

No. 382 / TR5®

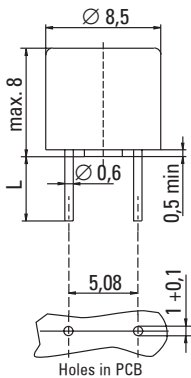

Dimensions (mm)



Long Leads (L=18.8mm)
Short Leads (L=4.3mm)

**IEC 60127-3/IV, 250 V, T
lead free**

Time-Current Characteristic
Time Lag (T)

Standard
IEC 60127-3/IV

Approvals
VDE
SEMKO
cULus Recognized
METI-T-Mark
METI-PSE
CCC

Features

- Lead Free
- 100A breaking capacity
- Reduced PCB space requirements
- Direct solderable or plug-in versions
- Internationally approved
- Low internal resistance
- Shocksafe casing
- Vibration resistant
- Halogen free

WebLinks

Further info see:
www.wickmanngroup.com
Further application info see fuseology:
www.wickmanngroup.com/download/fuseology.pdf



RoHS

Specifications

Packaging

000: Tape/Ampopack (1000 pcs.)
041: Short Leads - Bulk (1000 pcs.)

Materials

Base/Cap: Brown Thermoplastic
Polyamide PA 6.6, UL 94 V0
Round Pins: Copper, Sn plated

Operating Temperature

-40 °C to +85 °C (consider de-rating)

Climatic Category

-40 °C/+85 °C/21 days
(IEC 60068-1,-2-1,-2-2,-2-78)

Stock Conditions

+10 °C to +60 °C
relative humidity ≤ 75 % yearly average,
without dew, maximum value for 30 days-95 %

Vibration Resistance

24 cycles at 15 min. each (EN 60068-6)
10 - 60 Hz at 0.75 mm amplitude
60 - 2000 Hz at 10 g acceleration

Lead Pull Strength

10N (IEC 60068-2-21)

Solderability

260 °C, ≤ 3 s (Wave)
350 °C, ≤ 3 s (Soldering Iron)

Soldering Heat Resistance

260 °C, 10 s (IEC 60068-2-20)

Marking

Ⓜ, 382, 250 V, T, Current Rating, Approvals

Unit Weight

0.82 g (approx.)

Limits for Pre-arcing Time

| Rated Current | 1.5 x I _N | 2.1 x I _N | 2.75 x I _N | 4 x I _N | 10 x I _N |
|-------------------|----------------------|----------------------|-----------------------|--------------------|---------------------|
| 1.00 A ... 6.30 A | > 1 h | < 2 min | 400 ms ... 10 s | 150 ms ... 3 s | 20 ms ... 150 ms |



Permissible continuous operating current is ≤ 100 % at ambient temperature of 23 °C (73.4 °F).

| Rated Current | Amp Code | Voltage Rating | Breaking Capacity | Voltage Drop 1.0 x I _N max. (mV) | Power Dissipation 1.5 x I _N max. (mW) | Melting Integral 10 x I _N min. (A ² s) | Approvals | | | | |
|---------------|----------|----------------|--|--|---|---|-----------|-------|-------|-------------|----------|
| | | | | | | | VDE | SEMKO | cULus | METI-T-Mark | METI-PSE |
| 1.00 A | 1100 | 250 V | 100A / 250 V AC ¹ 50-60Hz cos φ = 1.0 | 100 | 400 | 3.0 | • | • | • | • | • |
| 1.25 A | 1125 | 250 V | | 95 | 465 | 4.5 | • | • | • | • | • |
| 1.60 A | 1160 | 250 V | | 90 | 490 | 9.0 | • | • | • | • | • |
| 2.00 A | 1200 | 250 V | | 85 | 670 | 12 | • | • | • | • | • |
| 2.50 A | 1250 | 250 V | | 80 | 750 | 22 | • | • | • | • | • |
| 3.15 A | 1315 | 250 V | | 75 | 900 | 32 | • | • | • | • | • |
| 4.00 A | 1400 | 250 V | | 70 | 1200 | 58 | • | • | • | • | • |
| 5.00 A | 1500 | 250 V | | 65 | 1250 | 90 | G | • | • | • | • |
| 6.30 A* | 1630 | 250 V | | 65 | 1400 | 105 | G | • | • | • | • |

¹ Breaking capacity at UL: 50A at 250V

* Conducting path min. 0.2mm²

^G Expert Report

Order Information

| Qty. | Order-Number | Series | Amp Code | Packaging |
|------|--------------|--------|----------|-----------|
| | | 382 | | |

Specifications are subject to change without notice

TR5[®] / No. 382

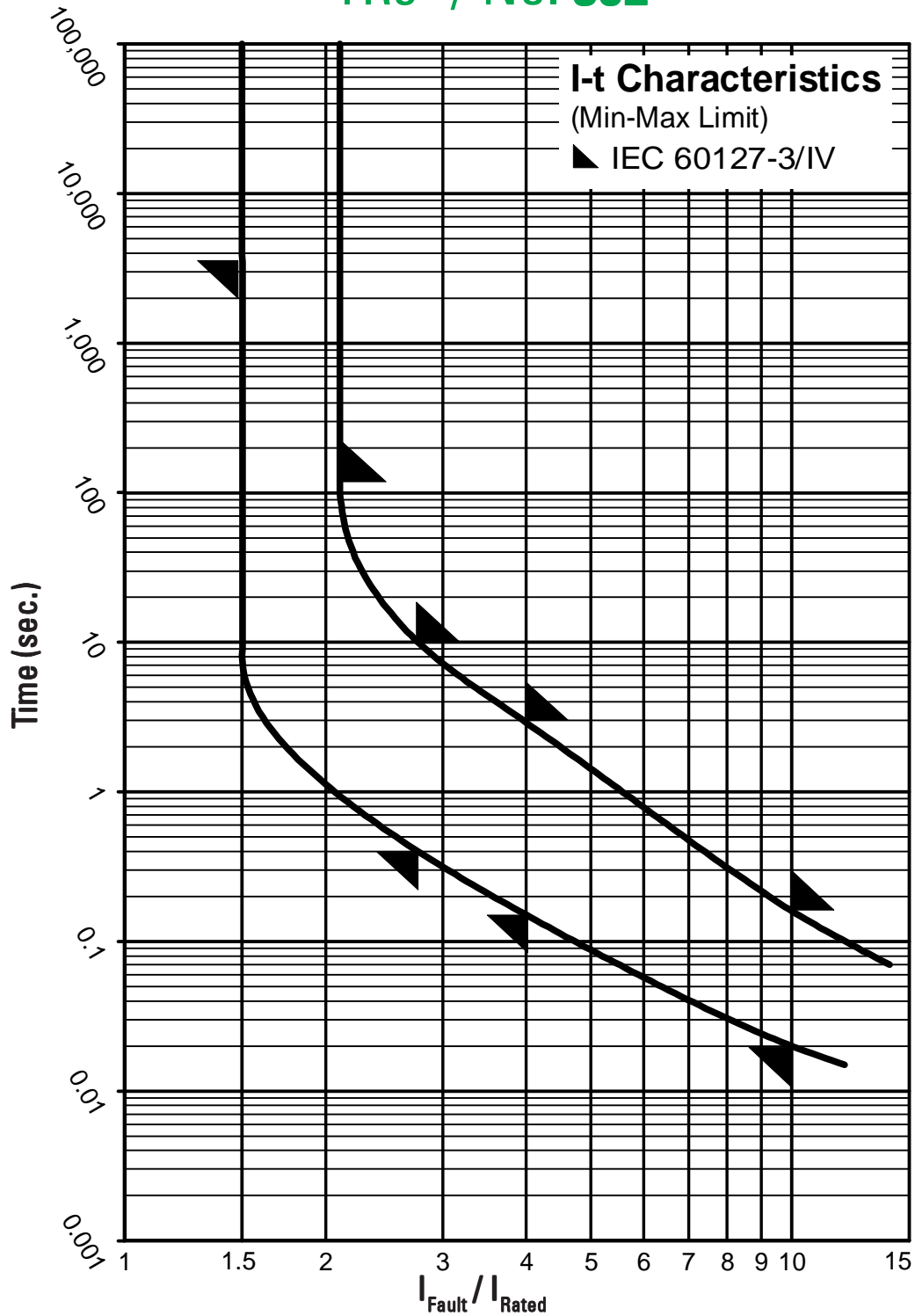

Contact WICKMANN for individual I-t curves