

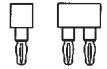

Receptacles, press-fit

For solderless mount into PCB, plated-thru holes, for pins \varnothing 0.40–0.56 mm



For corresponding pin connectors see pages 43 to 46

New version with modified eye of the needle pin

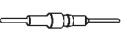
Platings	Sleeve 	Clip 	Pin 
91	5 μ m Sn Pb	0.25 μ m Au	
93	5 μ m Sn Pb	0.75 μ m Au	
99	5 μ m Sn Pb	5 μ m Sn Pb	

Ordering information

Replace **xx** with the number of poles, e.g. 346-93-1**xx**-41-035 for a single row version with 8 pins becomes: 346-93-1**08**-41-035

(Older versions 346/446-...-41-012/013/019 please consult)

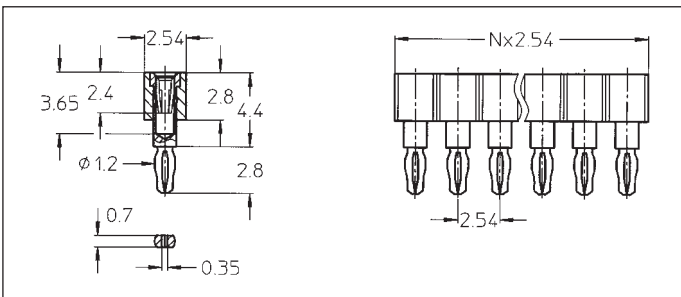

- 346-91-1xx-41-036
- 346-93-1xx-41-036
- 346-99-1xx-41-036

Press-fit receptacle connector:
single row, compliant pin
for plated-thru hole
 \varnothing 1 (+0.09/-0.06) mm

Availability from: 1 to 64 contacts
Standard number of contacts 5, 6, 8, 10, 14, 16, 20, 21, 25, 30, 32, 48, 56, 60, 64

For PCB thickness 1.5 to 2.0 mm

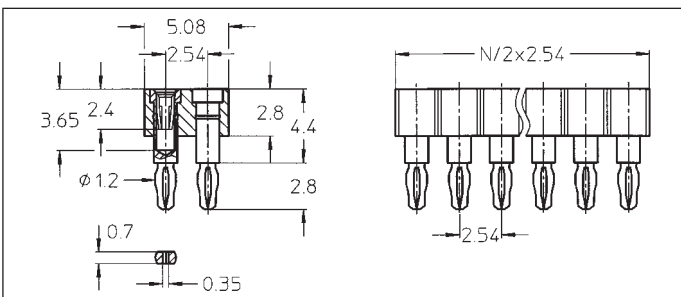

- 446-91-2xx-41-036
- 446-93-2xx-41-036
- 446-99-2xx-41-036

Press-fit receptacle connector:
double row, compliant pin
for plated-thru hole
 \varnothing 1 (+0.09/-0.06) mm

Availability from: 4 to 72 contacts
Standard number of contacts 40, 44, 56, 64, 72

For PCB thickness 1.5 to 2.0 mm

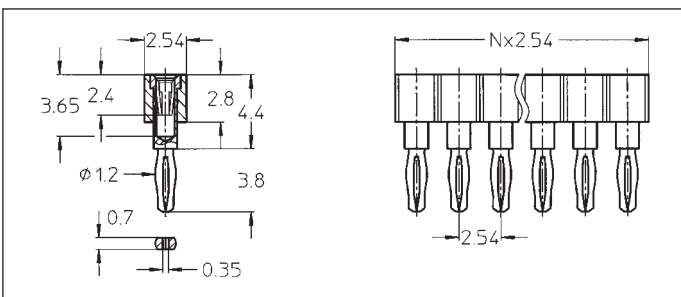

- 346-91-1xx-41-035
- 346-93-1xx-41-035
- 346-99-1xx-41-035

Press-fit receptacle connector:
single row, compliant pin
for plated-thru hole
 \varnothing 1 (+0.09/-0.06) mm

Availability from: 1 to 64 contacts
Standard number of contacts 5, 6, 8, 10, 14, 16, 20, 21, 25, 30, 32, 48, 56, 60, 64

For PCB thickness 2.1 to 3.2 mm

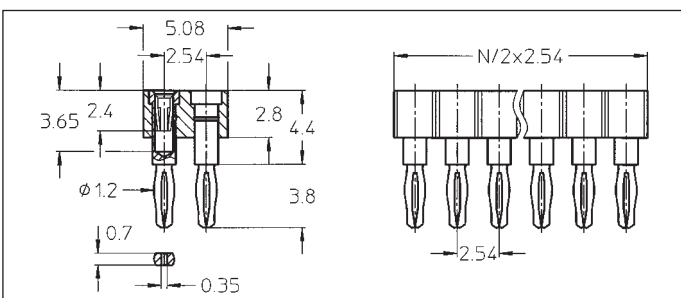

- 446-91-2xx-41-035
- 446-93-2xx-41-035
- 446-99-2xx-41-035

Press-fit receptacle connector:
double row, compliant pin
for plated-thru hole
 \varnothing 1 (+0.09/-0.06) mm

Availability from: 4 to 72 contacts
Standard number of contacts 40, 44, 56, 64, 72

For PCB thickness 2.1 to 3.2 mm