

C&K PL Series 5 Tumbler Miniature Camlocks



Features/Benefits

- **Cost-effective security**
- **Custom cams available**

Typical Applications

- **Office furniture**
- **Cash registers**
- **Copy machines**

Specifications

INDEXING: 90°: 2 positions.

NOTE: For the latest information regarding RoHS compliance, please go to: www.ittcannon.com/rohs.

NOTE: Specifications and materials listed above are for camlocks with standard options. For information on specific and custom camlocks, consult Customer Service Center.

Materials

LOCK: 6/6 nylon (UL 94V-2). Color, black.

5 tumbler, single bitted lock with integral detent mechanism.

KEYS: Two nickel plated brass keys with black plastic insert molded head.

CAM: 6/6 nylon (UL 94V-2).

Build-A-Switch

To order, simply select desired option from each category and place in the appropriate box. Available options are shown and described on pages M-53 and M-54. For additional options not shown in catalog, consult Customer Service Center.

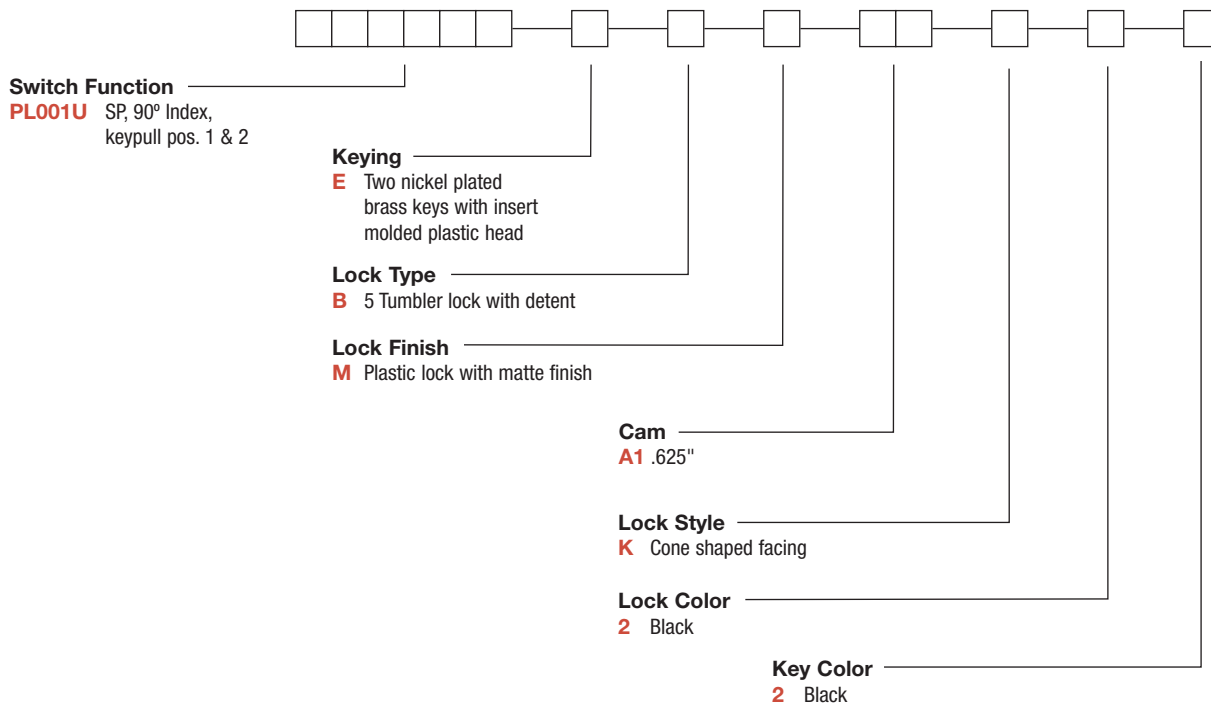

Switchlock



Dimensions are shown: Inch (mm)
 Specifications and dimensions subject to change

C&K PL Series 5 Tumbler Miniature Camlocks

LOCK FUNCTION

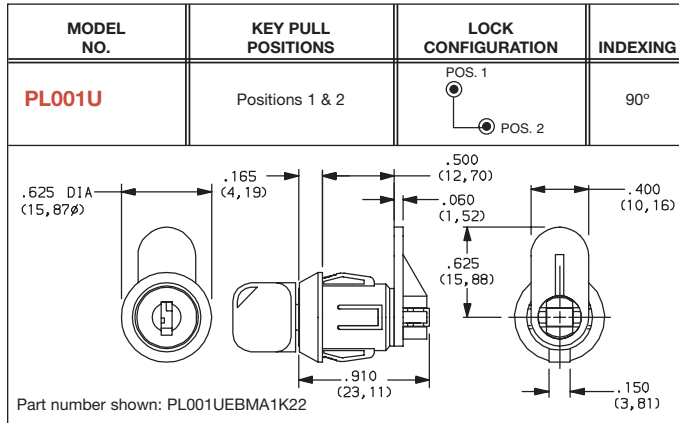

LEGEND

- = Detent Position (90°)
- ⊙ = Key pull possible in these positions.
- ⊙ = Stop Positions

KEYING

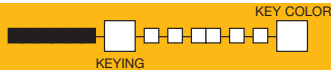

E TWO NICKEL PLATED BRASS KEYS WITH INSERT MOLDED PLASTIC HEAD

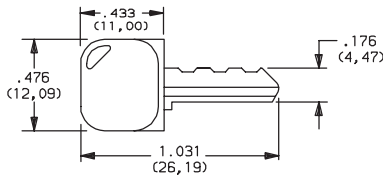

Key part number: 334C1004102

OPTION CODE	KEY COLOR
2	BLACK

NOTE: All orders keyed alike, standard. For more than one key code, replacement keys, or other special features, consult Customer Service Center.

LOCK TYPE

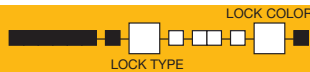

B 5 TUMBLER LOCK WITH DETENT

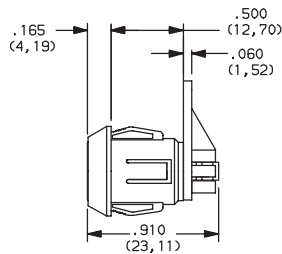

OPTION CODE	LOCK COLOR
2	BLACK

LOCK FINISH



M PLASTIC LOCK WITH MATTE FINISH

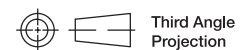

Dimensions are shown: Inch (mm)
Specifications and dimensions subject to change



M

Switchlock

C&K PL Series 5 Tumbler Miniature Camlocks

CAM

A1 .625"

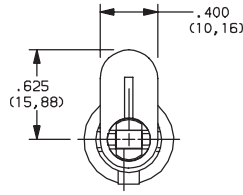

NOTE: Cam not assembled to switch. Other cam lengths and styles available, consult Customer Service Center.

LOCK STYLE

K CONE SHAPED FACING

PANEL MOUNTING

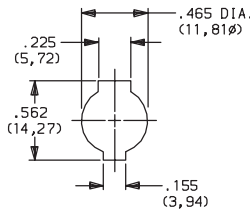
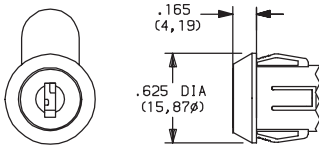

Panel thickness: .050-.080 (1,27-2,03)

AVAILABLE HARDWARE

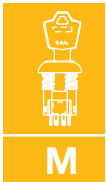

Key Code: 041
PART NO. (ONE KEY)

334C1004102 BLACK

Material: Brass
Finish: Nickel plate
6/6 Nylon insert molded head

Switchlock



Dimensions are shown: Inch (mm)
Specifications and dimensions subject to change