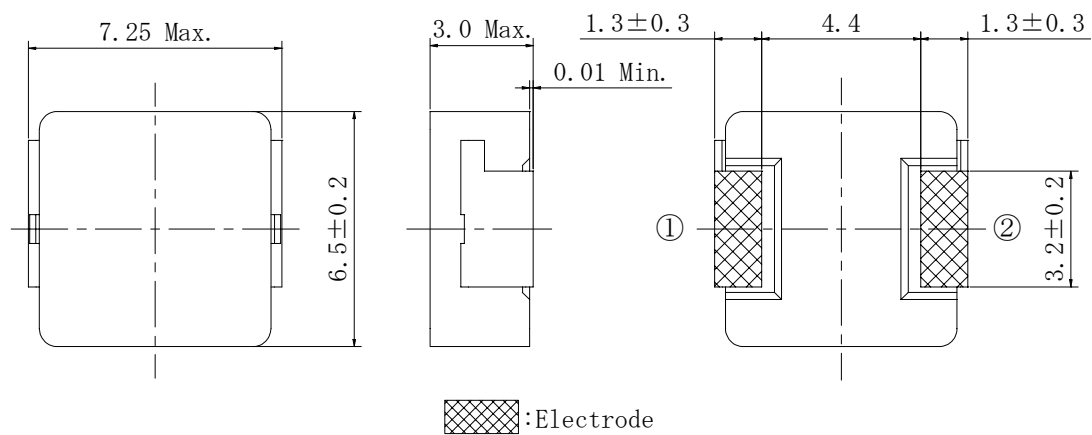
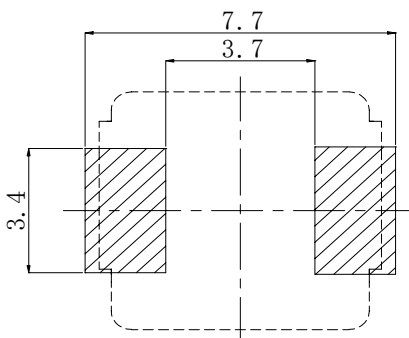
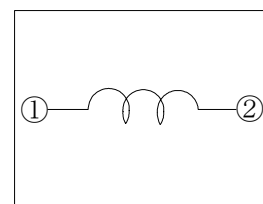

**Type: CDMC6D28**
**◆ Product Description**

- 6.7×7.25mm Max. (L×W), 3.0mm Max. height.
- Inductance range: 0.2~4.7 μH
- Rated Current Range: 3.7~17.4A

**◆ Feature**

- Magnetically shielded construction.
- Metal Powder Molded Type, Super high current inductors.
- High Current Inductor for Server, Notebook PC ,CPU, etc, as DC-DC Converter inductors.
- RoHS Compliance

**◆ Dimensions (mm)**

**◆ Land Pattern (mm)**

**◆ Schematics (Bottom)**

**Type: CDMC6D28**
**◆ Specification**

Part Name ※	Stamp	Inductance [Within] ( $\mu$ H) ※1	D.C.R. Max. (m $\Omega$ ) (at 20°C)	Saturation Current (A) (at 20°C)	Temperature rise current (A) ※4
CDMC6D28NP-R20M□	R20	0.20 $\pm$ 20%	2.5 (2.1)	21.7 (27.2)	17.4 (19.8)
CDMC6D28NP-R30M□	R30	0.30 $\pm$ 20%	3.2 (2.7)	15.4 (19.3)	16.1 (18.2)
CDMC6D28NP-R47M□	R47	0.47 $\pm$ 20%	4.2 (3.5)	13.6 (17.0)	14.0 (15.9)
CDMC6D28NP-R68M□	R68	0.68 $\pm$ 20%	5.4 (4.5)	11.3 (14.2)	12.1 (13.7)
CDMC6D28NP-1R0M□	1R0	1.0 $\pm$ 20%	8.8 (7.3)	8.8 (11.0)	9.5 (10.8)
CDMC6D28NP-1R5M□	1R5	1.5 $\pm$ 20%	12.5 (10.4)	7.3 (9.2)	7.6 (8.6)
CDMC6D28NP-2R2M□	2R2	2.2 $\pm$ 20%	19.3 (16.1)	6.0 (7.6)	6.0 (6.8)
CDMC6D28NP-3R3M□	3R3	3.3 $\pm$ 20%	30.6 (25.5)	5.0 (6.3)	4.9 (5.5)
CDMC6D28NP-4R7M□	4R7	4.7 $\pm$ 20%	46.4 (38.7)	4.3 (5.4)	3.7 (4.2)

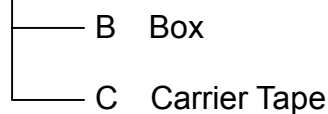
**※ Description of part name**

CDMC6D28NP-R20M□



※1. Measuring frequency: 1MHz

※2. ( ) is typical value.

※3. Saturation current: This indicates DC current at which the inductance decreases to 80% of its initial value.

 ※4. The temperature rise: The DC current at which the temperature rise is  $\Delta T=40^{\circ}\text{C}$  ( $T_a=20^{\circ}\text{C}$ ).