

Type: RC-865

Product Description

- 8.5mm Max. ϕ , 6.5mm Max. Height.
- Inductance range: 100 μ H ~ 10mH
- Rated Current Range : 40 ~ 450mA



Feature

- Magnetically unshielded construction.
- Ideally Used in Printers, LCD TV, Copy Machine, Mainboard of the compounding machines, Adapters, etc as Power Supplies's inductors or DC-DC Converter inductors.
- RoHS Compliance

Dimensions (mm)

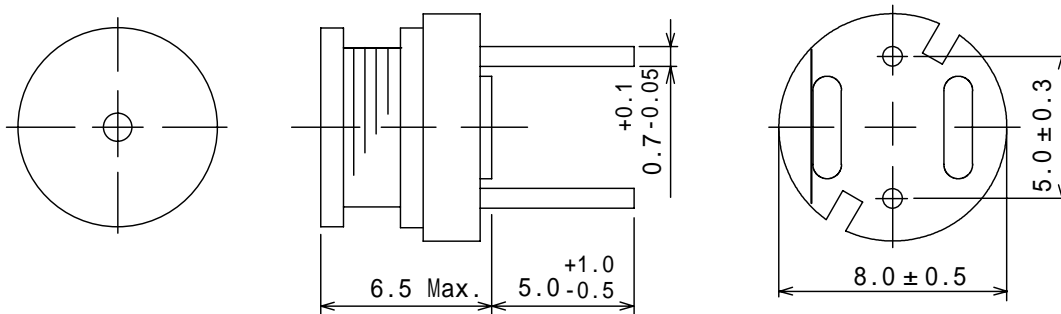

Type: RC-865
Specification

| Part Name | Stamp | Inductance [Within] 1 | Qu [Min.] 1 | D.C.R.() [Max.] (at 20) | Saturation current (m A)[Ref.] 2 |
|--------------|-------|-----------------------------|-------------------|---------------------------------|--|
| RC865NP-1Ø1K | 101K | 100 µ H ± 10% | 25 | 0.65 | 450 |
| RC865NP-121K | 121K | 120 µ H ± 10% | 25 | 0.80 | 390 |
| RC865NP-151K | 151K | 150 µ H ± 10% | 35 | 1.1 | 360 |
| RC865NP-181K | 181K | 180 µ H ± 10% | 35 | 1.3 | 330 |
| RC865NP-221K | 221K | 220 µ H ± 10% | 35 | 1.5 | 300 |
| RC865NP-271K | 271K | 270 µ H ± 10% | 35 | 2.1 | 260 |
| RC865NP-331K | 331K | 330 µ H ± 10% | 35 | 2.6 | 240 |
| RC865NP-391K | 391K | 390 µ H ± 10% | 35 | 3.0 | 210 |
| RC865NP-471K | 471K | 470 µ H ± 10% | 40 | 3.8 | 200 |
| RC865NP-561K | 561K | 560 µ H ± 10% | 40 | 4.2 | 180 |
| RC865NP-681K | 681K | 680 µ H ± 10% | 40 | 5.3 | 160 |
| RC865NP-821K | 821K | 820 µ H ± 10% | 40 | 5.9 | 140 |
| RC865NP-1Ø2K | 102K | 1.0mH ± 10% | 40 | 8.6 | 130 |
| RC865NP-122K | 122K | 1.2mH ± 10% | 40 | 9.8 | 120 |
| RC865NP-152K | 152K | 1.5mH ± 10% | 45 | 11.0 | 110 |
| RC865NP-182K | 182K | 1.8mH ± 10% | 45 | 13.0 | 100 |
| RC865NP-222K | 222K | 2.2mH ± 10% | 45 | 15.0 | 90 |
| RC865NP-272K | 272K | 2.7mH ± 10% | 45 | 18.0 | 80 |
| RC865NP-332K | 332K | 3.3mH ± 10% | 50 | 24.0 | 75 |
| RC865NP-392K | 392K | 3.9mH ± 10% | 50 | 27.0 | 65 |
| RC865NP-472K | 472K | 4.7mH ± 10% | 45 | 40.0 | 60 |
| RC865NP-562K | 562K | 5.6mH ± 10% | 45 | 52.0 | 55 |
| RC865NP-682K | 682K | 6.8mH ± 10% | 45 | 61.0 | 50 |
| RC865NP-822K | 822K | 8.2mH ± 10% | 45 | 70.0 | 45 |
| RC865NP-1Ø3K | 103K | 10mH ± 10% | 45 | 86.0 | 40 |

1.Measuring frequency :L: 1 kHz; Qu : 100 kHz

2. Saturation current: The DC current at which the inductance decreases to 95% of it's initial value.