

Edgeboard Connectors 200°C Burn-In Connectors, Dual Readout



ELECTRICAL SPECIFICATIONS

Current Rating: 5 amps.

Test Voltage Between Contacts: At sea level: 1800VRMS.
At 70,000 feet: 450VRMS.

Insulation Resistance: 5000 Megohm minimum at 500VDC potential.

Contact Resistance: 30 millivolts maximum at rated current.

Humidity: 48 hours at 95% relative humidity at + 90°C, insulation resistance 5000 Megohm.

Shock: Three 50g shocks in each of 3 mutually perpendicular planes with no loss of continuity.

FEATURES

- **EB4**, 0.100" [2.54mm] C-C. **EB6**, 0.125" [3.17mm] C-C. **EB7 and EB8**, 0.156" [3.96mm] C-C.
- Right angle styles included for all models.
- High temperature, glass reinforced PPS connector bodies - 200°C.
- High reliability copper-nickel-tin alloy contacts.
- Accepts PC board thickness of 0.054" to 0.071" [1.37mm to 1.80mm].
- High reliability bifurcated bellows contacts.
- Gold plated contacts.
- Card extender style terminals standard.
- Variety of mounting styles available.
- **Recognized under the Component Program of Underwriters Laboratories, Inc. Listed under File E65524.**

APPLICATIONS

High temperature, long life connectors specifically designed for burn-in oven and automatic temperature testing applications.

Available in a wide range of sizes. Priced affordably and competitively.

SPECIAL NOTE:

When operating units at elevated temperatures, solder having a melting point 50 degrees Centigrade above the operating temperature should be used. Contact factory for specific solder information.

MATERIAL SPECIFICATIONS

Body Material:

200°C Connectors: Fiberglass reinforced polyphenylene sulfide, + 200°C operating temperature, flame retardant (UL 94V-O).

Contacts: Copper-nickel-tin alloy per ASTM B 740.

Plating: Gold plating (0.00003" [0.000762mm] thick), over 0.00005" [0.00127mm] minimum nickel underplate.



MOUNTING STYLES in inches [millimeters]			
<p>Wire Wrap™ Permanent Mounting</p>			<p>EB4 0.100" [2.54mm] C-C EB6 0.125" [3.17mm] C-C</p>
200°C WIRE WRAP™ MODEL NUMBERS			
EB45-PK10GX EB45-PK12GX EB45-PK15GX EB45-PK18GX EB45-PK20GX EB45-PK22GX EB45-PK25GX EB45-PK28GX EB45-PK30GX EB45-PK31GX	EB45-PK35GX EB45-PK36GX EB45-PK40GX EB45-PK43GX EB45-PK44GX EB45-PK48GX EB45-PK49GX EB45-PK50GX EB45-PK60GX EB45-PK65GX	EB65-PK6GX EB65-PK10GX EB65-PK12GX EB65-PK14GX EB65-PK15GX EB65-PK18GX EB65-PK22GX EB65-PK24GX EB65-PK25GX EB65-PK28GX	EB65-PK30GX EB65-PK31GX EB65-PK32GX EB65-PK35GX EB65-PK36GX EB65-PK40GX EB65-PK43GX EB65-PK44GX EB65-PK49GX EB65-PK50GX
<p>Right Angle PC Board Mounting</p>			<p>EB4 0.100" [2.54mm] C-C EB6 0.125" [3.17mm] C-C EB7 0.156" [3.96mm] C-C</p>
200°C RIGHT ANGLE MODEL NUMBERS			
EB45-P3R10GXS EB45-P3R12GXS EB45-P3R15GXS EB45-P3R18GXS EB45-P3R20GXS EB45-P3R22GXS EB45-P3R25GXS* EB45-P3R28GXS EB45-P3R30GXS EB45-P3R31GXS EB45-P3R35GXS EB45-P3R36GXS	EB45-P3R40GXS EB45-P3R43GXS EB45-P3R44GXS EB45-P3R48GXS EB45-P3R49GXS EB45-P3R50GXS EB45-P3R60GXS EB45-P3R65GXS EB65-P3R6GX EB65-P3R10GX EB65-P3R12GX EB65-P3R14GX	EB65-P3R15GX EB65-P3R18GX EB65-P3R22GX EB65-P3R24GX EB65-P3R25GX EB65-P3R28GX EB65-P3R30GX EB65-P3R31GX EB65-P3R32GX EB65-P3R35GX EB65-P3R36GX EB65-P3R40GX	EB65-P3R43GX EB65-P3R44GX EB65-P3R49GX EB65-P3R50GX EB75D-PR6GXS EB75D-PR10GXS EB75D-PR12GXS EB75D-PR15GXS EB75D-PR18GXS EB75D-PR22GXS EB75D-PR36GXS EB75D-PR43GXS
<p>Hard Wire Permanent Mounting</p>			<p>EB7 0.156" [3.96mm] C-C EB8 0.156" [3.96mm] C-C</p>
200°C HARD WIRE MODEL NUMBERS			
EB85-PA6GX EB85-PA10GX EB85-PA12GX	EB85-PA15GX EB85-PA18GX EB85-PA22GX	EB85-PA24GX EB85-PA25GX EB75D-PA36GX	EB75D-PA43GX

MOUNTING VARIATIONS in inches [millimeters]

EB4 0.100" [2.54mm] C-C, EB6 0.125" [3.17mm] C-C

Type "X"
Clearance Hole
Raised Mounting Flange

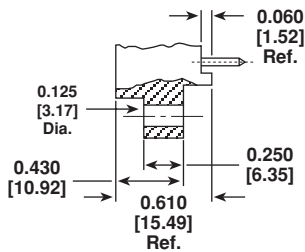

Type "XF"
Clearance Hole
Flush Mounting Flange

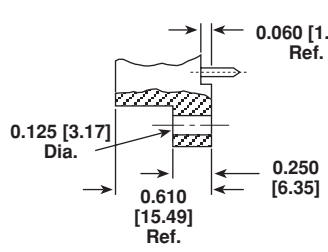

Type "XS"
Right Angle
Mounting Flange

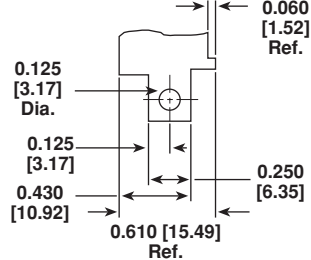

Type "XFS"
Right Angle
Mounting Flange

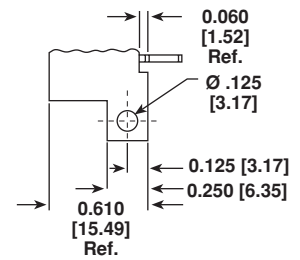

EB7 and EB8 0.156" [3.96mm] C-C
Side Mounting

Type "XS"

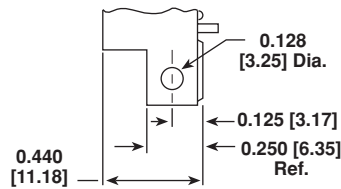

TERMINAL VARIATIONS in inches [millimeters]

EB4 0.100" [2.54mm] C-C

Type "E"
Card Extender

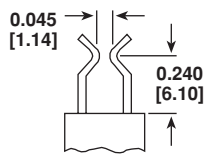

Type "K"
Wire Wrap™
0.025 [.630] Square Terminals

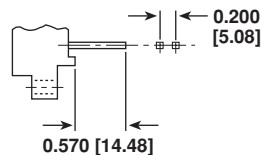

Type "3R"
Right Angle
0.025 [.630] Square Terminals

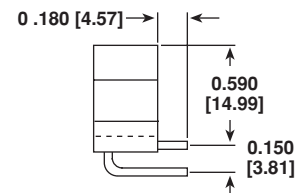

EB6 0.125" [3.17mm] C-C

Type "E"
Card Extender

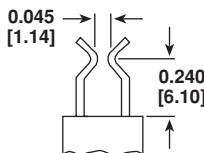

Type "K"
Wire Wrap™
0.025 [.630] Square Terminals

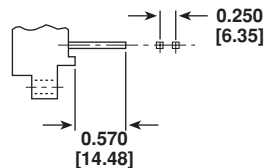

Type "3R"
Right Angle
0.025 [.630] Square Terminals

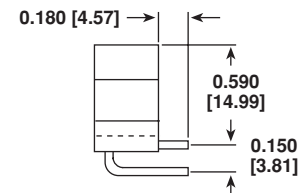

EB7 and EB8 .156" [3.96mm] C-C

Type "A"
Solder Eyelet

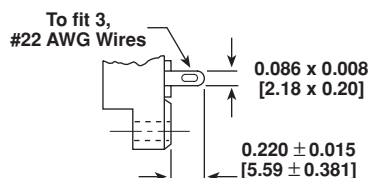

EB7D only
Type "R"
Right Angle

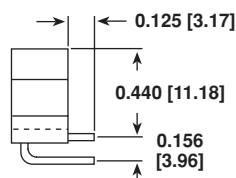

Type "E"
Card Extender (Made from Type "A")

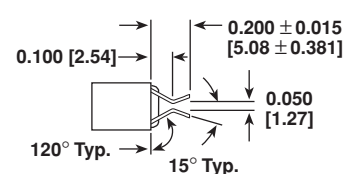



DIMENSIONS in inches [millimeters]

EB4 .100" [2.54mm] C-C

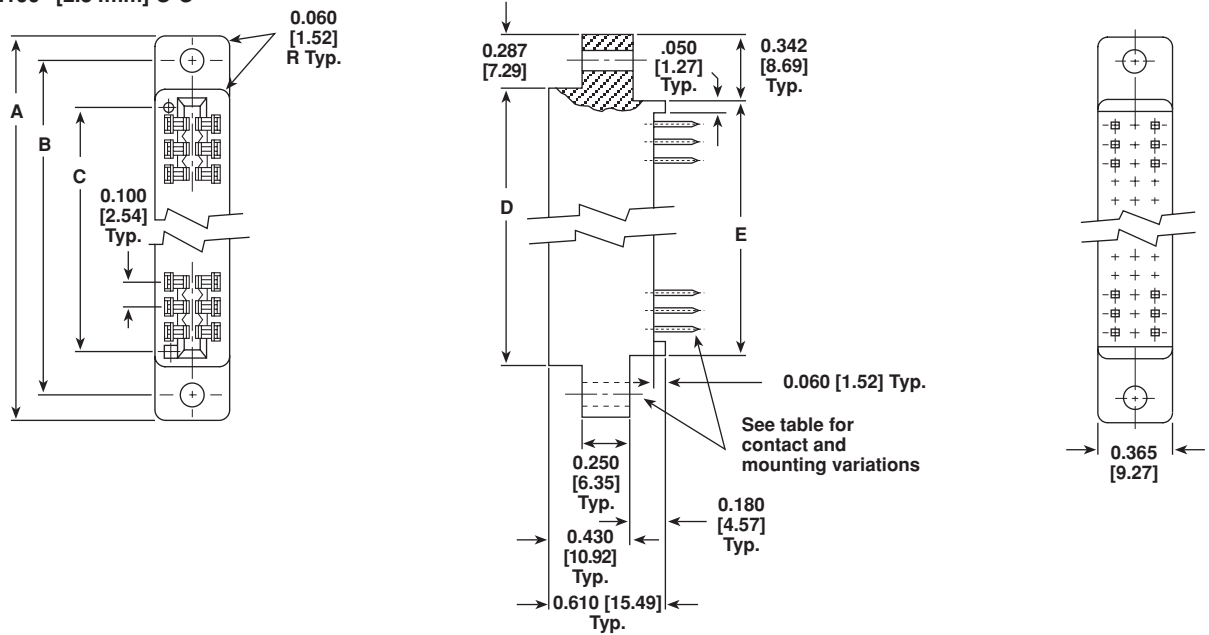

MODEL - PART NUMBER	# OF CONTACT POSITIONS PER SIDE	A	B	C	D	E	CARD SLOT DEPTH
EB45-P□6GΔ	6	1.435 [36.45]	1.175 [29.85]	0.700 [17.78]	0.860 [24.84]	0.750 [19.05]	0.300 [7.62]
EB45-P□10GΔ	10	1.835 [46.61]	1.575 [40.00]	1.100 [27.94]	1.260 [32.00]	1.150 [29.21]	0.300 [7.62]
EB45-P□12GΔ	12	2.035 [51.69]	1.775 [45.08]	1.300 [33.02]	1.460 [37.08]	1.350 [34.29]	0.300 [7.62]
EB45-P□15GΔ	15	2.335 [59.31]	2.075 [52.70]	1.600 [40.64]	1.760 [44.70]	1.650 [41.91]	0.300 [7.62]
EB45-P□18GΔ	18	2.635 [66.93]	2.375 [60.32]	1.900 [48.26]	2.060 [52.32]	1.950 [49.53]	0.300 [7.62]
EB45-P□20GΔ	20	2.835 [72.01]	2.575 [65.40]	2.100 [53.34]	2.260 [57.40]	2.150 [54.61]	0.300 [7.62]
EB45-P□22GΔ	22	3.035 [77.09]	2.775 [70.48]	2.300 [58.42]	2.460 [62.48]	2.350 [59.69]	0.300 [7.62]
EB45-P□25GΔ	25	3.335 [84.71]	3.075 [78.10]	2.600 [66.04]	2.760 [70.10]	2.650 [67.31]	0.300 [7.62]
EB45-P□28GΔ	28	3.635 [92.33]	3.375 [85.72]	2.900 [73.66]	3.060 [77.72]	2.950 [74.93]	0.300 [7.62]
EB45-P□30GΔ	30	3.835 [97.41]	3.575 [90.80]	3.100 [78.74]	3.260 [82.80]	3.150 [80.01]	0.300 [7.62]
EB45-P□31GΔ	31	3.935 [99.95]	3.675 [93.34]	3.200 [81.28]	3.360 [85.34]	3.250 [82.55]	0.300 [7.62]
EB45-P□35GΔ	35	4.335 [110.11]	4.075 [103.50]	3.600 [91.44]	3.760 [95.50]	3.650 [92.71]	0.300 [7.62]
EB45-P□36GΔ	36	4.435 [112.65]	4.175 [106.04]	3.700 [93.98]	3.860 [98.04]	3.750 [95.25]	0.300 [7.62]
EB45-P□40GΔ	40	4.835 [122.81]	4.575 [116.20]	4.100 [104.14]	4.260 [108.20]	4.150 [105.41]	0.300 [7.62]
EB45-P□43GΔ	43	5.135 [130.43]	4.875 [123.82]	4.400 [111.76]	4.560 [115.82]	4.450 [113.03]	0.300 [7.62]
EB45-P□44GΔ	44	5.235 [132.97]	4.975 [126.36]	4.500 [114.30]	4.660 [118.36]	4.550 [115.57]	0.300 [7.62]
EB45-P□48GΔ	48	5.635 [143.13]	5.375 [136.52]	4.900 [124.46]	5.060 [128.52]	4.950 [125.73]	0.300 [7.62]
EB45-P□49GΔ	49	5.735 [145.67]	5.475 [139.06]	5.000 [127.00]	5.160 [131.06]	5.050 [128.27]	0.300 [7.62]
EB45-P□50GΔ	50	5.835 [148.21]	5.575 [141.60]	5.100 [129.54]	5.260 [133.60]	5.150 [130.81]	0.300 [7.62]
EB45-P□60GΔ	60	6.835 [173.61]	6.575 [167.00]	6.100 [154.94]	6.260 [159.00]	6.150 [156.21]	0.300 [7.62]
EB45-P□65GΔ	65	7.335 [186.31]	7.075 [179.70]	6.600 [167.64]	6.760 [171.70]	6.650 [168.91]	0.300 [7.62]

ORDERING INFORMATION

When ordering connectors using the above Part Numbers:
 □ = Indicate "E" for Card Extender, "K" for Wire Wrap™ or "3R" for Right Angle Terminals.
 Δ = Indicate "X" for Standard Mounting, "XF" for Flush Mounting or "XS" for Side Mounting.

EB4, EB6, EB7, EB8



Vishay Dale

Edgeboard Connectors
200°C Burn-in Connectors, Dual Readout

DIMENSIONS in inches [millimeters]

EB6 .125" [3.17mm] C-C

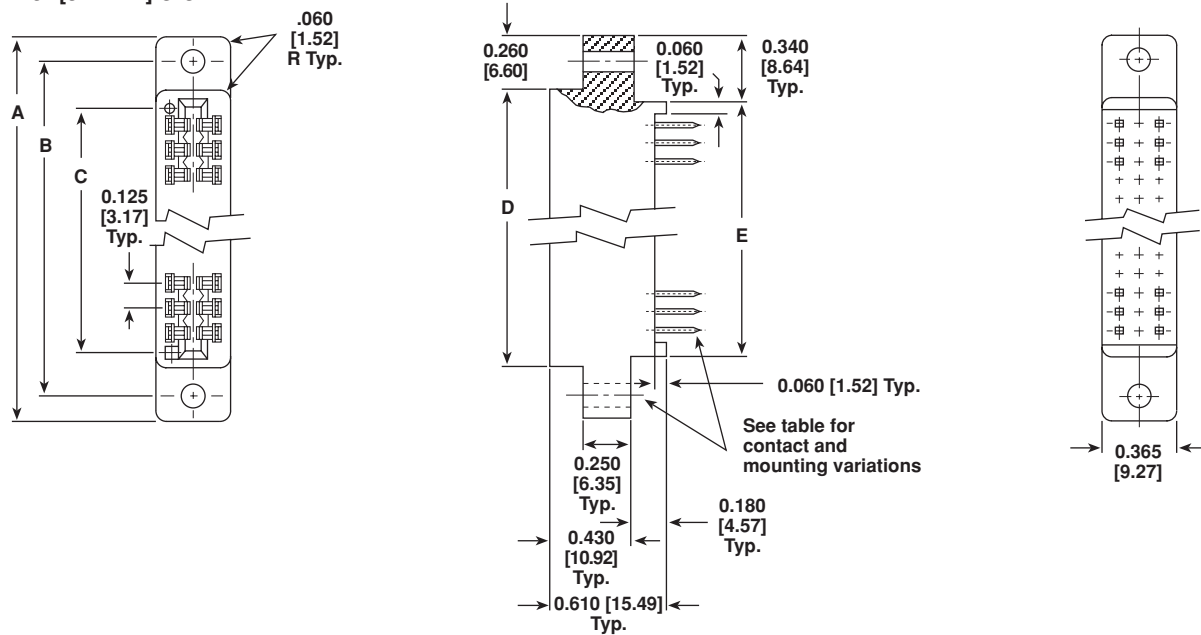

MODEL - PART NUMBER	# OF CONTACT POSITIONS PER SIDE	A	B	C	D	E	CARD SLOT DEPTH
EB65-P□6GΔ	6	1.555 [39.50]	1.295 [32.89]	.875 [22.22]	1.035 [26.29]	0.875 [22.22]	0.300 [7.62]
EB65-P□10GΔ	10	2.055 [52.20]	1.795 [45.59]	1.375 [34.92]	1.535 [38.99]	1.375 [34.92]	0.300 [7.62]
EB65-P□12GΔ	12	2.305 [58.55]	2.045 [51.94]	1.625 [41.28]	1.785 [45.34]	1.625 [41.28]	0.300 [7.62]
EB65-P□14GΔ	14	2.555 [64.90]	2.295 [58.29]	1.875 [47.62]	2.035 [51.69]	1.875 [47.62]	0.300 [7.62]
EB65-P□15GΔ	15	2.680 [68.07]	2.420 [61.47]	2.000 [50.80]	2.160 [54.86]	2.000 [50.80]	0.300 [7.62]
EB65-P□18GΔ	18	3.055 [77.60]	2.795 [70.99]	2.375 [60.32]	2.535 [64.39]	2.375 [60.32]	0.300 [7.62]
EB65-P□22GΔ	22	3.555 [90.30]	3.295 [83.69]	2.875 [73.02]	3.035 [77.09]	2.875 [73.02]	0.300 [7.62]
EB65-P□24GΔ	24	3.805 [96.65]	3.545 [90.04]	3.125 [79.38]	3.285 [83.44]	3.125 [79.38]	0.300 [7.62]
EB65-P□25GΔ	25	3.930 [99.82]	3.670 [93.22]	3.250 [82.55]	3.410 [86.61]	3.250 [82.55]	0.300 [7.62]
EB65-P□28GΔ	28	4.305 [109.35]	4.045 [102.74]	3.625 [92.08]	3.785 [96.14]	3.625 [92.08]	0.300 [7.62]
EB65-P□30GΔ	30	4.555 [115.70]	4.295 [109.09]	3.875 [98.42]	4.035 [102.49]	3.875 [98.42]	0.300 [7.62]
EB65-P□31GΔ	31	4.680 [118.87]	4.420 [112.27]	4.000 [101.60]	4.160 [105.66]	4.000 [101.60]	0.300 [7.62]
EB65-P□32GΔ	32	4.805 [122.05]	4.545 [115.44]	4.125 [104.78]	4.285 [108.84]	4.125 [104.78]	0.300 [7.62]
EB65-P□35GΔ	35	5.180 [131.57]	4.920 [124.97]	4.500 [114.30]	4.660 [118.36]	4.500 [114.30]	0.300 [7.62]
EB65-P□36GΔ	36	5.305 [134.75]	5.045 [128.14]	4.625 [117.48]	4.785 [121.54]	4.625 [117.48]	0.300 [7.62]
EB65-P□40GΔ	40	5.805 [147.45]	5.545 [140.84]	5.125 [130.18]	5.285 [134.24]	5.125 [130.18]	0.300 [7.62]
EB65-P□43GΔ	43	6.180 [156.97]	5.920 [150.37]	5.500 [139.70]	5.660 [143.76]	5.500 [139.70]	0.300 [7.62]
EB65-P□44GΔ	44	6.305 [160.15]	6.045 [153.54]	5.625 [142.88]	5.785 [146.94]	5.625 [142.88]	0.300 [7.62]
EB65-P□49GΔ	49	6.930 [176.02]	6.670 [169.42]	6.250 [158.75]	6.410 [162.81]	6.250 [158.75]	0.300 [7.62]
EB65-P□50GΔ	50	7.055 [179.20]	6.795 [172.59]	6.375 [161.92]	6.535 [165.99]	6.375 [161.92]	0.300 [7.62]

ORDERING INFORMATION

When ordering connectors using the above Part Numbers:

□ = Indicate "E" for Card Extender, "K" for Wire Wrap™ or "3R" for Right Angle Terminals.

Δ = Indicate "X" for Standard Mounting, "XF" for Flush Mounting or "XS" for Side Mounting.



DIMENSIONS in inches [millimeters]

EB7 and EB8 .156" [3.96mm] C-C

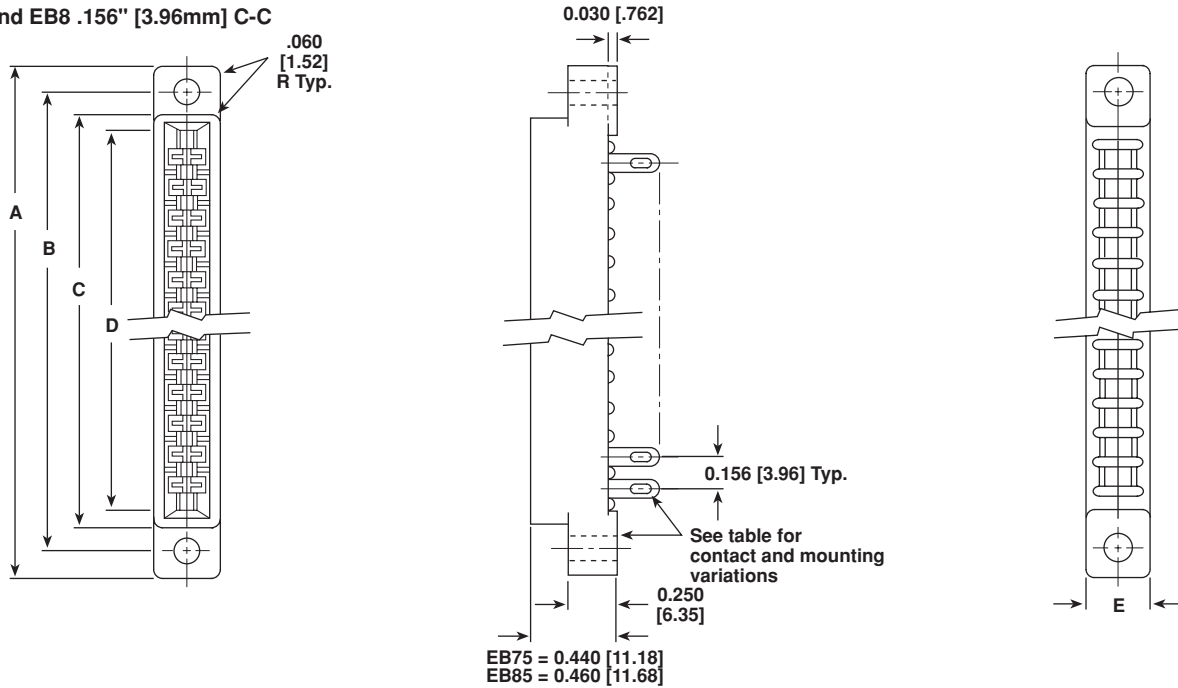

MODEL - PART NUMBER	# OF CONTACT POSITIONS PER SIDE	A	B	C	D	E	CARD SLOT DEPTH
EB85-P□6GΔ	6	1.780 [45.21]	1.531 [38.89]	1.240 [31.50]	1.100 [27.94]	0.340 [8.64]	0.330 [8.38]
EB85-P□10GΔ	10	2.410 [61.21]	2.156 [54.76]	1.864 [47.35]	1.724 [43.79]	0.340 [8.64]	0.330 [8.38]
EB85-P□12GΔ	12	2.720 [69.09]	2.469 [62.71]	2.176 [55.27]	2.036 [51.71]	0.340 [8.64]	0.330 [8.38]
EB85-P□15GΔ	15	3.190 [81.03]	2.937 [74.60]	2.644 [67.16]	2.504 [63.60]	0.340 [8.64]	0.330 [8.38]
EB85-P□18GΔ	18	3.660 [92.96]	3.406 [86.51]	3.112 [79.04]	2.972 [75.49]	0.340 [8.64]	0.330 [8.38]
EB85-P□22GΔ	22	4.280 [108.71]	4.031 [102.39]	3.736 [94.89]	3.596 [91.34]	0.340 [8.64]	0.330 [8.38]
EB85-P□24GΔ	24	4.590 [116.59]	4.344 [110.34]	4.051 [102.90]	3.911 [99.34]	0.340 [8.64]	0.330 [8.38]
EB85-P□25GΔ	25	4.750 [120.65]	4.500 [114.30]	4.207 [106.86]	4.067 [103.30]	0.340 [8.64]	0.330 [8.38]
EB75D-P□36GΔ	36	6.530 [165.86]	6.219 [157.96]	5.906 [150.01]	5.778 [146.76]	0.438 [11.13]	0.260 [6.60]
EB75D-P□43GΔ	43	7.615 [193.42]	7.302 [185.47]	7.000 [177.80]	6.802 [172.77]	0.500 [12.70]	0.260 [6.60]

RIGHT ANGLE DIMENSIONS

EB75D-PR6GΔ	6	1.780 [45.21]	1.531 [38.89]	1.218 [30.94]	1.100 [27.94]	0.328 [8.33]	0.260 [6.60]
EB75D-PR10GΔ	10	2.410 [61.21]	2.156 [54.76]	1.843 [46.81]	1.724 [43.79]	0.328 [8.33]	0.260 [6.60]
EB75D-PR12GΔ	12	2.720 [69.09]	2.468 [62.69]	2.156 [54.76]	2.036 [51.71]	0.328 [8.33]	0.260 [6.60]
EB75D-PR15GΔ	15	3.190 [81.03]	2.937 [74.60]	2.624 [66.65]	2.504 [63.60]	0.328 [8.33]	0.260 [6.60]
EB75D-PR18GΔ	18	3.660 [92.96]	3.406 [86.51]	3.093 [78.56]	2.972 [75.49]	0.328 [8.33]	0.260 [6.60]
EB75D-PR22GΔ	22	4.280 [108.71]	4.031 [102.39]	3.717 [94.41]	3.596 [91.34]	0.328 [8.33]	0.260 [6.60]
EB75D-PR36GΔ	36	6.530 [165.86]	6.219 [157.96]	5.906 [150.01]	5.778 [146.76]	0.438 [11.13]	0.260 [6.60]
EB75D-PR43GΔ	43	7.615 [193.42]	7.302 [185.47]	7.000 [177.80]	6.802 [172.77]	0.500 [12.70]	0.260 [6.60]

ORDERING INFORMATION

When ordering connectors using the above Part Numbers:
 □ = Indicate "A" for Solder Eyelet or "E" for Card Extender. **Note:** Dimensions are the same for "A" or "E" styles.
 Δ = Indicate "X" for Standard Mounting or "XS" for Side Mounting.

MOUNTING STYLES in inches [millimeters]

Card Extender Mounting
For Fast Change of Test Setups

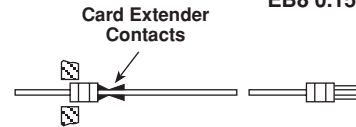
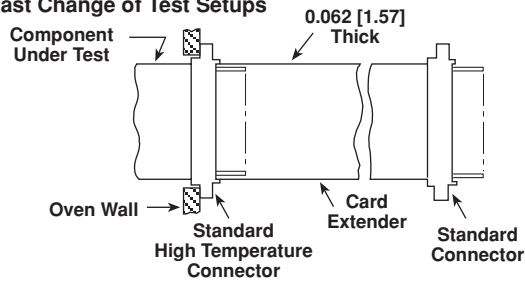

- EB4 0.100" [2.54mm] C-C
- EB6 0.125" [3.17mm] C-C
- EB7 0.156" [3.96mm] C-C
- EB8 0.156" [3.96mm] C-C

200°C CARD EXTENDER MODEL NUMBERS

EB45-PE10GX	EB45-PE43GX	EB65-PE22GX	EB65-PE50GX
EB45-PE12GX	EB45-PE44GX	EB65-PE24GX	EB75D-PE36GX
EB45-PE15GX	EB45-PE48GX	EB65-PE25GX	EB75D-PE43GX
EB45-PE18GX	EB45-PE49GX	EB65-PE28GX	EB85-PE6GX
EB45-PE20GX	EB45-PE50GX	EB65-PE30GX	EB85-PE10GX
EB45-PE22GX	EB45-PE60GX	EB65-PE31GX	EB85-PE12GX
EB45-PE25GX	EB45-PE65GX	EB65-PE32GX	EB85-PE15GX
EB45-PE28GX	EB65-PE6GX	EB65-PE35GX	EB85-PE18GX
EB45-PE30GX	EB65-PE10GX	EB65-PE36GX	EB85-PE22GX
EB45-PE31GX	EB65-PE12GX	EB65-PE40GX	EB85-PE24GX
EB45-PE35GX	EB65-PE14GX	EB65-PE43GX	EB85-PE25GX
EB45-PE36GX	EB65-PE15GX	EB65-PE44GX	
EB45-PE40GX	EB65-PE18GX	EB65-PE49GX	



Disclaimer

All product specifications and data are subject to change without notice.

Vishay Intertechnology, Inc., its affiliates, agents, and employees, and all persons acting on its or their behalf (collectively, "Vishay"), disclaim any and all liability for any errors, inaccuracies or incompleteness contained herein or in any other disclosure relating to any product.

Vishay disclaims any and all liability arising out of the use or application of any product described herein or of any information provided herein to the maximum extent permitted by law. The product specifications do not expand or otherwise modify Vishay's terms and conditions of purchase, including but not limited to the warranty expressed therein, which apply to these products.

No license, express or implied, by estoppel or otherwise, to any intellectual property rights is granted by this document or by any conduct of Vishay.

The products shown herein are not designed for use in medical, life-saving, or life-sustaining applications unless otherwise expressly indicated. Customers using or selling Vishay products not expressly indicated for use in such applications do so entirely at their own risk and agree to fully indemnify Vishay for any damages arising or resulting from such use or sale. Please contact authorized Vishay personnel to obtain written terms and conditions regarding products designed for such applications.

Product names and markings noted herein may be trademarks of their respective owners.