

# UW Series

Ceramic Wirewound Resistors

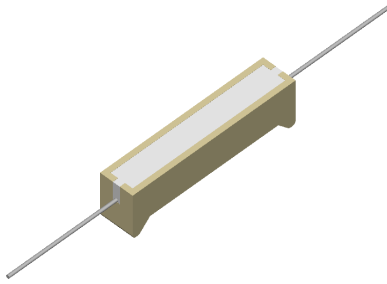

- Resistances from 0.01 to 91kOhms
- Tolerance to  $\pm 0.01\%$
- Low Temperature Coefficient
- Power Rating to 15Watts
- All Welded Resistance Element
- Non-Inductive Windings are Available
- Flameproof Inorganic Construction



## SPECIFICATIONS

Type	Power Rating W @ 70°C	Resistance <sup>1</sup> Range	L $\pm 0.04$ [ $\pm 1.0$ ]	H $\pm 0.04$ [ $\pm 1.0$ ]	HS $\pm 0.04$ [ $\pm 1.0$ ]	W $\pm 0.015$ [ $\pm 0.4$ ]	d <sup>2</sup> $\pm 0.015$ [ $\pm 0.4$ ]
UW-2	2	0.01 to 22k	0.700 [17.8]	0.245 [6.2]	0.300 [7.6]	0.255 [6.5]	0.032 [0.8]
UW-3	3	0.01 to 22k	0.875 [22.2]	0.312 [7.9]	0.375 [9.5]	0.312 [7.9]	0.032 [0.8]
UW-5	5	0.01 to 45k	0.875 [22.2]	0.375 [9.5]	0.437 [11.1]	0.375 [9.5]	0.032 [0.8]
UW-10	10	0.01 to 65k	1.875 [48]	0.375 [9.5]	0.500 [12.7]	0.375 [9.5]	0.040 [1.0]
UW-15	15	0.01 to 91k	1.875 [48]	0.500 [12.7]	0.625 [15.9]	0.500 [12.7]	0.040 [1.0]

<sup>1</sup> For non-inductive windings / divide maximum resistance by 2

<sup>2</sup> Lead Diameter: 18 AWG = 0.040" / 20 AWG = 0.032"

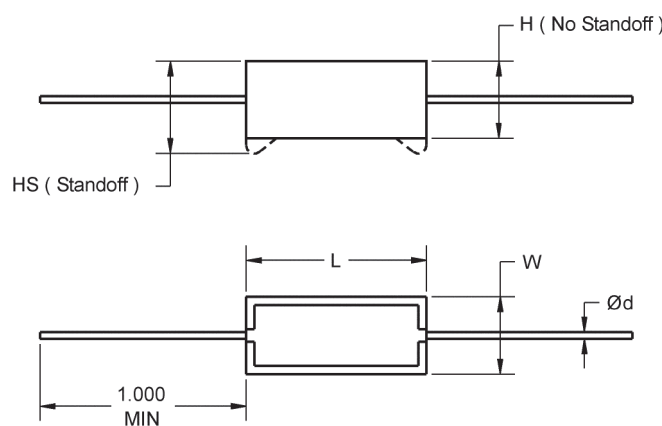

## Ordering Information

For Non-Inductive Windings / insert the letter "N" ( i.e. UWN-5 )

Part Number - Resistance - Tolerance - TCR ( If not standard )

Example: UW-5 100 Ohm 1%

# UW Series

Ceramic Wirewound Resistors



## SPECIFICATIONS (continued)

Specification	Value
Tolerances	±0.01% to ±10% ( 1% Standard )
Temperature Coefficient	>10Ω : ±20ppm/K 1Ω to 10Ω : ±50ppm/K <1Ω : Call Factory
Temperature Range	-55°C to +275°C
Dielectric Strength	1500 VAC
Constuction	Centerless ground ceramic core Tinned copper or copperweld leads High temperature / inorganic potting compound All welded terminations
Environmental Performance (MIL-STD 202)	ΔR
Dielectric	±0.2% + 0.05Ω
Load Life	±1% + 0.05Ω
Storage	±0.2% + 0.05Ω
Moisture Resistance	±0.2% + 0.05Ω
Thermal Shock	±0.2% + 0.05Ω
5X Overload ( 5s )	±0.2% + 0.05Ω
Shock	±0.1% + 0.05Ω
Vibration	±0.1% + 0.05Ω

Power Derating Curve

