

SPECIFICATION FOR APPROVAL

REF : 20090814-C

PAGE: 1

PROD. NAME	SHIELDED SMD POWER INDUCTOR	ABC'S DWG NO.	SS7045□□□□L□-□□□
		ABC'S ITEM NO.	

I . MECHANICAL DIMENSIONS :

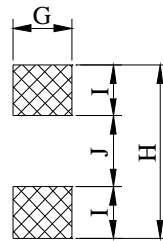
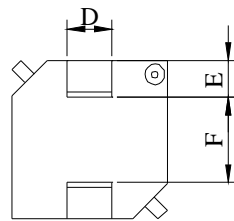
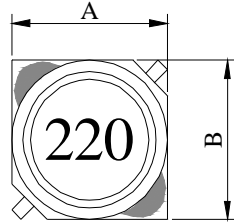

(PCB Pattern)

- A : 7.00±0.3 m/m
- B : 7.00±0.3 m/m
- C : 4.50±0.3 m/m
- D : 2.00 typ m/m
- E : 1.50 typ. m/m
- F : 4.00 typ. m/m
- G : 2.40 ref. m/m
- H : 7.80 ref. m/m
- I : 1.80 ref. m/m
- J : 4.20 ref. m/m

II . SCHEMATIC DIAGRAM :

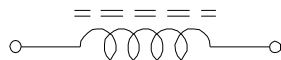

III . MATERIALS LIST :

- a . Core : Ferrite DR core
- b . Core : Ferrite RI core
- c . Wire : Enamelled copper wire (class F)
- d . Terminal : Cu/Ni+Sn
- e . Base : LCP Base
- f . Adhesive : Epoxy resin
- g . Remark : Products comply with RoHS' requirements

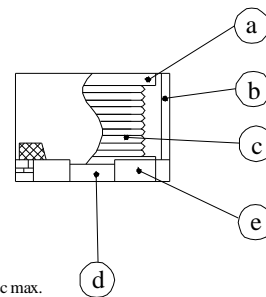

Peak Temp : 260°C max.
 Max time above 230°C : 50sec max.
 Max time above 200°C : 70sec max.

IV . ELECTRICAL CHARACTERISTICS :

- a . Temp. rise : 30°C max.
- b . Storage temp. : -40°C ----+125°C
- c . Operating temp. : -40°C ----+105°C
- d . Resistance to solder heat : 260°C . 10 secs.

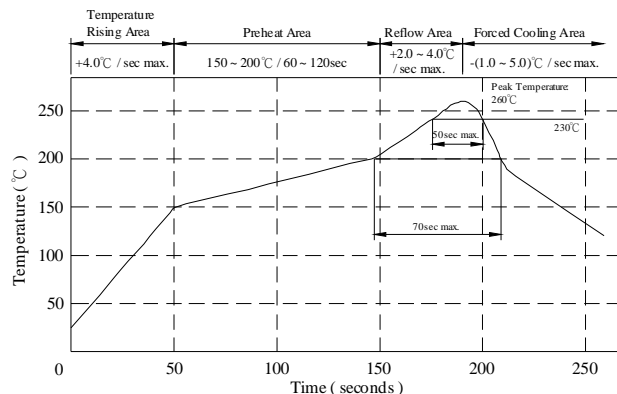

AR-001A

SPECIFICATION FOR APPROVAL

REF : 20090814-C

PAGE: 2

PROD.	SHIELDED SMD	ABC'S DWG NO.	SS7045□□□□L□-□□□
NAME	POWER INDUCTOR	ABC'S ITEM NO.	

V . ELECTRICAL CHARACTERISTICS :

DWG No.	Inductance (uH)	Q ref.	Test Freq. (MHz)	SRF (MHz) typ.	RDC (Ω) max.	Irms (A)	Isat (A)
SS70451R0ML□-□□□	1.0±20%	10	7.96	60	0.020	3.500	4.500
SS70452R2ML□-□□□	2.2±20%	10	7.96	50	0.022	2.800	2.800
SS70453R3ML□-□□□	3.3±20%	12	7.96	45	0.027	2.800	2.600
SS70453R9ML□-□□□	3.9±20%	12	7.96	38	0.030	2.750	2.500
SS70454R7ML□-□□□	4.7±20%	12	7.96	35	0.033	2.600	2.300
SS70455R6ML□-□□□	5.6±20%	12	7.96	35	0.035	2.400	2.200
SS70456R8ML□-□□□	6.8±20%	10	7.96	30	0.036	2.200	2.000
SS70458R2ML□-□□□	8.2±20%	10	7.96	30	0.041	2.100	1.850
SS7045100ML□-□□□	10.0±20%	30	2.52	25	0.042	2.000	1.700
SS7045120ML□-□□□	12.0±20%	27	2.52	23	0.050	1.850	1.700
SS7045150ML□-□□□	15.0±20%	31	2.52	24	0.062	1.600	1.475
SS7045180ML□-□□□	18.0±20%	29	2.52	21	0.070	1.500	1.375
SS7045220ML□-□□□	22.0±20%	26	2.52	18	0.082	1.350	1.000
SS7045270ML□-□□□	27.0±20%	25	2.52	18	0.110	1.250	1.000
SS7045330ML□-□□□	33.0±20%	25	2.52	12	0.115	1.150	0.900
SS7045390ML□-□□□	39.0±20%	26	2.52	13	0.130	1.100	0.800
SS7045470ML□-□□□	47.0±20%	29	2.52	11	0.150	0.950	0.780
SS7045560ML□-□□□	56.0±20%	21	2.52	11	0.200	0.850	0.700
SS7045680ML□-□□□	68.0±20%	22	2.52	10	0.210	0.770	0.600
SS7045820ML□-□□□	82.0±20%	20	2.52	8	0.280	0.700	0.550
SS7045101ML□-□□□	100.0±20%	40	0.796	8	0.300	0.650	0.500
SS7045121ML□-□□□	120.0±20%	30	0.796	7	0.420	0.600	0.500
SS7045151ML□-□□□	150.0±20%	51	0.796	7	0.480	0.530	0.410
SS7045181ML□-□□□	180.0±20%	52	0.796	5	0.660	0.475	0.375
SS7045221ML□-□□□	220.0±20%	44	0.796	5	0.700	0.450	0.360
SS7045271ML□-□□□	270.0±20%	30	0.796	5	0.700	0.425	0.300
SS7045331ML□-□□□	330.0±20%	65	0.796	4	0.730	0.400	0.250
SS7045391ML□-□□□	390.0±20%	27	0.796	5	1.000	0.350	0.230
SS7045471ML□-□□□	470.0±20%	80	0.796	3	1.100	0.320	0.220
SS7045561ML□-□□□	560.0±20%	27	0.796	4	1.600	0.300	0.200
SS7045681ML□-□□□	680.0±20%	65	0.796	3	1.600	0.270	0.200
SS7045821ML□-□□□	820.0±20%	26	0.796	3	2.200	0.260	0.175
SS7045102ML□-□□□	1000.0±20%	90	0.252	3	2.400	0.250	0.150

- 1). □ : Packaging Information... Bulk Taping Reel
- 2). "- □□□":Reference code
- 3). L Test Freq. : 1KHz / 0.5V
- 4). Irms base on Temp. rise 30°C max.
- 5). Isat base on $\Delta L/L0A=10\%$ typ. (1R0M~221M)
Isat base on $\Delta L/L0A=25\%$ typ. (271M~102M)

AR-001A



SPECIFICATION FOR APPROVAL

REF : 20090814-C

PAGE: 3

PROD. NAME	SHIELDED SMD POWER INDUCTOR	ABC'S DWG NO.	SS7045□□□□L□-□□□
		ABC'S ITEM NO.	

V . INDUCTANCE VS. DC CURRENT CURVE :

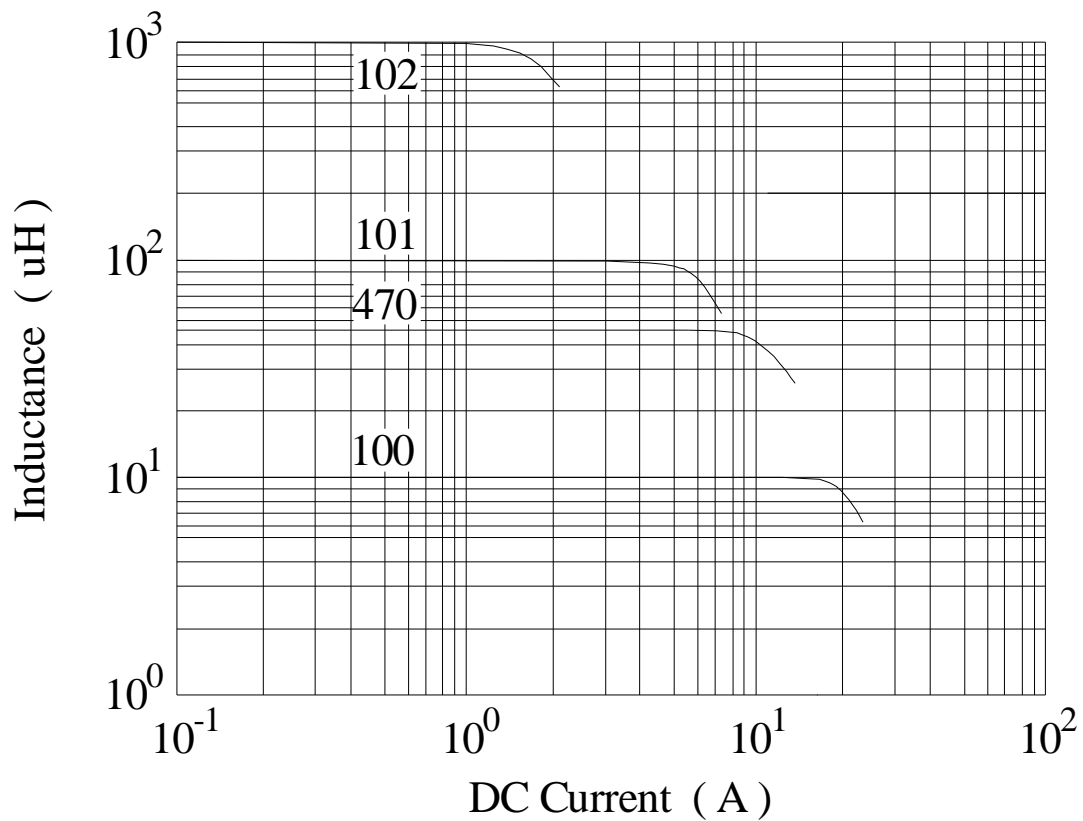

AR-001A

SPECIFICATION FOR APPROVAL

REF : 20090814-C

PAGE: 4

PROD. NAME	SHIELDED SMD POWER INDUCTOR	ABC'S DWG NO.	SS7045□□□□L□-□□□
		ABC'S ITEM NO.	

VI . PACKAGING INFORMATION :

(1) Configuration

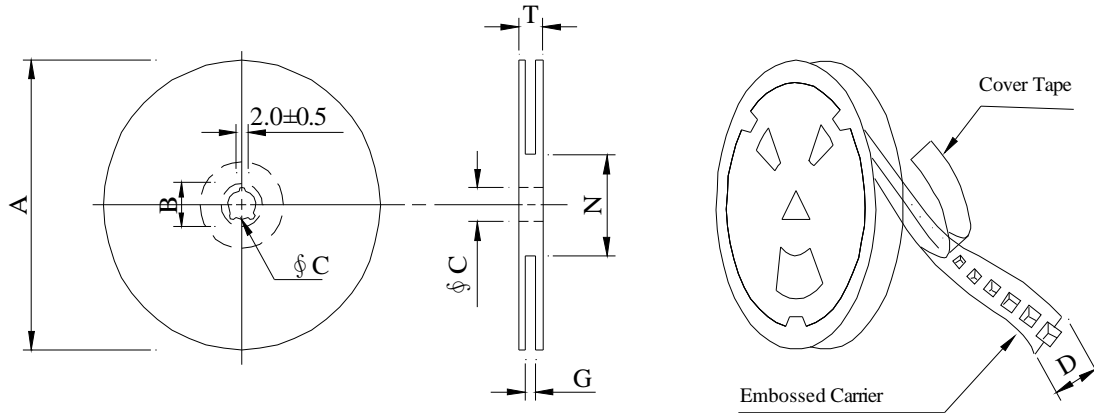

※Carrier Tape Width : D

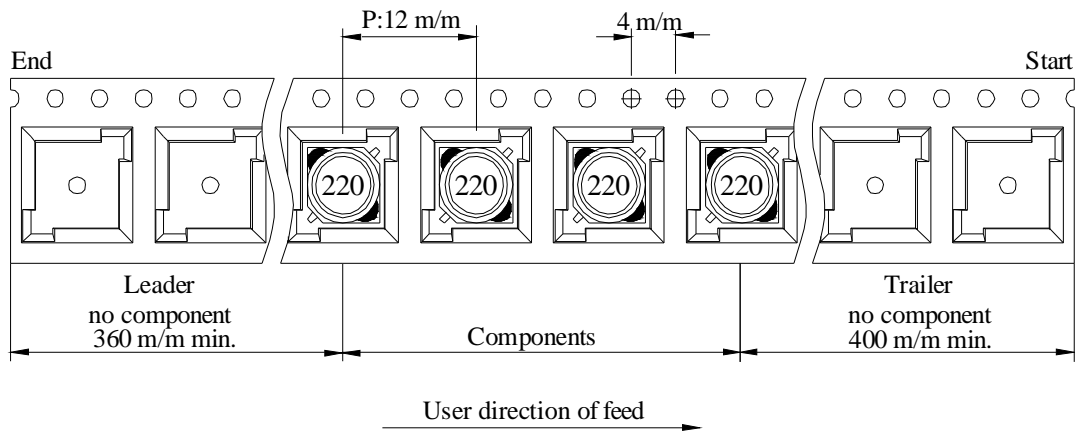

(2) Dimensions

Unit:m/m

STYLE	A	B	C	D	G	N	T
13 - 16	330	21±0.8	13±0.5	16	18 ⁺⁰	50 ⁻⁰	22.4

(3) Q'TY & G.W. Per package

Series	Inner : Reel			Outer : Carton		
	Q'TY (pcs)	G.W. (gw)	Style	Q'TY (pcs)	G.W. (Kg)	Size (cm)
SS7045	1,000	255	13 - 16	6,000	1.84	40 x 40 x 24

AR-001A

SPECIFICATION FOR APPROVAL

REF : 20090814-C

PAGE: 5

PROD. NAME	SHIELDED SMD POWER INDUCTOR	ABC'S DWG NO.	SS7045□□□□L□-□□□
		ABC'S ITEM NO.	

VII . DWGING NUMBER EXPRESSION :

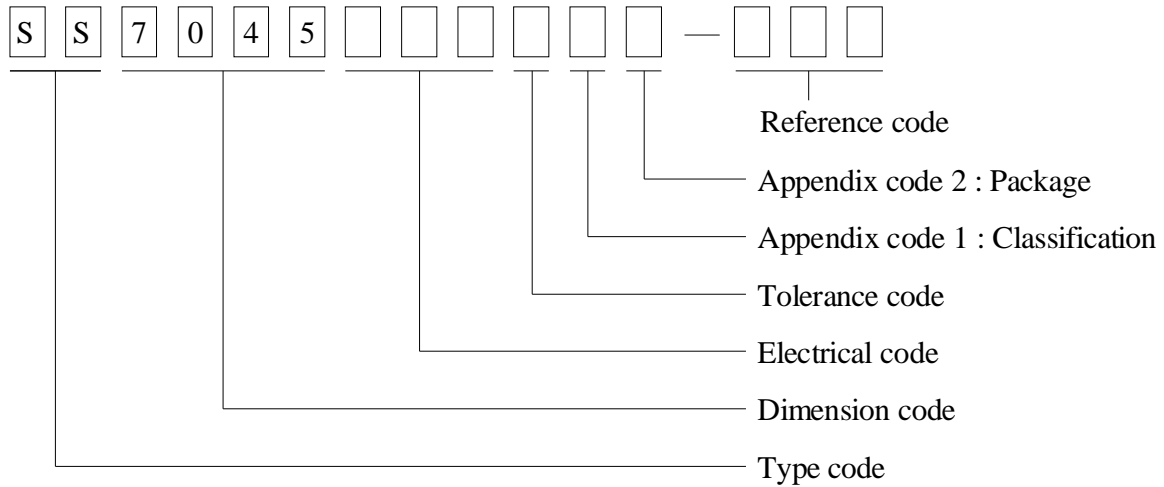

Appendix code 1 : Product Classification

L : Lead Free Standard products comply with RoHS' requirements

1 ~ 9 : Lead Free Special products comply with RoHS' requirements

Appendix code 2 : Package Information

Code	Inner package	Inner package QTY	Remark
A	T.B.D.	T.B.D.	
B	T / R (Reel package)	1000 pcs	

SPECIFICATION FOR APPROVAL

REF : 20090814-C

PAGE: 6

PROD. NAME	SHIELDED SMD POWER INDUCTOR	ABC'S DWG NO. ABC'S ITEM NO.	SS7045□□□□L□-□□□
---------------	--------------------------------	---------------------------------	------------------

VIII . RELIABILITY TEST :

Test item	Specification	Test condition						
Solderability	More than 95% of the terminal electrode shall be covered With fresh solder.	Preheat : 155°C / 4 hours. Solder : Sn96.5 / Ag3 / Cu0.5 or equivalent Solder temp. : 235±5°C Flux : Rosin Dip time : 5±0.5 seconds						
Thermal shock test (Temp. cycle)	Electrical oharacteristics shall not change more than ±20%	<table style="width: 100%; border: none;"> <tr> <td style="text-align: center;">Room temp. 15 minutes</td> <td style="text-align: center;">→</td> <td style="text-align: center;">-40 °C 30 minutes</td> </tr> <tr> <td style="text-align: center;">Room temp. 15 minutes</td> <td style="text-align: center;">→</td> <td style="text-align: center;">+105 °C 30 minutes</td> </tr> </table> <p>Total : 50 cycles</p>	Room temp. 15 minutes	→	-40 °C 30 minutes	Room temp. 15 minutes	→	+105 °C 30 minutes
Room temp. 15 minutes		→	-40 °C 30 minutes					
Room temp. 15 minutes		→	+105 °C 30 minutes					
Humidity Test		Temperature : 40±2°C Humidity : 90±5% Time : 1000 hours						
High temp. Resistance test	Temperature : 105±5°C Applied current : Per spec. Time : 96 hours							

AR-001A



SPECIFICATION FOR APPROVAL

REF : 20090814-C

PAGE: 7

PROD. NAME	SHIELDED SMD POWER INDUCTOR	ABC'S DWG NO.	SS7045□□□□L□-□□□
		ABC'S ITEM NO.	

IX . UL CARD :

OBMW2		September 8, 2000	
Magnet Wire-Component			
JUNG SHING WIRE CO LTD		E174837	
231 CHUNG CHENG RD, SEC 3 JEN-TEH HSIANG, TAINAN HSIEN TAIWAN			
Mtl Dsg	Mark Dsg	BC	Coat Typ
AIW	---	Polyamideimide	---
CFUEWB	---	Polyurethane	---
EIAIW	---	Polyesterimide	Polyamideimide
EILOCKY	---	Polyesterimide	Polyamide
EILOCKW	---	Polyesterimide	Modified Epoxy
EIW	---	Polyesterimide	---
EIW-2	---	Polyesterimide	---
FL.EILOCKY	---	Modified Polyester	Polyamide
LSFFW	---	Polyurethane	---
LSUEW	---	Polyurethane	---
PEW	---	Polyester	---
PEY	---	Polyester	Nylon
SF.FLW	---	Modified Polyester	---
SF.EIW	---	Polyesterimide	---
SF.BY@	---	Modified Polyester	Nylon
SF.FLY@	---	Modified Polyester	Nylon
SF.BLOCKBS	---	Modified Polyester	Modified
SF.EILOCKY#	---	Polyesterimide	Polyamide
SF.EILOCKBS	---	Polyesterimide	Modified
SF.BW@	---	Modified Polyester	Polyamide
SFFW	---	Polyurethane	---
287806002		Page 1 of 2	
		A not-for-profit organization dedicated to public safety and committed to quality service	
Mtl Dsg	Mark Dsg	BC	Coat Typ
SFFY	---	Polyurethane	Polyamide
UEW-1	---	Polyurethane	---
UEW-2	---	Polyurethane	---
UEW-4	---	Polyurethane	---
UEY	---	Polyurethane	Nylon
UEY-2	---	Polyurethane	Polyamide
287806002		Page 2 of 2	
		OBMW2E174837 September 8, 2000	

@-May be suffixed by LZ; # - May be suffixed by LZ, EL or LZL.
 LZ - Signifies magnd wires twisted together; EL - signifies base coated magnet wire laid parallel with top coat applied overall; LZL - signi-
 fies base coated magnet wire twisted together and covered with top coat overall.
 Marking: Company name or trademarks (JSW) or 榮星電線, material designation or marked designation on packaed or reel, and
 Recognized Component Mark.

See General Information Preceding These Recognitions
 For use only in equipment where the acceptability of the combination is determined by Underwriters Laboratories Inc.



SPECIFICATION FOR APPROVAL

REF : 20090814-C

PAGE: 8

PROD. NAME	SHIELDED SMD POWER INDUCTOR	ABC'S DWG NO. ABC'S ITEM NO.	SS7045□□□□L□-□□□
---------------	--------------------------------	---------------------------------	------------------

		SUMITOMO CHEMICAL CO LTD						E54705 (M)				
		5-33 KITAHAMA 4-CHOME CHUO-KO, OSAKA JAPAN										
Mtl Dsg	Col	Min Thk mm	UL94 Flame Class	Elec	RTI		H W I	H A I	H V T R	D 4 9 5	C T I	
					Mech with Imp	w/o Imp						
Liquid crystal polyester (LCP), designated "EKONOL" or "SUMIKASUPER", furnished in the form of pellets, (Contd)												
E4008, E400X	NC, BK	0.30	94V-0	130	130	130	—	—	—	—	—	
		0.75	94V-0	130	130	130	3	4	—	—	—	
		1.5	94V-0	130	130	130	2	4	—	—	—	
		3.0	94V-0	130	130	130	1	4	0	5	4	
E4008	NC, WT, BK	0.30	94V-0	130	130	130	—	—	—	—	—	
		0.75	94V-0	220	180	220	3	4	—	—	—	
		1.5	94V-0	220	200	240	2	4	—	—	—	
		3.0	94V-0	220	200	240	1	4	0	5	4	
E4010	NC, BK	0.30	94V-0	130	130	130	—	—	—	—	—	
		0.75	94V-0	220	180	220	3	4	—	—	—	
		1.5	94V-0	220	200	240	2	4	—	—	—	
		3.0	94V-0	220	200	240	1	4	0	5	4	
E400(Y)L, E4008L	NC, BK	0.30	94V-0	130	130	130	—	—	—	—	—	
		0.75	94V-0	130	130	130	3	4	—	—	—	
		1.5	94V-0	130	130	130	2	4	—	—	—	
		3.0	94V-0	130	130	130	1	4	0	5	4	
E4810	NC, BK	0.30	94V-0	130	130	130	—	—	—	—	—	
		0.75	94V-0	130	130	130	0	4	—	—	—	
		1.5	94V-0	130	130	130	0	4	—	—	—	
		3.0	94V-0	130	130	130	1	4	0	5	4	

(X) Denotes any number 1 thru 9.
(Y) Denotes any number 1 thru 7.

AR-001A

