

# SPECIFICATION FOR APPROVAL

REF :20080804-A

PAGE: 1

PROD. NAME	SHIELDED SMD POWER INDUCTOR	ABC'S DWG NO. ABC'S ITEM NO.	SU3014□□□□L□-□□□
---------------	--------------------------------	---------------------------------	------------------

## I . CONFIGURATION & DIMENSIONS :

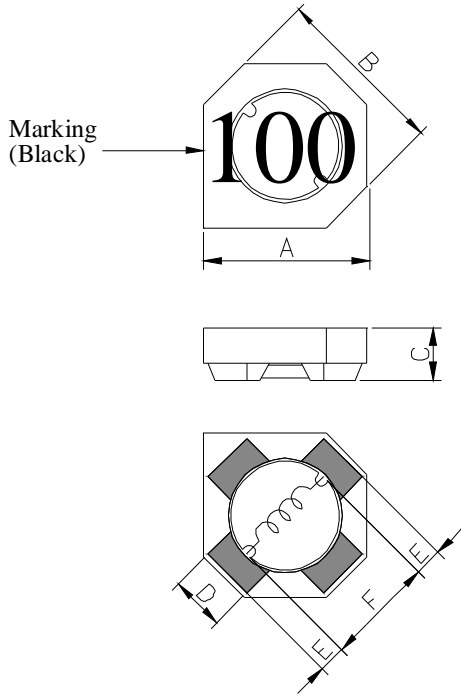

A :	3.30	±0.20	m/m
B :	3.50	±0.20	m/m
C :	1.40	±0.20	m/m
D :	1.10	typ.	m/m
E :	0.50	typ.	m/m
F :	2.30	typ.	m/m
G :	1.30	ref.	m/m
H :	4.20	ref.	m/m
I :	1.20	ref.	m/m
J :	1.80	ref.	m/m

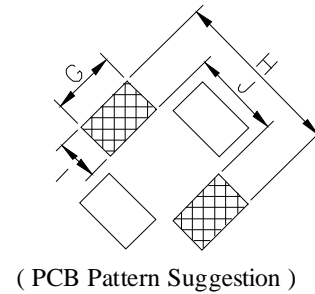

## II . SCHEMATIC DIAGRAM :

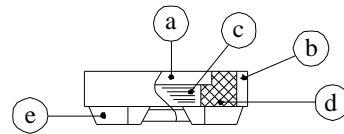

## III . MATERIALS :

- a . Core : Ferrite DR core
- b . Core : Ferrite RI core
- c . Wire : Enamelled copper wire (class F & H)
- d . Adhesive : Epoxy resin
- e . Terminal : Ag/Ni/Sn
- f . Remark : Products comply with RoHS' requirements

Peak Temp : 260°C max.  
Max time above 230°C : 50sec max.  
Max time above 200°C : 70sec max.

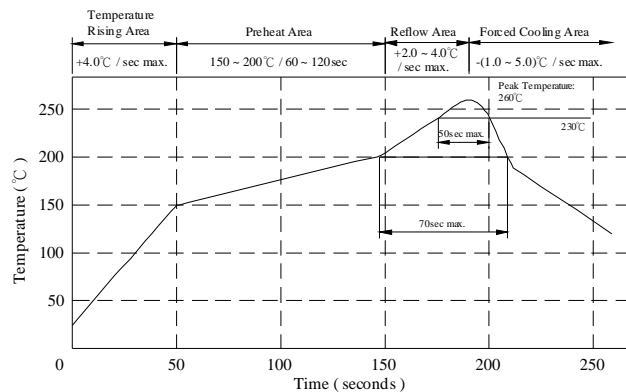

## IV . GENERAL SPECIFICATION :

- a . Temp. rise : 40°C typ.
- b . Rated current :  
Base on temp. rise &  $\Delta L / LOA=35\%$  typ.
- c . Storage temp. : -40°C ----+125°C
- d . Operating temp. : -40°C ----+105°C
- e . Resistance to solder heat : 260°C.10 secs.

AR-001A

# SPECIFICATION FOR APPROVAL

REF: 20080804-A

PAGE: 2

PROD. NAME	SHIELDED SMD POWER INDUCTOR	ABC'S DWG NO.	SU3014□□□□L□-□□□
		ABC'S ITEM NO.	

### V . ELECTRICAL CHARACTERISTICS :

DWG No.	Inductance ( $\mu$ H)	Q ref.	Test Freq. ( Hz )		RDC ( m $\Omega$ )		SRF ( MHz )	Irms ( mA )	Isat ( mA )
			L	Q	typ.	max.	typ.	typ.	typ.
SU30141R2YL□-□□□	1.2 $\pm$ 30 %	12.0	100K	7.96M	38	55	150	1850	1900
SU30141R5YL□-□□□	1.5 $\pm$ 30 %	12.0	100K	7.96M	51	63	120	1550	1600
SU30142R0YL□-□□□	2.0 $\pm$ 30 %	10.0	100K	7.96M	75	95	110	1100	1300
SU30143R0YL□-□□□	3.0 $\pm$ 30 %	12.0	100K	7.96M	95	135	80	1000	1100
SU30144R7YL□-□□□	4.7 $\pm$ 30 %	15.0	100K	7.96M	130	165	70	820	920
SU30146R8YL□-□□□	6.8 $\pm$ 30 %	10.0	100K	7.96M	180	230	50	700	780
SU3014100YL□-□□□	10.0 $\pm$ 30 %	30.0	100K	2.52M	235	290	40	640	660
SU3014150YL□-□□□	15.0 $\pm$ 30 %	35.0	100K	2.52M	440	550	30	400	460
SU3014220YL□-□□□	22.0 $\pm$ 30 %	35.0	100K	2.52M	700	875	25	320	360

- 1) . □ : Packaging Information... **A** : Bulk **B** : Taping Reel
- 2) . "-□□□":Reference code
- 3) . Inductance Test Freq. : 100KHz / 0.1V
- 4) . Irms base on Temp. rise 40°C typ.
- 5) . Isat base on  $\Delta$ L / LOA=35% typ.

@ Inductance VS. DC Current Curve :

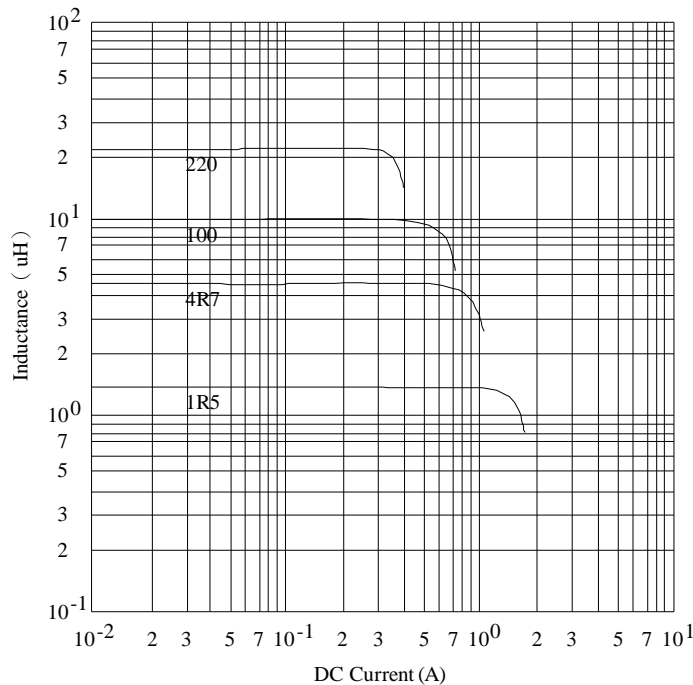

AR-001A



# SPECIFICATION FOR APPROVAL

REF : 20080804-A

PAGE: 3

PROD. NAME	SHIELDED SMD POWER INDUCTOR	ABC'S DWG NO.	SU3014□□□□L□-□□□
		ABC'S ITEM NO.	

## VI . PACKAGING INFORMATION :

### ( 1 ) Configuration

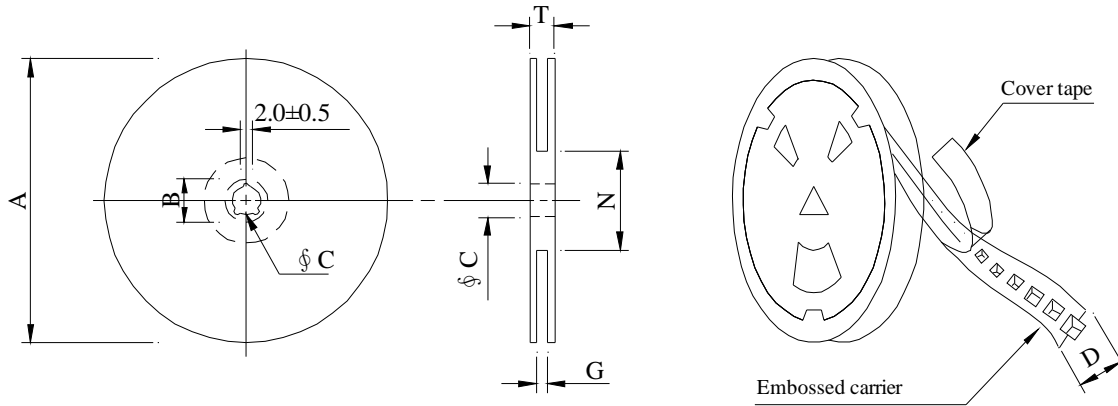

※Carrier tape width : D

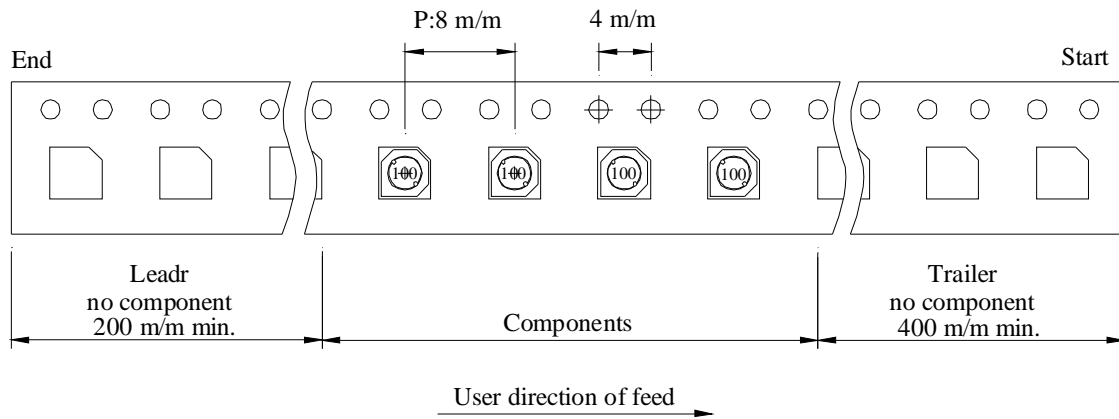

### ( 2 ) Dimensions

Unit:m/m

Style	A	B	C	D	G	N	T
07 - 12	178	21±0.8	13	12	14 +0	50 -0	16.5

### ( 3 ) Q'TY & G.W. Per package

Series	Inner : Reel			Outer : Carton		
	Q'TY (pcs)	G.W. (gw)	Style	Q'TY (pcs)	G.W. (Kg)	Size (cm)
SU3014	1,200	150	07 - 12	48,000	8.50	42 x 41 x 24

AR-001A



# SPECIFICATION FOR APPROVAL

REF : 20080804-A

PAGE: 4

PROD. NAME	SHIELDED SMD POWER INDUCTOR	ABC'S DWG NO.	SU3014□□□□L□-□□□
		ABC'S ITEM NO.	

## VII . DWGING NUMBER EXPRESSION :

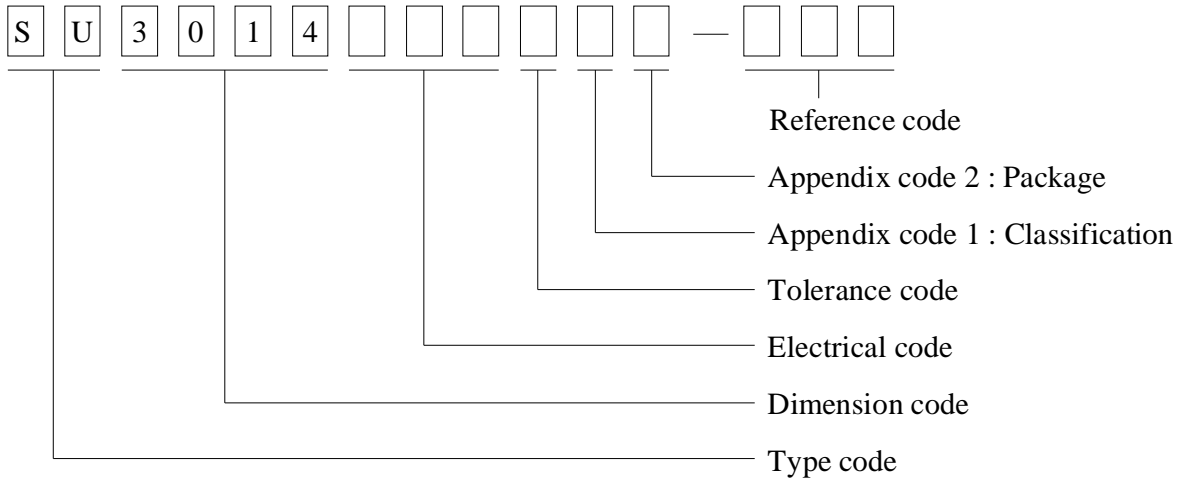

### Appendix code 1 : Product Classification

L : Lead Free Standard products comply with RoHS' requirements

1 ~ 9 : Lead Free Special products comply with RoHS' requirements

### Appendix code 2 : Package Information

Code	Inner package	Inner package Q'TY	Remark
A	T.B.D.	T.B.D.	
B	T / R ( Reel package )	1,200 pcs	

# SPECIFICATION FOR APPROVAL

REF : 20080804-A

PAGE: 5

PROD. NAME	SHIELDED SMD POWER INDUCTOR	ABC'S DWG NO.	SU3014□□□□L□-□□□
		ABC'S ITEM NO.	

**VIII . RELIABILITY TEST :**

Test item	Specification	Test condition						
Solderability	More than 95% of the terminal electrode shall be covered With fresh solder.	Preheat : 155°C / 4 hours. Solder : Sn96.5 / Ag3 / Cu0.5 or equivalent Solder temp. : 235±5°C Flux : Rosin Dip time : 5±0.5 seconds						
Thermal shock test ( Temp. cycle )	Electrical oharacteristics shall not change more than ±20%	<table style="width: 100%; border: none;"> <tr> <td style="text-align: center;">Room temp. 15 minutes</td> <td style="text-align: center;">→</td> <td style="text-align: center;">-40 °C 30 minutes</td> </tr> <tr> <td style="text-align: center;">Room temp. 15 minutes</td> <td style="text-align: center;">→</td> <td style="text-align: center;">+105 °C 30 minutes</td> </tr> </table> <p>Total : 50 cycles</p>	Room temp. 15 minutes	→	-40 °C 30 minutes	Room temp. 15 minutes	→	+105 °C 30 minutes
Room temp. 15 minutes		→	-40 °C 30 minutes					
Room temp. 15 minutes		→	+105 °C 30 minutes					
Humidity test		Temperature : 40±2°C Humidity : 90±5% Time : 1000 hours						
High temp. Resistance test	Temperature : 105±5°C Applied current : Per spec. Time : 96 hours							

AR-001A



# SPECIFICATION FOR APPROVAL

REF : 20080804-A

PAGE: 6

PROD. NAME	SHIELDED SMD POWER INDUCTOR	ABC'S DWG NO.	SU3014□□□□L□-□□□
		ABC'S ITEM NO.	

## IX . UL CARD :

OBMW2		September 8, 2000			
Magnet Wire-Component					
JUNG SHING WIRE CO LTD				E174837	
231 CHUNG CHENG RD, SEC 3 JEN-TEH HSIANG, TAINAN					
HSIEN TAIWAN					
Mtl Dsg	Mark Dsg	BC	Coat Typ	ANSI Type	Temp Class
AIW	—	Polyamideimide	OC	MW81-C	220
CFUEWB	—	Polyurethane	—	MW75C	130
EIAIW	—	Polyesterimide	Polyamideimide	MW35C	200
EILOCKY	—	Polyesterimide	Polyamide	—	180
EILOCKW	—	Polyesterimide	Modified Epoxy	—	200
EIW	—	Polyesterimide	—	—	220
EIW-2	—	Polyesterimide	—	MW74-C	200
FL.EILOCKY	—	Modified Polyester	Polyamide	—	155
LSFFW	—	Polyurethane	—	MW79-C	155
LSUEW	—	Polyurethane	—	—	130
PEW	—	Polyester	—	—	155
PEY	—	Polyester	Nylon	MW24-C	155
SF.FLW	—	Modified Polyester	—	MW26C	155
SF.EIW	—	<b>Polyesterimide</b>	—	MW77C	180
SF.BY@	—	Modified Polyester	Nylon	MW27-C	155
SF.FLY@	—	Modified Polyester	Nylon	MW27-C	155
SF.BLOCKBS	—	Modified Polyester	Modified Polyamide	—	155
SF.EILOCKY#	—	Polyesterimide	Polyamide	—	180
SF.EILOCKBS	—	Polyesterimide	Modified Polyamide	—	180
SF.BW@	—	Modified Polyester	—	MW26C	155
SFFW	—	Polyurethane	—	MW79	155
287806002		Page 1 of 2			
A not-for-profit organization dedicated to public safety and committed to quality service					
Mtl Dsg	Mark Dsg	BC	Coat Typ	ANSI Type	Temp Class
SFFY	—	Polyurethane	Polyamide	MW80C	155
UEW-1	—	Polyurethane	—	MW2-C	105
UEW-2	—	Polyurethane	—	—	130
UEW-4	—	Polyurethane	—	MW75C	130
UEY	—	Polyurethane	Nylon	MW28-C	130
UEY-2	—	Polyurethane	Polyamide	MW28-C	130
@-May be suffixed by LZ; # - May be suffixed by LZ, EL or LZL.					
LZ - Signifies magned wires twisted together; EL - signifies base coated magnet wire laid parallel with top coat applied overall; LZL - signifies base coated magnet wire twisted together and covered with top coat overall.					
Marking: Company name or trademarks <b>JSW</b> or 榮星電線, material designation or marked designation on packaed or reel, and Recognized Component Mark.					
See General Information Preceding These Recognitions					
For use only in equipment where the acceptability of the combination is determined by Underwriters Laboratories Inc.					
287806002		Page 2 of 2			OBMW2E174837
September 8, 2000					

AR-001A



# SPECIFICATION FOR APPROVAL

REF :20080804-A

PAGE: 7

PROD. NAME	SHIELDED SMD POWER INDUCTOR	ABC'S DWG NO. ABC'S ITEM NO.	SU3014□□□□L□-□□□
---------------	--------------------------------	---------------------------------	------------------

**IX . UL CARD :**

OBMW2 August 27, 1999  
Magnet Wire-Component

ELEKTRISOLA (MALAYSIA) SDN BHD E143312  
IALAN DAMN SATU IANDA BAIK 28750 BENTONG, PAHANG  
DARUL MAKMUR MALAYSIA

Mtl Dsg	Mark Dsg	Coating Type		ANSI Typ	Temp Class
		BC	OC		
Estersol 160	E180	Polyesterimide (solderable)	—	MW-77	180
Amldester 200	A200	Polyesterimide	—	MW-74	200
Polysol-N 155	PN155	Polyurethane	Nylon	MW-80, MW-28	155, 100
Polysol 155	P155	Polyurethane	—	MW-79, MW-79	155, 130
Polysol 155g	Pg155	Polyurethane	—	MW-79	130
Polysol 155p	Pp155,Gp155	Polyurethane	—	MW-79	155
Polysol 160	P160	Polyurethane	—	MW-79	155
Polysol 180	P180	Polyurethane	—	MW-79	155
Polysol 170	P170 or G170	Polyurethane	—	MW-79	156
Polysol-N 180	PN180	Polyurethane	Nylon	—	180

Marking : Company name/material designation or marked designation and factory identification on package ok reel

---

See General Information preceding These Recognitions  
For use only in equipment where the acceptability of the combination is determined by Underwriters Laboratories Inc.