



# TAI-SAW TECHNOLOGY CO., LTD.

No. 3, Industrial 2nd Rd., Ping-Chen Industrial District,  
Taoyuan, 324, Taiwan, R.O.C.

TEL: 886-3-4690038 FAX: 886-3-4697532

E-mail: [tstsales@mail.taisaw.com](mailto:tstsales@mail.taisaw.com) Web: [www.taisaw.com](http://www.taisaw.com)

## Approval Sheet For Product Specification

Issued Date:

Product Name: SAW Filter 860.5MHz SMD 3.0x3.0mm

TST Parts No.:TA0328A

Customer Parts No.: \_\_\_\_\_

Company: _____
Division: _____
Approved by : _____
Date: _____

Checked by: \_\_\_\_\_ Elvis Chiu

Approval by: \_\_\_\_\_ Francis Chen

Date: \_\_\_\_\_ 2003/01/07



# TAI-SAW TECHNOLOGY CO., LTD.

No. 3, Industrial 2nd Rd., Ping-Chen Industrial District,  
Taoyuan, 324, Taiwan, R.O.C.

TEL: 886-3-4690038 FAX: 886-3-4697532

E-mail: [tstsales@mail.taisaw.com](mailto:tstsales@mail.taisaw.com) Web: [www.taisaw.com](http://www.taisaw.com)

## SAW Filter 860.5 MHz

MODEL NO.: TA0328A

REV. NO.:1

### A. MAXIMUM RATING:

1. Input Power Level: 10 dB<sub>m</sub>
2. DC voltage: 3 V
3. Operating Temperature: -30°C to +70°C
4. Storage Temperature: -40°C to +85°C

RoHS Compliant  
Lead free  
Lead-free soldering

### B. ELECTRICAL CHARACTERISTICS:

Item	Unit	Min.	Typical	Max.
<b>Center frequency</b> <span style="float:right">Fc</span>	MHz	-	860.5	-
<b>Insertion loss</b> 851 ~ 870 MHz <span style="float:right">IL</span>	dB	-	2.2	3.0
<b>Amplitude ripple</b> 851 ~ 870 MHz	dB	-	0.6	1.3
<b>Group delay ripple</b> 851 ~ 870 MHz	ns	-	12	60
<b>Attenuation</b> (Reference level from 0 dB)				
0.000~806.000MHz	dB	27	54	-
806.000~825.000MHz	dB	37	54	-
896.000~902.000MHz	dB	25	31	-
905.825~924.825MHz	dB	27	40	-
960.650~979.650MHz	dB	37	65	-
1070.300~1089.300MHz	dB	47	65	-
1089.300~3000.000MHz	dB	24	28	-
<b>Return loss</b> 851 ~870 MHz		9.5	13	-
<b>Source impedance</b> <span style="float:right">Zs</span>	Ω	-	50	-
<b>Load impedance</b> <span style="float:right">ZL</span>	Ω	-	50	-

Note1. No matching network required for operation at 50 Ω

### C. Frequency Characteristics :

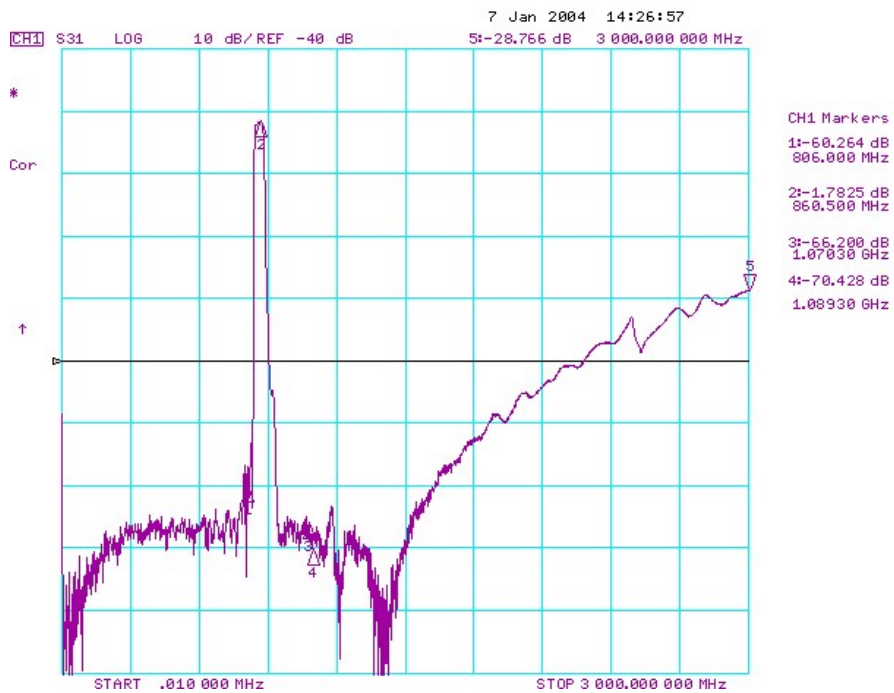
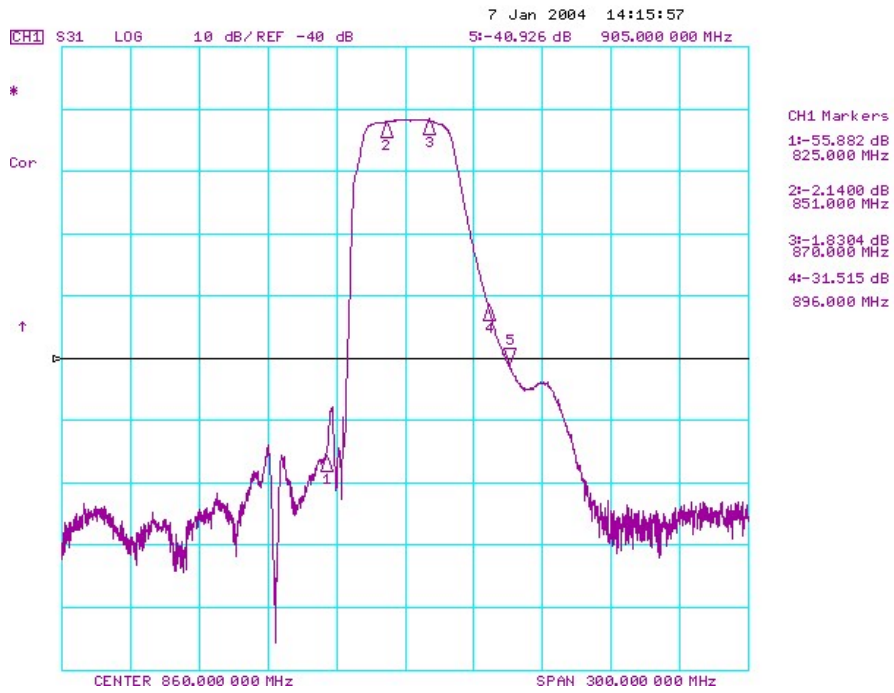

## D.Reflections Functions :

S11:

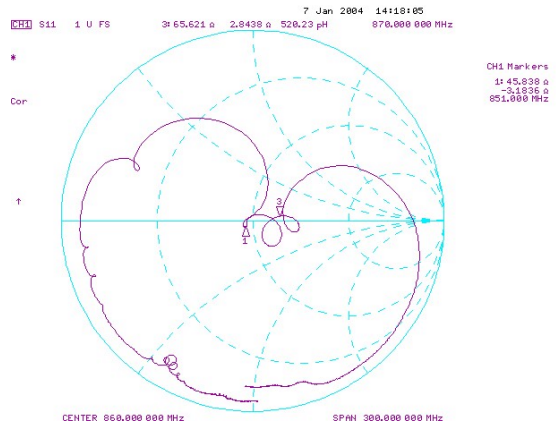
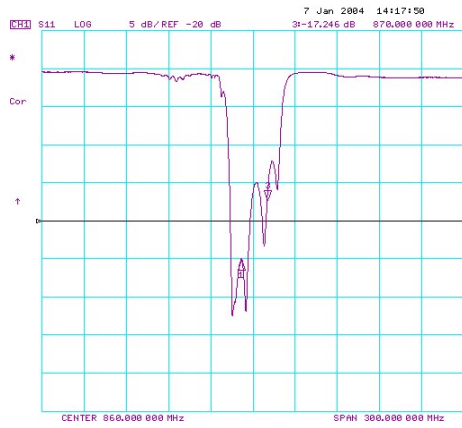

S22:

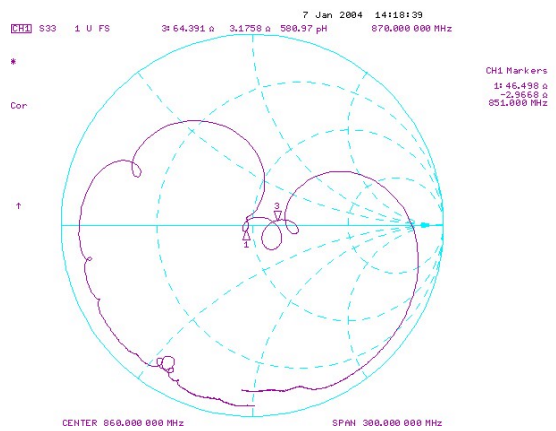
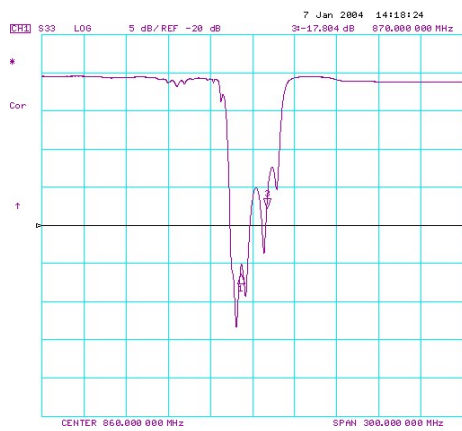

**E. MEASUREMENT CIRCUIT:**

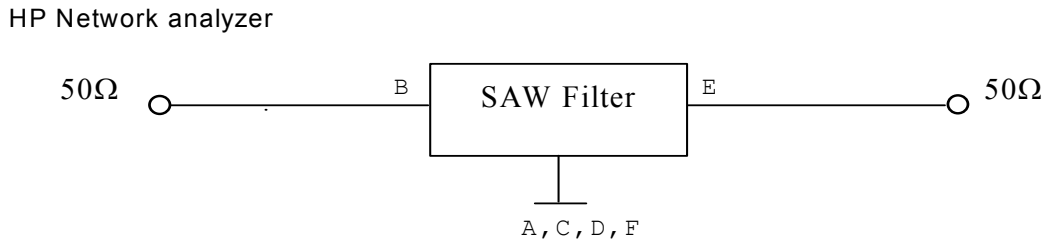

**E.OUTLINE DRAWING:**

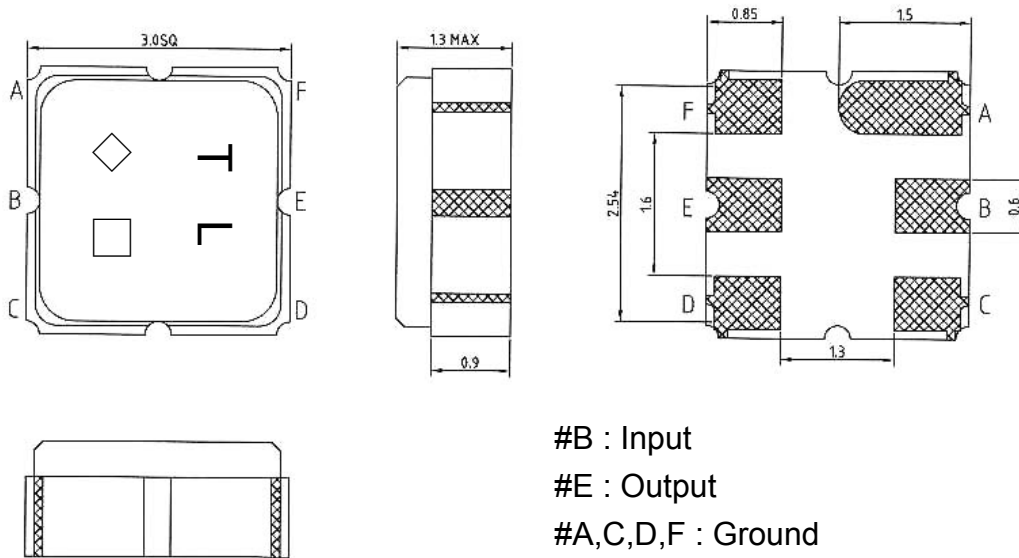

## F. PACKING:

### 1. REEL DIMENSION

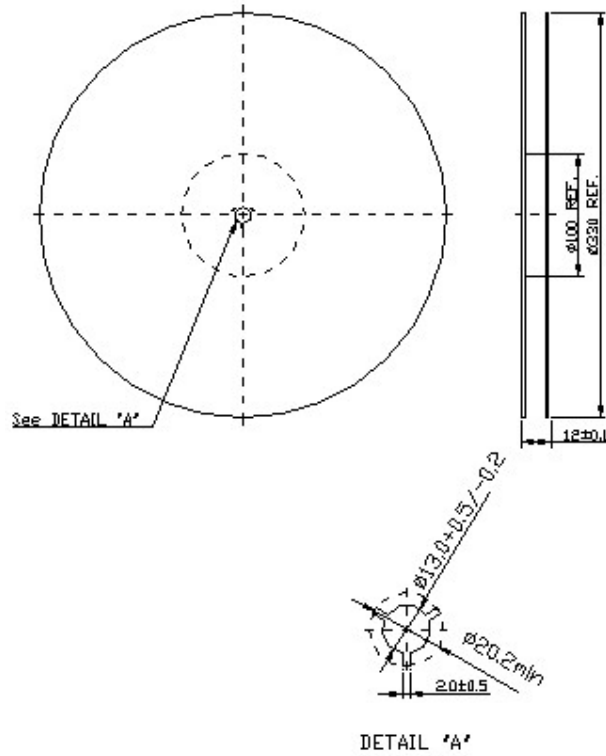

### 2. TAPE DIMENSION

