



# SWE61900(6V190AH)



### Specifications

|                               |              |                       |
|-------------------------------|--------------|-----------------------|
| Nominal Voltage               |              | 6V                    |
| Rated capacity (10 hour rate) |              | 190 Ah                |
| Dimensions                    | Total Height | 228 mm (8.97 inches)  |
|                               | Height       | 223 mm (8.77 inches)  |
|                               | Length       | 306 mm (12.04 inches) |
|                               | Width        | 169 mm (6.63 inches)  |
| Weight Approx                 |              | 28 Kg (61.88 lbs)     |

### Characteristics

|  |   |   |
|--|---|---|
| Capacity<br>25°C(77°F)                               | 10 hour rate(19A)<br>5 hour rate(30.4A)<br>1 hour rate(114 A)                                       | 190 AH<br>152 AH<br>114 AH                                    |
| Internal Resistance                                  | Full charged Battery at 25°C(77°F)  | Approx<br>1.2 mΩ  |
| Capacity affected<br>by Temperature<br>(10hour rate) | 40°C(104°F)<br>25°C(77°F)<br>0°C(32°F)<br>-15°C(5°F)  | 102%<br>100%<br>85%<br>65%                                    |
| Self-Discharge<br>at 25°C(77°F)                      | Capacity after 3 month storage<br>Capacity after 6 month storage<br>Capacity after 12 month storage | 91%<br>82%<br>64%   |
| Terminal   | T19   |   |
| Charge<br>(constant<br>Voltage)                      | Cycle   | Initial Charging Current less than 76 A<br>Voltage 7.05-7.20V |
|  | Float   | Voltage 6.75-6.90V  |

### Outer dimensions (mm)

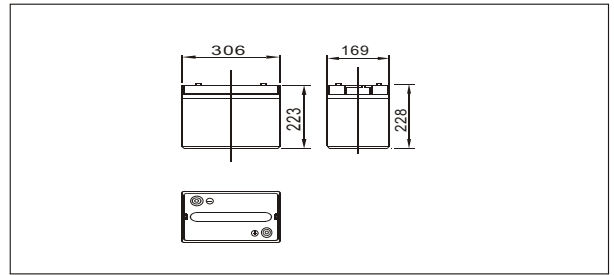

### Terminal Type (mm)

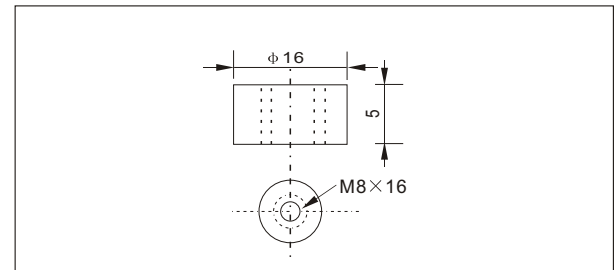

### Curves of cycle life(25°C)

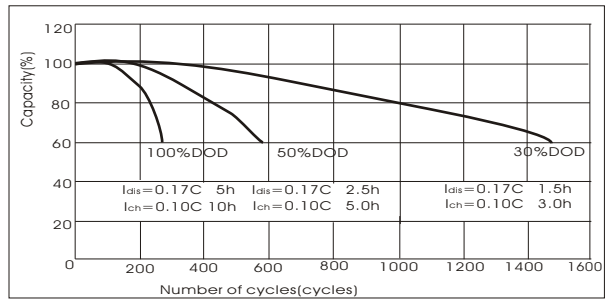

### Discharge Curves 25°C(77°F)

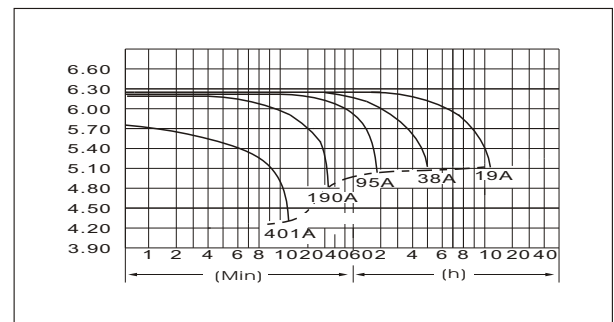

**Constant Current(Amp) and Constant Power(Watt) Discharge Table at 25°C(77°F)**

| Time  |   | 5min | 10min | 15min | 30min | 1h  | 2h  | 3h  | 4h  | 5h  | 8h  | 10h | 20h |
|-------|---|------|-------|-------|-------|-----|-----|-----|-----|-----|-----|-----|-----|
| 4.80V | A | 609  | 401   | 323   | 217   | 114 | 67  | 49  | 38  | 31  | 22  | 20  | 11  |
|       | W | 3140 | 2141  | 1733  | 1164  | 616 | 365 | 272 | 214 | 178 | 127 | 115 | 63  |
| 5.10V | A | 589  | 362   | 304   | 207   | 107 | 63  | 48  | 37  | 31  | 22  | 20  | 10  |
|       | W | 3147 | 2020  | 1703  | 1162  | 606 | 366 | 275 | 215 | 179 | 127 | 115 | 61  |
| 5.25V | A | 570  | 324   | 266   | 194   | 104 | 62  | 46  | 36  | 30  | 21  | 19  | 10  |
|       | W | 3113 | 1840  | 1519  | 1115  | 601 | 359 | 270 | 213 | 178 | 126 | 114 | 62  |
| 5.40V | A | 549  | 305   | 247   | 179   | 100 | 60  | 45  | 36  | 30  | 21  | 19  | 10  |
|       | W | 3083 | 1758  | 1425  | 1035  | 584 | 354 | 267 | 212 | 175 | 124 | 113 | 61  |
| 5.55V | A | 531  | 286   | 228   | 160   | 97  | 59  | 44  | 35  | 29  | 20  | 18  | 10  |
|       | W | 3011 | 1655  | 1329  | 934   | 570 | 348 | 260 | 208 | 172 | 122 | 109 | 59  |