

PLEASE CHECK WWW.MOLEX.COM FOR LATEST PART INFORMATION

Part Number: [0190430009](#)
Status: **Active**
Description: Double Male / Single Female Quick Disconnect Adapter, .187 x .020 Tab Size, Non-Plated

Documents:

[Drawing \(PDF\)](#) [RoHS Certificate of Compliance \(PDF\)](#)

General

Product Family	Quick Disconnects
Series	19043
Crimp Quality Equipment	Yes
Product Name	Adapter
Type	Quick Disconnect

Physical

Barrel Type	N/A
Gender	Dual
Glow-Wire Compliant	No
Insulation	None
Lock to Mating Part	None
Material - Plating Mating	Tin
Material - Plating Termination	Tin
Orientation	Straight
Packaging Type	Bag
Plating min: Mating (µin)	100
Plating min: Mating (µm)	2.5
Plating min: Termination (µin)	100
Plating min: Termination (µm)	2.5
Tab Thickness	0.51mm (.020")
Tab Width	4.75mm (.187")
Termination Interface: Style	N/A
Wire Insulation Diameter	N/A
Wire Size AWG	N/A

Electrical

Voltage - Maximum	N/A
-------------------	-----

Material Info

Old Part Number	MMFA-187
-----------------	----------

Reference - Drawing Numbers

Sales Drawing	SD-19043-002
---------------	--------------

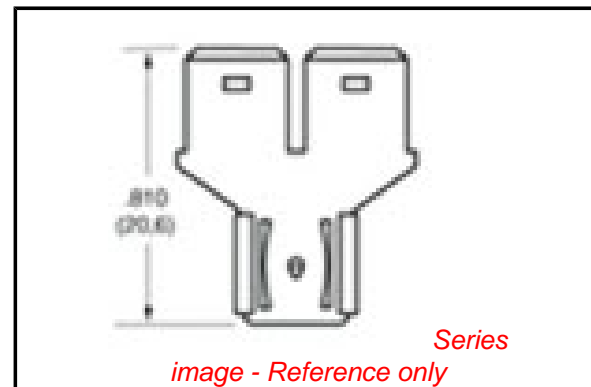

EU RoHS

ELV and RoHS Compliant
REACH SVHC
 Not Reviewed
Halogen-Free Status
 Not Reviewed

China RoHS



Need more information on product environmental compliance?

Email productcompliance@molex.com
 For a multiple part number RoHS Certificate of Compliance, [click here](#)

Please visit the [Contact Us](#) section for any non-product compliance questions.

Search Parts in this Series
[19043Series](#)

6	5	4	3	2	SD-19043-002
MATERIAL NUMBER	ENGINEERING NUMBER	PLATING	CARRIER		
I90430009	MMFA-187	TIN PLATED	LOOSE PIECE		

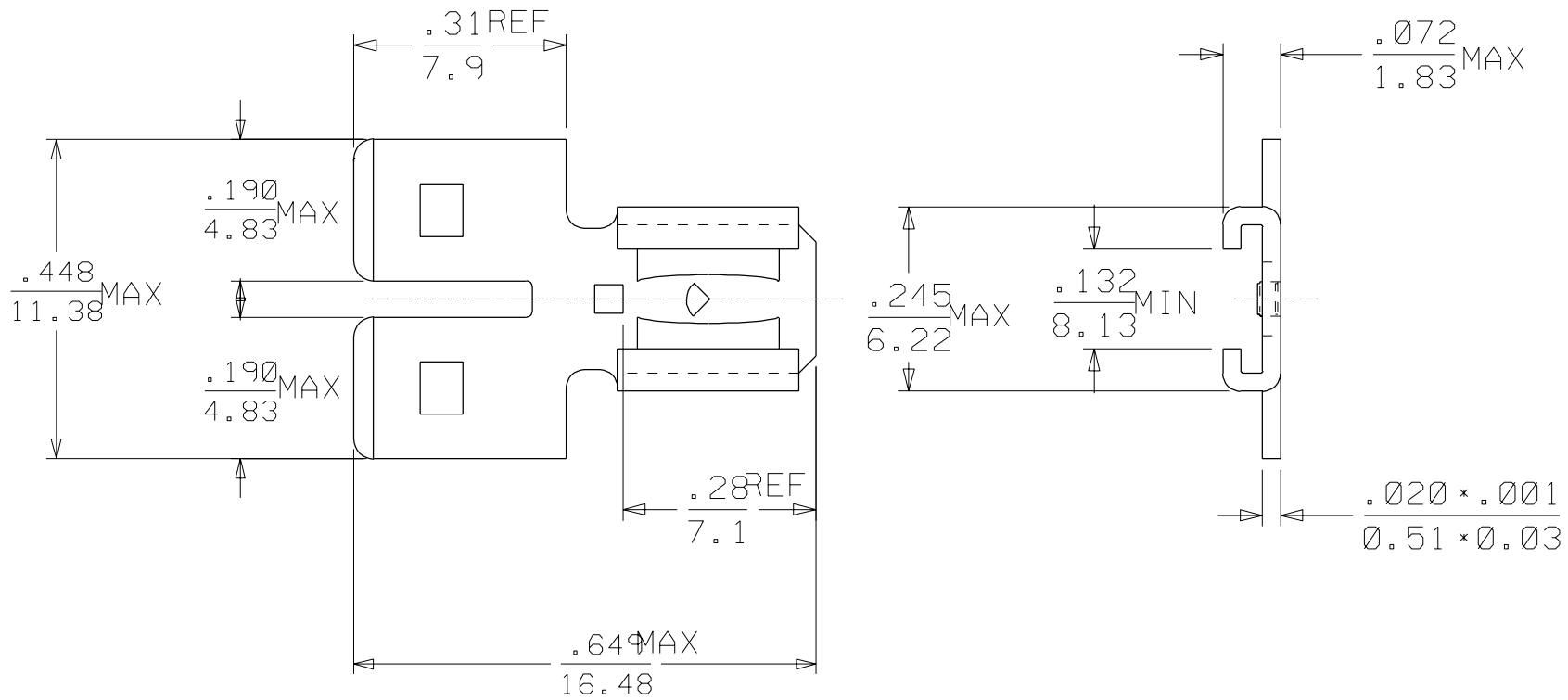

SALES DRAWING

NOTES:
 1. MATERIAL: BRASS
 2. PLATING SEE CHART.

REL TO PRODUCTION EC NO.: ETC2002-0055 DRWN: BRE 01/09/18 CHK: HEB 01/09/18 APPR: RWD 01/09/18	DESCRIPTION MAJOR ▲ = 0 CRITICAL ▽ = 0	GENERAL TOLERANCES: (UNLESS SPECIFIED)		SCALE 4:1	DESIGN UNITS <input type="checkbox"/> mm <input checked="" type="checkbox"/> INCH	THIRD ANGLE PROJECTION <input type="checkbox"/> mm INCH <input checked="" type="checkbox"/> mm <input type="checkbox"/> ONLY	SHT	REV	
		4 PLACES	±0.	±.	DRAWN BY & DATE BRE 01/08/24	TITLE: DBL MALE/SINGLE FEMALE QUICK DISCONNECT .187 X .020 TAB SIZE			
		3 PLACES	±0.	±.005	CHECKED BY & DATE HEB 01/08/24	MOLEX INCORPORATED			
		2 PLACES	±0.13	±.01	APPROVED BY & DATE RWD 01/08/24	CAD FILENAME SD-19043-002.DGN	MATERIAL NO. SEE CHART	DRAWING NO. SD-19043-002	SHEET NO. 1 OF 1
1 PLACE	±0.25	±.	ANGULAR: ± 1/2 °	THIS DRAWING CONTAINS INFORMATION THAT IS PROPRIETARY TO MOLEX INCORPORATED AND SHOULD NOT BE USED WITHOUT WRITTEN PERMISSION.				SIZE A	
B	REV	DRAFT WHERE APPLICABLE MUST REMAIN WITHIN DIMENSIONS							