

## Screw Terminal Type

Series:GNH

# Discontinued



- Features    Endurance :105°C 2000 h  
                  High-voltage and large-capacitance
- Recommended Applications  
                  For general-purpose inverter, power supply for  
                  non-power failure, motor-control inverter

Japan  
U.S.A.

### Specifications

Category temp. range	-25 to + 105°C	
Rated W.V. Range	160 to 400 V .DC	
Nominal Cap. Range	390 to 22000 μF	
Capacitance Tolerance	-10 to +30% (120Hz/+20°C)	
DC Leakage Current	3√CV (μA) max.after 5 minutes application of rated working voltage at +20°C C:Capacitance(μF) V: W.V. (V.DC)	
Dissipation Factor	Please see the attached standard products list	
Endurance	After 2000 hours application of DC voltage with specified ripple current (≤ rated DC working voltage ) at +105°C, the capacitor shall meet the following limits.	
	Capacitance change	±20% of initial measured value
	D.F.	≤ 150 % of initial specified value
Shelf Life	After storage for 1000hours at +105±2 °C with no voltage applied and then being stabilized at +20 °C, capacitors shall meet the limits specified in "Endurance".(With voltage treatment)	

### Frequency Correction Factor for Ripple Current

W.V.(V)	φD(mm)	Freq.(Hz)	50	60	120	300	360	1k	10k to
160, 200	36	50	0.80	0.86	1.00	1.07	1.08	1.12	1.17
		60	0.86	0.91	1.00	1.05	1.06	1.08	1.10
		90	0.90	0.95	1.00	1.05	1.06	1.08	1.10
250, 350	36	50	0.71	0.79	1.00	1.09	1.10	1.15	1.21
		60	0.83	0.88	1.00	1.07	1.08	1.13	1.20
		90	0.85	0.90	1.00	1.05	1.06	1.11	1.20
400	36	50	0.65	0.74	1.00	1.09	1.10	1.16	1.22
		60	0.81	0.87	1.00	1.07	1.08	1.13	1.21
		90	0.85	0.90	1.00	1.05	1.06	1.11	1.20

### Dimensions in mm(not to scale)

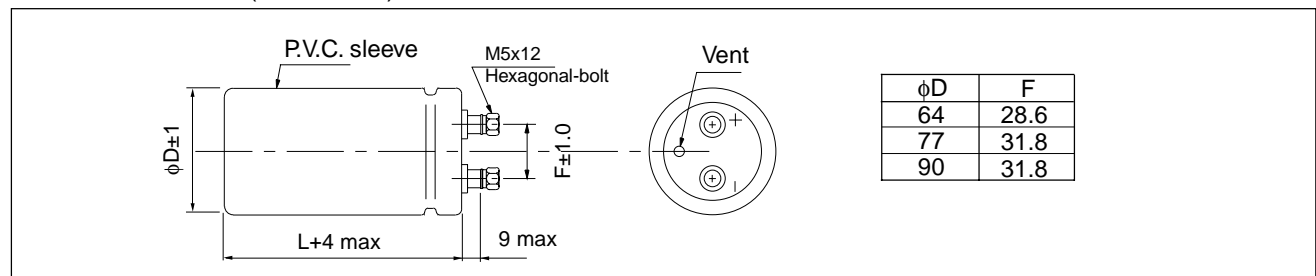

### Mounting clamp

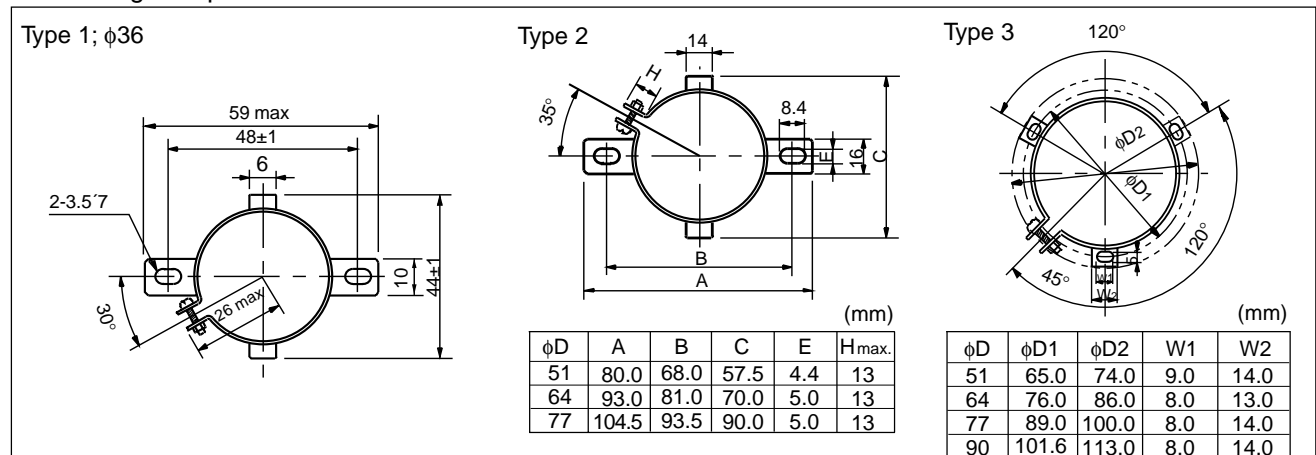

Design, Specifications are subject to change without notice. Ask factory for technical specifications before purchase and/or use. Whenever a doubt about safety arises from this product, please inform us immediately for technical consultation without fail.

Discontinued

■ Standard Products

W.V. (V)	Cap. (10 to +30%) (μF)	Case size		Specification		Terminal Pitch (mm)	Part No.	(:) Mounting Clamp		
		Dia. (mm)	Length (mm)	Ripple current (120Hz) (+105°C) (A)	D.F. (120Hz) (+20°C)			No	2point clamp	3point clamp
160	1800	36	83	1.98	0.1	13.0	ECEG2CG182P( )	N	F	
	2200	36	103	2.50	0.1	13.0	ECEG2CG222N( )	N	F	
	2700	36	125	3.02	0.1	13.0	ECEG2CG272M( )	N	F	F
	3300	51	83	3.63	0.1	22.0	ECEG2CG332L( )	N	C	F
	4700	51	103	4.84	0.1	22.0	ECEG2CG472K( )	N	C	F
	5600	51	125	5.93	0.1	22.0	ECEG2CG562J( )	N	C	F
	6800	51	145	7.03	0.1	22.0	ECEG2CG682H( )	N	C	F
		64	103	7.03	0.1	28.6	ECEG2CG682G( )	N	C	F
	8200	64	125	9.01	0.1	28.6	ECEG2CG822F( )	N	C	F
	10000	64	145	10.5	0.1	28.6	ECEG2CG103E( )	N	C	F
	12000	77	125	12.5	0.1	31.8	ECEG2CG123D( )	N	C	F
	15000	77	145	14.8	0.1	31.8	ECEG2CG153C( )	N	C	F
22000	90	150	20.0	0.1	31.8	ECEG2CG223A( )	N		F	
200	1500	36	83	1.81	0.1	13.0	ECEG2DG152P( )	N	F	
	1800	36	103	2.21	0.1	13.0	ECEG2DG182N( )	N	F	
	2200	36	125	2.73	0.1	13.0	ECEG2DG222M( )	N	F	
	2700	51	83	3.30	0.1	22.0	ECEG2DG272L( )	N	C	F
	3900	51	103	4.95	0.1	22.0	ECEG2DG392K( )	N	C	F
	4700	51	125	5.83	0.1	22.0	ECEG2DG472J( )	N	C	F
	5600	51	145	6.37	0.1	22.0	ECEG2DG562H( )	N	C	F
		64	103	6.37	0.1	28.6	ECEG2DG562G( )	N	C	F
	6800	64	125	8.24	0.1	28.6	ECEG2DG682F( )	N	C	F
	8200	64	145	9.67	0.1	28.6	ECEG2DG822E( )	N	C	F
	12000	77	125	12.5	0.1	31.8	ECEG2DG123D( )	N	C	F
	15000	77	145	14.8	0.1	31.8	ECEG2DG153C( )	N	C	F
18000	90	150	19.0	0.1	31.8	ECEG2DG183A( )	N		F	
250	1000	36	83	1.62	0.1	13.0	ECEG2EG102P( )	N	F	
	1200	36	103	1.77	0.1	13.0	ECEG2EG122N( )	N	F	
	1500	36	125	2.47	0.1	13.0	ECEG2EG152M( )	N	F	
	1800	51	83	2.78	0.1	22.0	ECEG2EG182L( )	N	C	F
	2700	51	103	3.81	0.1	22.0	ECEG2EG272K( )	N	C	F
	3300	51	125	4.77	0.1	22.0	ECEG2EG332J( )	N	C	F
	3900	51	145	5.68	0.1	22.0	ECEG2EG392H( )	N	C	F
		64	103	5.68	0.1	28.6	ECEG2EG392G( )	N	C	F
	4700	64	125	7.16	0.1	28.6	ECEG2EG472F( )	N	C	F
	5600	64	145	8.30	0.1	28.6	ECEG2EG562E( )	N	C	F
	8200	77	125	10.3	0.1	31.8	ECEG2EG822D( )	N	C	F
	10000	77	145	12.3	0.1	31.8	ECEG2EG103C( )	N	C	F
12000	90	150	15.8	0.1	31.8	ECEG2EG123A( )	N		F	
350	470	36	83	1.10	0.1	13.0	ECEG2VG471P( )	N	F	
	680	36	103	1.52	0.1	13.0	ECEG2VG681N( )	N	F	
	820	36	125	1.84	0.1	13.0	ECEG2VG821M( )	N	F	

Endurance : 105°C 2000 h

Design, Specifications are subject to change without notice. Ask factory for technical specifications before purchase and/or use. Whenever a doubt about safety arises from this product, please inform us immediately for technical consultation without fail.

### ■ Standard Products

Discontinued

W.V. (V)	Cap. (10 to +30%) ( $\mu$ F)	Case size		Specification		Terminal	Part No.	(): Mounting Clamp			
		Dia. (mm)	Length (mm)	Ripple current (120Hz) (+105°C) (A)	D.F. (120Hz) (+20°C)	Pitch (mm)			No	2point clamp	3point clamp
350	1000	51	83	2.07	0.1	22.0	ECEG2VG102L( )	N	C	F	
	1200	51	103	2.52	0.1	22.0	ECEG2VG122K( )	N	C	F	
	1500	51	125	3.18	0.1	22.0	ECEG2VG152J( )	N	C	F	
	1800	51	145	3.75	0.1	22.0	ECEG2VG182H( )	N	C	F	
			64	103	3.75	0.1	28.6	ECEG2VG182G( )	N	C	F
	2200	64	125	4.89	0.1	28.6	ECEG2VG222F( )	N	C	F	
	2700	64	145	5.74	0.1	28.6	ECEG2VG272E( )	N	C	F	
	3900	77	125	7.16	0.1	31.8	ECEG2VG392D( )	N	C	F	
	4700	77	145	8.53	0.1	31.8	ECEG2VG472C( )	N	C	F	
6800	90	150	12.1	0.1	31.8	ECEG2VG682A( )	N		F		
400	390	36	83	1.08	0.1	13.0	ECEG2GG391P( )	N	F		
	470	36	103	1.32	0.1	13.0	ECEG2GG471N( )	N	F		
	560	36	125	1.62	0.1	13.0	ECEG2GG561M( )	N	F		
	820	51	83	1.90	0.1	22.0	ECEG2GG821L( )	N	C	F	
	1000	51	103	2.41	0.1	22.0	ECEG2GG102K( )	N	C	F	
	1200	51	125	2.83	0.1	22.0	ECEG2GG122J( )	N	C	F	
	1500	51	145	3.45	0.1	22.0	ECEG2GG152H( )	N	C	F	
	1800	64	103	4.08	0.1	28.6	ECEG2GG182G( )	N	C	F	
	2200	64	125	4.94	0.1	28.6	ECEG2GG222F( )	N	C	F	
	2700	64	145	5.75	0.1	28.6	ECEG2GG272E( )	N	C	F	
	3300	77	125	6.63	0.1	31.8	ECEG2GG332D( )	N	C	F	
	3900	77	145	7.79	0.1	31.8	ECEG2GG392C( )	N	C	F	
5600	90	150	11.1	0.1	31.8	ECEG2GG562A( )	N		F		

Endurance : 105°C 2000 h