

PLEASE CHECK WWW.MOLEX.COM FOR LATEST PART INFORMATION

Part Number: [0387007310](#)
Status: **Active**
Description: 8.26mm (.325") Pitch Beau™ PCB Terminal Strip, with Mounting Ends, 10 Circuits, with Screw Clamp Washer

Documents:

[3D Model](#) [RoHS Certificate of Compliance \(PDF\)](#)
[Drawing \(PDF\)](#)

General

| | |
|----------------|-----------------------|
| Product Family | Terminal Blocks |
| Series | 38700 |
| Application | Wire-to-Board |
| Component Type | One Piece |
| Product Name | Fixed Mount Barrier |
| Type | Barrier Strip |

Physical

| | |
|--------------------------------|------------------------|
| Circuits (Loaded) | 10 |
| Circuits (maximum) | 10 |
| Entry Angle | Horizontal |
| Lock to Mating Part | None |
| Material - Metal | Brass |
| Material - Plating Mating | Tin |
| Material - Plating Termination | Tin |
| Number of Rows | 1 |
| Orientation | Horizontal |
| PC Tail Length (in) | 0.140 In |
| PC Tail Length (mm) | 3.56 mm |
| PCB Retention | Yes |
| Panel Mount | No |
| Pitch - Mating Interface (in) | 0.325 In |
| Pitch - Mating Interface (mm) | 8.26 mm |
| Pitch - Term. Interface (in) | 0.325 In |
| Pitch - Term. Interface (mm) | 8.25 mm |
| Plating min: Mating (µin) | 150 |
| Plating min: Mating (µm) | 3.75 |
| Plating min: Termination (µin) | 150 |
| Plating min: Termination (µm) | 3.75 |
| Polarized to Mating Part | No |
| Shrouded | Dual-Barrier |
| Stackable | Yes |
| Surface Mount Compatible (SMC) | No |
| Temperature Range - Operating | -40°C to +130°C |
| Termination Interface: Style | Through Hole |
| Wire Size AWG | 12, 14, 16, 18, 20, 22 |
| Wire Size mm² | 0.50 - 2.50 |

Electrical

| | |
|-------------------------------|------|
| Current - Maximum per Contact | 20A |
| Voltage - Maximum | 300V |

Material Info

| | |
|-----------------|----------|
| Old Part Number | 70510-50 |
|-----------------|----------|

Reference - Drawing Numbers

| | |
|---------------|--------------|
| Sales Drawing | SD-38700-002 |
|---------------|--------------|

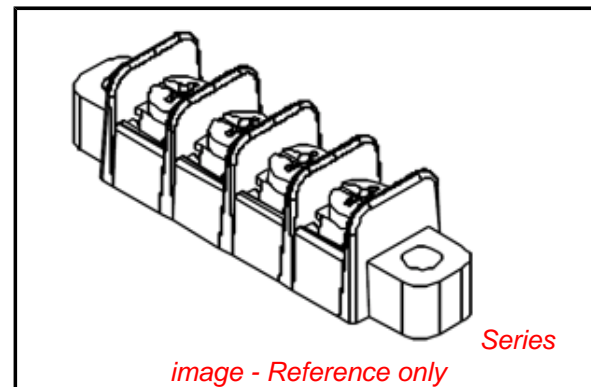

EU RoHS

ELV and RoHS Compliant
REACH SVHC
 Not Reviewed
Halogen-Free
Status
Not Reviewed

China RoHS



Need more information on product environmental compliance?

Email productcompliance@molex.com
 For a multiple part number RoHS Certificate of Compliance, [click here](#)

Please visit the [Contact Us](#) section for any non-product compliance questions.

Search Parts in this Series

[38700Series](#)

Mates With

N/A

This document was generated on 04/22/2010

PLEASE CHECK WWW.MOLEX.COM FOR LATEST PART INFORMATION

| NUMBER OF CIRCUITS "XX" | DIM "A" | DIM "B" | DIM "C" | MATERIAL NUMBER (STD) | MATERIAL NUMBER (50 OPT) |
|-------------------------|----------------|-----------------|------------------|-----------------------|--------------------------|
| 02 | 32.7 (1.291) | 8.26 (.3251) | 24.78 (1.9761) | 387006102 | 387007302 |
| 03 | 40.9 (1.611) | 16.52 (1.6501) | 33.04 (1.3011) | 387006103 | 387007303 |
| 04 | 49.2 (1.941) | 24.78 (1.9761) | 41.30 (1.6261) | 387006104 | 387007304 |
| 05 | 57.4 (2.261) | 33.04 (1.3011) | 49.56 (1.9511) | 387006105 | 387007305 |
| 06 | 65.7 (2.591) | 41.30 (1.6261) | 57.82 (2.2761) | 387006106 | 387007306 |
| 07 | 74.0 (2.911) | 49.56 (1.9511) | 66.08 (2.6021) | 387006107 | 387007307 |
| 08 | 82.2 (3.241) | 57.82 (2.2761) | 74.34 (2.9271) | 387006108 | 387007308 |
| 09 | 90.5 (3.561) | 66.08 (2.6021) | 82.60 (3.2521) | 387006109 | 387006309 |
| 10 | 98.7 (3.891) | 74.34 (2.9271) | 90.86 (3.5771) | 387006110 | 387007310 |
| 11 | 107.0 (4.211) | 82.60 (3.2521) | 99.12 (3.9021) | 387006111 | 387007311 |
| 12 | 115.3 (4.541) | 90.86 (3.5771) | 107.38 (4.2281) | 387006112 | 387007312 |
| 13 | 123.5 (4.861) | 99.12 (3.9021) | 115.64 (4.5531) | 387006113 | 387007313 |
| 14 | 131.8 (5.191) | 107.38 (4.2281) | 123.90 (4.8781) | 387006114 | 387007314 |
| 15 | 140.0 (5.511) | 115.64 (4.5531) | 132.16 (5.2031) | 387006115 | 387007315 |
| 16 | 148.3 (5.841) | 123.90 (4.8781) | 140.42 (5.5281) | 387006116 | 387007316 |
| 17 | 156.6 (6.161) | 132.16 (5.2031) | 148.68 (5.8541) | 387006117 | 387007317 |
| 18 | 164.8 (6.491) | 140.42 (5.5281) | 156.94 (6.1791) | 387006118 | 387007318 |
| 19 | 173.1 (6.811) | 148.68 (5.8541) | 165.20 (6.5041) | 387006119 | 387007319 |
| 20 | 181.3 (7.141) | 156.94 (6.1791) | 173.46 (6.8291) | 387006120 | 387007320 |
| 21 | 189.6 (7.461) | 165.20 (6.5041) | 181.72 (7.1541) | 387006121 | 387007321 |
| 22 | 197.9 (7.791) | 173.46 (6.8291) | 189.98 (7.4801) | 387006122 | 387007322 |
| 23 | 206.1 (8.111) | 181.72 (7.1541) | 198.24 (7.8051) | 387006123 | 387007323 |
| 24 | 214.4 (8.441) | 189.98 (7.4801) | 206.50 (8.1301) | 387006124 | 387007324 |
| 25 | 222.6 (8.771) | 198.24 (7.8051) | 214.76 (8.4551) | 387006125 | 387007325 |
| 26 | 230.9 (9.091) | 206.50 (8.1301) | 223.02 (8.7801) | 387006126 | 387007326 |
| 27 | 239.2 (9.421) | 214.76 (8.4551) | 231.28 (9.1061) | 387006127 | 387007327 |
| 28 | 247.4 (9.741) | 223.02 (8.7801) | 239.54 (9.4311) | 387006128 | 387007328 |
| 29 | 255.7 (10.071) | 231.28 (9.1061) | 247.80 (9.7561) | 387006129 | 387007329 |
| 30 | 263.9 (10.391) | 239.54 (9.4311) | 256.06 (10.0811) | 387006130 | 387007330 |

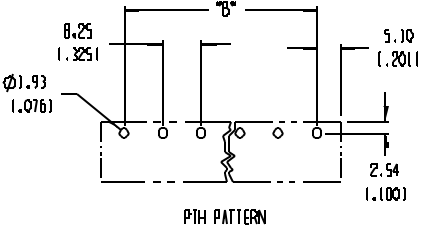
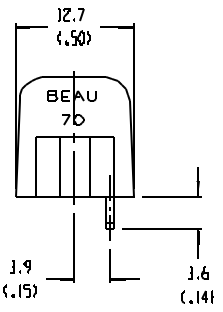
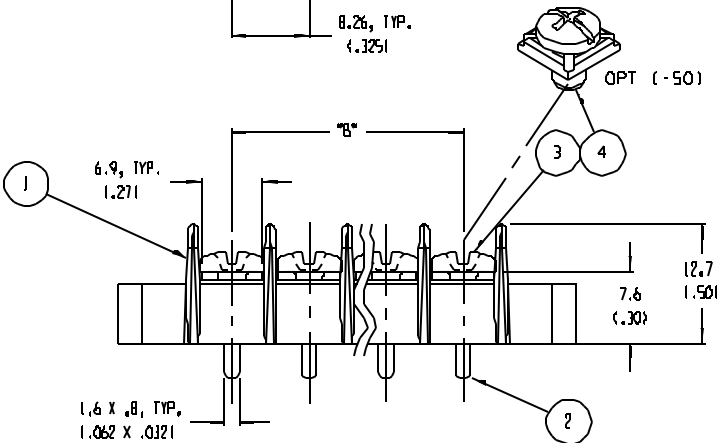
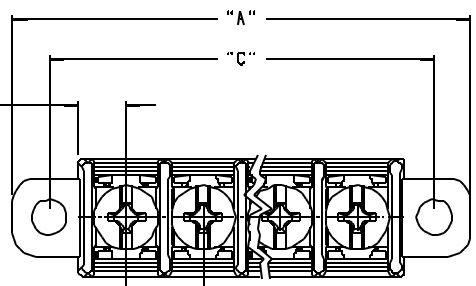
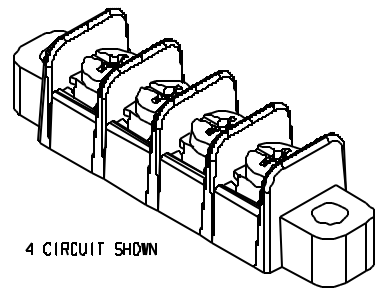

- NOTES:
1. MATERIAL: SEE TABLE
 2. FINISHES: SEE TABLE
 3. PRODUCT SPECIFICATION: NOT REQUIRED
 4. PACKAGING: NOT REQUIRED
 5. MATES WITH: NONE
 6. "XX" REFERS TO THE NUMBER OF CIRCUITS

| ITEM | QTY. | DESCRIPTION | MATERIAL | FINISH |
|------|------|--|---------------|--------------------|
| 4 | "XX" | SCREW, #6-32, PAN HD, PH-SL, W/50 WASHER | STEEL | ZN, CLEAR CHROMATE |
| 3 | "XX" | SCREW, #6-32, PAN HD, PH-SL | STEEL | ZN, CLEAR CHROMATE |
| 2 | "XX" | TERMINAL | BRASS | TIN |
| 1 | 1 | BARRIER | THERMOPLASTIC | BLACK |
| | | | MATERIAL | FINISH |

EC NO. ECN 3712
 DRWN: CY 05-28-04
 CHK: []
 APPR: []

REV DESCRIPTION

MAJOR []
 CRITICAL []
 SPC []

GENERAL TOLERANCES: (UNLESS SPECIFIED)

| | MM | INCH |
|----------|--------|--------|
| 4 PLACES | ±.0015 | ±.0015 |
| 3 PLACES | ±.038 | ±.005 |
| 2 PLACES | ±.13 | ±.01 |
| 1 PLACE | ±.3 | |

ANGULAR: ±2°

DRAFT WHERE APPLICABLE MUST REMAIN WITHIN DIMENSIONS

SCALE: 2:1

DESIGN UNITS: MM INCH

THIRD ANGLE PROJECTION

DRAWN BY & DATE: W. HOWARD 07-29-03

CHECKED BY & DATE: R. KEMP 08-05-03

APPROVED BY & DATE: P. WALTZ 08-05-03

CAD FILENAME: 705XX

PROJECT NO.:

DIMENSIONS: DIM (INCH) DIM (MM) DIM ONLY

SHEET: 1 REV: []

REVISE ON CAD ONLY

TITLE: SR BT5 ASSY, PC

MOLEX INCORPORATED

MATERIAL NO. [] DRAWING NO. SD-38700-002 SHEET NO. 1 OF 1

THIS DRAWING CONTAINS INFORMATION THAT IS PROPRIETARY TO MOLEX INCORPORATED AND SHOULD NOT BE USED WITHOUT WRITTEN PERMISSION.

SIZE: B