

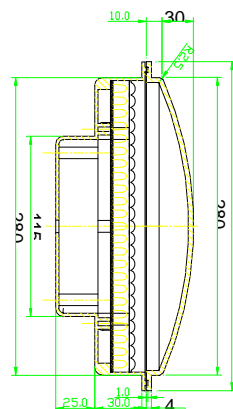

TS-300 LED Traffic Signal Lamp

- Available in all three standard colors
- Replace incandescent bulb in standard signal head
- Save energy and maintenance cost
- Increase traffic safety by better device reliability & visibility
- Custom specification acceptable
- International patent pending

30 cm Version Features			
	RED	YELLOW	GREEN
<i>Model Number</i>	TR-301	TY-302	TG-303
<i>Applied Voltage</i>	120 VAC / 60 Hz, 220 VAC / 60 Hz		
<i>Power Consumption(Watts)</i>	10.5	10.5	10.5
<i>Dominant Wavelength(nm)</i>	626	592	505
<i>On Axis Luminous Intensity(Min.)</i>	350 cd	350 cd	450 cd
<i>LEDs Per Lamp</i>	196	196	116
<i>Intensity Loss Due to Single LED Failure</i>	2.5 %	2.5 %	4.3 %
<i>Power Factor (PF)</i>	> 0.95	> 0.95	> 0.95
<i>Total Harmonic Distortion (THD)</i>	< 20 %	< 20 %	< 20 %
<i>LED Material</i>	AllnGaP	AllnGaP	InGaN
<i>Lens & Housing Material</i>	UV resistant Polycarbonate		
<i>Signal Lamp Size</i>	300 mm disc		
<i>IP Rating (Out of / In Lantern Housing)</i>	IP 34 / IP 65		
<i>Operating Temperature</i>	-40°C ~ 74°C		
<i>Storage Temperature</i>	-40°C ~ 85°C		



OPTO TECH CORPORATION

NO.8, Innovation Rd. 1, Hsinchu Science-Based Industrial Park, Hsinchu, Taiwan, R.O.C.

TEL : 886-3-5777481 · 886-3-5799481 EXT : 643,644,645

FAX : 886-3-5779576 E-mail : 1658@opto.com.tw

