

# KNOBS

TYPE

PATTERN



THREAD OR BORE

LENGTH OF  
MALE THREAD

**RENKOL**

Matt finish duroplast

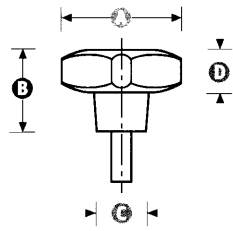

MALE

Plated steel  
insert

<b>1481/M</b>	25	15	10	7	M4 M5	10 20
---------------	----	----	----	---	-------	-------

Gloss finish duroplast

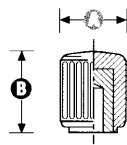

FEMALE

Brass  
insert

<b>501</b>	14	16	M4 M5 M6
------------	----	----	----------

<b>502</b>	20	22	M5 M6
------------	----	----	-------

<b>503</b>	25	33	M6 M8
------------	----	----	-------

<b>504</b>	30	38	M6 M8 M10
------------	----	----	-----------

MALE

Plated steel  
insert

<b>501/M</b>	14	16	M4 M5 M6	10
--------------	----	----	----------	----

<b>502/M</b>	20	22	M5 M6	15
--------------	----	----	-------	----

<b>503/M</b>	25	33	M6 M8	25
--------------	----	----	-------	----

<b>504/M</b>	30	38	M6 M8 M10	25
--------------	----	----	-----------	----

Spinner knob

Gloss finish duroplast

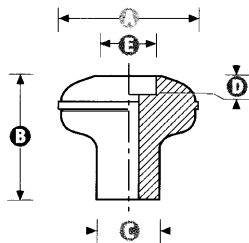

FEMALE

Moulded  
clearance  
bore

<b>181</b>	48	45	22	6	20	8 10
------------	----	----	----	---	----	------

Matt finish thermoplastic

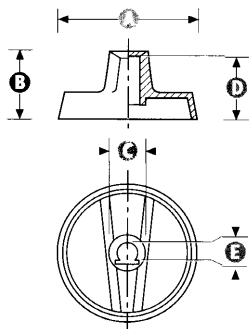
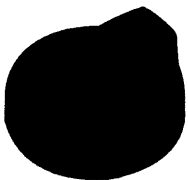

FEMALE

Fitted with  
clip to suit  
'D' shaft

<b>1535</b>	40	20	11	18	4.6	6
-------------	----	----	----	----	-----	---

TYPE

PATTERN



THREAD OR BORE

LENGTH OF  
MALE THREAD

Most patterns are available with imperial threads (Whitworth) or bores

Non standard thread diameters, lengths, insert materials and other modifications are available for minimum quantities. The standard colour is black. Some patterns are available in a choice of colours. Contact our sales department for details.

All dimensions in mm and are approximate