

Rocker Switches

Sub-Miniature Rocker Switches

RK15 Series

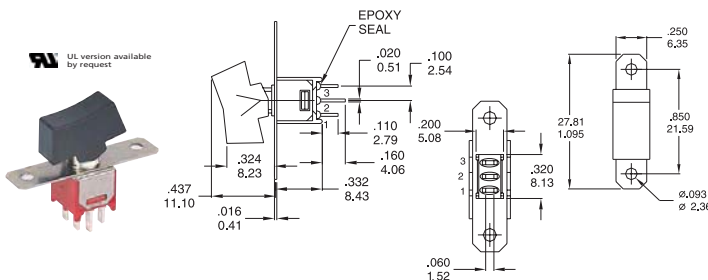

RK15S1A1A_T1AGEV

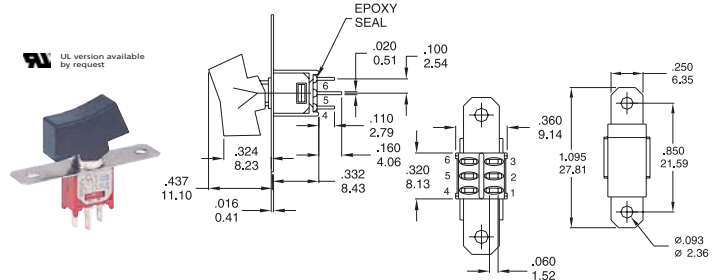

RK15D1A1A_T1AGEV

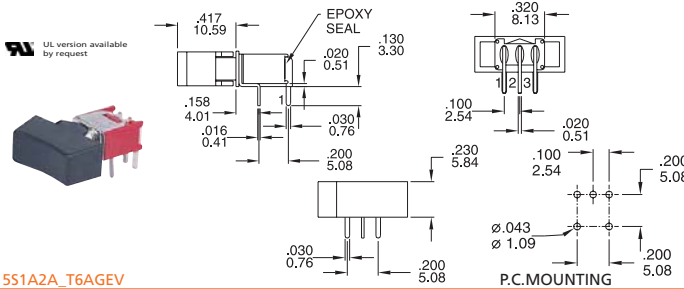

RK15S1A2A_T6AGEV

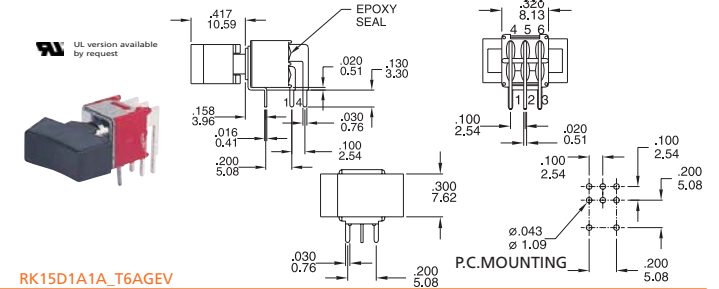

RK15D1A1A_T6AGEV

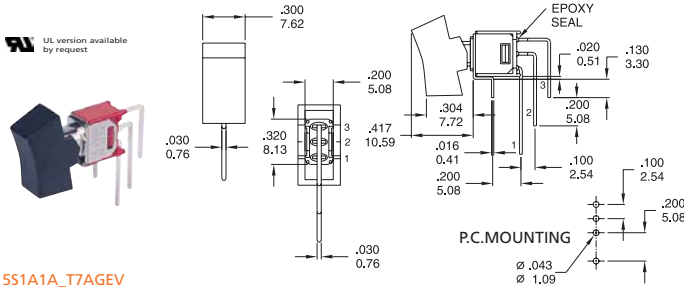

RK15S1A1A_T7AGEV

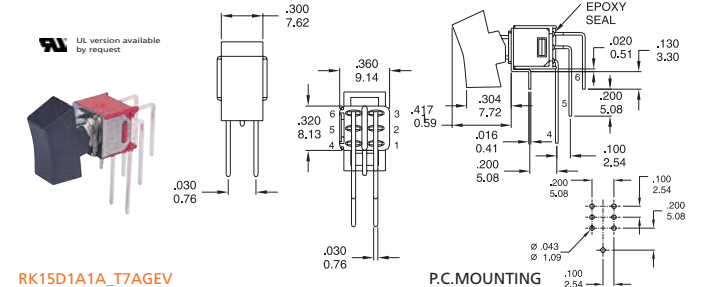

RK15D1A1A_T7AGEV

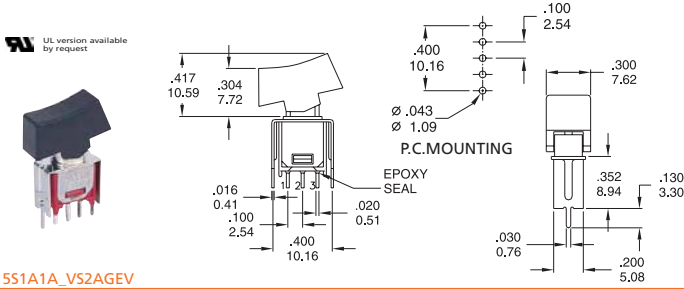

RK15S1A1A_VS2AGEV

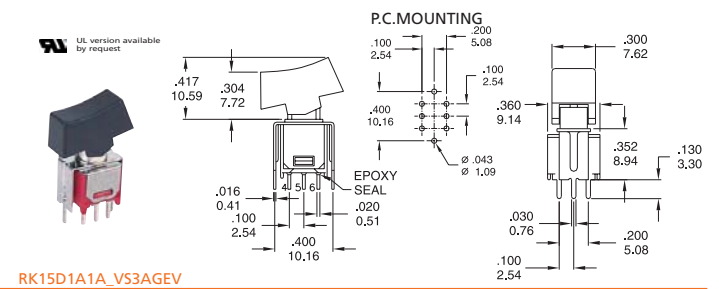

RK15D1A1A_VS3AGEV

How to order:

RK15

1 POLES & SWITCH FUNCTION:

- S1 SP ON-NONE-ON
- S2 SP ON-NONE-MOM
- S3 SP ON-OFF-ON
- S4 SP MOM-OFF-MOM
- S5 SP ON-OFF-MOM
- S6 SP OFF-NONE-ON
- D1 DP ON-NONE-ON
- D2 DP ON-NONE-MOM
- D3 DP ON-OFF-ON
- D6 DP ON-ON-ON

2 ACTUATOR:

- A1 Rocker, 7.62mm wide
- A2 Rocker, 5.84mm wide

3 ACTUATOR COLOR

- | | | |
|---------------|----------|---------|
| A Black(Std.) | H Grey | B White |
| F Green | D Orange | C Red |
| E Yellow | K Brown | G Blue |

4 ACTUATOR MARKING

- | | |
|---|----------|
| A | E |
| B | F |
| C | G ON/OFF |
| D | H |

5 TERMINATIONS

- T1 Solder Lug
- T2 PC Thru Hole
- T5 Wire Wrap
- T6 PC Thru Hole Right Angle
- T6N PC Thru Hole Right Angle Snap-in
- T7 PC Thru Hole, Vertical Right Angle
- T7N PC Thru Hole, Vertical Right Angle Snap-in
- VS2 V-Bracket, Height=8.94mm
- V2N Snap-in V-Bracket, Height=8.94mm
- VS3 V-Bracket, Height=8.94mm
- V3N Snap-in V-Bracket, Height=8.94mm

6 CONTACT MATERIALS :

- AG Silver
- AU Gold
- UT Gold, Tin-Lead
- GT Silver, Tin-Lead
- UG Gold over Silver
- UGT Gold over Silver, Tin-Lead

7 SEAL:

- E Epoxy

8 ROHS & LEAD FREE

- V RoHS Compliant & Lead Free

General Specifications:

MATERIALS

- » Movable Contact & Fixed Terminals:
 - AG, GT, UG & UGT: Silver plated over copper alloy
 - AU & UT: Gold over nickel plated over copper alloy

MECHANICAL

- » Operating Temperature: -30°C to +85°C
- » Mechanical Life: 30,000 cycles

CONTACT RATING

- » AG, GT, UG & UGT: 3A120VAC/28VDC
1A250VAC
- » AU & UT: 0.4VA max. 20V max. (AC/DC)

ELECTRICAL

- » Contact Resistance: 20mΩ max. initial @ 2-4VDC
100mA for silver & gold plated contacts
- » Insulation Resistance: 1,000MΩ min.

Rocker Switches

Sub-Miniature Rocker Switches

RK15 Series

| NO. POLES | MODEL NO. | SWITCH FUNCTION | | | CONNECTED TERMINALS / SCHEMATIC | | |
|-----------|-----------|-----------------|-------|-------|---------------------------------|-------|----------------------|
| | | POS.1 | POS.2 | POS.3 | POS.1 | POS.2 | POS.3 |
| SP | RK15S1 | ON | NONE | ON | 2-3 | N/A | 2-1 |
| | RK15S2 | ON | NONE | MOM | | | |
| | RK15S3 | ON | OFF | ON | 1-3 2(COMM) | OPEN | 1-3 2(COMM) |
| | RK15S4 | MOM | OFF | MOM | | | |
| | RK15S5 | ON | OFF | MOM | OPEN | N/A | 3-1 |
| | RK15S6 | OFF | NONE | ON | | | |
| DP | RK15D1 | ON | NONE | ON | 2-3,5-6 2(COMM) 5 | N/A | 2-1,5-4 2(COMM) 5 |
| | RK15D2 | ON | NONE | MOM | | | |
| | RK15D3 | ON | OFF | ON | 1-3 4-6 | OPEN | 1-3 4-6 |
| | RK15D6 | ON | ON | ON | | | |

ACTUATOR OPTIONS

| | |
|--|--|
| <p style="text-align: center;">A1</p> <p style="text-align: center;">Std. all models except SPDT with T6 terminations</p> | <p style="text-align: center;">A2</p> <p style="text-align: center;">Std. on SPDT models with T6 terminations</p> |
|--|--|

TERMINAL OPTIONS

| | |
|--|---|
| <p style="text-align: center;">SP DP</p> <p style="text-align: center;">T1 Solde Lug</p> | <p style="text-align: center;">SP DP</p> <p style="text-align: center;">T2 P.C. Mount</p> |
|--|---|

SNAP-IN TERMINATION OPTIONS

| | | | |
|---|---|---|---|
| <p style="text-align: center;">T6N</p> | <p style="text-align: center;">T7N</p> | <p style="text-align: center;">V2N</p> | <p style="text-align: center;">V3N</p> |
|---|---|---|---|