



# Pushbutton Switches

## Snap-Acting Pushbutton Switches (ON-MOM)

## PB1M Series

Pushbutton Switches



**PB1MDA1B10T1**

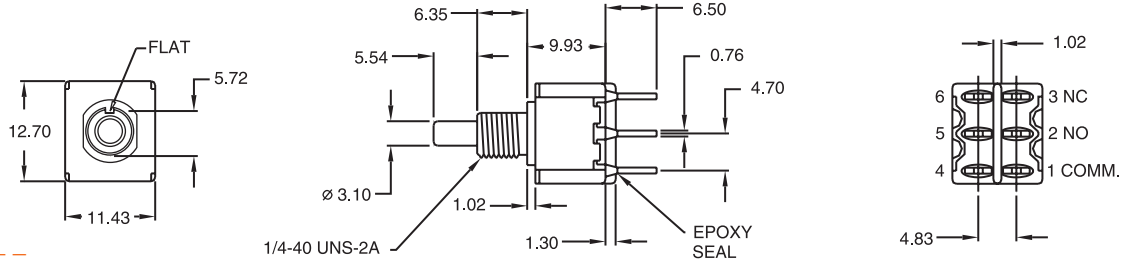

**PB1MDA1B20T6**

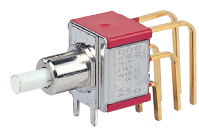
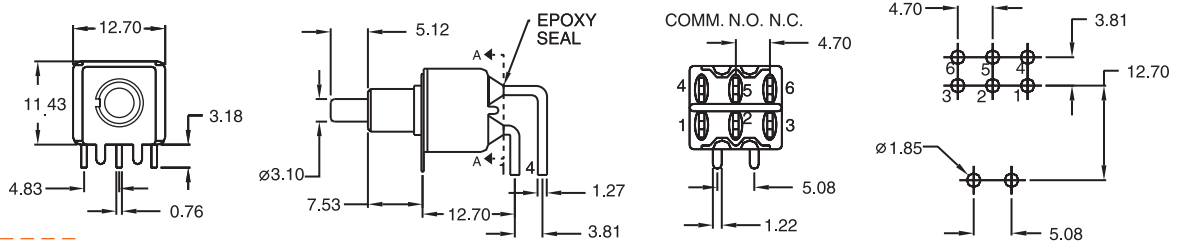

**PB1MDA1B20T7**

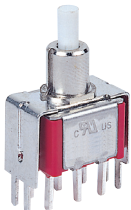
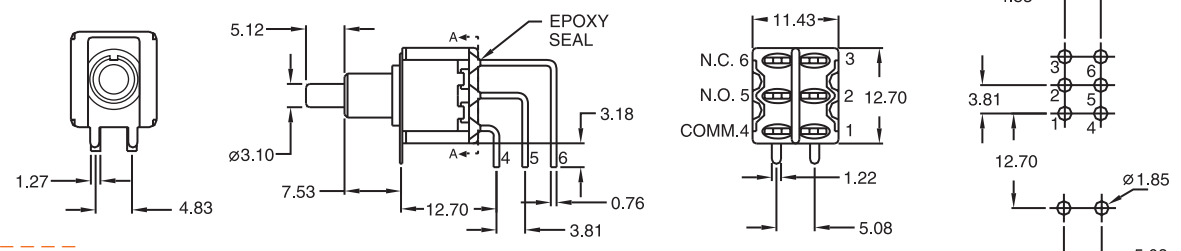

**PB1MDA1B20VS2**

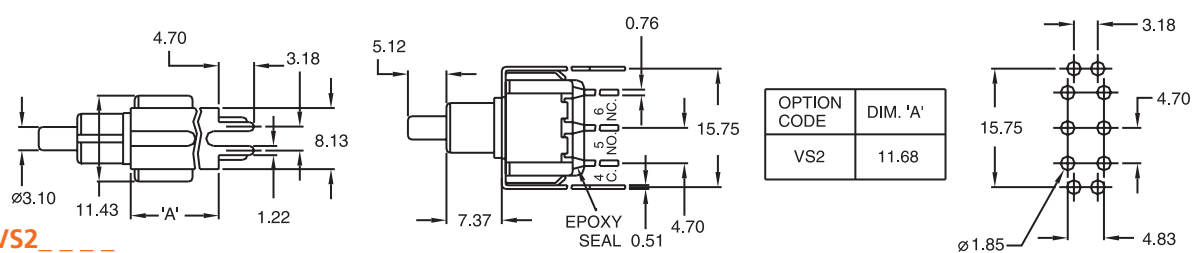

**PB1MDA1B20VS4**

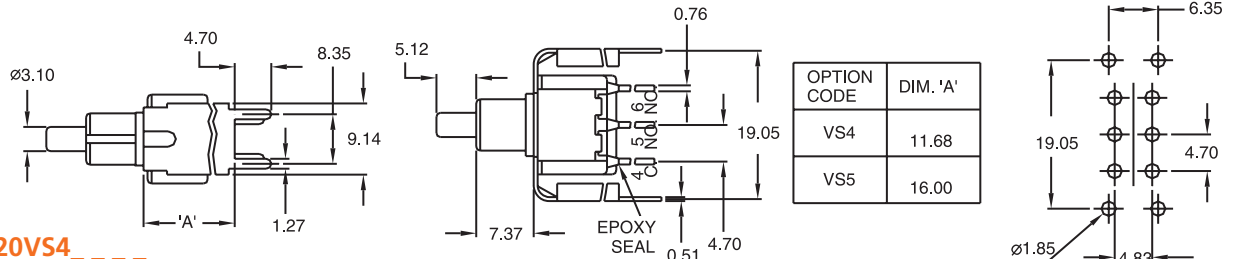

**PB1MSAP2** □ □ T1

AP2: Cap & Frame  
AP1: Cap only

A	BLACK
B	WHITE
C	RED
D	ORANGE
E	YELLOW
F	GREEN
G	BLUE
K	BROWN
H	GRAY

--- FRAME COLOR  
--- CAP COLOR

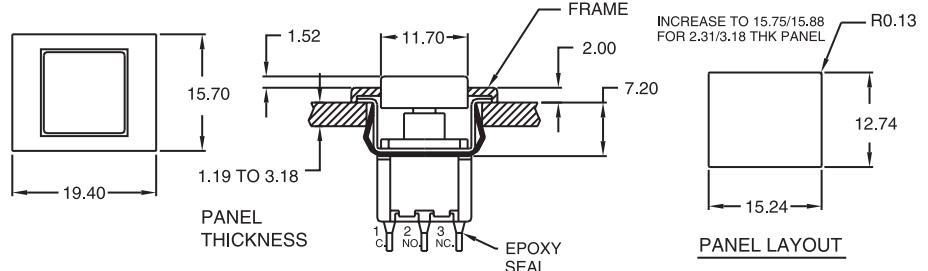

**PB1MDAP2** □ □ T1

AP2: Cap & Frame  
AP1: Cap only

A	BLACK
B	WHITE
C	RED
D	ORANGE
E	YELLOW
F	GREEN
G	BLUE
K	BROWN
H	GRAY

--- FRAME COLOR  
--- CAP COLOR

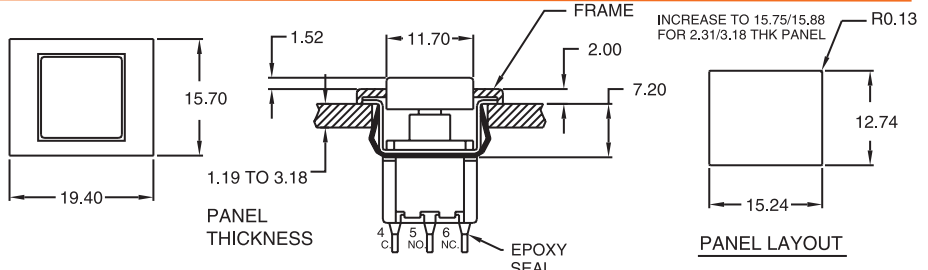

# Pushbutton Switches

## Snap-Acting Pushbutton Switches (ON-MOM)

## PB1M Series

Pushbutton Switches



AP4: Cap & Frame  
AP3: Cap only

A	BLACK
B	WHITE
C	RED
D	ORANGE
E	YELLOW
F	GREEN
G	BLUE
K	BROWN
H	GRAY

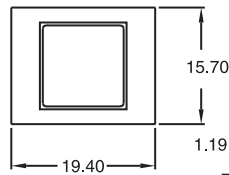

15.70

19.40

1.19 TO 3.18

PANEL THICKNESS

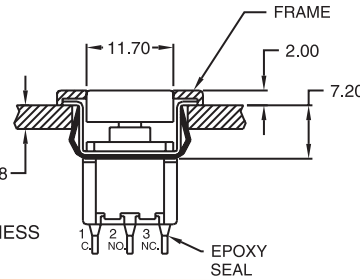

FRAME

2.00

7.20

11.70

1

2

3

NC

EPOXY SEAL

INCREASE TO 15.75/15.88 FOR 2 31/32 THK PANEL

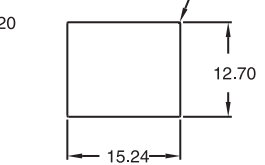

PANEL LAYOUT

PB1MSAP4□□T1

FRAME COLOR  
CAP COLOR

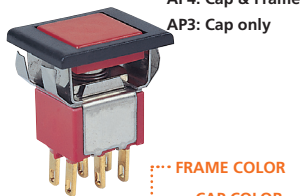

AP4: Cap & Frame  
AP3: Cap only

A	BLACK
B	WHITE
C	RED
D	ORANGE
E	YELLOW
F	GREEN
G	BLUE
K	BROWN
H	GRAY

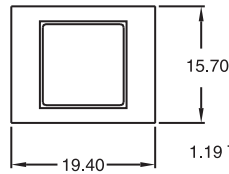

15.70

19.40

1.19 TO 3.18

PANEL THICKNESS

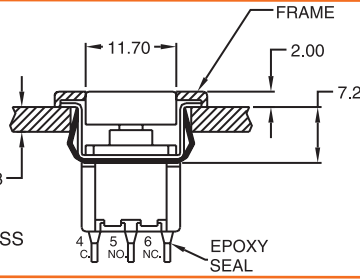

FRAME

2.00

7.20

11.70

4

5

6

NC

EPOXY SEAL

INCREASE TO 15.75/15.88 FOR 2 31/32 THK PANEL

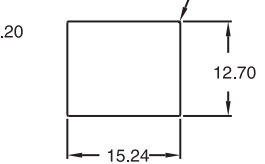

PANEL LAYOUT

PB1MDAP4□□T1

FRAME COLOR  
CAP COLOR

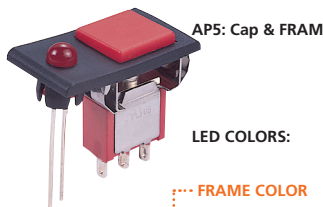

AP5: Cap & FRAME

A	BLACK
B	WHITE
C	RED
D	ORANGE
F	GREEN

LED COLORS:

FRAME COLOR  
CAP COLOR

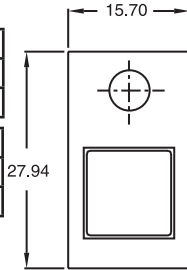

27.94

15.70

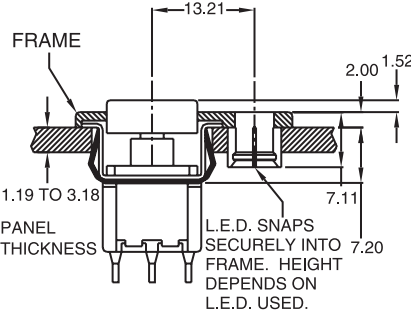

FRAME

2.00

1.52

1.19 TO 3.18

PANEL THICKNESS

7.11

L.E.D. SNAPS SECURELY INTO FRAME. HEIGHT DEPENDS ON L.E.D. USED.

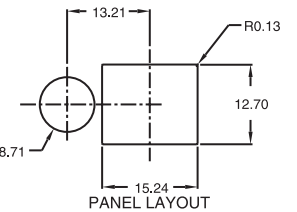

PANEL LAYOUT

PB1MSAP5□□T1

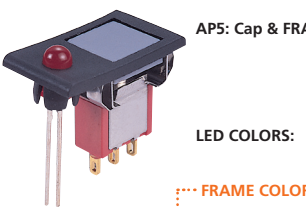

AP5: Cap & FRAME

A	BLACK
B	WHITE
C	RED
D	ORANGE
F	GREEN

LED COLORS:

FRAME COLOR  
CAP COLOR

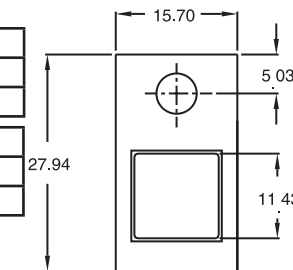

27.94

15.70

5.03

11.43 THICKNESS

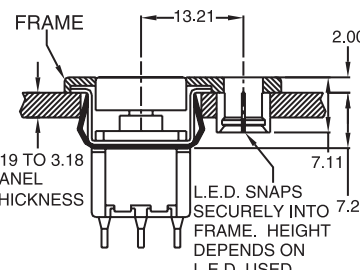

FRAME

2.00

7.11

1.19 TO 3.18

PANEL THICKNESS

7.20

L.E.D. SNAPS SECURELY INTO FRAME. HEIGHT DEPENDS ON L.E.D. USED.

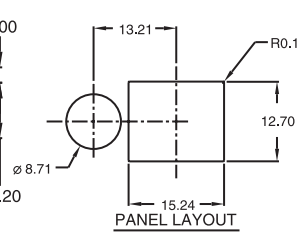

PANEL LAYOUT

PB1MSAP5□□T1

### SWITCH FUNCTION

NO. POLES	MODEL NO.	SWITCH FUNCTION		CONNECTED TERMINALS		SCHEMATIC
		POS.1	POS.2	POS.1	POS.2	
SP	PB1MS	ON	MOM	1-3	1-2	
DP	PB1MD	ON	MOM	1-3,4-6	1-2,4-5	

MOM=MENTORY

### TERMINAL OPTIONS

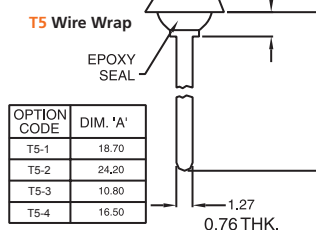
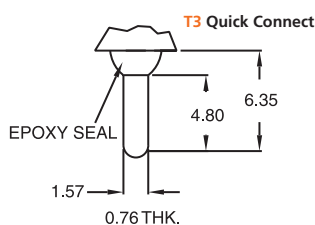
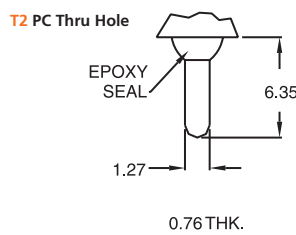
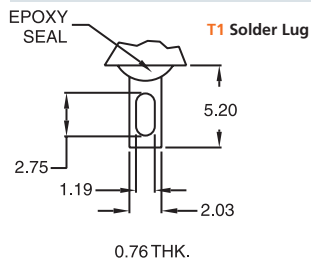

OPTION CODE	DIM. 'A'
T5-1	18.70
T5-2	24.20
T5-3	10.80
T5-4	16.50

### BUSHING OPTIONS

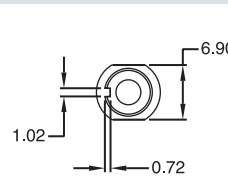

B20 NON THD

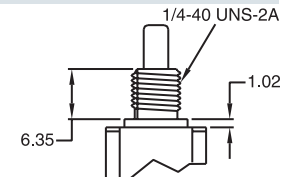

B21 NON THD

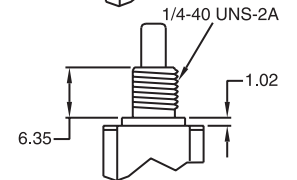

### SNAP-IN TERMINAL OPTIONS

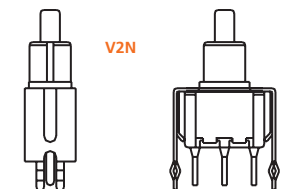
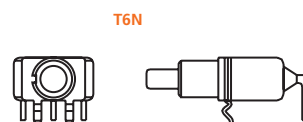

# Pushbutton Switches

## Snap-Acting Pushbutton Switches (ON-ON)

## PB1N Series

Pushbutton Switches



**PB1NSA1B60T1**

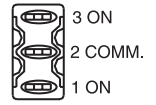
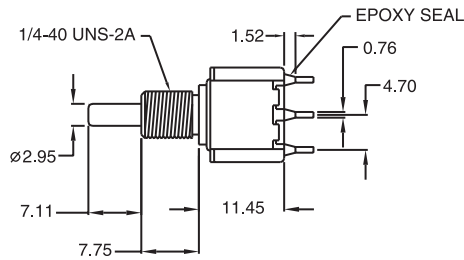
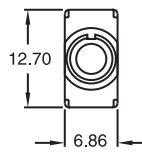

**PB1NDA1B60T1**

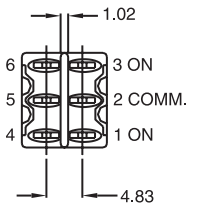
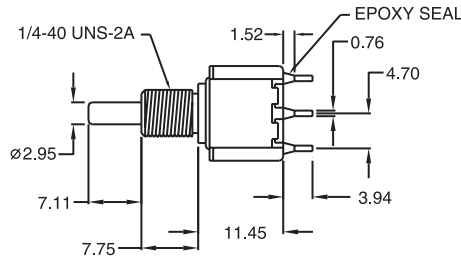
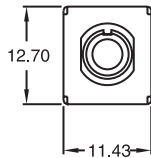

**PB1NSA1B70T6**

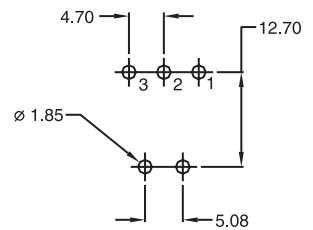
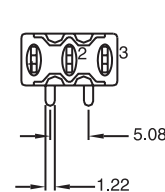
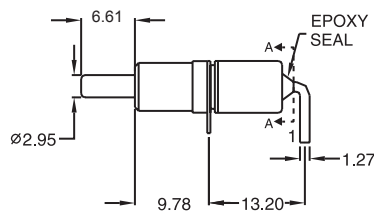
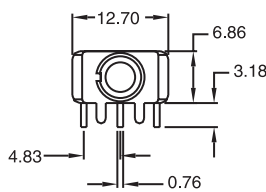

**PB1NDA1B70T6**

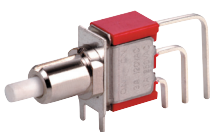
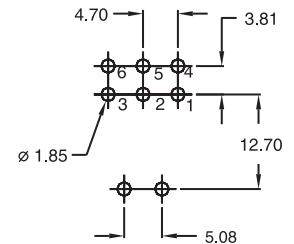
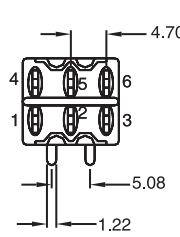
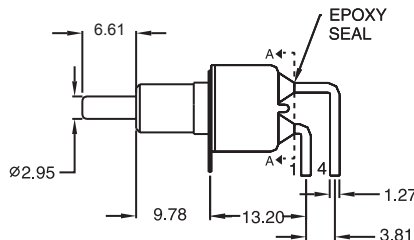
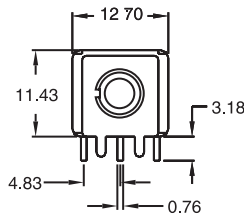

**PB1NSA1B70T7**

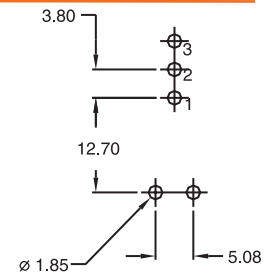
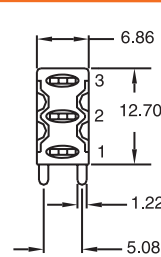
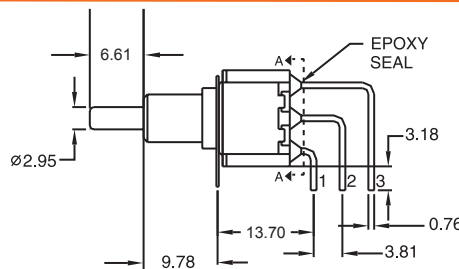
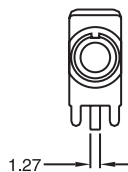

### How to order:

**PB1**

**1 SWITCHING & POLES:**  
 NS ON-ON SPDT  
 ND ON-ON DPDT

**2 ACTUATOR:**  
 A1 6.61/7.11 mm high  
 AA Handle, metal material  
 AB Handle, metal material

**3 BUSHING:**  
 B60 7.62mm high, keyway (thd)  
 B61 7.62mm high, flat (thd)  
 B70 7.62mm high, keyway (non-thd)  
 B71 7.62mm high, flat (non-thd)

**4 TERMINALS:**  
 T1 Solder Lug  
 T2 PC thru-hole  
 T5 Wire wrap  
 T6 Right angle, PC thru-hole

**T6N** Right angle, PC thru-hole  
**T7** Right angle, snap-in, PC thru-hole  
**VS2** Vertical right angle, PC thru-hole  
**V2N** 11.68mm high, V-bracket  
**VS3** 11.68mm high, snap-in, V-bracket  
**VS4** 16.00mm high, V-bracket  
**VS5** 11.68mm high, V-bracket  
**VS5** 16.00mm high, V-bracket

**5 CONTACT MATERIAL:**  
 AG Silver  
 AU Gold  
 UT Gold, tin-lead  
 GT Silver, tin-lead  
 UG Gold over silver  
 UGT Gold over silver, tin-lead

**6 SEAL:**  
 E Epoxy (Standard)  
 N No Epoxy

**7 ROHS & LEAD FREE:**  
 blank RoHS compliant  
 V RoHS & lead free

**8 CAP:**  
 C1 Cap1  
 C2 Cap2  
 C3 Cap3  
 C4 Cap4

### General Specifications:

#### MATERIALS

» Movable Contact & Fixed Terminals:  
 AG, GT, UG & UGT: Silver plated over copper alloy  
 AU & UT: Gold over nickel plated over copper alloy

#### MECHANICAL

» Operating Temperature: -30°C to +85°C  
 » Mechanical Life: 30,000 cycles

#### CONTACT RATING

» AG, GT, UG & UGT: 3A 120VAC/28VDC  
 1A 250VAC  
 » AU & UT: 0.4VA max. 20V max. (AC/DC)

#### ELECTRICAL

» Contact Resistance: 20mΩ max. initial @ 2-4VDC  
 100mA for silver & gold plated contacts  
 » Insulation Resistance: 1,000MΩ min.

# Pushbutton Switches

## Snap-Acting Pushbutton Switches (ON-ON)

## PB1N Series

Pushbutton Switches

**PB1NDA1B70T7**

OPTION CODE	DIM. 'A'
VS2	11.68
VS3	16.00

**PB1NSA1B70VS2**

OPTION CODE	DIM. 'A'
VS2	11.68

**PB1NDA1B70VS2**

### CAPS (Colors: white, black, green, red)

**C1** **C2** **C3** **C4**

### SWITCH FUNCTION

NO. POLES	MODEL NO.	SWITCH FUNCTION		CONNECTED TERMINALS/SCHEMATIC	
		POS.1	POS.2	POS.1	POS.2
SP	PB1NS	ON	ON	1-2	2-3
DP	PB1ND	ON	ON	1-2,4-5	2-3,5-6

### BUSHING OPTIONS

**B60 THD STD** **B70 NON THD** **B61 THD STD** **B71 NON THD**

### TERMINAL OPTIONS

**T1 Solder Lug** **T2 PC Thru Hole** **T3 Quick Connect** **T5 Wire Wrap**

OPTION CODE	DIM. 'A'
T5-1	18.70
T5-2	24.20
T5-3	10.80
T5-4	16.50

### SNAP-IN TERMINAL OPTIONS

**T6N** **V2N**