

Switching Power Transformers

Electrical Characteristics

- Applicable to flyback,forward,push pull and bridge circuits
- Output power rating up to 500W
- Frequency range:15KHz to 200 KHz
- Design to meet UL,CSA and VDE safety specifications
- Heat resistance classification : Class A (105[°]c) or Class B(130[°]c)
- Flammability retardant rating:UL-0 or 94V-1

EE Series

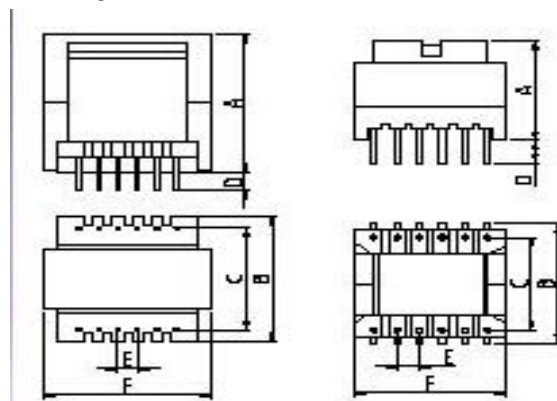

Shape & Dimensions in mm

PART NO.	TERMINALPINS	Dimensions in mm (inches)						TYPE
		A	B	C+/-0.5	D+/-0.5	E+/-0.5	F	
EE-8.3	6	8	8	6	4	2.5	8.3	V
EE-10	8	11.5	10.2	8	4	2.5	10.2	V
EE-13	10	12	12.5	8.5	4	2.5	13	V
EE-16-1	6	14.8	13.3	9	4	3	16	V
EE-16-2	10	15.4	13	10.5	4	3.2	17.1	V
EEL-16	10	28.5	16	12.3	4	4.3	21.9	V
EE-19-1	8	17.6	16	10	4	5	19	V
EE-19-2	10	17.2	16.2	13	4	3.9	20	V
EEL-19	10	31.5	16	10.5	4	4	21.1	V
EEL-19-1	10	15.6	30	24.1	4	3.5	21	H
EE-25-1	6	20	18.2	12.5	4	6.3	25.2	V
EE-25-2	8	21.7	17.5	12.6	4	5	25.2	H
EE-25-3	10	22.2	25	15.4	4	5	26.1	H
EEL-25	8	35.3	17.5	12.5	4	5	25.2	V
EE-30	10	21	29.2	25.2	4	5	30	H
EE-40	14	27.6	30.5	25.8	4	5	40	H
EE-42/15-1	12	33.8	44	35.5	4	5	42	H
EE-42/15-2	16	41.3	48	37.7	4	5	42	H
EE-42/15-3	18	48.7	32	27.5	4	5	45.1	V
EE-42/20-1	12	45	39.8	32.5	4	5	42	V
EE-42/20-2	16	44.2	50	37.8	4	5	42.2	H
EE-42/20-3	18	44.1	37	27.3	4	5	45.3	V
EE-55	20	50	50	45.5	4	5	55	H
EE-65	16	55.2	51.8	45	4	5	65	H

TYPE : H ->HORIZONTAL TYPE V ->VERTICAL TYPE

DESIGN AS CUSTOMER'S REQUESTED SPECIFICATIONS

Switching Power Transformers

EI Series

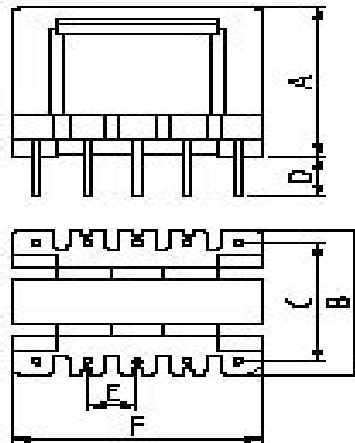

Shape & Dimensions in mm

PART NO.	TERMINAL PINS	Dimensions in mm (inches)						
		A	B	C+/-0.5	D+/-0.5	E+/-0.5	F	TYPE
EI-14	6	12	13	10.5	4	3.2	14	V
EI-22	10	19.5	15.8	10	4	4	22	V
EI-24	6	18.5	20.5	17.5	4	5	24	V
EI-28	10	21.5	22.1	17.4	4	5	28	V
EI-30	10	26	21.6	17.3	4	5	30	V
EI-33	12	31.5	28	22.5	4	5	33	V
EI-33-1	18	32	28.1	22.6	4	5	43.7	V
EI-40	12	33.5	28	22.5	4	5	40	V
EI-40-1	16	35.5	28.5	22.8	4	5	42	V
EI-50	12	41	35.5	27.5	4	7.5	50	V
EI-60	12	45	45	35	5	7.5	60	V

TYPE : H -> HORIZONTAL TYPE V -> VERTICAL TYPE

DESIGN AS CUSTOMER'S REQUESTED SPECIFICATIONS

EER Series

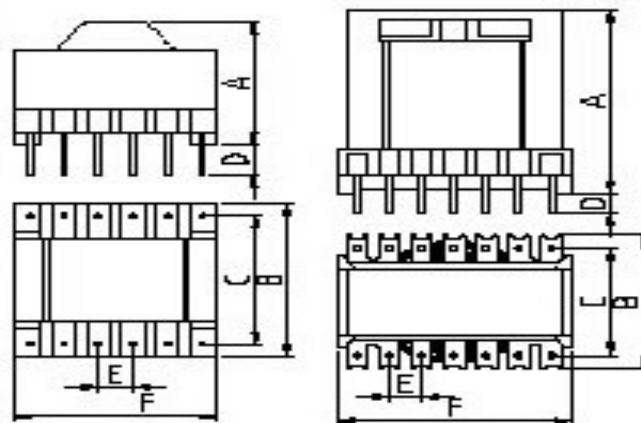

Switching Power Transformers

Shape & Dimensions in mm

PART NO.	TERMINAL PINS	Dimensions in mm (inches)						
		A	B	C+/-0.5	D+/-0.5	E+/-0.5	F	TYPE
EER25.5	8	19.5	19.7	12.5	4	5	25.5	V
EER28	12	30.5	23	17.5	4	5	31	V
EER28	12	23.1	28.2	25	4	5	29.1	H
EERL28	12	36	27	20	4	5	30	V
EERL28	12	26.3	37.1	30	4	5	30.2	H
EER33	14	37.5	28	22.5	4	5	36	V
EERL35	14	43.5	28	22.5	4	5	35.5	V
EERL35	16	29.1	40.3	35.4	4	5	40.3	H
EERL39	16	46	31.1	25	4	5	43.1	V
EERL39	16	33	41.5	30.85	4	5	42.3	H
EER39	18	33	33	25	5	2.5	50	V
EER40	16	48	31.1	25	4	5	43.1	V
EER4215	14	45.5	30	25	4	5	42	V
EER4220	14	44	37.5	36	4	5	42	V

TYPE : H ->HORIZONTAL TYPE V ->VERTICAL TYPE

DESIGN AS CUSTOMER'S REQUESTED SPECIFICATIONS

EF Series

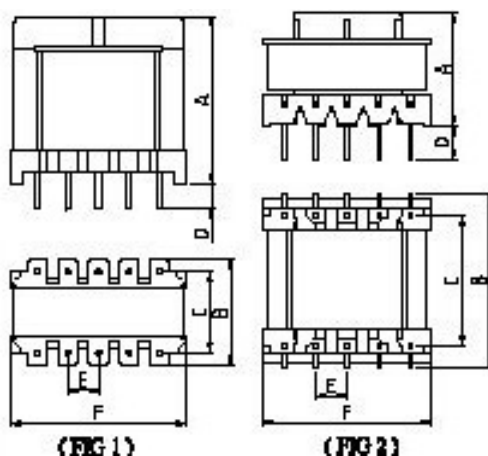

Shape & Dimensions in mm

PART NO.	TERMINAL PINS	Dimensions in mm (inches)						
		A	B	C+/-0.5	D+/-0.5	E+/-0.5	F	TYPE
EF-12.6	6	16	10	7.6	4	3.8	14.4	V
EF-12.6	10	9.5	17.7	10.9	4	2.5	13.2	H
EF-16	6	18.5	11.5	7.5	4	3.75	16.2	V
EF-16	14	13.5	19	15.24	4	2.54	16.9	H
EF-20	6	21	13	10	4	5.08	20	V
EF-20	10	16.6	21.2	15.24	4	3.8	22	H
EF-25	6	26	17.1	12.5	4	5	25	V
EF-25	10	27.5	19.4	12.7	4	5	25	V
EF-25	8	20	26	20	4	5	25.1	H

TYPE : H ->HORIZONTAL TYPE V ->VERTICAL TYPE

DESIGN AS CUSTOMER'S REQUESTED SPECIFICATIONS

Switching Power Transformers

EPC Series

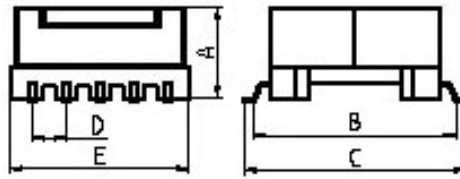

Shape & Dimensions in mm

PART NO.	TERMINALPINS	Dimensions in mm (inches)					
		A	B	C	D	E	F
EPC10	8	5.5	10.2	11.5+/-0.5	2.0	10.9	10.9
EPC13	10	6.8	17.2	20.2+/-0.2	3.0	14	14
EPC19	10	9.5	22.5	25	3.5	20	20
EPC25	10	11.5	27.6	29.6	3.8	25	25

TYPE : H ->HORIZONTAL TYPE V ->VERTICAL TYPE

DESIGN AS CUSTOMER'S REQUESTED SPECIFICATIONS

ETD Series

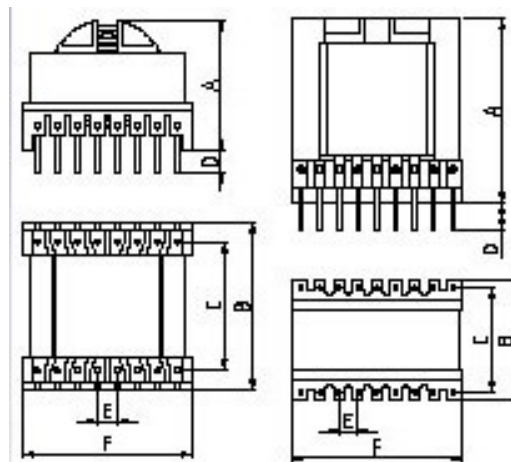

Shape & Dimensions in mm

PART NO.	TERMINALPINS	Dimensions in mm (inches)						
		A	B	C+/-0.5	D+/-0.5	E+/-0.5	F	TYPE
ETD-24	12	35.6	21	17.8	4	5.08	36.1	V
ETD-29	12	40.9	24	20.3	4	5.08	41.8	V
ETD-29	14	24.9	35.1	25.5	4	5	35.7	H
ETD-34	16	39.9	31.7	25.5	4	5	42	V
ETD-34	14	29.8	40	25.5	4	5	39.9	H
ETD-39	14	35.6	44.2	30.7	4	5	44.6	H
ETD-44	18	42	32	27.5	4	5	45	V
ETD-44	18	39.6	51.3	35.7	4	5	49.8	H
ETD-49	22	57.5	36	27.5	5	5	53.7	V
ETD-49	20	41.4	57.2	40.7	5	5	54.7	H

TYPE : H ->HORIZONTAL TYPE V ->VERTICAL TYPE

DESIGN AS CUSTOMER'S REQUESTED SPECIFICATIONS

Switching Power Transformers

PQ Series

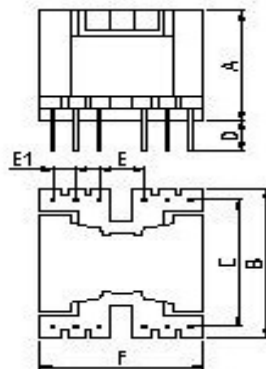

Shape & Dimensions in mm

PART NO.	TERMINALPINS	Dimensions in mm (inches)					
		A	B	C+/-0.5	D+/-0.5	E+/-0.5	F
PQ-2016	14	18.5	23.2	20.6	4	5	3.8
PQ-2020	14	22.3	23	20.3	4	5	3.8
PQ-2620	12	20	29.3	25.4	4	7.7	3.8
PQ-2625	12	28.5	29.6	25.5	4	7.62	3.8
PQ-3220	12	23.5	34.4	30.7	4	7.62	3.8
PQ-3230	12	33.5	34.2	30.7	4	7.52	5.08
PQ-3535	12	37.5	39.1	35.6	5	10.16	5.08
PQ-4040	12	41.5	42	38	5	15	5.08

TYPE : H ->HORIZONTAL TYPE V ->VERTICAL TYPE

DESIGN AS CUSTOMER'S REQUESTED SPECIFICATIONS

EP Series

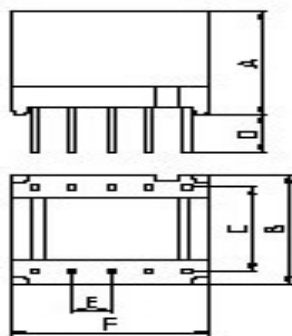

Shape & Dimensions in mm

PART NO.	TERMINALPINS	Dimensions in mm (inches)						TYPE
		A	B	C+/-0.5	D+/-0.5	E+/-0.5	F	
EP-7	6	9.6	7.4	5.08	4	2.54	9.3	H
EP-10	8	11.8	11	7.5	4	2.5	11	H
EP-13	10	12.7	13.5	10	4	2.5	13.2	H
EP-17	8	15.7	19	15	4	5	19	H
EP-20	10	19.6	22	17.78	4	5.08	25.1	H

TYPE : H ->HORIZONTAL TYPE V ->VERTICAL TYPE

DESIGN AS CUSTOMER'S REQUESTED SPECIFICATIONS