



**Data Sheet**



Product Category: RF SAW Filter

Part Number	Package	Application	Last Modified
862-RF1086.0M-A	3.0 x 3.0 SMD	Wireless	Jan. 01, 2007

TYPE :

Wireless, Balanced RF SAW Filter



PART NUMBER :

**862-RF1086.0M-A**

**OPERATING CONDITIONS / ELECTRICAL CHARACTERISTICS**

PARAMETERS	Condition	Minimum	Typical	Maximum	Units
Center Frequency (Fo)	-	-	1086.0	-	MHz
Maximum Insertion Loss	1081.0~ 1091.0 MHz	-	3.5	4.5	dB
Stop Band Attenuation:	500.0~ 988.0 MHz	50	57	-	dB
	988.0~ 1002.0 MHz	45	50	-	
	1038.0~ 1046.0MHz	35	40	-	
	1156.0~ 1600.0 MHz	40	45	-	
	2040.0~ 2148.0 MHz	30	35	-	
Amplitude Ripple	1081.0~ 1091.0 MHz	-	0.6	1.5	dB
Input/ Output VSWR	1081.0~ 1091.0 MHz	-	2.0	2.5	-
Source Impedence (balanced ended)*	-	-	200	-	ohm
Load Impedence (balanced ended)*	-	-	200	-	ohm
Group Delay Ripple	1081.0~ 1091.0 MHz	-	7.0	-	ns
Maximum DC Voltage	-	-	-	0	V
Phase Balance	1081.0~ 1091.0 MHz	-	10	-	deg.
Maximum Input Power	-	-	-	0	dBm
Operating Temperature	-	-40	-	+85	°C

\* No Matching Network

**PACKAGE OUTLINE (mm)**

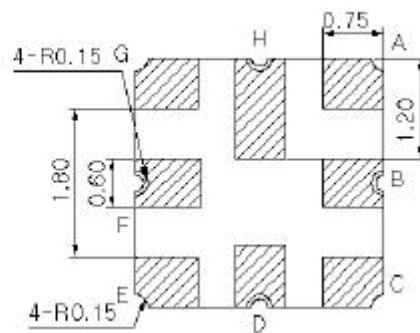
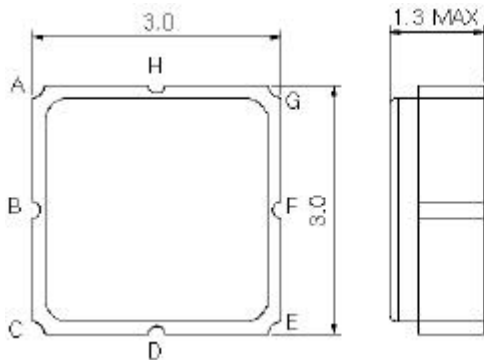

PIN LAYOUT	
A	In
B	Ground
C	In
D	Ground
E	Out
F	Ground
G	Out
H	Ground

**TEST FIXTURE**

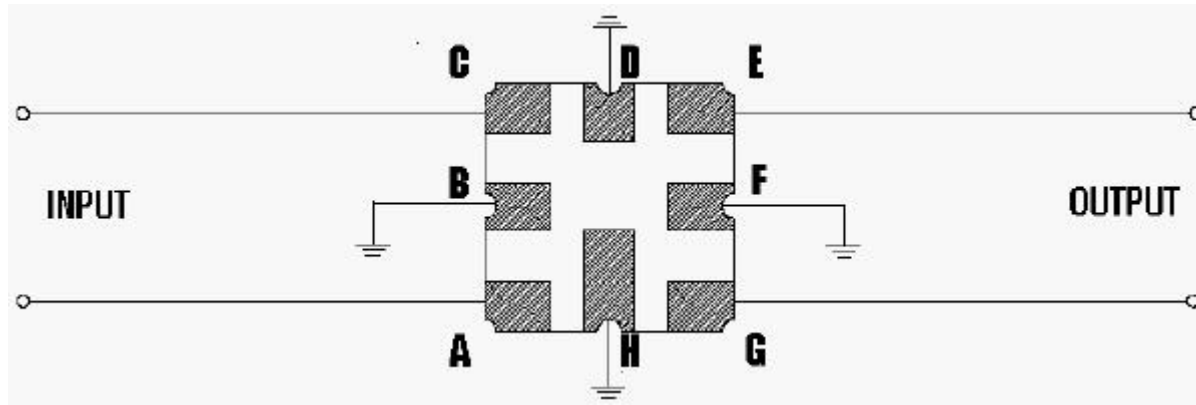

Load Impedance = 200 ohms  
 Source Impedance = 200 ohms

### FREQUENCY RESPONSE

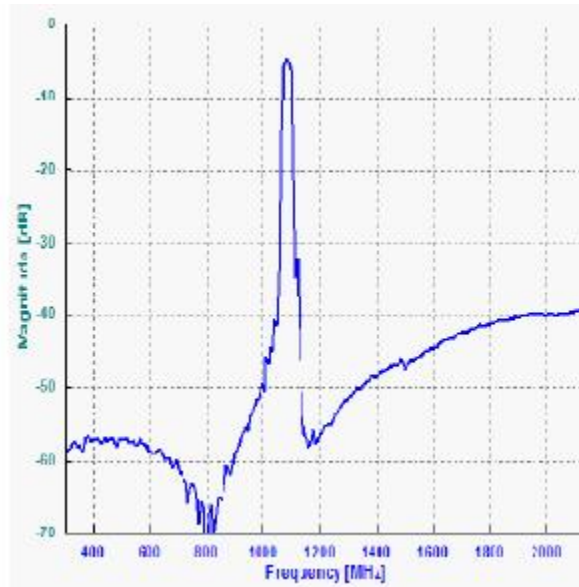
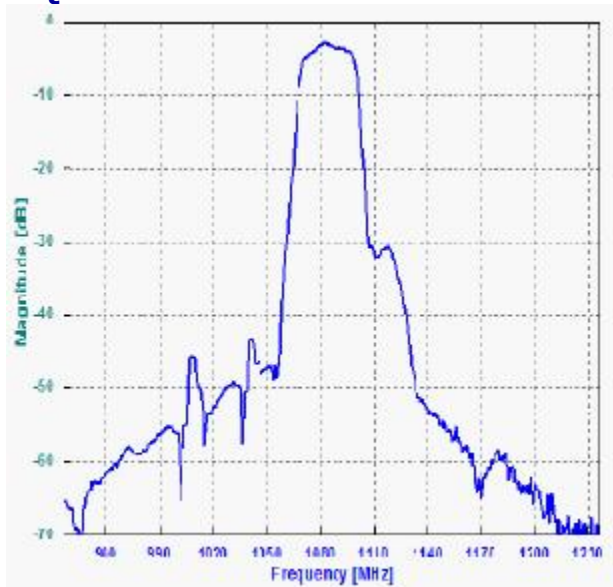

### VSWR

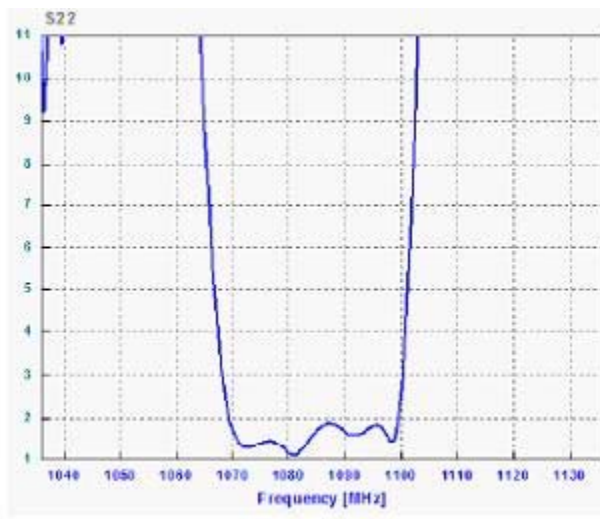
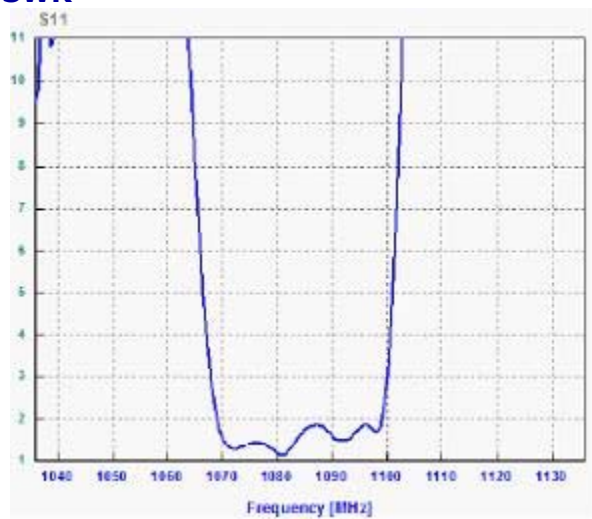

### SMITH CHART

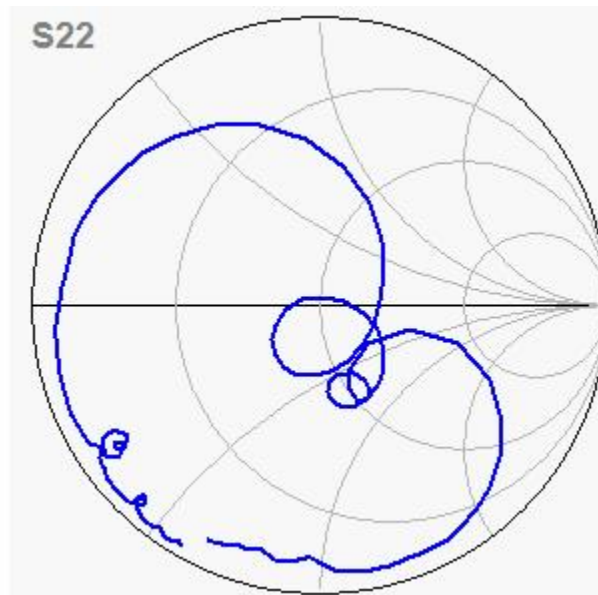
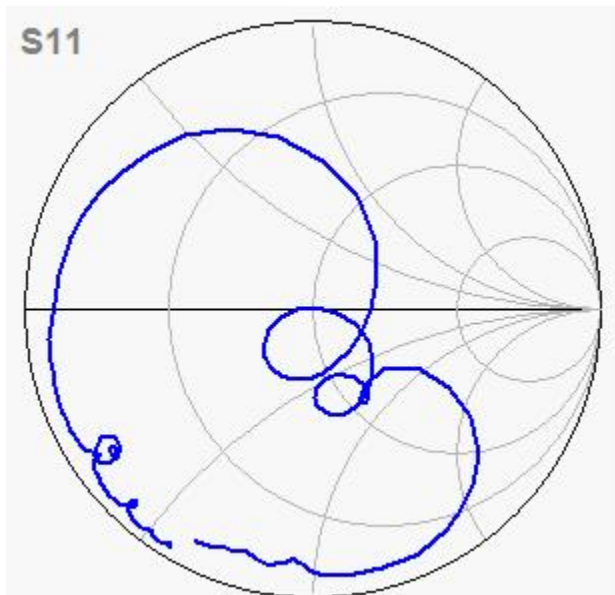

**Oscilent Corporation** - CALL **949.252.0522**

18195 East McDermott Street , Building D , Irvine , CA 92614 , USA

Fax: 949.252.0599 , E-Mail: [Sales@Oscilent.com](mailto:Sales@Oscilent.com)

**Part No.:** 862-RF1086.0M-A