

MBC13900

Product Preview

The RF Building Block Series NPN Silicon Low Noise Transistor

The MBC13900 is a high performance transistor fabricated using Motorola's 15 GHz f_T bipolar IC process. It is housed in the 4-lead SC-70 (SOT-343) surface mount plastic package resulting in a parasitic effect reduction and RF performance enhancements. The high performance at low power makes the MBC13900 suitable for front-end applications in portable wireless systems such as pagers, cellular and cordless phones.

- Low Noise Figure, $NF_{min} = 1.0$ dB (Typ) @ 1.0 GHz, 3.0 V and 3.0 mA
- Maximum Stable Gain, 22 dB @ 1.0 GHz, 3.0 V and 3.0 mA
- Output Third Order Intercept, $OIP_3 = 23$ dBm @ 1.0 GHz, 3.0 V and 22 mA
- Ultra small SOT-343 Surface Mount Package
- Available Only in Tape and Reel Packaging

RF NPN SILICON TRANSISTOR

$f_T = 15$ GHz
 $NF_{min} = 1.2$ dB
 $I_{CMAX} = 20$ mA
 $V_{CEO} = 5.0$ V

SEMICONDUCTOR TECHNICAL DATA

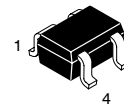

(Scale 4:1)

PLASTIC PACKAGE
CASE 318M
(SOT-343, Tape & Reel Only)

PIN CONNECTIONS

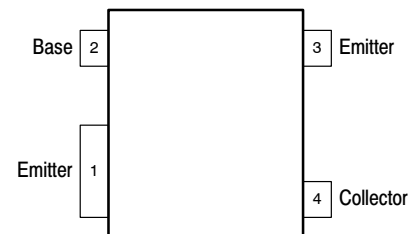

ORDERING INFORMATION

Device	Package
MBC13900	SOT-343

MBC13900
NOTES

MBC13900
NOTES

MBC13900

OUTLINE DIMENSIONS

PLASTIC PACKAGE
CASE 318M-01
(SOT-343)
ISSUE O

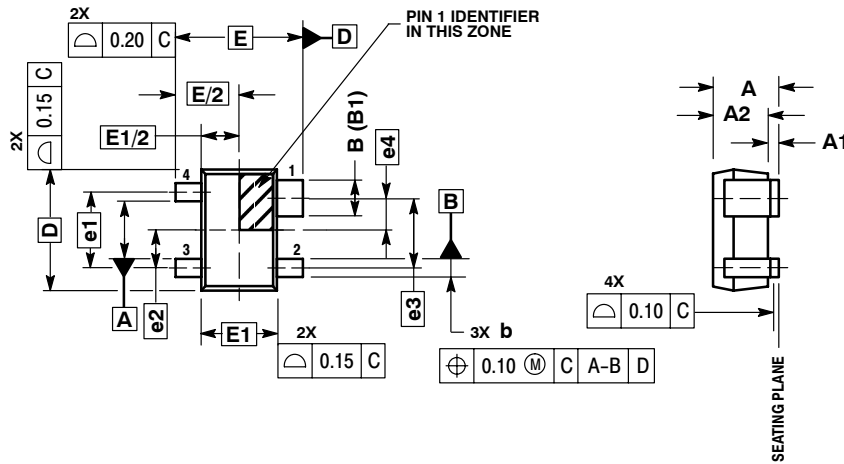

NOTES:

1. DIMENSIONS ARE IN MILLIMETERS.
2. INTERPRET DIMENSIONS AND TOLERANCES PER ASME Y14.5M, 1994.
3. DIMENSION D DOES NOT INCLUDE MOLD FLASH, PROTRUSIONS OR GATE BURRS. MOLD FLASH, PROTRUSIONS OR GATE BURRS SHALL NOT EXCEED 0.15mm PER END. DIMENSION E1 DOES NOT INCLUDE INTERLEAD FLASH OR PROTRUSION. INTERLEAD FLASH OR PROTRUSION SHALL NOT EXCEED 0.15mm PER SIDE.
4. DIMENSIONS D AND E1 ARE DETERMINED AT THE OUTMOST EXTREMES OF THE PLASTIC BODY EXCLUSIVE OF MOLD FLASH, TIE BAR BURRS, GATE BURRS AND INTERLEAD FLASH, BUT INCLUDING ANY MISMATCH BETWEEN THE TOP AND BOTTOM OF PLASTIC BODY.
5. DATUMS A, B AND D TO BE DETERMINED 0.10mm FROM THE LEAD TIP.
6. TERMINAL NUMBERS ARE SHOWN FOR REFERENCE ONLY.
7. THESE DIMENSIONS APPLY TO THE FLAT SECTION OF THE LEAD BETWEEN 0.08mm AND 0.15mm FROM THE LEAD TIP.

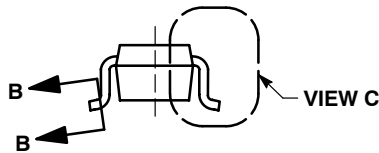

SECTION B-B
(SEE NOTE 7)

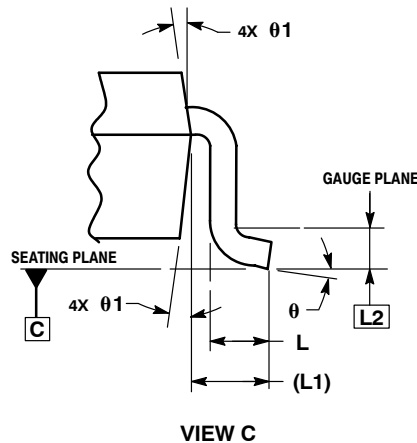
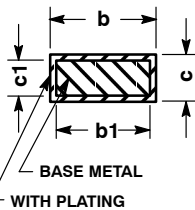

DIM	MILLIMETERS	
	MIN	MAX
A	---	1.10
A1	0.00	0.10
A2	0.80	1.00
b	0.25	0.40
b1	0.25	0.35
B	0.55	0.70
B1	0.55	0.65
c	0.10	0.25
c1	0.08	0.20
D	2.00	BSC
E	2.10	BSC
E1	1.25	BSC
e1	1.30	BSC
e2	0.65	BSC
e3	1.15	BSC
e4	0.50	BSC
L	0.26	0.46
L1	0.425	REF
L2	0.15	BSC
theta	0°	8°
theta 1	4°	10°

Motorola reserves the right to make changes without further notice to any products herein. Motorola makes no warranty, representation or guarantee regarding the suitability of its products for any particular purpose, nor does Motorola assume any liability arising out of the application or use of any product or circuit, and specifically disclaims any and all liability, including without limitation consequential or incidental damages. "Typical" parameters which may be provided in Motorola data sheets and/or specifications can and do vary in different applications and actual performance may vary over time. All operating parameters, including "Typicals" must be validated for each customer application by customer's technical experts. Motorola does not convey any license under its patent rights nor the rights of others. Motorola products are not designed, intended, or authorized for use as components in systems intended for surgical implant into the body, or other applications intended to support or sustain life, or for any other application in which the failure of the Motorola product could create a situation where personal injury or death may occur. Should Buyer purchase or use Motorola products for any such unintended or unauthorized application, Buyer shall indemnify and hold Motorola and its officers, employees, subsidiaries, affiliates, and distributors harmless against all claims, costs, damages, and expenses, and reasonable attorney fees arising out of, directly or indirectly, any claim of personal injury or death associated with such unintended or unauthorized use, even if such claim alleges that Motorola was negligent regarding the design or manufacture of the part. Motorola, Inc. is an Equal Opportunity/Affirmative Action Employer. MOTOROLA and the M logo are registered in the US Patent & Trademark Office. All other product or service names are the property of their respective owners.

© Motorola, Inc. 2002

How to reach us:

USA/EUROPE/Locations Not Listed: Motorola Literature Distribution;
P.O. Box 5405, Denver, Colorado 80217. 1-303-675-2140 or 1-800-441-2447

JAPAN: Motorola Japan Ltd.; SPS, Technical Information Center, 3-20-1,
Minami-Azabu, Minato-ku, Tokyo 106-8573 Japan. 81-3-3440-3569

Technical Information Center: 1-800-521-6274

ASIA/PACIFIC: Motorola Semiconductors H.K. Ltd.; Silicon Harbour Centre,
2, Dai King Street, Tai Po Industrial Estate, Tai Po, N.T., Hong Kong.
852-26668334

HOME PAGE: <http://www.motorola.com/semiconductors/>

