

TR5® / No. 382

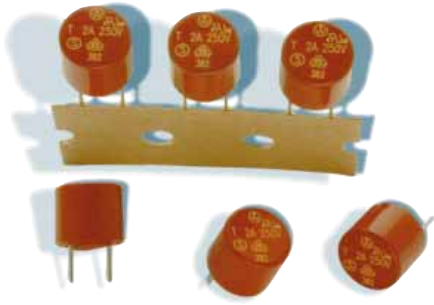

Dimensions (mm)

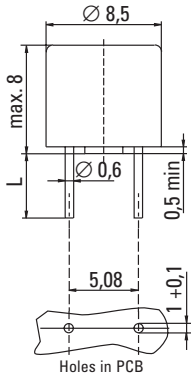

Long Leads (L=18.8mm)
Short Leads (L=4.3mm)

IEC 60127-3/IV, 250V, T

Time-Current Characteristic

Time Lag (T)

Standard

IEC 60127-3/IV

Approvals

VDE: License No. 122750
SEMKO: Certificate No. 9937118
cULus Recognized: File No. E 67006
MITI: File No. 32-1926

Features

Enhanced breaking capacity
Reduced PCB space requirements
Direct solderable or plug-in versions
Internationally approved
Low internal resistance
Shocksafe casing
Vibration resistant

WebLinks

Data Sheet

www.wickmann.com/products/382.pdf

Approval Certificates

www.wickmann.com/approvals

Time-Current Curve

Page 59
www.wickmann.com/itcurves

Packaging

Page 118
www.wickmann.com/pack

FaxBack Document # 300

Specifications

Packaging

000: Tape/Ampopack (1000 pcs.)
041: Short Leads - Bulk (1000 pcs.)

Materials

Base/Cap: Brown Thermoplastic
Polyamide PA 6.6, UL 94V0
Round Pins: Copper alloy, tin plated

Operating Temperature

-40°C to +85°C (consider de-rating)

Climatic Category

-25°C/+70°C/21 days (IEC 60068-2-1..3)

Stock Conditions

+10°C to +60°C
relative humidity ≤ 75% yearly average,
without dew, maximum value for 30 days-95%

Vibration Resistance

24 cycles at 15 min. each (IEC 60068-2-6)
10 - 60Hz at 0.75mm amplitude
60 - 2000Hz at 10g acceleration

Lead Pull Strength

10N (IEC 60068-2-21)

Solderability

260°C, ≤ 3 sec. (Wave)
350°C, ≤ 1 sec. (Hand)

Soldering Heat Resistance

260°C, 10 sec. (IEC 60068-2-20)

Marking

 , 382, 250V, T, Current Rating, Approvals

Unit Weight

0.82g (approx.)

Limits for Pre-arcing Time					
Rated Current	1.5 x I _{Rated}	2.1 x I _{Rated}	2.75 x I _{Rated}	4 x I _{Rated}	10 x I _{Rated}
1.00A ... 5.00A	> 1h	< 2 min	400ms ... 10s	150ms ... 3s	20ms ... 150ms



Permissible continuous operating current is ≤ 100% at ambient temperature of 23°C (73.4°F).										
Rated Current	Amp Code	Voltage Rating	Breaking Capacity	Voltage Drop 1.0 x I _{Rated} max. (mV)	Power Dissipation 1.5 x I _{Rated} max. (mW)	Melting Integral 10 x I _{Rated} min. (A²s)	Approvals			
							VDE	SEMKO	cULus	MITI
1.00A	1100	250V		100	400	3.0	•	•	•	•
1.25A	1125	250V		95	465	4.5	•	•	•	•
1.60A	1160	250V		90	490	9.0	•	•	•	•
2.00A	1200	250V	100A/250VAC ¹	85	670	12	•	•	•	•
2.50A	1250	250V	50-60Hz	80	750	22	•	•	•	•
3.15A	1315	250V	cos φ = 1.0	75	900	32	•	•	•	•
4.00A	1400	250V		70	1200	58	•	•	•	•
5.00A	1500	250V		65	1250	90	G	G	•	•

¹ Breaking capacity ratings per approval agencies:
VDE: 35 A or 10 x I_{Rated} at 250V, whichever is greater.
100 A at 250V; Expert Report
SEMKO: 35 A or 10 x I_{Rated} at 250V, whichever is greater.
UL: 50 A at 250V
MITI: 100A at 250V

^G Expert Report

Order Information

Qty.	Order-Number	Series	Amp Code	Packaging
		382		

TR5® / No. 382

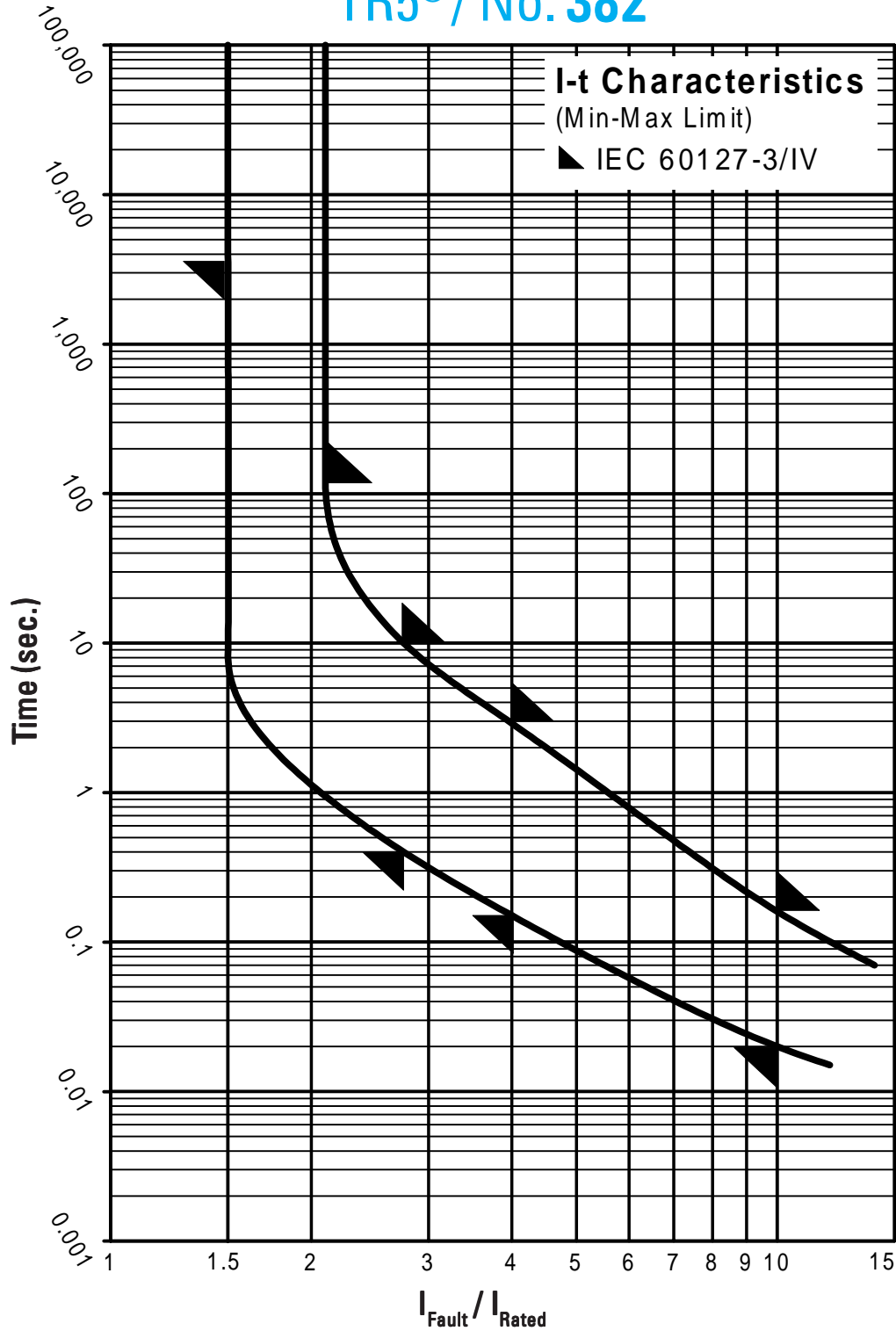

Contact WICKMANN for individual I-t curves