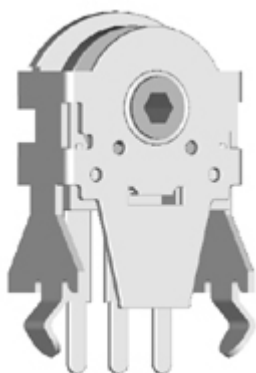
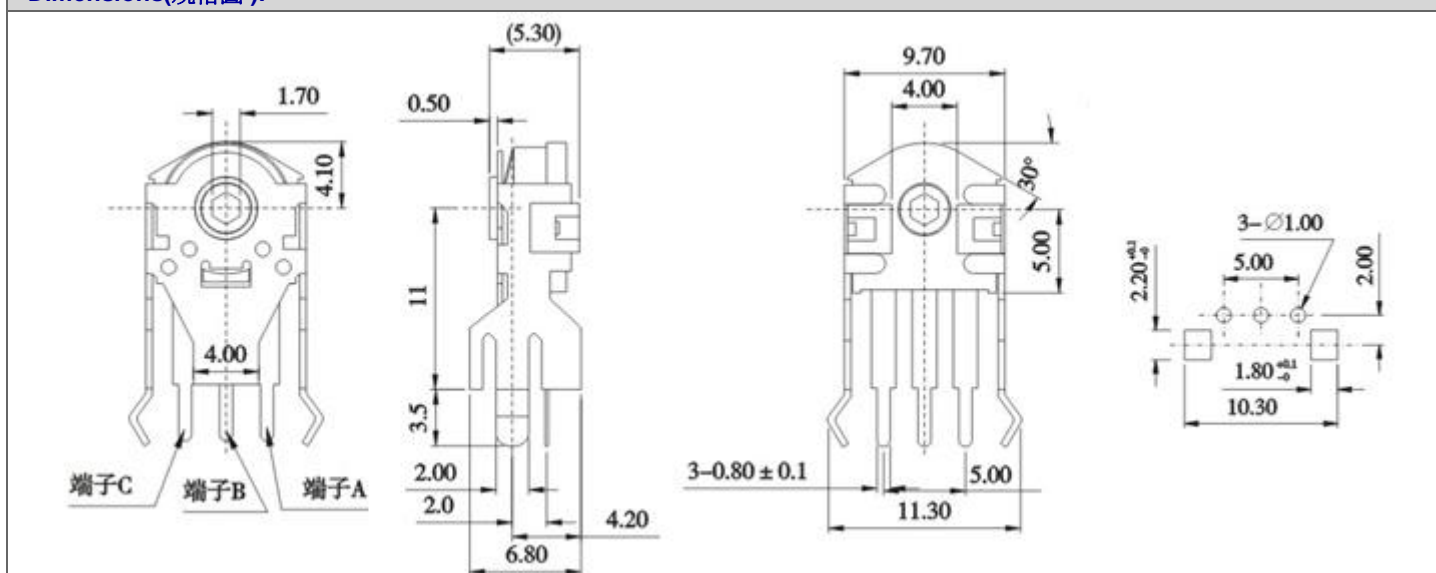

**Model(型號): ROTARY POTENTIOMETER-----EC10A12V110**
[► Download PDF file](#)

**Features:(特點):**

Small body as thin as 4.4mm . height from the shaft centre to the product top is only 3.6mm .  
 A long-life type that can operate more than 100,000 cycles .  
 The operability has been improved by incorporating a good-feeling detent mechanism .  
 The unique through shaft shape contribute for simplifying SET design .An incremental type

**Applications(作用):**

Various controls for personal computer input device , AV equipment , communication equipment , etc .

**Dimensions(規格圖):**

**Specifications( 規格)**

|                               |                            |
|-------------------------------|----------------------------|
| Pulses / rotation [分解能]       | 12                         |
| Output Code [輸出代碼]            | Phase difference 2 signals |
| Total rotational angle [回轉角度] | 360°                       |
| Rotational life [回轉壽命]        | More than 10,000 cycles    |

**OUTPUT SIGNAL 輸出信號**

[The broken line shows detent position of with detent type 圖中虛線表示子點位置]

| CW<br>順時針方向 |     | CCW<br>逆時針方向 |     |
|-------------|-----|--------------|-----|
| A 信號        | OFF | A 信號         | OFF |
| ON          |     | ON           |     |
| B 信號        | OFF | B 信號         | OFF |
| ON          |     | ON           |     |