

## 571-4250 Insulated solder terminal, Turreted, Feed thru

Recommended mounting hole .158 (4,01)

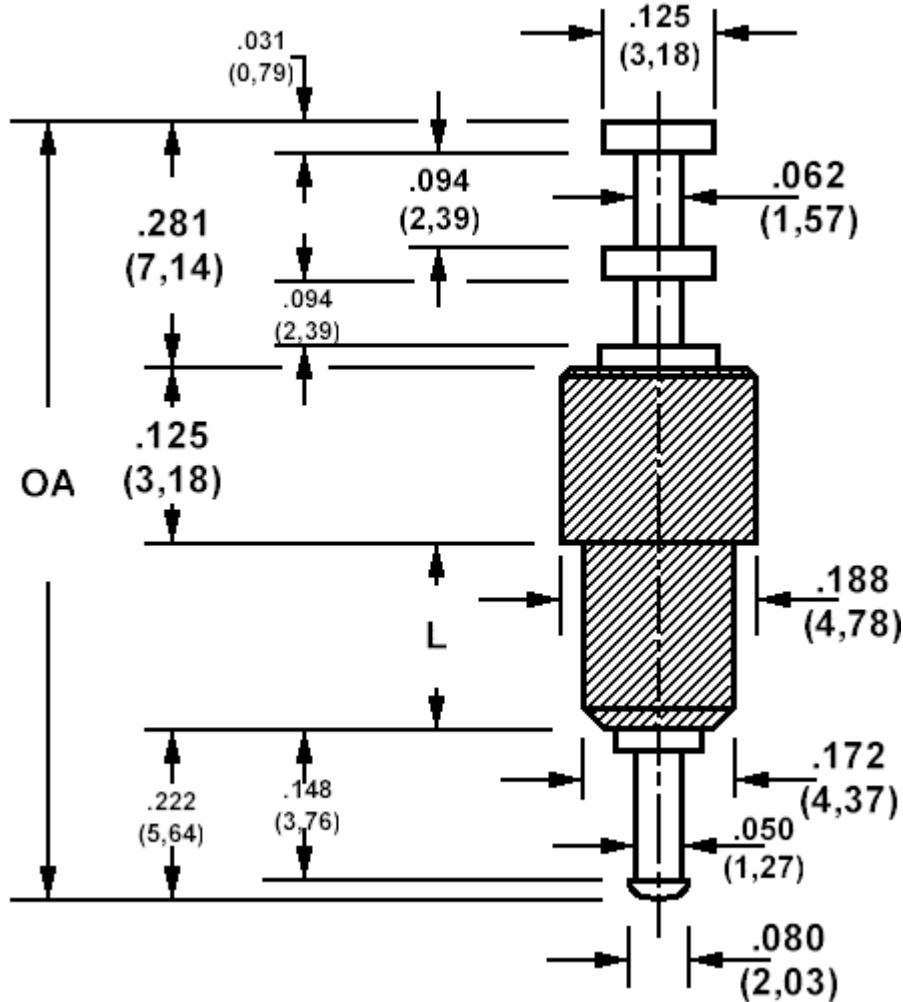

How to order code  
**571-4250-01-YY-19**

Basic Part No (XX = panel thickness, YY = plating finish. See tables for options)

| Basic Part No. |     | OA (ref)      | L           | Panel Thickness (XX)       |
|----------------|-----|---------------|-------------|----------------------------|
| 571-4250       | -01 | 0.828 (21,03) | .200 (5,08) | .031 (0,79) to .162 (4,11) |

| Component | Material       | Finish (YY) |                |
|-----------|----------------|-------------|----------------|
|           |                | -01         | -05            |
| Terminal  | Brass          | Silver      | Electro Solder |
| Insulator | Teflon - white |             |                |

| Additional Specifications   |      |
|-----------------------------|------|
| Flashover VRMS at Sea Level | 5500 |
| Capacitance (pF)            | 1.0  |

Teflon is a registered trademark of Dupont