

SHIELDED, LOW PROFILE WIREWOUND POWER INDUCTOR



3.2 x 3.2mm

ASPI-2D



RoHS
Compliant

FEATURES:

- Magnetic shielded for low radiation
- Low profile, compact size
- Large Terminal surface for good PCB bonding
- Low DCR, suitable for large currents
- Ideal for a variety of DC-DC converter inductor applications

APPLICATIONS:

- Desktop, notebook, servers
- Network hubs, bridges, routers
- Portable communication equipment
- OA equipment
- LCD, DVD, modem, set-top box
- Battery charger
- DC/DC converters

STANDARD SPECIFICATIONS:

PARAMETERS

ABRACON P/N:	ASPI-2DXX Series
Operating temperature:	-30°C to +100°C
Storage temperature:	Under 25°C; Humidity<75% RH
Test Frequency:	100kHz, 1Vrms

ASPI-2D09-	L (μH)	Tolerance	RDC max (Ω)	Rated Current (A)	Irms typ. (A)
1R2	1.2	N	0.0975	0.8	1.24
1R5	1.5	N	0.11	0.73	1.15
1R8	1.8	N	0.1313	0.65	1.06
2R2	2.2	N	0.1438	0.6	1.05
2R7	2.7	N	0.15	0.53	0.98
3R3	3.3	N	0.1938	0.47	0.84
3R9	3.9	N	0.225	0.45	0.72
4R7	4.7	M, N	0.2875	0.41	0.64
5R6	5.6	N	0.325	0.37	0.59
6R8	6.8	N	0.425	0.33	0.53
8R2	8.2	N	0.475	0.3	0.46
100	10	M, N	0.5375	0.28	0.42

ASPI-2D11-	L (μH)	Tolerance	RDC max (Ω)	Rated Current (A)	Irms typ. (A)
1R5	1.5	N	0.068	0.9	1.48
2R2	2.2	N	0.098	0.78	1.27
3R3	3.3	N	0.123	0.6	1.02
4R7	4.7	M, N	0.17	0.5	0.88
6R8	6.8	N	0.26	0.44	0.8
100	10	M, N	0.4	0.35	0.65



SHIELDED, LOW PROFILE WIREWOUND POWER INDUCTOR

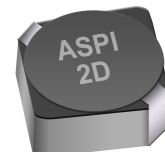

3.2 x 3.2mm

ASPI-2D



RoHS
Compliant

ASPI-2D14-	L (uH)	Tolerance	RDC max (Ω)	Rated Current (A)	Irms typ. (A)
1R5	1.5	N	0.063	1.8	2
1R8	1.8	N	0.075	1.65	1.8
2R2	2.2	N	0.094	1.5	1.6
2R7	2.7	N	0.106	1.35	1.4
3R3	3.3	N	0.125	1.2	1.24
3R9	3.9	N	0.138	1.1	1.12
4R1	4.1	M, N	0.169	1	1
4R7	4.7	M, N	0.169	1	1
5R6	5.6	M, N	0.188	0.95	0.98
6R8	6.8	M, N	0.213	0.85	0.92
8R2	8.2	M, N	0.281	0.8	0.8
100	10	M, N	0.294	0.7	0.76
120	12	M, N	0.394	0.62	0.64

ASPI-2D18L-	L (uH)	Tolerance	RDC max (Ω)	Rated Current (A)	Irms typ. (A)
2R2	2.2	M,N	0.041	0.85	2.3
3R3	3.3	M,N	0.054	0.75	2.1
4R7	4.7	M,N	0.078	0.63	1.65
6R8	6.8	M,N	0.106	0.52	1.32
100	10	M,N	0.18	0.43	1
150	15	M,N	0.22	0.35	0.8
220	22	M,N	0.32	0.3	0.68
330	33	M,N	0.46	0.24	0.56
470	47	M,N	0.66	0.2	0.48

ASPI-2D18H-	L (uH)	Tolerance	RDC max (Ω)	Rated Current (A)	Irms typ. (A)
1R7	1.7	M, N	0.044	1.85	2.2
2R2	2.2	M, N	0.06	1.6	1.9
3R3	3.3	M, N	0.086	1.45	1.55
4R7	4.7	M, N	0.14	1.2	1.2
6R3	6.3	M, N	0.16	1.05	1.15
100	10	M, N	0.245	0.85	0.9
150	15	M, N	0.345	0.7	0.64

NOTE:

* Rated Current: The rated current indicates the current when the inductance decrease to 65% over of its nominal value or DC current when the temperature rising 40°C, whichever is lower.

* Test Frequency: 100KHz, 1V

TEST INSTRUMENT:

L: HP4192A LF impedance analyzer
Rdc: CH502BC
Rated Current: HP4284+42841A or CH1061+CH301A

➤ **OPTIONS AND PART IDENTIFICATION:**

(Left blank if standard)

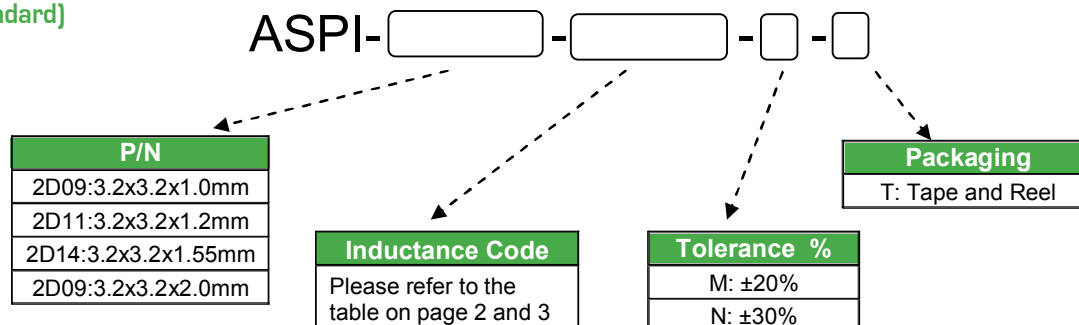

SHIELDED, LOW PROFILE WIREWOUND POWER INDUCTOR



3.2 x 3.2mm

ASPI-2D



RoHS
Compliant

OUTLINE DRAWING:

Dimensions: Inches (mm)

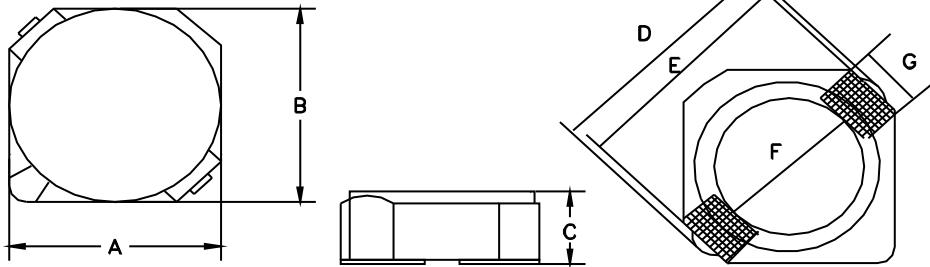

Recommended Land Pattern

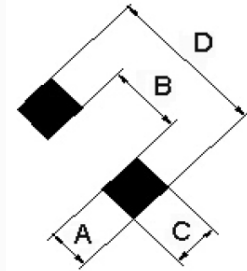

P/N	A(Max)	B(Max)	C(Max)	D(Max)	E	F	G
ASPI-2D09	3.2	3.2	1.0	4.5	3.3	2.1	1.0
ASPI-2D11	3.2	3.2	1.2	4.5	3.3	2.1	1.0
ASPI-2D14	3.2	3.2	1.55	4.5	3.3	2.1	1.0
ASPI-2D18L	3.2	3.2	2.0	4.5	3.3	2.1	1.0
ASPI-2D18H	3.2	3.2	2.0	4.5	3.3	2.1	1.0

A	B	C	D
1.3	1.7	1.3	4.3

TAPE & REEL: T= tape and reel(1,000pcs per reel)

REFLOW PROFILE:

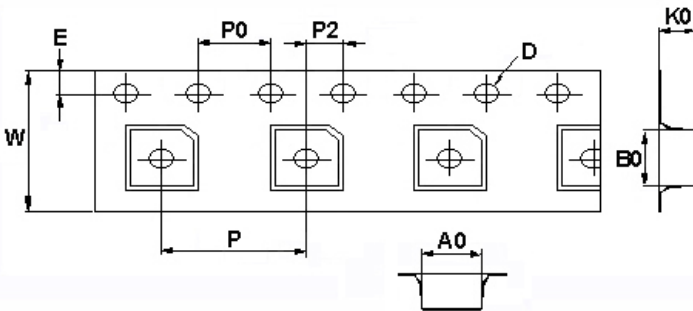

P/N	A0	B0	K0	D	E	W	P	P0	P2
ASPI-2D09	3.35	3.35	1.4	1.55	1.75	12	8	4	2
ASPI-2D11	3.35	3.35	1.4	1.55	1.75	12	8	4	2
ASPI-2D14	3.35	3.35	1.7	1.55	1.75	12	8	4	2
ASPI-2D18L	3.35	3.35	2.1	1.55	1.75	12	8	4	2
ASPI-2D18H	3.35	3.35	2.1	1.55	1.75	12	8	4	2

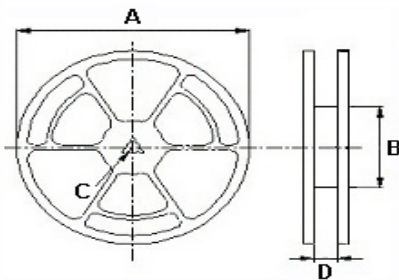

Dimensions:
mm

A	B	C	D
178	60	13	13.2

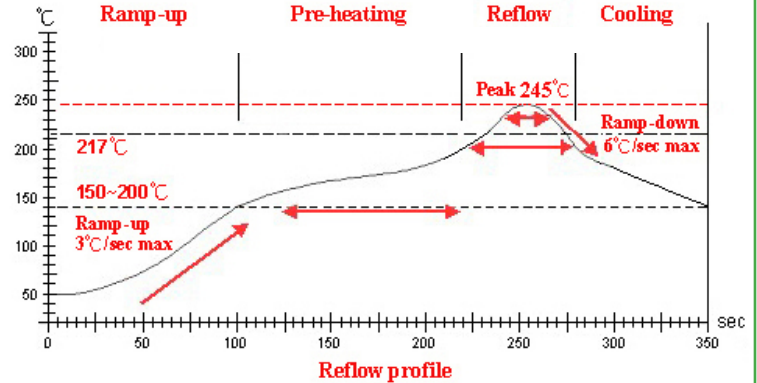

Item	Ramp-up	Pre-heating	Reflow	Peak Temp.	Cooling
Temp. scope	R.T. ~ 150°C	150°C ~ 200°C	217°C	260±5°C	Peak Temp. ~ 150°C
Time spec.	--	60 ~ 180 sec	60 ~ 150 sec	20 ~ 40 sec	--

ATTENTION: Abracon Corporation's products are COTS – Commercial-Off-The-Shelf products; suitable for Commercial, Industrial and, where designated, Automotive Applications. Abracon's products are not specifically designed for Military, Aviation, Aerospace, Life-dependant Medical applications or any application requiring high reliability where component failure could result in loss of life and/or property. For applications requiring high reliability and/or presenting an extreme operating environment, written consent and authorization from Abracon Corporation is required. Please contact Abracon Corporation for more information.

ABRACON IS
ISO9001:2008
CERTIFIED



Visit www.abracon.com for Terms & Conditions of Sale **Revised: 08.10.10**
30332 Esperanza, Rancho Santa Margarita, California 92688
tel 949-546-8000 | fax 949-546-8001 | www.abracon.com