

POB SERIES RF CO-AXIAL CONNECTORS

Guide to products

The following are the typical products in the POB series. We also accept orders for designing and production according to special specifications. Client orders are invited.

Connectors for semi-rigid cables

The connectors for semi-rigid cables match two types of cables: .141-inch and .085-inch semi-rigid cables. .141-inch cables should be used in order to obtain the V.S.W.R. listed on P.129. .085-inch cables, which have good flexibility, are suitable in cases where the wiring is laid with a high density inside the set. In this case, the V.S.W.R. value will be higher than that of the .141-inch cables.

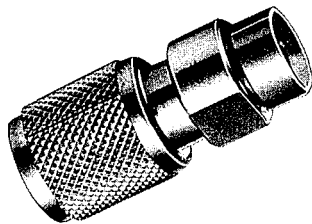

HRS No.	Part No.
* CL326-0001-0	POB-P-141
CL326-0002-3	POB-P-85

Plugs

- 141: for .141-inch semi-rigid cables
- 85: for .085-inch semi-rigid cables

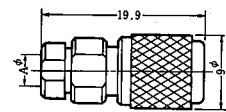
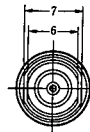

Part No.	Aφ
POB-P-141	3.63
POB-P-85	2.25

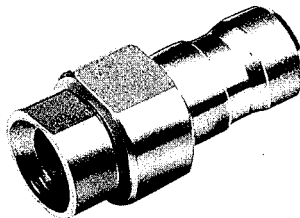

HRS No.	Part No.
CL326-0003-6	POB-J-141

Jacks

- 141: for .141-inch semi-rigid cables
- 85: for .085-inch semi-rigid cables

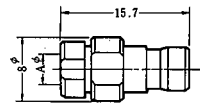
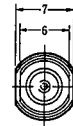

Part No.	Aφ
POB-J-141	3.63

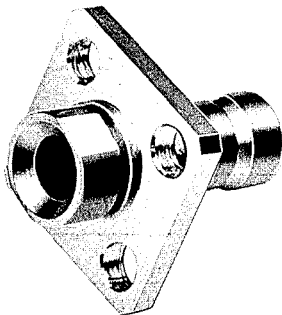

HRS No.	Part No.
CL326-0005-1	POB-PJ-141
* CL326-0006-4	POB-PJ-85

Panel jacks

- 141: for .141-inch semi-rigid cables
- 85: for .085-inch semi-rigid cables

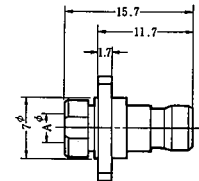
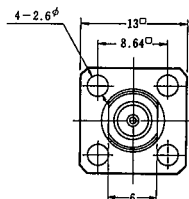

Part No.	Aφ
POB-PJ-141	3.63
POB-PJ-85	2.25

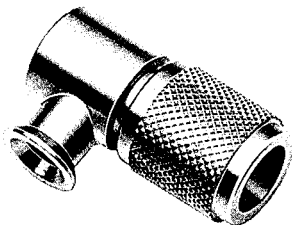

HRS No.	Part No.
CL326-0007-7	POB-LP-141
CL326-0008-0	POB-LP-85

L-type plugs

- 141: for .141-inch semi-rigid cables
- 85: for .085-inch semi-rigid cables

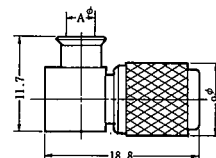

Part No.	Aφ
POB-LP-141	3.63
POB-LP-85	2.25