

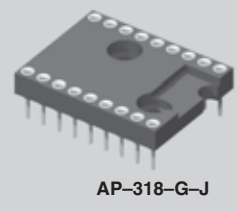

MOLD-TO-POSITION PRODUCT
 Minimums or set-up charges may apply. Call Samtec.

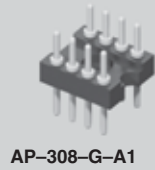

SCREW MOUNT ADAPTOR PLUGS

Mates with:
 IC, ICS, ICO,
 ICA, ICH

Machined pin DIP adaptor plugs

DIP adaptor plugs are available in a wide variety of lead counts from 8 through 64 pins.

Samtec offers a choice of many terminal styles including solder, wire-wrap, solder pot, and others. Terminals can be gold or tin plated. AP series adaptor plugs feature a UL rated G.F. polyester body with mounting holes.

Low cost stamped pin adaptor plugs and mating covers are also available from Samtec.

Specifications: AP

Insulator Material: Black Glass Filled Polyester
Flammability Rating: UL 94V-O
Insulation Resistance: 5000 megohm @ 500 VDC
Temperature Range: -55°C to +125°C
Withstanding Voltage: 1000 VRMS @ 60 Hz
Terminal Material: Brass except styles -M, -N, -P and -Q are Phosphor Bronze
Plating: Au over 50µ" Ni or Sn over 100µ" Cu or 50µ" Ni
Current Rating: 1 amp continuous @ 100 VDC per contact
Terminal Retention in Body: 5 lbs. against barb

Note: Some sizes, styles and options are non-standard, non-returnable.

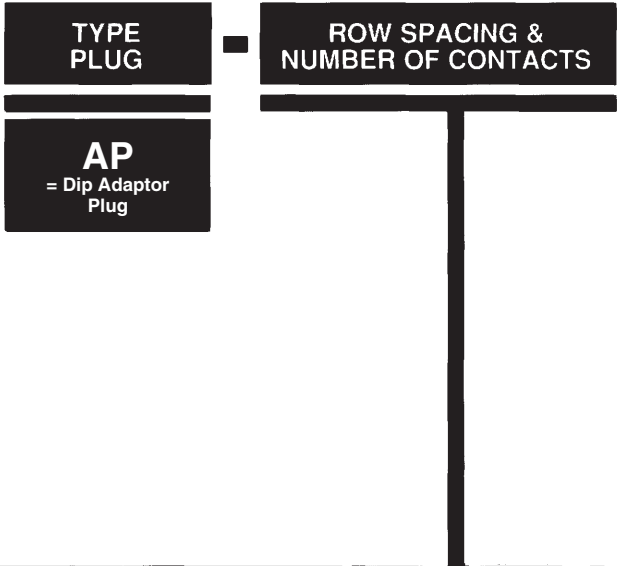

-306	= .300 Row	06Contacts
-308	= .300 Row	08 Contacts
-310	= .300 Row	10 Contacts

-314	= .300 Row	14 Contacts
-316	= .300 Row	16 Contacts
-318	= .300 Row	18 Contacts
-320	= .300 Row	20 Contacts
-324	= .300 Row	24 Contacts
-422	= .400 Row	22 Contacts
-424	= .400 Row	24 Contacts

-610	= .600 Row	10 Contacts
-614	= .600 Row	14 Contacts
-616	= .600 Row	16 Contacts
-618	= .600 Row	18 Contacts

Part No.	A LENGTH	B WIDTH
AP-306	(8,89) .350	(10,16) .400
AP-308	(11,43) .450	(10,16) .400
*AP-310	(13,97) .550	(10,16) .400

* Mounting hole off center on 10 position.

Part No.	A LENGTH	B WIDTH	E MNT HOLES
AP-314	(17,78) .700	(10,16) .400	(10,16) .400
AP-316	(20,32) .800	(10,16) .400	(12,70) .500
AP-318	(22,86) .900	(10,16) .400	(15,24) .600
AP-320	(25,40) 1.000	(10,16) .400	(17,78) .700
AP-324	(30,48) 1.200	(10,16) .400	(22,86) .900
AP-422	(27,94) 1.100	(10,16) .400	(20,32) .800
AP-424	(30,48) 1.200	(12,70) .500	(22,86) .900

Part No.	A LENGTH
AP-610	(12,70) .500
AP-614	(17,78) .700
AP-616	(20,32) .800
AP-618	(22,86) .900

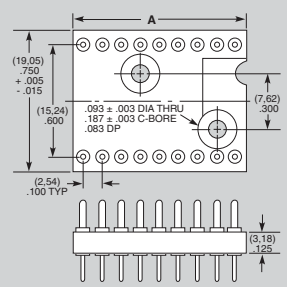
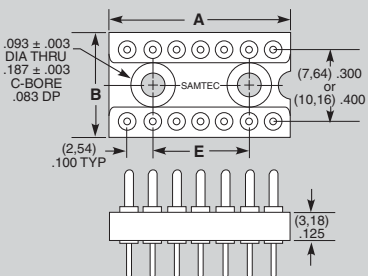
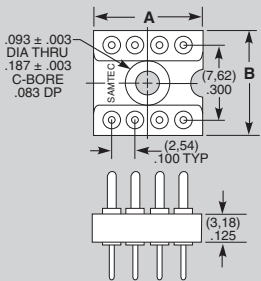

Due to technical progress, all designs, specifications and components are subject to change without notice.

WWW.SAMTEC.COM



MOLD-TO-POSITION PRODUCT
 Minimums or set-up charges may apply. Call Samtec.

AP-614-T-J

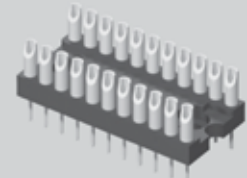
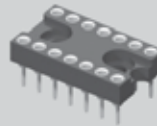

AP-422-T-B

AP SERIES

PLATING OPTION

-G
 = 20µ" Gold

-T
 = Tin

STYLE OPTION

-A or -A1
 = Round Pin

STYLE	X DIA
-A	(0.64) .025
-A1	(0.46) .018

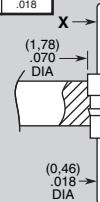

Style A Component No. = T-1R0-
 Style A1 Component No. = T-1R5-

-B
 = Solder Pot

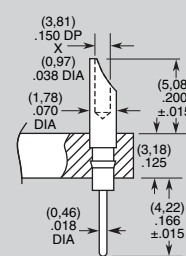

Component No. = T-1R1-

-C
 = Slotted Head

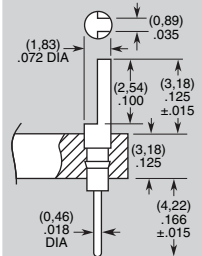

Component No. = T-1R2-

-D
 = Wire-Wrap

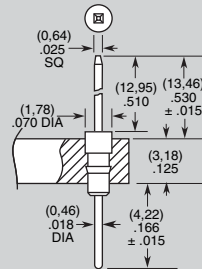

Component No. = T-1S4-1-1

-E
 = Slot-head W.W.

(-648 N/A)

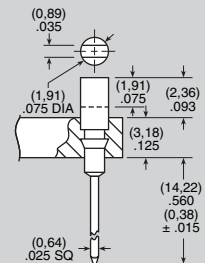

Component No. = T-1S5-

-J
 = Solder Shell

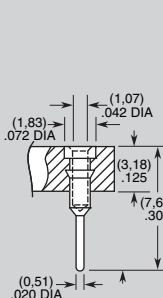

Component No. = S-1P1-

-M, -N or -P
 = Interconnect Post

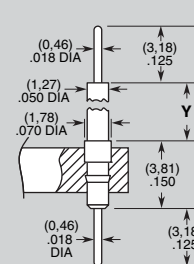

Component No. = T-1R14-

STYLE	Y
M	(1.52) .060
N	(4.67) .185
P	(11.05) .435

-624 = .600 Row 24 Contacts

-628 = .600 Row 28 Contacts

-632 = .600 Row 32 Contacts

-640 = .600 Row 40 Contacts

-940 = .900 Row 40 Contacts

-950 = .900 Row 50 Contacts

-964 = .900 Row 64 Contacts

Part No.	A LENGTH	B WIDTH
AP-624	(30,48) 1.200	(17,78) .700
AP-628	(35,56) 1.400	(17,78) .700
AP-632	(40,64) 1.600	(17,78) .700
*AP-640	(50,80) 2.000	(17,78) .700
*AP-940	(63,50) 2.500	(26,27) 1.050
*†AP-950	(63,50) 2.500	
AP-964	(81,28) 3.200	

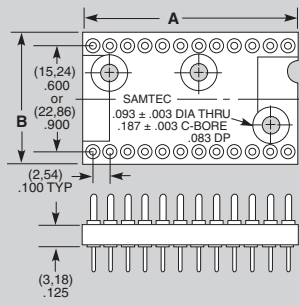

* AP-940 and AP-950 are non-standard non-returnable

† Mounting hole off center on 50 positions

Due to technical progress, all designs, specifications and components are subject to change without notice.

WWW.SAMTEC.COM