

## RING TERMINALS HEAVY DUTY

### Non-Insulated

- Brazed Seam
- Beveled Wire Lead-In

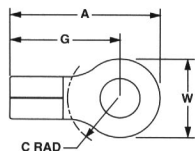

LISTED CERTIFIED

PANDUIT® Part Number	Wire Range	Stud Size	Dimensions (In.)				Std. Ctn. Qty.	Std. Ctn. Qty.	Bulk Pkg. Qty.	Bulk Ctn. Qty.	Crimp Tools
			A	W	C	G					
<b>P12-6HDR-L</b>	16-12 .05 Stock	#6	.78	.31	.36	.62	50	500	500	5000	CT-100 CT-200 CT-1570‡
<b>P12-8HDR-L</b>		#8	.78	.31	.36	.62	50	500	500	5000	
<b>P12-10HDR-L</b>		#10	.81	.37	.36	.62	50	500	500	5000	
<b>P12-14HDR-L</b>		1/4"	.96	.52	.43	.70	50	500	500	5000	
<b>P12-56HDR-L</b>		5/16"	.96	.52	.43	.70	50	500	500	5000	
<b>P12-38HDR-L</b>	3/8"	1.04	.58	.48	.75	50	500	500	5000		

Order the number of pieces required in multiples of standard package quantities.  
X = 10 pcs., E = 20 pcs., Q = 25 pcs., C = 100 pcs., T = 200 pcs., D = 500 pcs. and M = 1000 pcs.  
‡ UL and CSA approved tooling/product combinations.  
Prime items appear in **BOLD**.

## RING TERMINALS LARGE WIRE

### Non-Insulated

- Brazed Seam
- Beveled Wire Lead-In

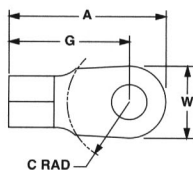
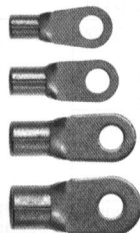

LISTED CERTIFIED

PANDUIT Part Number	Wire Range	Stud Size	Dimensions (In.)				Std. Ctn. Qty.	Std. Ctn. Qty.	Bulk Pkg. Qty.	Bulk Ctn. Qty.	Crimp Tools
			A	W	C	G					
<b>P8-8R-Q</b>	8 .040 Stock	#8	1.12	.42	.43	.91	25	250	200	2000	CT-1701‡
<b>P8-10R-Q</b>		#10	1.14	.47	.43	.91	25	250	200	2000	
<b>P8-14R-Q</b>		1/4"	1.14	.47	.43	.91	25	250	200	2000	
<b>P8-56R-Q</b>		5/16"	1.25	.59	.51	.95	25	250	200	2000	
<b>P8-38R-Q</b>		3/8"	1.25	.59	.51	.95	25	250	200	2000	
<b>P8-12R-Q</b>	1/2"	1.36	.82	.51	.95	25	250	200	2000		
<b>P6-8R-E</b>	6 .045 Stock	#8	1.21	.47	.43	.97	20	200	200	2000	
<b>P6-10R-E</b>		#10	1.21	.47	.43	.97	20	200	200	2000	
<b>P6-14R-E</b>		1/4"	1.21	.47	.43	.97	20	200	200	2000	
<b>P6-56R-E</b>		5/16"	1.33	.62	.51	1.02	20	200	200	2000	
<b>P6-38R-E</b>		3/8"	1.33	.62	.51	1.02	20	200	200	2000	
<b>P6-12R-E</b>	1/2"	1.43	.82	.51	1.02	20	200	200	2000		
<b>P4-10R-E</b>	4 .050 Stock	#10	1.40	.55	.50	1.12	20	200	200	2000	
<b>P4-14R-E</b>		1/4"	1.40	.55	.50	1.12	20	200	200	2000	
<b>P4-56R-E</b>		5/16"	1.46	.68	.50	1.12	20	200	200	2000	
<b>P4-38R-E</b>		3/8"	1.46	.68	.50	1.12	20	200	200	2000	
<b>P4-12R-E</b>		1/2"	1.55	.86	.53	1.12	20	200	200	2000	
<b>P2-10R-X</b>	2 .060 Stock	#10	1.46	.68	.58	1.12	10	100	200	2000	
<b>P2-14R-X</b>		1/4"	1.46	.68	.58	1.12	10	100	200	2000	
<b>P2-56R-X</b>		5/16"	1.46	.68	.58	1.12	10	100	200	2000	
<b>P2-38R-X</b>		3/8"	1.46	.68	.58	1.12	10	100	200	2000	
<b>P2-12R-X</b>		1/2"	1.55	.86	.58	1.12	10	100	200	2000	

Order the number of pieces required in multiples of standard package quantities.  
X = 10 pcs., E = 20 pcs., Q = 25 pcs., C = 100 pcs., T = 200 pcs., D = 500 pcs. and M = 1000 pcs.  
‡ UL and CSA approved tooling/product combinations.  
Prime items appear in **BOLD**.