

Condensateurs tantale à électrolyte gélifié
Boîtiers tantale hermétiques
Sorties axiales
Polarisés

Wet tantalum capacitors
Hermetically sealed tantalum cases
Axial leads
Polarised types

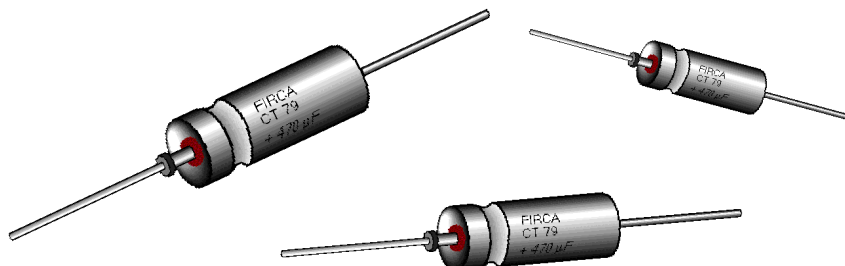

CT 79 (T3T - 40AW)

CT 79E (ST3T - 40AW)

(ESCC 3003/005)

CARACTERISTIQUES ELECTRIQUES ET CLIMATIQUES

ELECTRICAL AND CLIMATIC CHARACTERISTICS

| | CT 79 | CT 79E | |
|---|---|---|---|
| | E | E | |
| Homologué suivant Spécifications particulières | CECC 30202-801 CECC 30202-005 CECC 30202-001 | CECC 30202-801 CECC 30202-005 CECC 30202-001 | Approved to Detail specifications |
| Température d'utilisation Chaleur humide Gamme de capacité Tolérance Gamme de tension | -55°C +125°C 56 jours / days 1,7µF...1200µF 20%...10% 6V...125V | -55°C +125°C 56 jours / days 5,6µF...2200µF 20%...10% 6V... 125V | Operating temperature Damp heat Capacitance range Tolerance Voltage range |
| C / C maximum à -55°C C / C maximum à +85°C C / C maximum à +125°C | voir / see / table voir / see / table voir / see / table | voir / see / table voir / see / table voir / see / table | Max capacitance change at -55°C Max capacitance change at +85°C Max capacitance change +125°C |
| Tg maximum à +20°C Tg maximum à +85°C Tg maximum à +125°C | voir / see / table = lim20°C = lim20°C | voir / see / table = lim20°C = lim20°C | Maximum DFat +20°C Maximum DFat +85°C Maximum DFat +125°C |
| Impéd. max. (100Hz) à -55°C | voir / see / table | voir / see / table | Max. impedance (100Hz) at -55°C |
| Courant de fuite max à +20°C Courant de fuite max à +85°C Courant de fuite max à +125°C | voir / see / table voir / see / table = lim+85°C | voir / see / table voir / see / table = lim+85°C | Max leakage current at +20°C Max leakage current at +85°C Max leakage current at +125°C |
| Courant eff. max à 40kHz +85°C | voir / see / table | voir / see / table | Max. ripple current 40kHz +85°C |
| Tension inverse max à +20°C Tension inverse max à +85°C Tension inverse max à +125°C | 3 volts 3 volts 3 volts | 3 volts 3 volts 3 volts | Max reverse voltage at +20°C Max reverse voltage at +85°C Max reverse voltage at +125°C |
| Surtension max à +85°C Surtension max à +125°C | 1,15 x UR 1,15 x UC | 1,15 x UR 1,15 x UC | Max surge voltage at +85°C Max surge voltage at +125°C |

DIMENSIONS

| Boîtier Case code | Dimensions avec gaine isolante Dimensions with insulating sleeve | | |
|----------------------|---|--------|-----------------|
| | L max | D. max | d +10% -0,05 |
| A | 18 | 5,6 | 0,6 |
| B | 23 | 7,4 | 0,6 |
| C | 26 | 10,1 | 0,6 |
| D | 34 | 10,1 | 0,6 |

MARQUAGE, CONDITIONNEMENT, CONSTRUCTION
voir caractéristiques générales

DIMENSIONS

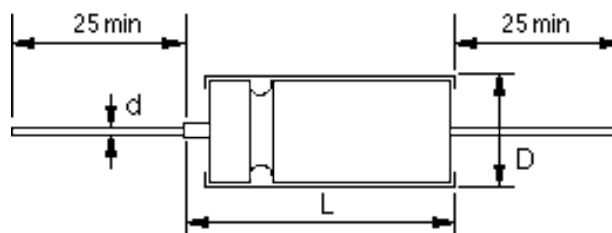

MARKING, PACKAGING, CONSTRUCTION :
see general characteristics

| CT 79 & CT 79 CMS / SMD | | | VALEURS STANDARD - CARACTERISTIQUES ELECTRIQUES | | | | | | | |
|---|-------------------------|----------------|--|--------------|---------------|------------------------------|--|---|--------------------|-----------------------------------|
| Gamme standard / Standard range | | | STANDARD RATINGS - ELECTRICAL CHARACTERISTICS | | | | | | | |
| CAPACITE NOMINALE RATED CAPACITANCE | BOÎTIER CASE CODE | MODELE TYPE | VARIATION MAXIMUM DELACAPACITE CAPACITANCE MAXIMUM CHANGE | | | TANG. MAX. MAX. D.F | IMPEDANCE MAX. MAX. IMPEDANCE | COURANT DE FUITE MAX. MAX. LEAKAGE CURRENT | | I efficace MAX I rms MAX |
| | | | -55°C (%) | +85°C (%) | +125°C (%) | | | +20°C (%) | 100Hz -55°C () | |
| TENSION NOMINALE (+85°C) 6 V - 6,3 V - TENSION DE CATEGORIE (+125°C) 4 V RATED VOLTAGE (+85°C) 6 V - 6,3 V - CATEGORY VOLTAGE (+125°C) 4 V | | | | | | | | | | |
| 30 | A | CT79 | -40 | +10 | +12 | 9 | 100 | 1 | 2 | 820 |
| 68 | A | CT79 | -40 | +14 | +16 | 15 | 60 | 1 | 2 | 960 |
| 140 | B | CT79 | -40 | +14 | +16 | 21 | 40 | 1 | 3 | 1200 |
| 220 | B | CT79 | -44 | +16 | +18 | 36 | 30 | 1 | 6,5 | 1370 |
| 270 | B | CT79 | -44 | +17 | +20 | 41 | 25 | 1 | 6,5 | 1375 |
| 330 | C | CT79 | -44 | +14 | +16 | 36 | 20 | 2 | 7,9 | 1800 |
| 560 | C | CT79 | -64 | +17,5 | +20 | 50 | 25 | 2 | 13 | 1900 |
| 1000 | D | CT79 | -80 | +25 | +25 | 68 | 22 | 3 | 14 | 2388 |
| 1200 | D | CT79 | -80 | +25 | +25 | 86 | 20 | 3 | 14 | 2388 |
| TENSION NOMINALE (+85°C) 8 V - TENSION DE CATEGORIE (+125°C) 5 V RATED VOLTAGE (+85°C) 8 V - CATEGORY VOLTAGE (+125°C) 5 V | | | | | | | | | | |
| 25 | A | CT79 | -40 | +10,5 | +12 | 7,5 | 100 | 1 | 2 | 820 |
| 56 | A | CT79 | -40 | +14 | +16 | 14 | 59 | 1 | 2 | 900 |
| 120 | B | CT79 | -44 | +17,5 | +20 | 20 | 50 | 1 | 2 | 1230 |
| 220 | B | CT79 | -44 | +16 | +18 | 37 | 30 | 1 | 7 | 1370 |
| 290 | C | CT79 | -64 | +17,5 | +20 | 34 | 25 | 2 | 6 | 1770 |
| 430 | C | CT79 | -64 | +17,5 | +20 | 46 | 25 | 2 | 14 | 1825 |
| 850 | D | CT79 | -80 | +25 | +25 | 60 | 22 | 3 | 16 | 2456 |
| TENSION NOMINALE (+85°C) 10 V - TENSION DE CATEGORIE (+125°C) 6,3 V RATED VOLTAGE (+85°C) 10 V - CATEGORY VOLTAGE (+125°C) 6,3 V | | | | | | | | | | |
| 20 | A | CT79 | -32 | +10,5 | +12 | 6 | 175 | 1 | 2 | 820 |
| 47 | A | CT79 | -36 | +14 | +16 | 13 | 100 | 1 | 2 | 855 |
| 100 | B | CT79 | -36 | +14 | +16 | 15 | 60 | 1 | 4 | 1200 |
| 150 | B | CT79 | -32 | +14 | +16 | 28 | 45 | 1 | 7 | 1271 |
| 180 | B | CT79 | -35 | +14 | +16 | 29 | 40 | 1 | 7 | 1365 |
| 250 | C | CT79 | -40 | +14 | +16 | 30 | 30 | 2 | 10 | 1720 |
| 390 | C | CT79 | -64 | +17,5 | +20 | 44 | 25 | 2 | 15 | 1800 |
| 680 | D | CT79 | -80 | +25 | +25 | 42 | 20 | 3 | 16 | 2487 |
| 750 | D | CT79 | -80 | +25 | +25 | 50 | 23 | 3 | 16 | 2487 |
| 820 | D | CT79 | -80 | +25 | +25 | 53 | 22 | 3 | 16 | 2360 |
| TENSION NOMINALE (+85°C) 15 V - 16 V - TENSION DE CATEGORIE (+125°C) 10 V RATED VOLTAGE (+85°C) 15 V - 16 V - CATEGORY VOLTAGE (+125°C) 10 V | | | | | | | | | | |
| 15 | A | CT79 | -24 | +10,5 | +12 | 5 | 155 | 1 | 2 | 780 |
| 33 | A | CT79 | -28 | +14 | +16 | 10 | 90 | 1 | 2 | 820 |
| 70 | B | CT79 | -28 | +14 | +16 | 13 | 75 | 1 | 4 | 1150 |
| 120 | B | CT79 | -28 | +14 | +16 | 18 | 50 | 1 | 7 | 1450 |
| 170 | C | CT79 | -32 | +14 | +16 | 25 | 35 | 2 | 10 | 1480 |
| 220 | C | CT79 | -41 | +13 | +15 | 21 | 40 | 2 | 6 | 1490 |
| 270 | C | CT79 | -56 | +17,5 | +20 | 32 | 30 | 2 | 14 | 1740 |
| 330 | C | CT79 | -58 | +18 | +20 | 40 | 30 | 2 | 14 | 1760 |
| 470 | D | CT79 | -75 | +25 | +25 | 33 | 24 | 3 | 18 | 2100 |
| 540 | D | CT79 | -80 | +25 | +25 | 40 | 23 | 3 | 18 | 2300 |
| 560 | D | CT79 | -80 | +25 | +25 | 36 | 23 | 3 | 18 | 2300 |
| TENSION NOMINALE (+85°C) 25 V - TENSION DE CATEGORIE (+125°C) 16 V RATED VOLTAGE (+85°C) 25 V - CATEGORY VOLTAGE (+125°C) 16 V | | | | | | | | | | |
| 10 | A | CT79 | -16 | +8 | +9 | 4 | 220 | 1 | 2 | 715 |
| 22 | A | CT79 | -20 | +10 | +12 | 6,6 | 140 | 1 | 2 | 825 |
| 50 | B | CT79 | -28 | +13 | +15 | 11 | 70 | 1 | 2 | 1130 |
| 100 | B | CT79 | -28 | +13 | +15 | 15 | 50 | 1 | 9 | 1435 |
| 120 | C | CT79 | -32 | +13 | +15 | 21 | 38 | 2 | 6 | 1450 |
| 180 | C | CT79 | -48 | +13 | +15 | 26 | 32 | 2 | 13 | 1700 |
| 330 | D | CT79 | -60 | +25 | +25 | 28 | 27 | 3 | 20 | 2000 |
| 350 | D | CT79 | -64 | +25 | +25 | 35 | 24 | 3 | 20 | 2246 |
| 390 | D | CT79 | -68 | +25 | +25 | 32 | 24 | 3 | 20 | 2025 |
| 560 | D | CT79 | -65 | +25 | +30 | 46 | 15 | 9 | 36 | 2040 |
| TENSION NOMINALE (+85°C) 30 V - TENSION DE CATEGORIE (+125°C) 20 V RATED VOLTAGE (+85°C) 30 V - CATEGORY VOLTAGE (+125°C) 20 V | | | | | | | | | | |
| 8 | A | CT79 | -16 | +8 | +12 | 4 | 275 | 1 | 2 | 640 |
| 15 | A | CT79 | -20 | +10 | +12 | 5 | 175 | 1 | 2 | 780 |
| 40 | B | CT79 | -24 | +10,5 | +12 | 10 | 65 | 1 | 5 | 1120 |
| 68 | B | CT79 | -24 | +13 | +15 | 13 | 60 | 1 | 8 | 1285 |
| 100 | C | CT79 | -28 | +10,5 | +12 | 17 | 40 | 2 | 12 | 1477 |
| 150 | C | CT79 | -48 | +13 | +15 | 23 | 35 | 2 | 12 | 1525 |
| 300 | D | CT79 | -60 | +25 | +25 | 30 | 25 | 3 | 20 | 2100 |

| CAPACITE NOMINALE RATED CAPACITANCE | | BOÎTIER CASE CODE | MODELE TYPE | VARIATION MAXIMUM DELACAPACITE CAPACITANCE MAXIMUMCHANGE | | | TANG. MAX. MAX. D.F | IMPEDANCE MAX. MAX. IMPEDANCE | COURANT DE FUITE MAX. MAX. LEAKAGE CURRENT | | I efficace MAX I rms MAX |
|---|---|----------------------|----------------|---|--------------|---------------|------------------------------|--|---|---------------|-----------------------------------|
| 100Hz+20°C (µF) | | | | -55°C (%) | +85°C (%) | +125°C (%) | +20°C (%) | 100Hz -55°C () | +20°C (µA) | +85°C (µA) | 40kHz +85°C (mA) |
| TENSION NOMINALE (+85°C) 40 V - TENSION DE CATEGORIE (+125°C) 25 V RATED VOLTAGE (+85°C) 40 V - CATEGORY VOLTAGE (+125°C) 25 V | | | | | | | | | | | |
| 12 | A | CT79 | -24 | +8 | +10 | 6 | 234 | 1 | 2 | 450 | |
| 56 | B | CT79 | -28 | +13 | +15 | 14 | 78 | 1 | 9 | 1100 | |
| 100 | C | CT79 | -40 | +13 | +15 | 18 | 48 | 2 | 17 | 1450 | |
| 220 | D | CT79 | -55 | +23 | +23 | 22 | 27 | 3 | 22 | 1900 | |
| TENSION NOMINALE (+85°C) 50 V - TENSION DE CATEGORIE (+125°C) 30 V RATED VOLTAGE (+85°C) 50 V - CATEGORY VOLTAGE (+125°C) 30 V | | | | | | | | | | | |
| 5 | A | CT79 | -16 | +5 | +6 | 3 | 400 | 1 | 2 | 580 | |
| 10 | A | CT79 | -20 | +8 | +9 | 4 | 250 | 1 | 2 | 715 | |
| 25 | B | CT79 | -20 | +10,5 | +12 | 8 | 95 | 1 | 5 | 1065 | |
| 47 | B | CT79 | -24 | +13 | +15 | 11 | 70 | 1 | 9 | 1215 | |
| 60 | C | CT79 | -16 | +10,5 | +12 | 12 | 45 | 2 | 12 | 1335 | |
| 82 | C | CT79 | -32 | +13 | +15 | 15 | 45 | 2 | 10 | 1460 | |
| 160 | D | CT79 | -50 | +23 | +23 | 17 | 27 | 3 | 22 | 2040 | |
| TENSION NOMINALE (+85°C) 60 V - 63 V - TENSION DE CATEGORIE (+125°C) 40 V RATED VOLTAGE (+85°C) 60 V - 63 V - CATEGORY VOLTAGE (+125°C) 40 V | | | | | | | | | | | |
| 4 | A | CT79 | -16 | +5 | +6 | 2,8 | 550 | 1 | 2 | 525 | |
| 8,2 | A | CT79 | -20 | +8 | +9 | 4 | 275 | 1 | 2 | 625 | |
| 20 | B | CT79 | -16 | +10,5 | +12 | +7 | 105 | 1 | 5 | 1026 | |
| 39 | B | CT79 | -24 | +10 | +12 | 10 | 90 | 1 | 9 | 1185 | |
| 50 | C | CT79 | -16 | +10,5 | +12 | 10 | 50 | 2 | 12 | 1341 | |
| 68 | C | CT79 | -30 | +10,5 | +12 | 13 | 50 | 2 | 10 | 1393 | |
| 140 | D | CT79 | -40 | +20 | +20 | 16 | 28 | 3 | 22 | 1990 | |
| 150 | D | CT79 | -40 | +20 | +20 | 17 | 27 | 3 | 22 | 1865 | |
| TENSION NOMINALE (+85°C) 75 V - 80 V - TENSION DE CATEGORIE (+125°C) 50 V RATED VOLTAGE (+85°C) 75 V - 80 V - CATEGORY VOLTAGE (+125°C) 50 V | | | | | | | | | | | |
| 3,5 | A | CT79 | -16 | +5 | +6 | 2,5 | 650 | 1 | 2 | 525 | |
| 6,8 | A | CT79 | -20 | +8 | +9 | 3 | 300 | 1 | 2 | 610 | |
| 15 | B | CT79 | -16 | +8 | +9 | 6 | 150 | 1 | 5 | 1000 | |
| 33 | B | CT79 | -24 | +10 | +12 | 10 | 90 | 1 | 9 | 1079 | |
| 40 | C | CT79 | -16 | +10,5 | +12 | 9 | 60 | 2 | 12 | 1293 | |
| 56 | C | CT79 | -28 | +10,5 | +15 | 11 | 60 | 2 | 10 | 1396 | |
| 68 | C | CT79 | -30 | +14 | +15 | 13 | 50 | 2 | 10 | 1522 | |
| 100 | D | CT79 | -35 | +20 | +20 | 12 | 36 | 9 | 36 | 1500 | |
| 110 | D | CT79 | -35 | +20 | +20 | 11 | 29 | 3 | 24 | 1990 | |
| 120 | D | CT79 | -36 | +20 | +20 | 12 | 28 | 3 | 24 | 1914 | |
| 150 | D | CT79 | -48 | +21 | +22 | 17 | 30 | 9 | 36 | 1914 | |
| TENSION NOMINALE (+85°C) 100 V - TENSION DE CATEGORIE (+125°C) 65 V RATED VOLTAGE (+85°C) 100 V - CATEGORY VOLTAGE (+125°C) 65 V | | | | | | | | | | | |
| 2,5 | A | CT79 | -16 | +7 | +8 | 2 | 950 | 1 | 2 | 505 | |
| 4,7 | A | CT79 | -16 | +7 | +8 | 3 | 500 | 1 | 2 | 565 | |
| 11 | B | CT79 | -16 | +8 | +8 | 5 | 200 | 1 | 4 | 835 | |
| 22 | B | CT79 | -16 | +7 | +8 | 7,5 | 100 | 1 | 9 | 1065 | |
| 30 | C | CT79 | -16 | +8 | +8 | 7 | 80 | 2 | 12 | 1240 | |
| 33 | C | CT79 | -16 | +8 | +8 | 7 | 93 | 2 | 10 | 1200 | |
| 39 | C | CT79 | -16 | +8 | +8 | 8 | 90 | 2 | 10 | 1282 | |
| 43 | C | CT79 | -20 | +8 | +8 | 8 | 70 | 2 | 10 | 1389 | |
| 47 | C | CT79 | -20 | +7 | +8 | 8 | 70 | 2 | 10 | 1389 | |
| 68 | D | CT79 | -24 | +15 | +15 | 8 | 42 | 3 | 26 | 1859 | |
| 82 | D | CT79 | -24 | +15 | +15 | 10 | 39 | 3 | 24 | 1859 | |
| 86 | D | CT79 | -24 | +15 | +15 | 10 | 30 | 3 | 24 | 1859 | |
| TENSION NOMINALE (+85°C) 125 V - TENSION DE CATEGORIE (+125°C) 85 V RATED VOLTAGE (+85°C) 125 V - CATEGORY VOLTAGE (+125°C) 85 V | | | | | | | | | | | |
| 1,7 | A | CT79 | -16 | +7 | +8 | 2 | 1250 | 1 | 2 | 415 | |
| 2,2 | A | CT79 | -16 | +7 | +8 | 2 | 1250 | 1 | 2 | 452 | |
| 2,7 | A | CT79 | -16 | +7 | +8 | 3 | 780 | 1 | 2 | 452 | |
| 3,3 | A | CT79 | -16 | +7 | +8 | 3 | 600 | 1 | 2 | 495 | |
| 3,6 | A | CT79 | -16 | +7 | +8 | 2,7 | 600 | 1 | 2 | 520 | |
| 3,9 | A | CT79 | -16 | +7 | +8 | 3,5 | 557 | 1 | 2 | 495 | |
| 9 | B | CT79 | -16 | +7 | +8 | 5 | 240 | 1 | 5 | 755 | |
| 14 | B | CT79 | -16 | +7 | +8 | 6 | 167 | 1 | 7 | 1050 | |
| 15 | B | CT79 | -16 | +7 | +8 | 6 | 167 | 1 | 7 | 1050 | |
| 18 | C | CT79 | -16 | +7 | +8 | 5 | 129 | 2 | 9 | 1130 | |
| 25 | C | CT79 | -16 | +7 | +8 | 6 | 93 | 2 | 10 | 1335 | |
| 27 | C | CT79 | -16 | +7 | +8 | 6 | 106 | 2 | 13 | 1282 | |
| 56 | D | CT79 | -25 | +15 | +15 | 6 | 32 | 3 | 28 | 1859 | |



| CAPACITE NOMINALE RATED CAPACITANCE | | BOÎTIER CASE CODE | MODELE TYPE | VARIATION MAXIMUM DELACAPACITE CAPACITANCE MAXIMUM CHANGE | | | TANG. MAX. MAX. D.F | IMPEDANCE MAX. MAX. IMPEDANCE | COURANT DE FUITE MAX. MAX. LEAKAGE CURRENT | | I efficace MAX I rms MAX |
|---|---|----------------------|----------------|--|--------------|---------------|------------------------------|--|---|---------------|-----------------------------------|
| 100Hz+20°C (µF) | | | | -55°C (%) | +85°C (%) | +125°C (%) | +20°C (%) | 100Hz -55°C () | +20°C (µA) | +85°C (µA) | 40kHz +85°C (mA) |
| TENSION NOMINALE (+85°C) 6 V - 6,3 V - TENSION DE CATEGORIE (+125°C) 4 V RATED VOLTAGE (+85°C) 6 V - 6,3 V - CATEGORY VOLTAGE (+125°C) 4 V | | | | | | | | | | | |
| 120 | A | CT79E | -41 | +15 | +16 | 21 | 81 | 1,5 | 3 | 820 | |
| 150 | A | CT79E | -42 | +16 | +16 | 34 | 80 | 2 | 9 | 820 | |
| 160 | A | CT79E | -42 | +16 | +16 | 41 | 80 | 2 | 9 | 820 | |
| 220 | A | CT79E | -64 | +13 | +16 | 50 | 36 | 2 | 9 | 1000 | |
| 470 | B | CT79E | -60 | +20 | +20 | 90 | 46 | 2 | 10 | 1281 | |
| 560 | B | CT79E | -68 | +20 | +20 | 106 | 48 | 2 | 10 | 1255 | |
| 820 | B | CT79E | -88 | +16 | +20 | 155 | 18 | 3 | 14 | 1500 | |
| 1500 | C | CT79E | -90 | +20 | +25 | 172 | 18 | 5 | 20 | 1900 | |
| 2200 | D | CT79E | -90 | +25 | +25 | 170 | 13 | 6 | 24 | 2300 | |
| TENSION NOMINALE (+85°C) 8 V - TENSION DE CATEGORIE (+125°C) 5 V RATED VOLTAGE (+85°C) 8 V - CATEGORY VOLTAGE (+125°C) 5 V | | | | | | | | | | | |
| 120 | A | CT79E | -44 | +17,5 | +20 | 32 | 80 | 2 | 6 | 820 | |
| 180 | A | CT79E | -60 | +13 | +16 | 41 | 45 | 2 | 9 | 1000 | |
| 430 | B | CT79E | -64 | +17,5 | +20 | 64 | 54 | 2 | 10 | 1230 | |
| 680 | B | CT79E | -83 | +16 | +20 | 130 | 22 | 3 | 14 | 1500 | |
| 1500 | C | CT79E | -90 | +20 | +25 | 170 | 18 | 5 | 20 | 1900 | |
| 1800 | D | CT79E | -90 | +25 | +30 | 138 | 14 | 7 | 25 | 2300 | |
| TENSION NOMINALE (+85°C) 10 V - TENSION DE CATEGORIE (+125°C) 6,3 V RATED VOLTAGE (+85°C) 10 V - CATEGORY VOLTAGE (+125°C) 6,3 V | | | | | | | | | | | |
| 68 | A | CT79E | -40 | +15 | +16 | 21 | 85 | 1,5 | 3 | 820 | |
| 82 | A | CT79E | -40 | +16 | +16 | 25 | 84 | 2 | 6 | 820 | |
| 100 | A | CT79E | -40 | +16 | +16 | 30 | 82 | 2 | 6 | 820 | |
| 150 | A | CT79E | -55 | +13 | +13 | 34 | 54 | 2 | 9 | 900 | |
| 300 | B | CT79E | -54 | +16 | +18 | 60 | 52 | 2 | 10 | 1195 | |
| 330 | B | CT79E | -54 | +17 | +18 | 65 | 52 | 2 | 10 | 1195 | |
| 350 | B | CT79E | -60 | +18 | +18 | 68 | 52 | 2 | 10 | 1195 | |
| 390 | B | CT79E | -60 | +19 | +20 | 74 | 54 | 2 | 10 | 1195 | |
| 470 | C | CT79E | -65 | +18 | +20 | 44 | 25 | 2 | 15 | 1800 | |
| 560 | B | CT79E | -77 | +16 | +20 | 106 | 27 | 3 | 16 | 1450 | |
| 850 | C | CT79E | -84 | +25 | +25 | 111 | 36 | 4 | 16 | 1720 | |
| 1000 | C | CT79E | -80 | +25 | +25 | 92 | 36 | 4 | 16 | 1720 | |
| 1200 | C | CT79E | -80 | +20 | +25 | 137 | 18 | 5 | 20 | 1850 | |
| 1500 | D | CT79E | -88 | +25 | +30 | 114 | 15 | 7 | 25 | 2360 | |
| 1800 | D | CT79E | -88 | +30 | +30 | 138 | 24 | 7 | 25 | 2360 | |
| 2200 | D | CT79E | -88 | +30 | +30 | 170 | 22 | 8 | 26 | 2360 | |
| TENSION NOMINALE (+85°C) 15 V - 16 V - TENSION DE CATEGORIE (+125°C) 10 V RATED VOLTAGE (+85°C) 15 V - 16 V - CATEGORY VOLTAGE (+125°C) 10 V | | | | | | | | | | | |
| 47 | A | CT79E | -28 | +16 | +16 | 20 | 100 | 1,5 | 3 | 760 | |
| 56 | A | CT79E | -28 | +16 | +16 | 22 | 100 | 1,5 | 3 | 760 | |
| 82 | A | CT79E | -35 | +12 | +16 | 20 | 43 | 2 | 6 | 915 | |
| 100 | A | CT79E | -44 | +13 | +16 | 30 | 72 | 2 | 9 | 900 | |
| 220 | B | CT79E | -35 | +16 | +16 | 42 | 62 | 2 | 10 | 1215 | |
| 270 | B | CT79E | -45 | +18 | +18 | 55 | 60 | 2 | 12 | 1215 | |
| 290 | B | CT79E | -54 | +18 | +18 | 60 | 65 | 2 | 12 | 1215 | |
| 330 | C | CT79E | -58 | +18 | +20 | 40 | 30 | 2 | 14 | 1760 | |
| 390 | B | CT79E | -66 | +16 | +20 | 74 | 31 | 3 | 16 | 1450 | |
| 680 | C | CT79E | -80 | +25 | +25 | 80 | 42 | 5 | 20 | 1582 | |
| 750 | C | CT79E | -80 | +25 | +25 | 95 | 42 | 6 | 24 | 1582 | |
| 820 | C | CT79E | -77 | +20 | +25 | 95 | 22 | 6 | 24 | 1800 | |
| 850 | D | CT79E | -80 | +25 | +25 | 95 | 24 | 8 | 32 | 2300 | |
| 1000 | D | CT79E | -77 | +25 | +25 | 92 | 17 | 8 | 32 | 2300 | |
| 1200 | D | CT79E | -84 | +25 | +30 | 103 | 25 | 8 | 32 | 2300 | |
| TENSION NOMINALE (+85°C) 25 V - TENSION DE CATEGORIE (+125°C) 16 V RATED VOLTAGE (+85°C) 25 V - CATEGORY VOLTAGE (+125°C) 16 V | | | | | | | | | | | |
| 27 | A | CT79E | -20 | +12 | +12 | 11 | 140 | 1,5 | 3 | 715 | |
| 33 | A | CT79E | -24 | +14 | +14 | 13 | 130 | 1,5 | 3 | 715 | |
| 39 | A | CT79E | -28 | +16 | +16 | 16 | 120 | 2 | 9 | 715 | |
| 43 | A | CT79E | -28 | +16 | +16 | 18 | 120 | 2 | 9 | 715 | |
| 68 | A | CT79E | -40 | +12 | +15 | 22 | 90 | 2 | 9 | 850 | |
| 150 | B | CT79E | -35 | +15 | +15 | 32 | 62 | 2 | 10 | 1130 | |
| 160 | B | CT79E | -35 | +15 | +15 | 34 | 60 | 2 | 10 | 1130 | |
| 180 | B | CT79E | -48 | +14 | +15 | 34 | 60 | 2 | 10 | 1130 | |
| 220 | C | CT79E | -52 | +18 | +20 | 33 | 33 | 2 | 13 | 1614 | |
| 270 | B | CT79E | -62 | +13 | +16 | 55 | 33 | 2 | 16 | 1400 | |
| 390 | C | CT79E | -70 | +25 | +25 | 48 | 48 | 7 | 28 | 1396 | |
| 470 | C | CT79E | -76 | +25 | +25 | 48 | 48 | 7 | 28 | 1398 | |
| 540 | C | CT79E | -80 | +25 | +25 | 60 | 48 | 7 | 28 | 1398 | |
| 560 | C | CT79E | -72 | +20 | +25 | 60 | 24 | 7 | 28 | 1750 | |
| 680 | D | CT79E | -72 | +25 | +25 | 60 | 19 | 8 | 32 | 2100 | |
| 820 | D | CT79E | -80 | +25 | +25 | 82 | 26 | 8 | 32 | 1862 | |
| 850 | D | CT79E | -80 | +25 | +25 | 95 | 26 | 8 | 32 | 1970 | |



CT 79E & CT 79E CMS / SMD VALEURS STANDARD - CARACTERISTIQUES ELECTRIQUES
Gamme étendue / Extended range STANDARD RATINGS - ELECTRICAL CHARACTERISTICS

| CAPACITE NOMINALE RATED CAPACITANCE | BOÎTIER CASE CODE | MODELE TYPE | VARIATION MAXIMUM DELACAPACITE CAPACITANCE MAXIMUMCHANGE | | | TANG. MAX. MAX. D.F | IMPEDANCE MAX. MAX. IMPEDANCE | COURANTDE FUITEMAX. MAX.LEAKAGE CURRENT | | I efficace MAX I rms MAX |
|--|-------------------------|----------------|---|--------------|---------------|------------------------------|--|--|--------------------|-----------------------------------|
| | | | -55°C (%) | +85°C (%) | +125°C (%) | | | +20°C (%) | 100Hz -55°C () | |
| TENSION NOMINALE (+85°C) 30 V - TENSION DE CATEGORIE (+125°C) 20 V RATED VOLTAGE (+85°C) 30 V - CATEGORY VOLTAGE (+125°C) 20 V | | | | | | | | | | |
| 25 | A | CT79E | -24 | +12 | +12 | 11 | 160 | 1,5 | 3 | 640 |
| 33 | A | CT79E | -30 | +12 | +14 | 12 | 160 | 2 | 9 | 640 |
| 47 | A | CT79E | -23 | +12 | +15 | 20 | 57 | 2 | 6 | 830 |
| 56 | A | CT79E | -38 | +12 | +15 | 22 | 100 | 2 | 9 | 800 |
| 120 | B | CT79E | -32 | +15 | +15 | 30 | 60 | 2 | 10 | 1185 |
| 150 | B | CT79E | -35 | +15 | +15 | 32 | 60 | 2 | 10 | 1185 |
| 170 | B | CT79E | -48 | +15 | +15 | 34 | 65 | 2 | 12 | 1185 |
| 220 | B | CT79E | -60 | +13 | +16 | 42 | 36 | 3 | 16 | 1200 |
| 300 | C | CT79E | -60 | +15 | +15 | 43 | 44 | 6 | 24 | 1559 |
| 330 | C | CT79E | -65 | +25 | +25 | 45 | 52 | 6 | 24 | 1373 |
| 350 | C | CT79E | -70 | +25 | +25 | 48 | 52 | 8 | 32 | 1477 |
| 390 | C | CT79E | -75 | +25 | +25 | 55 | 52 | 8 | 32 | 1477 |
| 430 | C | CT79E | -80 | +25 | +25 | 60 | 54 | 8 | 32 | 1477 |
| 470 | C | CT79E | -65 | +20 | +25 | 64 | 25 | 8 | 32 | 1500 |
| 560 | D | CT79E | -65 | +25 | +30 | 40 | 20 | 9 | 36 | 2000 |
| TENSION NOMINALE (+85°C) 40 V - TENSION DE CATEGORIE (+125°C) 25 V RATED VOLTAGE (+85°C) 40 V - CATEGORY VOLTAGE (+125°C) 25 V | | | | | | | | | | |
| 15 | A | CT79E | -20 | +10 | +12 | 7 | 140 | 1 | 2 | 660 |
| 18 | A | CT79E | -20 | +12 | +12 | 10 | 200 | 1,5 | 4 | 580 |
| 22 | A | CT79E | -24 | +12 | +12 | 11 | 190 | 1,5 | 4 | 580 |
| 33 | A | CT79E | -20 | +10 | +12 | 12 | 88 | 3 | 8 | 795 |
| 68 | B | CT79E | -24 | +13 | +15 | 15 | 60 | 1 | 8 | 1285 |
| 100 | B | CT79E | -40 | +15 | +15 | 25 | 60 | 2 | 10 | 1285 |
| 120 | B | CT79E | -32 | +15 | +15 | 30 | 62 | 2 | 12 | 1241 |
| 150 | C | CT79E | -48 | +14 | +15 | 23 | 35 | 2 | 12 | 1525 |
| 270 | C | CT79E | -60 | +25 | +25 | 37 | 52 | 7 | 28 | 1373 |
| 330 | C | CT79E | -65 | +25 | +25 | 43 | 52 | 8 | 32 | 1373 |
| 390 | D | CT79E | -75 | +25 | +25 | 43 | 30 | 8 | 32 | 1900 |
| 470 | D | CT79E | -80 | +25 | +25 | 45 | 30 | 9 | 36 | 1900 |
| TENSION NOMINALE (+85°C) 50 V - TENSION DE CATEGORIE (+125°C) 30 V RATED VOLTAGE (+85°C) 50 V - CATEGORY VOLTAGE (+125°C) 30V | | | | | | | | | | |
| 18 | A | CT79E | -24 | +12 | +12 | 10 | 200 | 1,5 | 3 | 580 |
| 22 | A | CT79E | -24 | +12 | +12 | 11 | 190 | 2 | 9 | 580 |
| 33 | A | CT79E | -29 | +10 | +12 | 12 | 135 | 2 | 9 | 700 |
| 100 | B | CT79E | -40 | +15 | +15 | 25 | 67 | 3 | 15 | 1150 |
| 120 | B | CT79E | -42 | +12 | +15 | 22,5 | 49 | 4 | 24 | 1200 |
| 270 | C | CT79E | -46 | +20 | +25 | 37 | 29 | 8 | 32 | 1450 |
| 330 | D | CT79E | -46 | +25 | +30 | 38 | 22 | 9 | 36 | 1900 |
| 350 | D | CT79E | -70 | +25 | +25 | 40 | 30 | 9 | 36 | 1900 |
| 390 | D | CT79E | -75 | +25 | +25 | 43 | 30 | 9 | 36 | 1900 |
| 430 | D | CT79E | -80 | +25 | +25 | 45 | 31 | 10 | 40 | 1900 |
| TENSION NOMINALE (+85°C) 60 V - 63 V - TENSION DE CATEGORIE (+125°C) 40 V RATED VOLTAGE (+85°C) 60 V - 63 V - CATEGORY VOLTAGE (+125°C) 40 V | | | | | | | | | | |
| 10 | A | CT79E | -20 | +8 | +9 | 4 | 250 | 1 | 2 | 572 |
| 12 | A | CT79E | -20 | +8 | +9 | 7 | 233 | 2 | 4 | 572 |
| 15 | A | CT79E | -22 | +9 | +9 | 8 | 220 | 2 | 9 | 562 |
| 27 | A | CT79E | -24 | +10 | +12 | 10 | 144 | 3 | 12 | 700 |
| 47 | B | CT79E | -24 | +13 | +15 | 13 | 70 | 1 | 9 | 1150 |
| 56 | B | CT79E | -26 | +14 | +15 | 18 | 72 | 2 | 12 | 1150 |
| 82 | B | CT79E | -36 | +15 | +15 | 22 | 70 | 2 | 12 | 1150 |
| 100 | B | CT79E | -36 | +12 | +15 | 19 | 54 | 4 | 20 | 1100 |
| 100 | C | CT79E | -37 | +14 | +15 | 18 | 42 | 2 | 11 | 1420 |
| 120 | C | CT79E | -40 | +18 | +18 | 20 | 49 | 3 | 18 | 1420 |
| 220 | C | CT79E | -40 | +16 | +20 | 30 | 29 | 8 | 32 | 1400 |
| 270 | D | CT79E | -45 | +20 | +25 | 26 | 23 | 9 | 36 | 1850 |
| 330 | D | CT79E | -72 | +25 | +25 | 32 | 31 | 10 | 40 | 1850 |
| TENSION NOMINALE (+85°C) 75 V - 80 V - TENSION DE CATEGORIE (+125°C) 50 V RATED VOLTAGE (+85°C) 75 V - 80 V - CATEGORY VOLTAGE (+125°C) 50 V | | | | | | | | | | |
| 8,2 | A | CT79E | -22 | +9 | +9 | 6 | 280 | 1,5 | 3 | 610 |
| 9 | A | CT79E | -22 | +9 | +9 | 6 | 280 | 2 | 4 | 572 |
| 22 | A | CT79E | -19 | +10 | +12 | 8,5 | 157 | 3 | 12 | 600 |
| 43 | B | CT79E | -24 | +10,5 | +12 | 15 | 89 | 2 | 10 | 1051 |
| 47 | B | CT79E | -30 | +14 | +14 | 15 | 87 | 2 | 10 | 1051 |
| 56 | B | CT79E | -28 | +10,5 | +15 | 11 | 72 | 2 | 12 | 1051 |
| 68 | B | CT79E | -36 | +15 | +15 | 21 | 86 | 2 | 12 | 1051 |
| 82 | B | CT79E | -30 | +12 | +15 | 15 | 63 | 4 | 24 | 1000 |



| CAPACITE NOMINALE RATED CAPACITANCE | | BOÎTIER CASE CODE | MODELE TYPE | VARIATION MAXIMUM DELACAPACITE CAPACITANCE MAXIMUM CHANGE | | | TANG. MAX. MAX. D.F | IMPEDANCE MAX. MAX. IMPEDANCE | COURANT DE FUITE MAX. MAX. LEAKAGE CURRENT | | I efficace MAX I rms MAX |
|---|---|----------------------|----------------|--|--------------|---------------|------------------------------|--|---|---------------|-----------------------------------|
| 100Hz+20°C (µF) | | | | -55°C (%) | +85°C (%) | +125°C (%) | +20°C (%) | 100Hz -55°C () | +20°C (µA) | +85°C (µA) | 40kHz +85°C (mA) |
| TENSION NOMINALE (+85°C) 75 V - 80 V - TENSION DE CATEGORIE (+125°C) 50 V RATED VOLTAGE (+85°C) 75 V - 80 V - CATEGORY VOLTAGE (+125°C) 50 V | | | | | | | | | | | |
| 82 | C | CT79E | -32 | +14 | +15 | 15 | 45 | 2 | 10 | 1335 | |
| 100 | C | CT79E | -36 | +17 | +18 | 19 | 60 | 8 | 32 | 1335 | |
| 150 | C | CT79E | -40 | +20 | +20 | 25 | 60 | 9 | 36 | 1335 | |
| 180 | C | CT79E | -35 | +16 | +20 | 28 | 30 | 9 | 36 | 1335 | |
| 220 | D | CT79E | -40 | +20 | +22 | 24,4 | 24 | 10 | 40 | 1850 | |
| 250 | D | CT79E | -68 | +25 | +25 | 40 | 33 | 10 | 40 | 1850 | |
| 270 | D | CT79E | -68 | +25 | +25 | 42 | 35 | 11 | 44 | 1850 | |
| TENSION NOMINALE (+85°C) 100 V - TENSION DE CATEGORIE (+125°C) 65 V RATED VOLTAGE (+85°C) 100 V - CATEGORY VOLTAGE (+125°C) 65 V | | | | | | | | | | | |
| 5,6 | A | CT79E | -17 | +8 | +8 | 6 | 475 | 2 | 5 | 530 | |
| 10 | A | CT79E | -17 | +10 | +12 | 4,5 | 200 | 3 | 12 | 800 | |
| 30 | B | CT79E | -16 | +8 | +8 | 10 | 99 | 3 | 15 | 1065 | |
| 33 | B | CT79E | -16 | +8 | +8 | 14 | 95 | 3 | 15 | 1065 | |
| 39 | B | CT79E | -20 | +12 | +12 | 10 | 80 | 2 | 12 | 1300 | |
| 56 | C | CT79E | -28 | +14 | +15 | 11 | 60 | 2 | 10 | 1335 | |
| 68 | C | CT79E | -30 | +14 | +15 | 11,3 | 40 | 10 | 40 | 1600 | |
| 100 | D | CT79E | -35 | +20 | +20 | 11 | 36 | 3 | 24 | 1859 | |
| 120 | D | CT79E | -35 | +15 | +17 | 25 | 30 | 12 | 48 | 2000 | |
| TENSION NOMINALE (+85°C) 125 V - TENSION DE CATEGORIE (+125°C) 85 V RATED VOLTAGE (+85°C) 125 V - CATEGORY VOLTAGE (+125°C) 85 V | | | | | | | | | | | |
| 6,8 | A | CT79E | -14 | +10 | +12 | 6 | 300 | 3 | 12 | 700 | |
| 18 | B | CT79E | -16 | +8 | +8 | 8 | 133 | 2 | 10 | 1065 | |
| 27 | B | CT79E | -18 | +12 | +15 | 7,2 | 90 | 5 | 24 | 1200 | |
| 39 | C | CT79E | -16 | +8 | +8 | 8 | 90 | 2 | 10 | 1282 | |
| 47 | C | CT79E | -23 | +10 | +10 | 7,9 | 50 | 2 | 10 | 1500 | |
| 68 | D | CT79E | -24 | +15 | +15 | 8 | 42 | 3 | 26 | 1859 | |
| 82 | D | CT79E | -24 | +15 | +17 | 10 | 32 | 3 | 24 | 1900 | |
| TENSION NOMINALE (+85°C) 150 V - TENSION DE CATEGORIE (+125°C) 100 V RATED VOLTAGE (+85°C) 150 V - CATEGORY VOLTAGE (+125°C) 100 V | | | | | | | | | | | |
| 2,5 | A | CT79E | -16 | +8 | +8 | 3 | 780 | 1 | 3 | 495 | |
| 3,3 | A | CT79E | -16 | +8 | +8 | 3 | 600 | 1 | 3 | 495 | |
| 14 | B | CT79E | -16 | +8 | +8 | 10 | 167 | 2 | 10 | 1065 | |
| 18 | B | CT79E | -16 | +8 | +8 | 10 | 133 | 2 | 10 | 1065 | |
| 25 | C | CT79E | -16 | +8 | +8 | 20 | 93 | 2 | 20 | 1335 | |
| 47 | C | CT79E | -24 | +10 | +10 | 20 | 70 | 2 | 20 | 1335 | |
| 56 | D | CT79E | -24 | +15 | +15 | 30 | 47 | 3 | 30 | 1860 | |
| 82 | D | CT79E | -24 | +18 | +18 | 30 | 39 | 3 | 30 | 1860 | |

Note :
Les tensions 6V, 8V, 15V, 30V, 50V, 60V et 75V concernent la gamme MIL.
Les valeurs indiquées en italique sont hors gamme CECC.

Note :
Voltage 6V, 8V, 15V, 30V, 50V, 60V and 75V concern the MIL standard range.
Values in italics are out of CECC range.

NOTES

| | |
|--|--|
| | |
|--|--|