

UNLESS OTHERWISE NOTED TOLERANCES ARE:
 DIMENSIONS ARE IN INCHES
 ONE PLACE DECIMALS ±.1[2.5] THREE PLACE DECIMALS ±.005[.13] ANGLES ± 2°
 TWO PLACE DECIMALS ±.01[.3] FOUR PLACE DECIMALS ±.0020[.051]

TITLE:
 2mm x 2mm
 TERMINAL STRIP ASSEMBLY

DWG NO:
 TMMH-1XX-XX-XX-D-XXX-XXX
 SHEET 1 OF 3

TABLE 1				
LEAD STYLE	"A"	"B"	TERMINAL	"C"
-01	.126 [3.20]	.302 [7.67]	T-1S13-07-XX-2	.097 [2.46] REF
-04	.075 [1.91]	.255 [6.48]	T-1S13-04-XX-2	.101 [2.57] REF
* -05	.065 [1.65]	.234 [5.94] REF	T-1S13-07-XX-2	.090 [2.29]
-21	.126 [3.20]	.255 [6.48]	T-1S13-04-XX-2	.050 [1.27] REF
-22	.075 [1.91]	.204 [5.18]	T-1S13-25-XX-2	.050 [1.27] REF
-06	.126 [3.20]	.344 [8.74]	T-1S13-31-XX-2	.139 [3.53] REF

* SEE NOTE 5

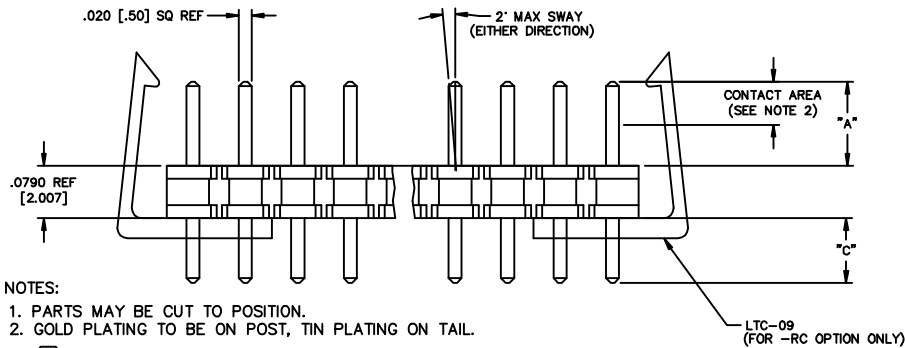
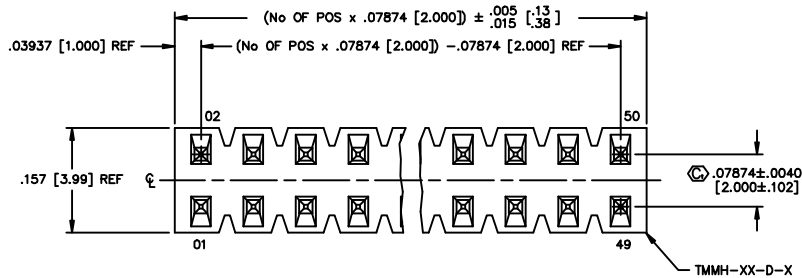

NOTES:

- PARTS MAY BE CUT TO POSITION.
- GOLD PLATING TO BE ON POST, TIN PLATING ON TAIL.
- ⊙ REPRESENTS A CRITICAL DIMENSION.
- MINIMUM PUSHOUT FORCE: 1.0 LB.
- MUST SHEAR TO DIMENSION SHOWN.
- NOTE DELETED
- MAX CUT FLASH: .020 [.51]
- WAVE SOLDER APPLICATION ONLY.
- RETAINING CLIP FOR -06 LEAD STYLE ONLY.
- DUE TO THE HIGH AMOUNT OF INSERTION FORCE NEEDED, THE -LC OPTION IS NOT COMPATIBLE WITH AUTO PLACEMENT. SAMTEC RECOMMENDS MANUAL PLACEMENT FOR ALL ASSEMBLIES WITH THE -EC, -EBC, AND -EPC OPTION.

TMMH-1XX-XX-XX-D-XXX-XXX

No OF POSITIONS
 -02 THRU -50
 (PER ROW)

LEAD STYLE
 SEE TABLE 1

POLARIZATION
 SPECIFY POSITION -XXX TO BE OMITTED
 OPTIONS (IF NO OPTIONS USE TMMC-50-D)
 -ES: END SHROUDS (SEE FIG. 2- SHT. 2, 9 POS MIN)
 -EL: BOARD LOCK (SEE FIG. 3- SHT. 2, 9 POS MIN)
 -EC: LOCKING CLIP (SEE FIG. 4- SHT. 2, 9 POS MIN) (SEE NOTE 10)
 -EP: GUIDE POST (SEE FIG. 5- SHT. 2, 9 POS MIN)
 -EA: ALIGNMENT PIN (SEE FIG. 6- SHT. 2, 9 POS MIN)
 -EBC: BOARD LOCK WITH LOCKING CLIP (SEE FIG. 7- SHT. 3, 9 POS MIN) (SEE NOTE 10)
 -EPC: GUIDE POST WITH LOCKING CLIP (SEE FIG. 8- SHT. 3, 9 POS MIN) (SEE NOTE 10)
 ** -MW: METAL WASHER (SEE FIG. 9- SHT. 3) (5 POS PER ROW MIN, 30 POS PER ROW MAX)
 -RC: RETAINING CLIP FOR IDC, USE LTC-09, DOUBLE ROW ONLY, REQUIRES 4 POSITIONS MIN, NOT FOR USE WITH OTHER OPTIONS, SEE NOTES 8 & 9.

ROW OPTION
 -D: DOUBLE
 (USE TMMH-XX-D-X)
 (IF NO OPTIONS USE TMMC-50-D)

PLATING
 -L: LIGHT SELECTIVE GOLD (USE T-1S13-XX-L-2)
 -F: FLASH GOLD (USE T-1S13-XX-F-2)
 -S: SELECTIVE GOLD (USE T-1S13-XX-S-2)
 -G: GOLD (USE T-1S13-XX-G-2)
 -H: HEAVY GOLD (USE T-1S13-XX-H-2)
 -T: TIN (USE T-1S13-XX-T-2)
 -TM: MATTE TIN (USE T-1S13-XX-T-2)
 -LM: LIGHT SELECTIVE GOLD/MATTE TIN TAIL (USE T-1S13-XX-L-2)
 -FM: FLASH GOLD/MATTE TIN TAIL (USE T-1S13-XX-F-2)
 -SM: SELECTIVE GOLD/MATTE TIN (USE T-1S13-XX-S-2)

** -MW OPTION, DO NOT DESIGN IN. SAMTEC WILL ONLY SUPPORT EXISTING BUSINESS 2/05/02.

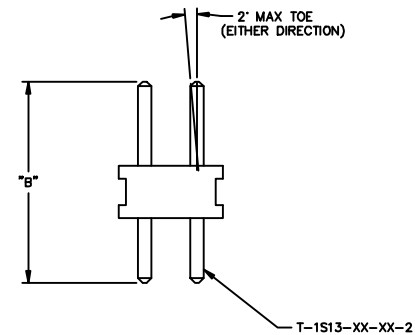

FIG. 1

MATERIAL:
 BLACK, LCP
 TERMINAL:
 PHOSPHOR BRONZE

samtec
 520 PARK EAST BLVD. NEW ALBANY, INDIANA 47150
 PHONE (812) 944-8733 P.O. BOX 1147
 CODE 55322

MADE BY:
 PURVIS 12-17-96

TMMH-1XX-XX-XX-D-XXX-XXX
 SHEET 1 OF 3

PROPRIETARY NOTE
 THIS DOCUMENT CONTAINS INFORMATION OF A CONFIDENTIAL AND PROPRIETARY NATURE. IT IS THE PROPERTY OF SAMTEC INC. AND SHALL NOT BE REPRODUCED, COPIED, OR DISCLOSED TO OTHERS WITHOUT THE WRITTEN CONSENT OF SAMTEC INC.

REV. AQ

UNLESS OTHERWISE NOTED TOLERANCES ARE:
 DIMENSIONS ARE IN INCHES
 ONE PLACE DECIMALS ±.1[2.5] THREE PLACE DECIMALS ±.005[.13]
 TWO PLACE DECIMALS ±.01[.3] FOUR PLACE DECIMALS ±.0020[.051]
 ANGLES ± 2°

TITLE: 2mm x 2mm TERMINAL STRIP ASSEMBLY

DWG NO: TMMH-1XX-XX-X-D-XXX-XXX
 SHEET 2 OF 3

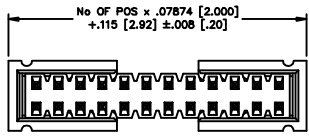

FIG. 2
-ES

STYLE	"A"	"B"	SHROUD
-01, -06, -21	.202 [5.13]	.210 [5.33]	TMMH-ES-01
-04, -05, -22	.149 [3.78]	.157 [3.99]	TMMH-ES-04

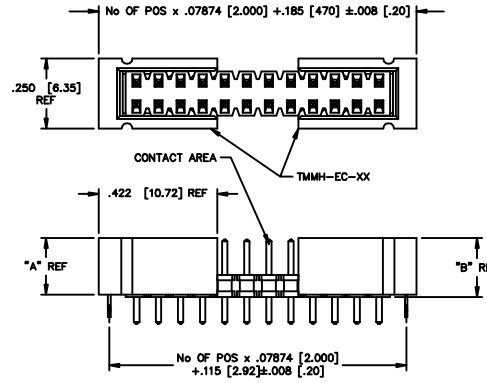
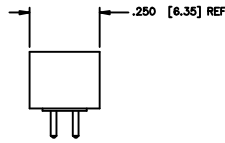
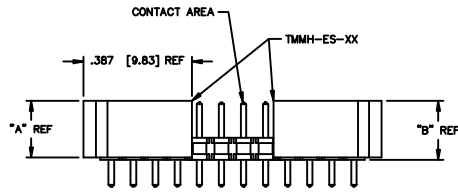

FIG. 4
-EC

STYLE	"A"	"B"	SHROUD
-01, -06, -21	.202 [5.13]	.210 [5.33]	TMMH-EC-01
-04, -05, -22	.149 [3.78]	.157 [3.99]	TMMH-EC-04

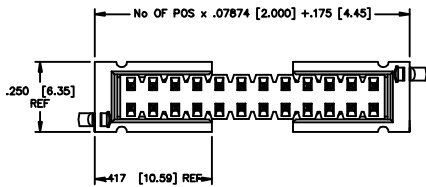
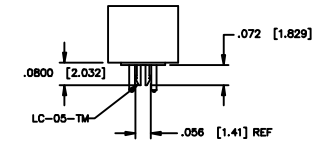
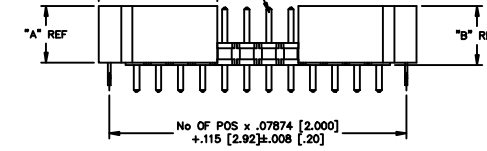

FIG. 3
-EL

STYLE	"A"	"B"	SHROUD
-01, -06, -21	.202 [5.13]	.210 [5.33]	TMMH-EL-01
-04, -05, -22	.149 [3.78]	.157 [3.99]	TMMH-EL-04

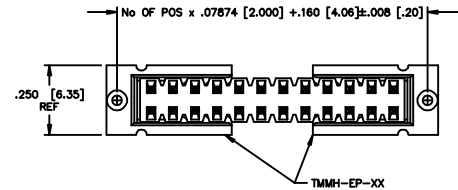
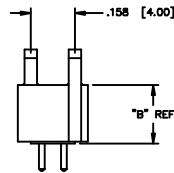
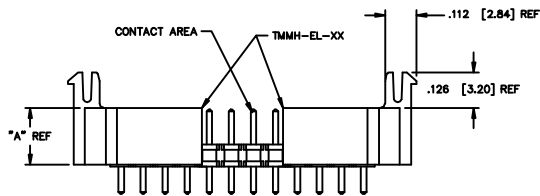
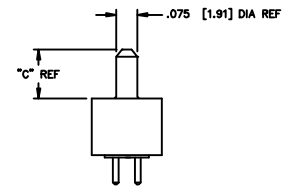
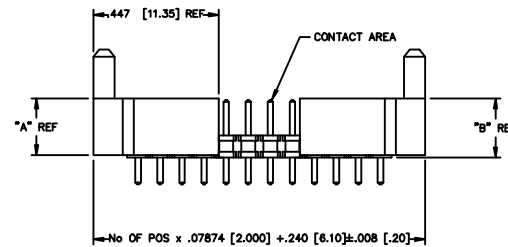

FIG. 5
-EP

STYLE	"A"	"B"	"C"	SHROUD
-01, -06, -21	.202 [5.13]	.210 [5.33]	.175 [4.45]	TMMH-EP-01
-04, -05, -22	.149 [3.78]	.157 [3.99]	.119 [3.02]	TMMH-EP-04



PROPRIETARY NOTE
 THE FOLLOWING CONTENTS INFORMATION IS CONFIDENTIAL AND PROPRIETARY TO SAMTEC INC. AND SHALL NOT BE REPRODUCED OR TRANSMITTED IN ANY FORM OR BY ANY MEANS, ELECTRONIC OR MECHANICAL, INCLUDING PHOTOCOPYING, RECORDING, OR BY ANY INFORMATION STORAGE AND RETRIEVAL SYSTEM, WITHOUT THE WRITTEN CONSENT OF SAMTEC INC.

ALL FIGURES
 DIFFERENT AS SHOWN,
 OTHERWISE SAME AS FIG. 1
PATENT PENDING

DO NOT SCALE FROM THIS PRINT

MSC/MKTO TMMH22MK

samtec

520 PARK EAST BLVD. NEW ALBANY, INDIANA 47150
 PHONE (812) 944-6733 P.O. BOX 1147
 CODE 55322

MADE BY: PURVIS 9-9-96

TMMH-1XX-XX-X-D-XXX-XXX
 SHEET 2 OF 3

UNLESS OTHERWISE NOTED
 DIMENSIONS ARE IN INCHES TOLERANCES ARE:
 ONE PLACE DECIMALS ±.1[2.5] THREE PLACE DECIMALS ±.005[.13]
 TWO PLACE DECIMALS ±.01[.3] FOUR PLACE DECIMALS ±.0020[.051]
 ANGLES ± 2°

TITLE:
**2mm x 2mm
 TERMINAL STRIP ASSEMBLY**

DWG NO:
 TMMH-1XX-XX-X-D-XXX-XXX
 SHEET 3 OF 3

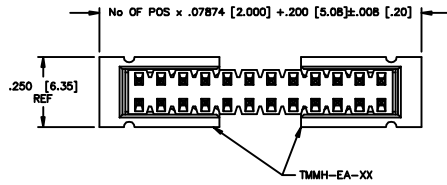

FIG. 6
-EA

STYLE	"A"	"B"	SHROUD
-01	.202 [5.13]	.210 [5.33]	TMMH-EA-01
-04, -05	.149 [3.78]	.157 [3.99]	TMMH-EA-04

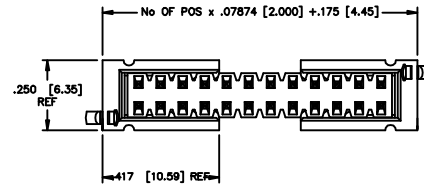
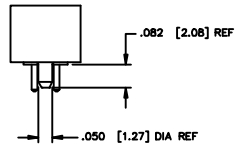
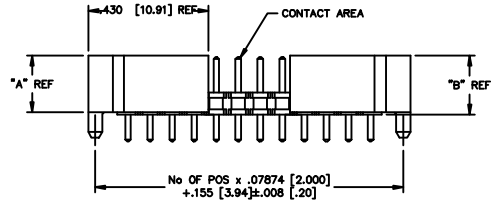

FIG. 7
-EBC

STYLE	"A"	"B"	SHROUD
-01	.202 [5.13]	.210 [5.33]	TMMH-EL-01
-04, -05	.149 [3.78]	.157 [3.99]	TMMH-EL-04

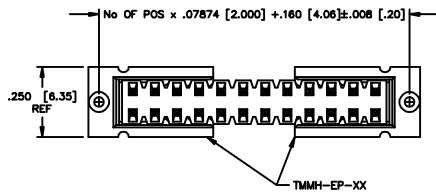
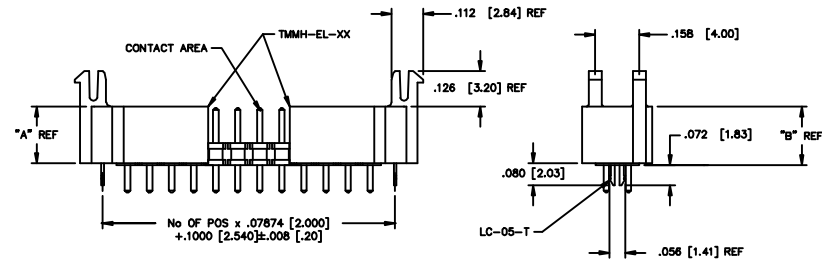

FIG. 8
-EPC

STYLE	"A"	"B"	"C"	SHROUD
-01	.202 [5.13]	.210 [5.33]	.175 [4.45]	TMMH-EP-01
-04, -05	.149 [3.78]	.157 [3.99]	.119 [3.02]	TMMH-EP-04

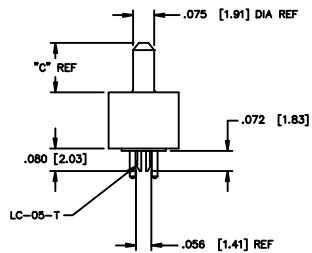
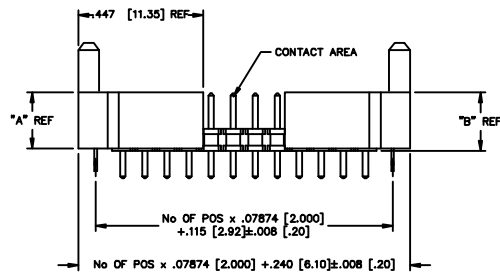
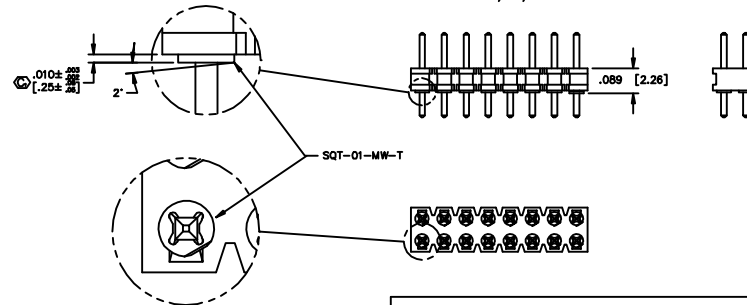
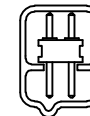

FIG. 9
 -MW OPTION, DO NOT DESIGN IN. SAMTEC WILL
 ONLY SUPPORT EXISTING BUSINESS 2/05/02.



ALL FIGURES
 DIFFERENT AS SHOWN,
 OTHERWISE SAME AS FIG. 1
PATENT PENDING



FOR MEDAL WASHER OPTION ONLY
 USE TUBE- PT-1-24-04-36
 USE PLUG- TP-24

samtec

MISC MKTG
 TMMH23AK

520 PARK EAST BLVD. NEW ALBANY, INDIANA 47150
 PHONE (812) 944-6733 P.O. BOX 1147
 CODE 55322

MADE BY:
 PURVIS 9-9-96

TMMH-1XX-XX-X-D-XXX-XXX
 SHEET 3 OF 3

PROPRIETARY NOTE
 THIS DOCUMENT CONTAINS INFORMATION
 CONFIDENTIAL AND PROPRIETARY TO
 SAMTEC INC. AND SHALL NOT BE
 REPRODUCED OR TRANSMITTED IN
 ANY FORM OR BY ANY MEANS,
 ELECTRONIC OR MECHANICAL,
 INCLUDING PHOTOCOPYING, RECORDING,
 OR BY ANY INFORMATION STORAGE
 AND RETRIEVAL SYSTEM, WITHOUT THE
 WRITTEN CONSENT OF SAMTEC INC.

Do not scale
 from this print