



# T Series Subminiature Toggle Switches



Models Available

## Features/Benefits

- Compact size—small footprint
- Single and double pole models
- PC and panel mount options available

## Typical Applications

- Hand-held telecommunications
- Instrumentation
- Medical equipment

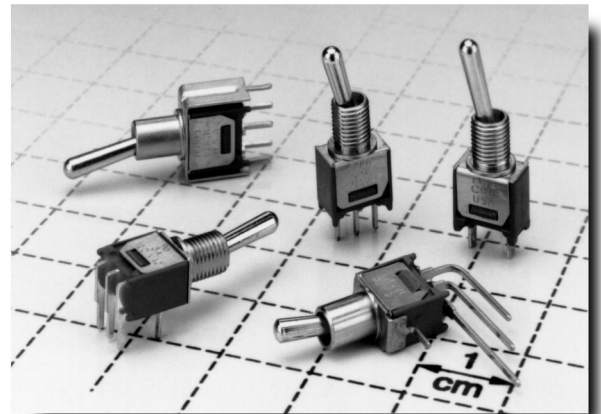

## Build-A-Switch

Our easy Build-A-Switch concept allows you to mix and match options to create the switch you need. Below is a complete listing of options shown in catalog. To order, simply select desired option from each category and place in the appropriate box. Switches with standard options are shown on pages A-40 and A-41. Available options are shown and described on pages A-41 thru A-45. For additional options not shown in catalog, consult Customer Service Center. All models have epoxy terminal seal and are compatible with all "bottom-wash" PCB cleaning methods.

Typical Example: **T 1 0 1** — **S** — **H** — **Z** — **Q** — **E** —

### Switch Function

- T101** (STD.) SPDT On-None-On
- T103** (STD.) SPDT On-Off-On
- T105** (STD.) SPDT Mom.-Off-Mom.
- T201** (STD.) DPDT On-None-On
- T102** SPST Off-None-On
- T107** SPDT On-Off-Mom.
- T108** SPDT On-None-Mom.
- T203** DPDT On-Off-On
- T205** DPDT Mom.-Off-Mom.
- T207** DPDT On-Off-Mom.
- T208** DPDT On-None-Mom.
- T211** DPDT On-On-On

### Actuator

- M** (STD.) .210" high
- P3** (STD.) Flatted, anti-rotation, .450" high
- S** (STD.) .370" high
- K** Locking lever
- K1** Locking lever
- L** .290" high
- L1** .620" high
- M1** .220" high
- S1** .410" high

### Bushing

- H** (STD.) .220" high, threaded, flat
- H9** (STD.) .220" high, unthreaded, flat
- CF** Splashproof, .310" high, threaded, flat
- D9** .260" high, unthreaded, keyway
- K9** .310" high, unthreaded, keyway
- T** .310" high, threaded, flat
- T9** .310" high, unthreaded, flat
- TD** .260" high, threaded, keyway
- TK** .310" high, threaded, keyway
- Y** .220" high, threaded, keyway
- Y9** .220" high, unthreaded, keyway

### Terminations

- A** (STD.) Right angle, PC thru-hole
- AV** (STD.) Vertical right angle, PC thru-hole
- C** (STD.) PC Thru-hole
- V3** (STD.) Vertical mount V-bracket
- Z** (STD.) Solder lug
- W** Wire wrap

### Contact Material

- B** (STD.) Gold
- Q** (STD.) Silver
- K** Gold
- M** Silver
- G** Gold over silver
- L** Gold over silver

### Seal

- E** (STD.) Epoxy

### Locking Lever Actuator Finish

- NONE** (STD.) Natural aluminum
- 2** Black
- 3** Red
- 7** Blue

## Specifications

**CONTACT RATING:** B contact material: 0.4 VA max. @ 20 V AC or DC max. Q contact material (TX01 models): 3 AMPS @ 120 V AC or 28 V DC. All other models: 2 AMPS @ 120 V AC or 28 V DC. See page A-45 for additional ratings.

**ELECTRICAL LIFE:** TX01 models: 60,000 make-and-break cycles at full load. All other models: 30,000 cycles.

**CONTACT RESISTANCE:** Below 20 milliohms typ. initial @ 2-4 V DC, 100 mA, for both silver and gold plated contacts.

**INSULATION RESISTANCE:** 10<sup>9</sup> ohms min.

**DIELECTRIC STRENGTH:** 1000 V RMS min. @ sea level.

**OPERATING TEMPERATURE:** -30°C to 85°C.

**SOLDERABILITY:** Per MIL-STD-202F method 208D, or EIA RS-186E method 9 (1 hour steam aging).

**NOTE:** Specifications and materials listed above are for switches with standard options. For information on specific and custom switches, consult Customer Service Center.

## Materials

**CASE:** Glass filled nylon 6/6, flame retardant, heat stabilized or diallyl phthalate (DAP), (UL 94V-0).

**ACTUATOR:** Brass, chrome plated.

**BUSHING:** Brass, nickel plated.

**HOUSING:** Stainless steel.

**SWITCH SUPPORT:** Brass, tin plated.

**END CONTACTS:** B contact material: Copper alloy, with gold plate over nickel plate. Q contact material: Coin silver, silver plated. See page A-45 for additional contact materials.

**CENTER CONTACTS & TERMINALS:** B contact material: Copper alloy, with gold plate over nickel plate. Q contact material: Copper alloy, silver plated. See page A-45 for additional contact materials.

**TERMINAL SEAL:** Epoxy.

**HARDWARE:** Nut & Locking Ring: Brass, nickel plated. Lockwasher: Steel, nickel plated.

# T Series Subminiature Toggle Switches



## SWITCHES WITH STANDARD OPTIONS



**T101SHZQE**  
**SPDT**

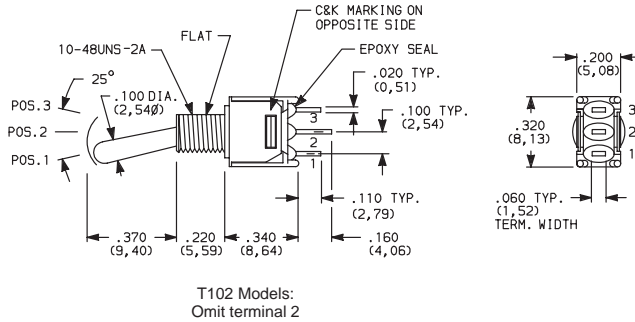

PART NUMBER	NO. POLES	POS. 1	POS. 2	POS. 3
<b>T101SHZQE</b>	SPDT	ON	NONE	ON

**NOTE:** For PC termination, replace 'Z' with 'C'.  
For panel mounting information, see page A-42.  
For PC mounting information, see page A-43.



**T201SHZQE**  
**DPDT**

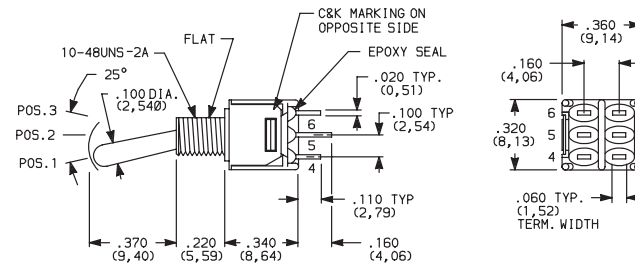

PART NUMBER	NO. POLES	POS. 1	POS. 2	POS. 3
<b>T201SHZQE</b>	DPDT	ON	NONE	ON

**NOTE:** For PC termination, replace 'Z' with 'C'.  
For panel mounting information, see page A-42.  
For PC mounting information, see page A-43.



**T101MH9ABE**  
Horizontal Actuation  
**SPDT**

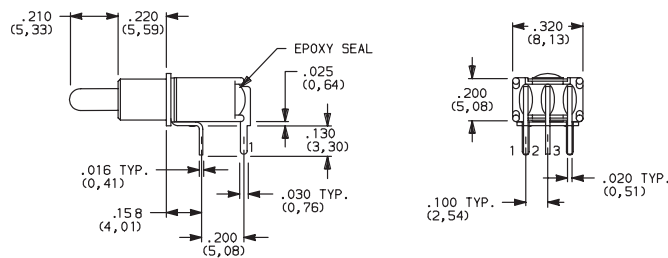

PART NUMBER	NO. POLES	POS. 1	POS. 2	POS. 3
<b>T101MH9ABE</b>	SPDT	ON	NONE	ON
<b>T103MH9ABE</b>		ON	OFF	ON
<b>T105MH9ABE</b>		MOM.	OFF	MOM.
<b>T107MH9ABE</b>		ON	OFF	MOM.
<b>T108MH9ABE</b>		ON	NONE	MOM.

**NOTE:** For PC mounting information, see page A-43.  
MOM. = Momentary

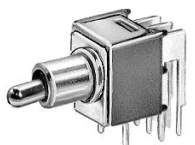

**T201MH9ABE**  
Horizontal Actuation  
**DPDT**

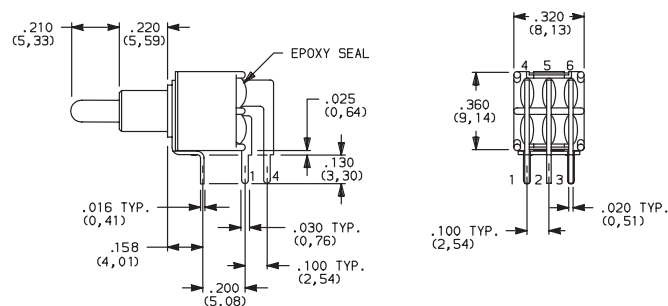

PART NUMBER	NO. POLES	POS. 1	POS. 2	POS. 3
<b>T201MH9ABE</b>	DPDT	ON	NONE	ON

**NOTE:** For PC mounting information, see page A-43.



# T Series Subminiature Toggle Switches

## SWITCH WITH STANDARD OPTIONS

PART NUMBER	NO. POLES	POS. 1	POS. 2	POS. 3
<b>T101MH9AVBE</b>	SPDT	ON	NONE	ON

NOTE: For PC mounting information, see page A-44.

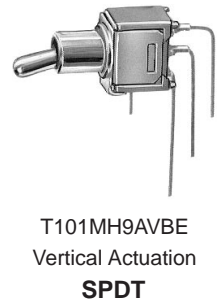
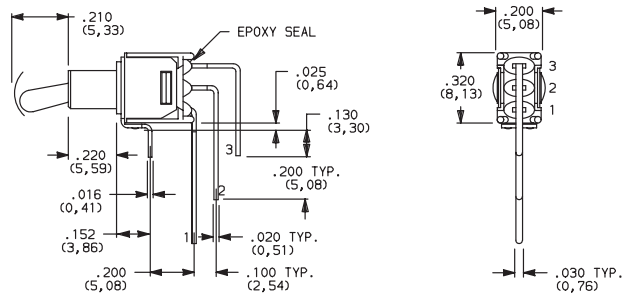

## SWITCH FUNCTION

NO. POLES	MODEL NO.	SWITCH FUNCTION			CONNECTED TERMINALS			SCHEMATIC
		POS. 1	POS. 2	POS. 3	POS. 1	POS. 2	POS. 3	
SP	<b>T101 (STD.)</b>	ON	NONE	ON	2-3	OPEN	2-1	
	<b>T103 (STD.)</b>	ON	OFF	ON				
	<b>T105 (STD.)</b>	MOM.	OFF	MOM.				
	<b>T107</b>	ON	OFF	MOM.				
	<b>T108</b>	ON	NONE	MOM.				
	<b>T102</b>	OFF	NONE	ON				
DP	<b>T201 (STD.)</b>	ON	NONE	ON	2-3,5-6	OPEN	2-1,5-4	
	<b>T203</b>	ON	OFF	ON				
	<b>T205</b>	MOM.	OFF	MOM.				
	<b>T207</b>	ON	OFF	MOM.				
	<b>T208</b>	ON	NONE	MOM.				
	<b>T211*</b>	ON	ON	ON				

MOM. = Momentary

All models with all options when ordered with G, L, M or Q contact material.

\* Wiring for 3-way switch, see page L-29.

## ACTUATOR

**M (STD.)** .210" HIGH

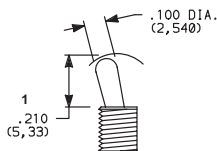

Standard with A, AV or V3 terminations.

**S (STD.)** .370" HIGH

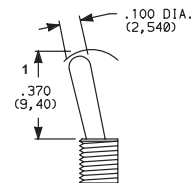

Standard with Z, C or W terminations.

**M1** .220" HIGH

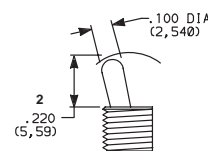

**S1** .410" HIGH

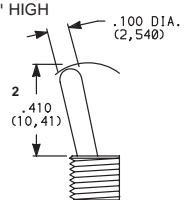

**L** .290" HIGH

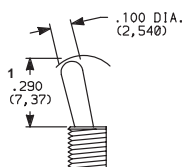

**L1** .620" HIGH

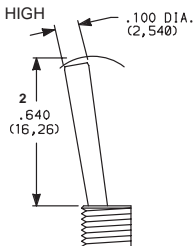

**P3 (STD.)** ANTI-ROTATION, FLATTED, .450" HIGH

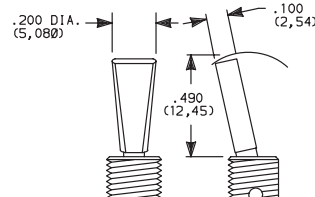

Available with T & T9 bushings only.

<sup>1</sup> Actuator shown with standard H bushing. Subtract .040 (1,02) for TD and D9 bushings, subtract .090 (2,29) for T, T9, TK, K9 & CF bushings.

<sup>2</sup> Actuators shown with T, TK & CF bushings, add .050 (1,27) for TD and D9 bushings, add .090 (2,29) for H, H9, Y & Y9 bushings.

**NOTE:** Dress nut part number 709901201 supplied standard with threaded bushing. All actuators have chrome finish (except K & K1). No finish selection required.

# T Series Subminiature Toggle Switches



Toggle

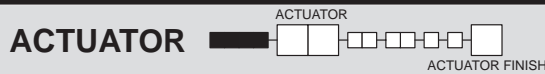

## K LOCKING LEVER

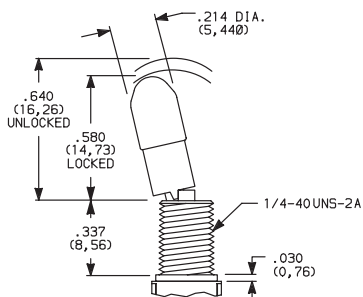

## K1 LOCKING LEVER

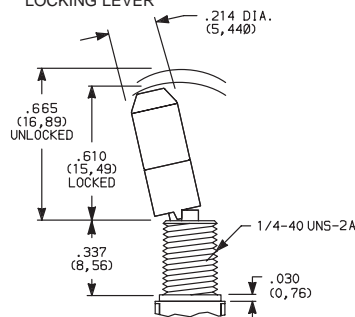

## Locking Positions



-01 & -02 Models  
2 Position lock



-03 & -11 Models  
3 Position lock



-08 Models  
1 Position lock

OPTION CODE	K & K1 ACTUATOR CAP FINISH
NONE	(STD.) NATURAL AL.
2	BLACK ANODIZED AL.
3	RED ANODIZED AL.
7	BLUE ANODIZED AL.

Not available with CF bushing option.

**NOTE:** Keyway on right side. To prevent accidental actuation, toggles must be lifted before being actuated. When released, toggles again lock in place. Overtightening mounting nut may cause actuator to bind.

Bushing option code not required. Not available with TX05 & TX07 models.

## BUSHING

### H (STD.) .220" HIGH THREADED, FLAT

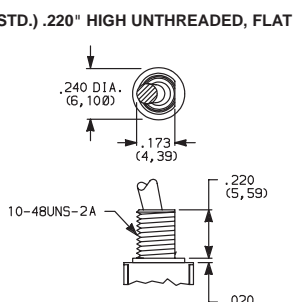

H standard with C, W & Z terminations.  
H9 standard with A, AV & V3 terminations.

### Y .220" HIGH THREADED, KEYWAY

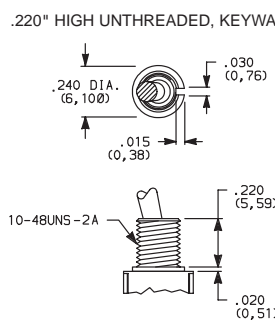

### Y9 .220" HIGH UNTHREADED, KEYWAY

### T .310" HIGH THREADED, FLAT

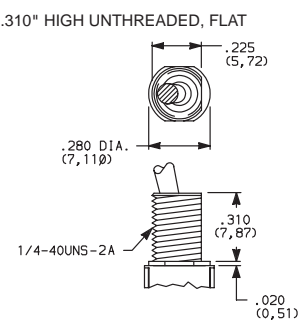

### T9 .310" HIGH UNTHREADED, FLAT

### TK .310" HIGH THREADED, KEYWAY

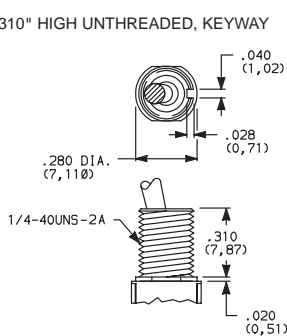

### K9 .310" HIGH UNTHREADED, KEYWAY

### TD .260" HIGH THREADED, KEYWAY

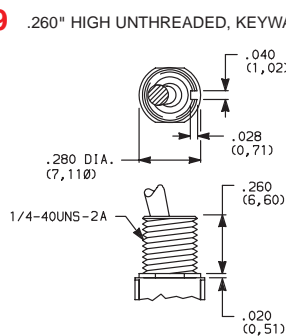

### D9 .260" HIGH UNTHREADED, KEYWAY

### CF SPLASHPROOF, .310" HIGH THREADED, FLAT

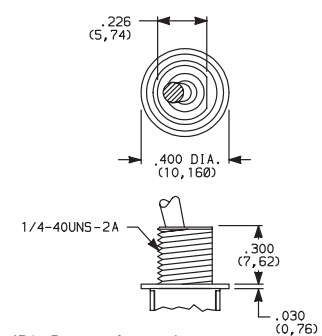

IP67 Degree of protection. Internal o-ring actuator seal and external bushing seal washer standard.

Not available with K locking lever option.

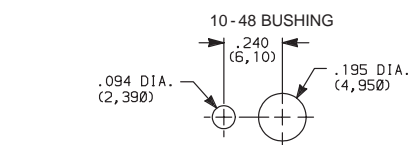

With Standard Locking Ring

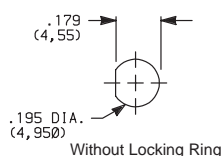

Without Locking Ring

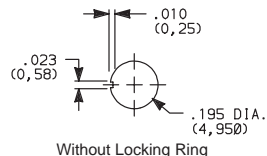

Without Locking Ring

### PANEL MOUNTING

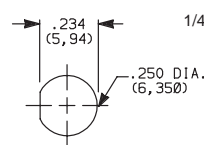

With Standard Locking Ring

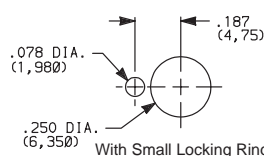

With Small Locking Ring

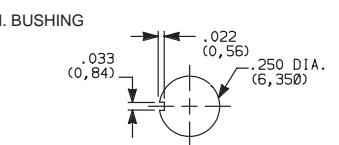

With Standard Locking Ring

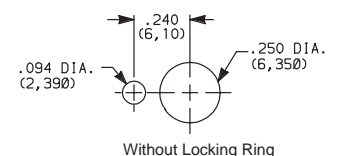

Without Locking Ring

## TERMINATIONS



### Z (STD.) SOLDER LUG

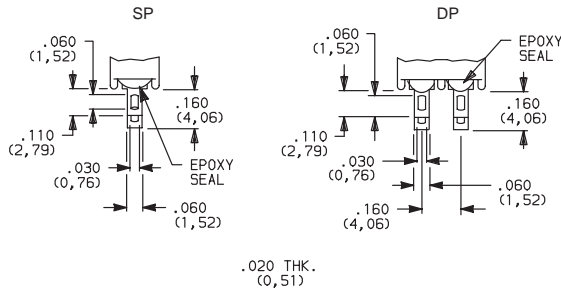

Not available with K, L or M contact materials.

### C (STD.) PC THRU-HOLE

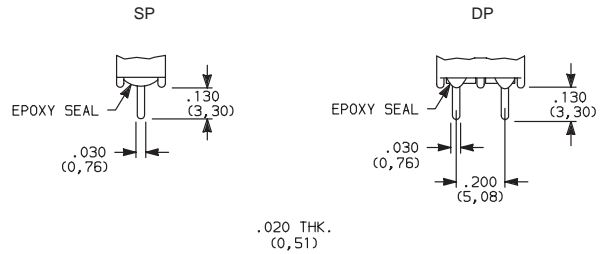

### W WIRE WRAP

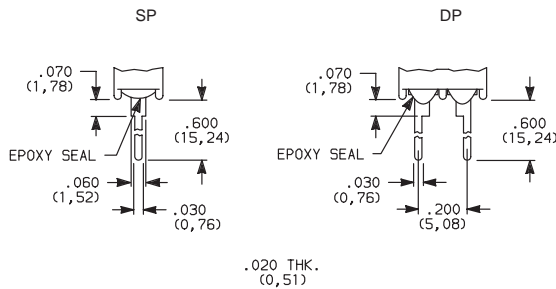

### PC MOUNTING

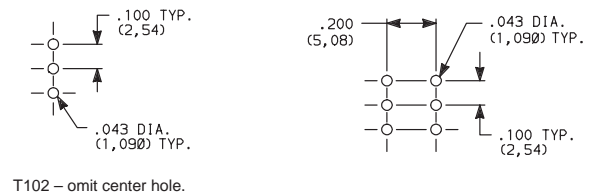

### A (STD.) RIGHT ANGLE, PC THRU-HOLE

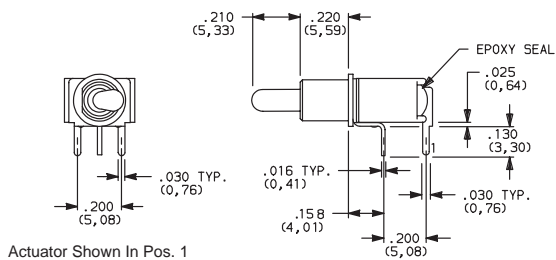

### PC MOUNTING

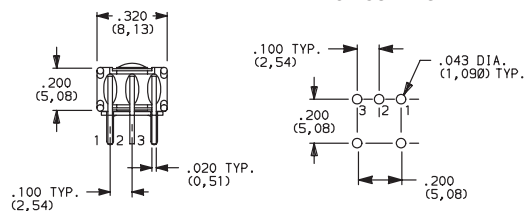

T101MH9ABE  
Horizontal Actuation  
SPDT

Not available with T102 model.

### A (STD.) RIGHT ANGLE, PC THRU-HOLE

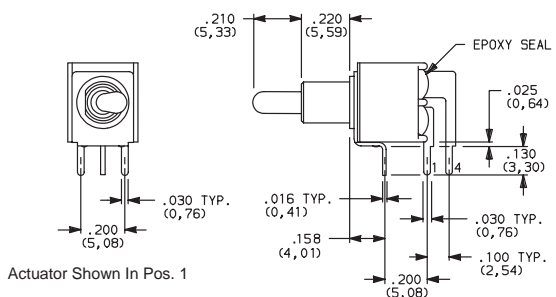

### PC MOUNTING

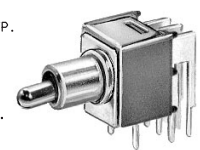
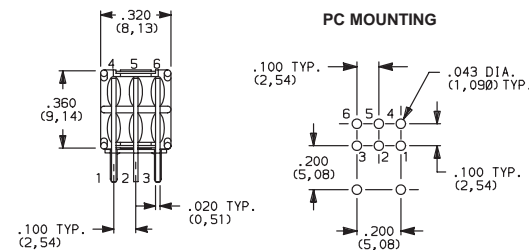

T201MH9ABE  
Horizontal Actuation  
DPDT

# T Series Subminiature Toggle Switches



## TERMINATIONS

**AV** (STD.) VERTICAL RIGHT ANGLE, PC THRU-HOLE

**A**  
Toggle

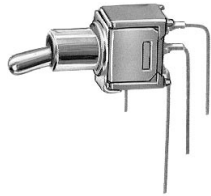

**T101MH9AVBE**  
Vertical Actuation  
**SPDT**

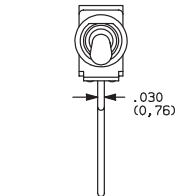

Actuator Shown In Pos. 1

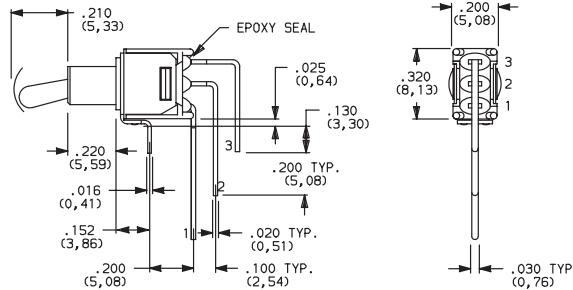

T102 Models: Omit terminal 2

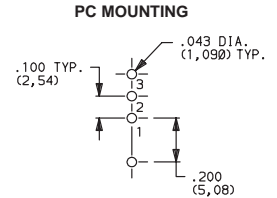

NOTE: Terminal bend radii and lead-in manufacturing option.

**AV** (STD.) VERTICAL RIGHT ANGLE, PC THRU-HOLE

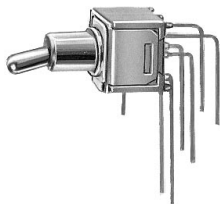

**T201MH9AVBE**  
Vertical Actuation  
**DPDT**

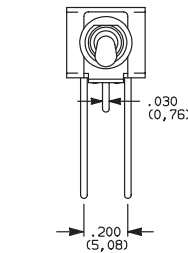

Actuator Shown In Pos. 1

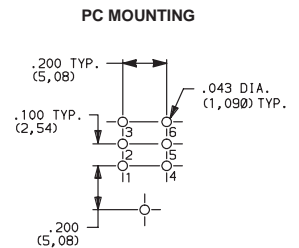
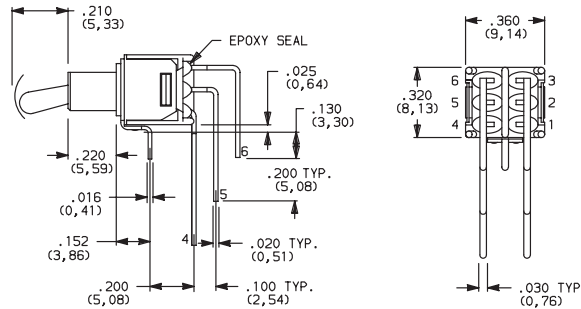

NOTE: Terminal bend radii and lead-in manufacturing option.

**V3** (STD.) VERTICAL MOUNT, V-BRACKET



**T101MH9V3BE**  
**SPDT**

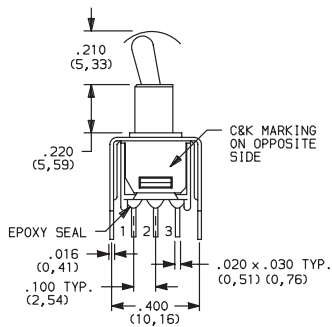

Actuator Shown In Pos. 1

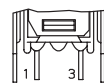

T102 Models:  
Omit terminal 2

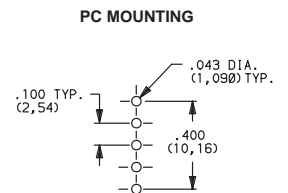
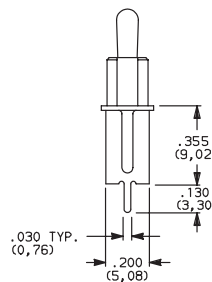

T102 Models:  
Omit center hole.



# T Series Subminiature Toggle Switches

## TERMINATIONS

### V3 (STD.) VERTICAL MOUNT, V-BRACKET



T201MH9V3BE  
DPDT

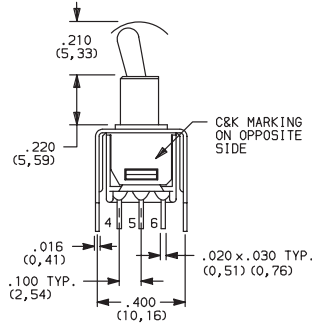

Actuator Shown In Pos. 1

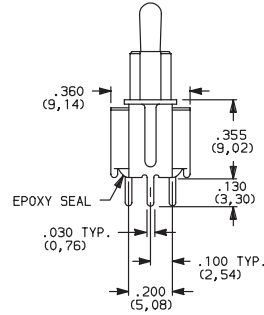

### PC MOUNTING

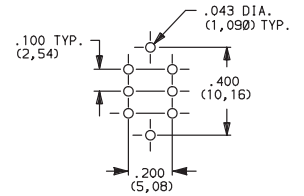

## CONTACT MATERIAL

OPTION CODE	CONTACT MATERIAL	TERMINAL PLATING	RATINGS	
<b>B (STD.)</b>	GOLD <sup>1</sup>	GOLD <sup>1</sup>	LOW LEVEL / DRY CIRCUIT	0.4 VA MAX. @ 20 V AC OR DC MAX.
<b>K</b>		TIN-LEAD <sup>6</sup>		
<b>Q (STD.)</b>	SILVER <sup>4,5</sup>	SILVER <sup>5</sup>	POWER	TX01 MODELS: 3 AMPS @ 120 V AC OR 28 V DC. ALL OTHER MODELS: 2 AMPS @ 120 V AC OR 28 V DC.
<b>M</b>		TIN-LEAD <sup>6</sup>		
<b>G</b>	GOLD OVER SILVER <sup>2,3</sup>	GOLD <sup>3</sup>	LOW LEVEL / DRY CIRCUIT OR POWER	TX01 MODELS: 0.4 VA MAX @ 20 V AC OR DC MAX. OR 3 AMPS @ 120 V AC OR 28 V DC. ALL OTHER MODELS: 0.4 VA MAX. @ 20 V AC OR DC MAX. OR 2 AMPS @ 120 V AC OR 28 V DC.
<b>L</b>		TIN-LEAD <sup>6</sup>		

CONTACT MATERIAL / APPLICATION RECOMMENDATIONS—SEE CHART, PAGE L-31.

- <sup>1</sup> CONTACTS & TERMINALS: Copper alloy, with gold plate over nickel plate.
- <sup>2</sup> END CONTACTS: Coin silver, with gold plate over nickel plate.
- <sup>3</sup> CENTER CONTACTS & ALL TERMINALS: Copper alloy, with gold plate over nickel plate.
- <sup>4</sup> END CONTACTS: Coin silver, silver plated.
- <sup>5</sup> CENTER CONTACT & ALL TERMINALS: Copper alloy, silver plated.
- <sup>6</sup> TERMINALS: Copper alloy, with tin-lead alloy over nickel plate.

All models with all options when ordered with G, L, M or Q contact material.  
B contact material standard with A, AV, V3 & W terminations.  
Q contact material standard with C & Z terminations.

## SEAL

### E (STD.) EPOXY SEAL

