

STAMP: 91836 M39012/34-0001
KA-71-03 XXXX

DATE CODE
MOUNTING HOLE

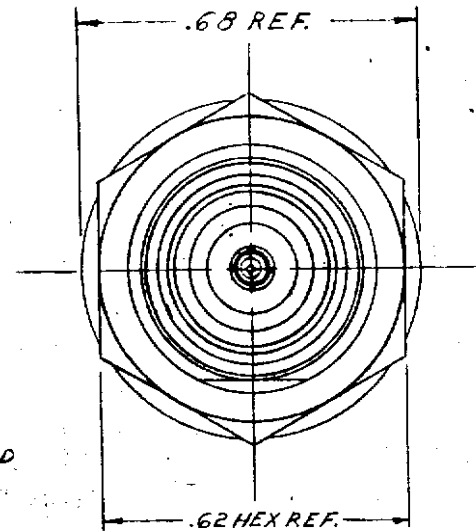
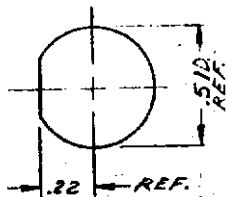

M39012/34-0001

REVISIONS

ISSUE	CHANGES
4	CN 8365C WLA 5 MAR 70
5	CN 9859A WLA 22 JUL 71
6	CN 23168 E MD 29 MAR 82
7	CN 32302A LNM 21 JUN 90

KA-71-03

QTY	DESCRIPTION	REF.
1	SOLDER PREFORM	
1	INSULATOR	
1	SLEEVE	
1	NUT	492A-9-M67
1	LOCKWASHER	492A-12-M67
1	GASKET	492A-10-M67
1	GLASS TERMINAL	
1	BODY	
1	CONTACT	
1	CONTACT ASS'Y.	

FINISH	
SPEC	
MATL	
SPEC	
TMC RECEPTACLE HERMETIC SEALED	
DRAWN WLA	DATE 16 FEB 70
APP. [Signature]	DATE 3-5-70

KINGS ELECTRONICS
48 HARBORDALE ROAD
TUCKAHOE, N. Y. 10787

UNLESS OTHERWISE SPECIFIED:

- TOLERANCES: FRACTIONS & 2 PLACE DECIMALS ± .010
3 PLACE DECIMALS ± .004
4 PLACE DECIMALS ± .001
- REMOVE ALL BURRS. BREAK SHARP EDGES .008 MAX.
- NO FILLETS PERMITTED.
- SURFACE ROUGHNESS 83 MICROINCHES RMS MAX.

DRAWING NO. M39012/34-0001