

DASH NO.	M CODE	MADE FROM
----------	--------	-----------

GSD

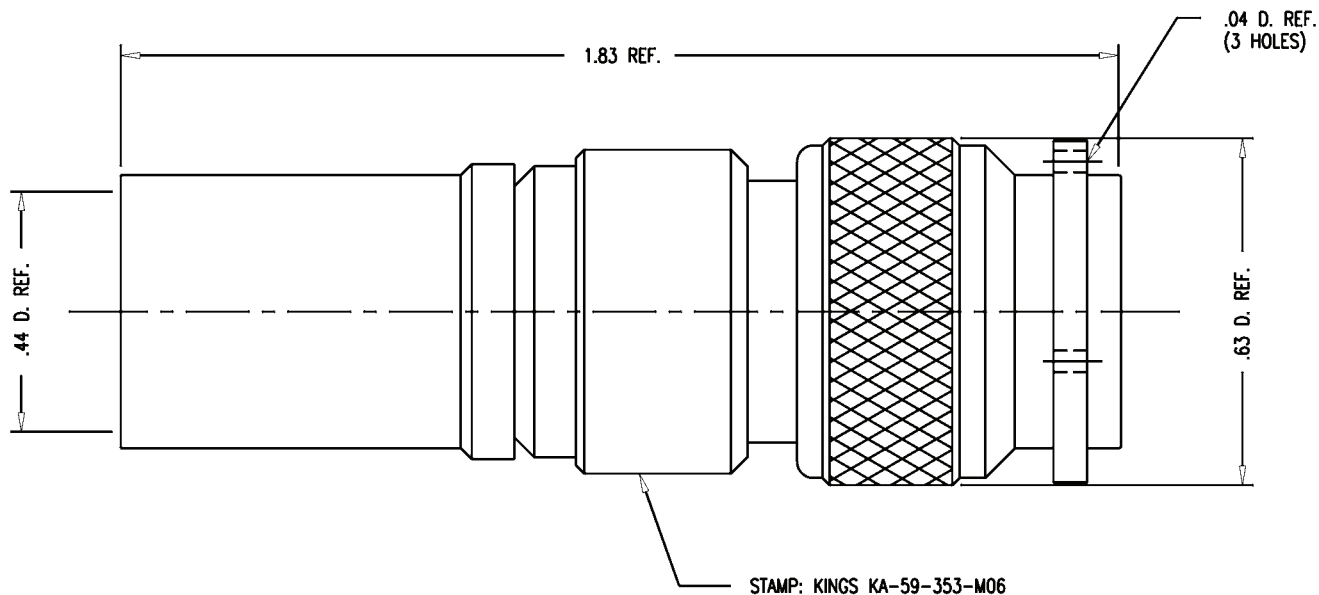

NOTES:

1. FOR USE WITH RG-393/U CABLE.
2. FOR CABLE TRIMMING USE KTJ-150 AND KTD-138.
3. FOR CRIMPING USE DIE SIZE KTH-2105.
4. FOR CABLING INSTRUCTIONS SEE CP-5402.
5. CENTER CONTACT TO BE SUPPLIED UNASSEMBLED.
6. MATERIALS:  
 INSULATOR-TEFLON, L-P-403  
 GASKET-SILICONE RUBBER, ZZ-R-765  
 K-GRIP SLEEVE-COMMERCIAL BRONZE TUBE, ALLOY 220  
 C-RING-PHOSPOR BRONZE, QQ-B-750  
 OUTER CONTACT-BER. COP., QQ-C-530  
 ALL OTHER METAL PARTS-BRASS, QQ-B-626
7. FINISHES:  
 CENTER CONTACT-.00005 HARD GOLD PLATE PER MIL-G-45204  
 ALL OTHER METAL PARTS-KINGS TARNISH RESISTANT FINISH (TR-5)
8. ELECTRICAL CHARACTERISTICS:  
 NOMINAL IMPEDANCE-50 OHMS  
 FREQUENCY RANGE-DC TO 11 GHZ  
 WORKING VOLTAGE-500 VRMS
9. MARK PACKAGE: KINGS KA-59-353-M06  
 XXXX (DATE CODE)

KA-59-353-M06

REVISIONS	
ISSUE	CHANGES
3	CN 31109 A AJ 14 SEP 89

SCALE 4:1	
APPROX SURFACE AREA	
WAS: E-11379	
USED ON	
REF:	
TNC PLUG	
DRAWN KH	DATE 05/29/90
DESIGN MJB	DATE 05/30/90
APPR.	DATE

KA-59-353-M06

GSD