

# MW136

MEDICAL 60 WATT SERIES



Photo shows Ault #3 Connector

## MW136 SWITCH-MODE POWER SUPPLY

- 100-250 VAC Universal Input
- Desktop / Wallmount Styles
- Single Output Up to 60W
- Regulated Output With Low Ripple
- Meets Safety Agency Requirements
- Complies With EMI/RFI Regulations
- CE Compliant
- Impact Resistant Polycarbonate Enclosure
- Private Label Marking Available
- 3 Year Warranty
- Modified and Custom Designs Also Available

### MW136

Ault Part No.	Voltage DC	Max Amps	Max Watts	Ripple p-p Max
MW136RA1203_01	12V	5.00	60.0	120mV
MW136RA1503_01	15V	4.00	60.0	150mV
MW136RA1803_01	18V	3.33	60.0	180mV
MW136RA2403_01	24V	2.50	60.0	240mV

### Ault Part No. Key

Product Family Name	Manufacturing Location (volume dependent)	Design Revision Changes	Voltage DC	Connector	Input Configuration/ Model Type (see pg. 2)	Standard (no modifications, special artwork or special packaging)
MW136 R	A	12	03	—	01	



AULT INCORPORATED

7105 Northland Terrace | Minneapolis, Minnesota 55428 | USATEL (1) 763-592-1900

FAX (1) 763-592-1911 | E-MAIL [info@aultinc.com](mailto:info@aultinc.com) | WEB [www.aultinc.com](http://www.aultinc.com)

© Copyright 2005 Ault Inc.

# MW136

## MEDICAL 60 WATT SERIES

### Input

Voltage	100-250 VAC -10%, +6%
Line Frequency	47-63 Hz
Current	1.0 Amp max. at 90 VAC input
Protection	Internal primary current fuse, Inrush limiting, Thermal shutdown

### Output

Combined Line and Load Voltage Regulation	±1% (excluding cord)
Ripple	See table
Transient Response	0.5 msec. for 50% load change typical
Holdup Time	18 msec min. @ 120 VAC 80 msec min. @ 240 VAC
Protection	Overcurrent protection, Short circuit Protection
Cord and Connectors	6 ft., 2 conductor, 18 AWG, #3 connector

### Safety Approvals

Agency Listings	CURus, UL2601, CSA60601, TUV EN60601
-----------------	--------------------------------------

### Electrical

Topology	Switching-fixed frequency flyback
Dielectric Withstand	3000VAC, 4242 VDC primary-secondary 1500 VAC, 2121 VDC primary-GND
Spacing	6.4mm primary-secondary
Efficiency	Up to 85%
EMI	Complies with EMC Directives
CE	CE Compliant
MTBF	100,000 Calculated Hours Minimum

### Environmental

Operating Temperature	0° to 40° C with no derating
Storage Temperature	-30° to +85° C
Relative Humidity	5% to 95% non-condensing
Altitude	0-10,000 feet
Cooling	Convectional-non vented case

### Mechanical

Case and Dimensions	All Models 3.92L x 2.58W x 1.61H (in) 100L x 66W x 41H (mm)
Case Material	Black 94V0 Polycarbonate
Weight	Max. 10 ounces, 285 grams (excluding cord)

### Input Configuration



IEC320  
w/ground  
C14  
(F)



IEC320  
w/o ground  
C18  
(Q)



N. America/  
Japan  
(B)



Europe  
(M)



United  
Kingdom  
(G)

Specify the Input Configuration Code in your order.

### Connector

# 3

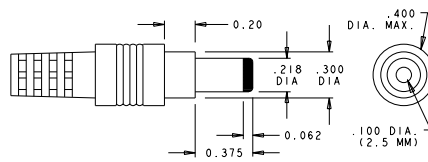

Pinout Code	Center contact: positive
Description	Switchcraft 760 plug or equivalent
Suggested Mating	Switchcraft 712A jack or equivalent
Other Connectors are available by special order	



AULT INCORPORATED

7105 Northland Terrace | Minneapolis, Minnesota 55428 | USATEL (1) 763-592-1900

FAX (1) 763-592-1911 | E-MAIL info@aultinc.com | WEB www.aaultinc.com

© Copyright 2005 Ault Inc.