

THIS COPY IS PROVIDED ON A RESTRICTED BASIS AND IS NOT TO BE USED IN ANY WAY DETRIMENTAL TO THE INTERESTS OF PANDUIT CORP.

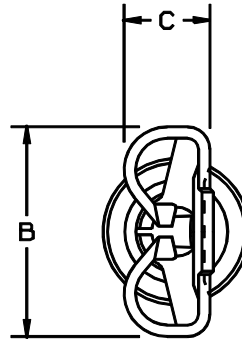
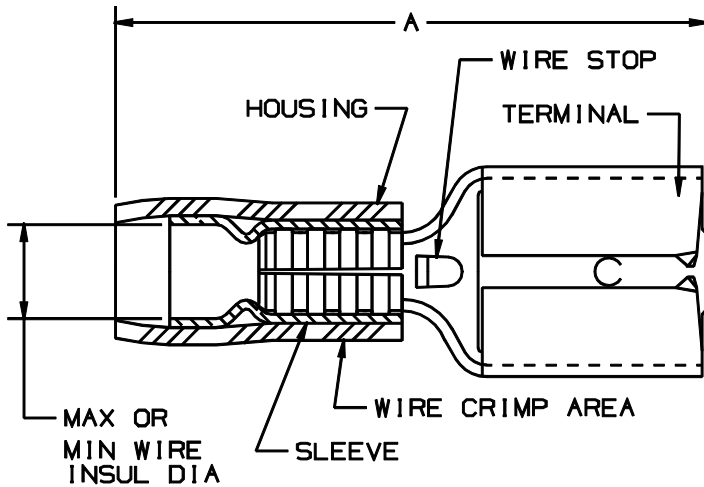

NOTES:

1. UL LISTED AND CSA CERTIFIED FOR:
  - A. 300V MAX VOLTAGE RATING
  - B. 194°F (90°C) MAX TEMP RATING
  - C. STRANDED COPPER WIRE ONLY
  - D. 6-12 LBS INITIAL INSERTION/WITHDRAWAL FORCE
2. MATERIAL:
  - A. STAMPING-BRASS, TIN PLATED
  - B. HOUSING-NYLON
  - C. SLEEVE-BRASS, TIN PLATED
3. DIMENSIONS IN BRACKETS ARE IN mm OR mm<sup>2</sup>
4. INSTALLATION TOOLS: UL/CSA: CT-500  
PANDUIT APPROVED: CT-100, CT-160, CT-260, CT-400, CT-460, CT-1551, CT-1550
5. WIRE STRIP LENGTH: 9/32 ±.002 (7.1 ±.08)
6. PKG QTY:
  - C = 100
  - M = 1000

PART NUMBER	TAB SIZE	WIRE RANGE AWG	COLOR	MAX. INSUL.	MIN. INSUL.	DIMENSIONS in.		
						A ±.03	B ±.01	C ±.004
DNF18-250	.250 X .032	22-18	RED	.138 (3.51)	.040 (1.02)	.81 (20.57)	.29 (7.37)	.12 (3.05)
DNF14-250	.250 X .032	16-14	BLUE	.162 (4.11)	.050 (1.27)	.83 (21.08)	.29 (7.37)	.12 (3.05)



06	1/01	KMD		CAD FILE SPEC. WAS N41200AA_PCD_05				
05	3/99	JKD		ADDED CT-1551 & CT-1550 TOOLS	07632			
04	12/96	JB	RLS	ADDED TO TABLE "MIN INSUL"	05427	LA	DBH	
03	4/95	MS	RLS	REMOVED SLOT FROM TERMINAL	03132	LA	KRS	
02	12/94	TH	RS	UPDATED NOTES AND DIMENSIONS	02819	LA	JJM	
REV	DATE	BY	CHK	DESCRIPTION	ECN #	CUST	PM	

A41200\_06

**PANDUIT** CORP.

TINLEY PARK, ILLINOIS

FEMALE DISCONNECTS, NYLON INSULATED, FUNNEL  
.250 X .032

DRAWN BY FES	CHK'D LA	SCALE NONE	DRAWING NO. A41200
-----------------	-------------	---------------	-----------------------