

- **85 - 264 Vac input range (100 - 240 Vac nominal)**
- **Overvoltage and short circuit protection**
- **Approved to UL, CSA and EN Standards**
- **Class II input**
- **RoHS Compliant (G suffix models)**

The GSM11 Series is an 11 W universal input AC/DC power supply in an industry leading small footprint. With the medical approvals the GSM11 is ideal for a variety of medical device applications including small single board computers, battery charging, and running small motors, pumps, and solenoids. The series, with full approval to EN60601-1 and EN60950-1 Standards, improves design-in time and reduces end system compliance costs.

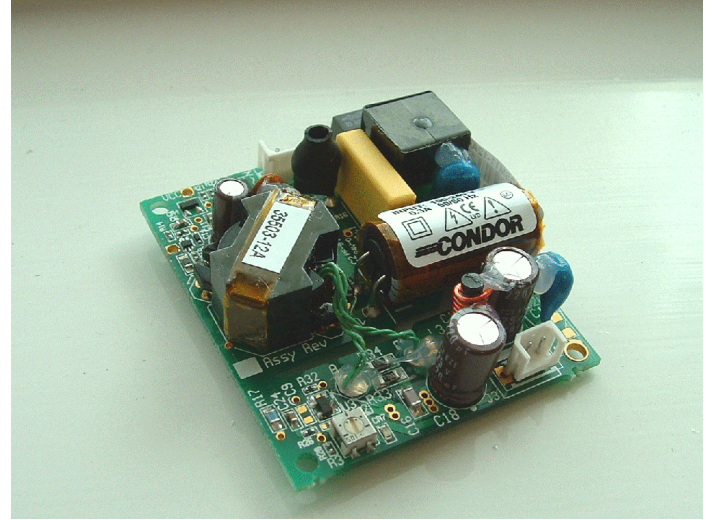

| OUTPUT SPECIFICATIONS | | |
|------------------------------|-----------------------------------|-------------------------------------|
| Output Power | Natural Convection | 11 Watts |
| Total Regulation | | See table |
| Turn on time | | 2.0 s max. |
| Transient response | Main output 50% 0.2 A/ μ s | 5% max. dev. 1 ms recovery to 1% |
| Temperature Coef- ficient | | +/-0.03%/oC |
| Overvoltage protection | | 110 - 155% |
| Short Circuit protection | Power cycling | 135 % +/- 20 % |

| INPUT SPECIFICATIONS | | |
|----------------------|-----------------|-----------------------------------|
| Input Voltage range | Universal input | 100-240 nom (85 - 264 max) Vac |
| Input frequency | | 55 Hz +/- 10 Hz |
| Input surge current | | 35 A max. |
| Input current | 120 Vac | 0.23 A |
| | 230 Vac | 0.16 A |
| Input fuse | F1 | 1.0 A |

| EMC INFORMATION | | |
|------------------------|--------------|---|
| Conducted emissions | EN55011 | Level B |
| Radiated emissions | EN55011 | Level A |
| Line freq. harmonics | EN61000-3-2 | Complies |
| Voltage fluctuations | EN61000-3-3 | Complies |
| ESD Air | EN61000-4-2 | 8 kV air |
| ESD Contact | EN61000-4-2 | 4 kV contact |
| Radiated immunity | EN61000-4-3 | 3 V/m |
| Fast Transients (EFT) | EN61000-4-4 | 2 kV |
| Line surge immunity | EN61000-4-5 | 1 kV differential |
| Conducted immunity | EN61000-4-6 | 3 Vrms |
| Power freq. mag. field | EN61000-4-8 | 3 A/m |
| Voltage dip immunity | EN61000-4-11 | 5 cycles 40 % vnom 4.0 Watts. 25 cycles 70 % vnom 11 W |

| ENVIRONMENTAL SPECIFICATIONS | | |
|------------------------------|--|---------------------------------|
| Thermal Performance | operating ambient (see ratings chart) | 0-70 °C |
| | non-operating | -40 to +85 °C |
| | 0 - 50 °C Convection cooled | 11 Watts |
| | 50 -70 °C ambient Convection cooled | derate to 50% |
| Relative Humidity | non-condensing | 5% - 95% RH |
| Maximum Altitude | operating / non-operating | 10,000 ft. / 40,000 ft. max. |
| Vibration | 5 Hz- 500 Hz | 2.5 g rms |
| Shock | per MIL-STD-810E | 516.4 part IV |

| GENERAL SPECIFICATIONS | | |
|------------------------|---------------------|--|
| Hold-up time | 120 Vac, 60 Hz | >31 ms at 11 Watts output |
| Efficiency | 120 Vac 11 W output | 67 - 77 % |
| isolation voltage | input to ouput | 4000 Vac 1500 Vac |
| Switching frequency | fixed | 80 KHz, +/- 5 KHz |
| Safety Approvals | | UL/EN/IEC 60601-1 CSA22.2 No.601 UL/EN/IEC 60950-1 CSA22.2 No.60950-1 |
| Maximum weight | | 50 g (0.1 lbs) |

| MODEL NUMBER Shown with opt A Connectors | 50°C Convection | RIPPLE | REGULATION | ADJUSTMENT |
|---|-----------------|--------|------------|------------|
| GSM11-3AAG | 3.3 V 2.0 A | 50 mV | 2% | +/- 5% |
| GSM11-5AAG | 5.1 V 2.2 A | 50 mV | 2% | +/- 5% |
| GSM11-12AAG | 12 V 0.92 A | 120 mV | 2% | +/- 5% |
| GSM11-15AAG | 15 V 0.73 A | 150 mV | 2% | +/- 5% |
| GSM11-24AAG | 24 V 0.46 A | 240 mV | 2% | +/- 5% |
| GSM11-28AAG | 28 V 0.39 A | 280 mV | 2% | +/- 5% |

NOTES

1. Convection cooling rating is 11 Watts (7 Watts on 3.3 V unit)
2. When the input voltage is less than 90 Vac the operating temperature range is 0°C to 40°C. The ripple and regulation specs. may not be met.
3. Peak output rating is 15 Watts for 1 minute, 10% duty cycle. (7 Watts on 3.3 V unit)
4. Noise 0.5% RMS, 1% Pk-Pk, 20 MHz Bandwidth, differential mode. Measured with scope probe directly across output terminals of the power supply.
5. Installation data is online at www.condorpower.com

| GSM11 CONNECTOR OPTIONS (other options available) | | | |
|---|-------------------------------|-------------------------------|-------------------------------|
| AC INPUT | OPTION A | OPTION B | OPTION T |
| Connector | 2.5 mm SPOX | 0.025" Square pin locking | Screw terminal block |
| Part Num | MOLEX 22-43-8030 | MOLEX 22-23-2031 | Weco 950-T-DS/02 |
| Mate | MOLEX 50-37-5033 | MOLEX 22-01-2035 | 26-16 Gage |
| Pins | MOLEX 08-70-1040 | MOLEX 08-50-0113 | N/A |
| Kit | 18-30234-111A | 18-30234-111B | N/A |
| | Pin 1 =neutral Pin 3 =line | Pin 1 =neutral Pin 3 =line | Pin 1 =neutral Pin 2 =line |
| DC OUTPUT | OPTION A | OPTION B | OPTION T |
| Connector | 2.5 mm SPOX | 0.025" Square pin locking | Screw terminal block |
| Part Num | MOLEX 22-43-8020 | MOLEX 22-23-2021 | Weco 950-T-DS/02 |
| Mate | MOLEX 50-37-5023 | MOLEX 22-01-2025 | 26-16 Gage |
| Pins | MOLEX 08-70-1040 | MOLEX 08-50-0113 | N/A |
| Kit | 18-30234-112A | 18-30234-112B | N/A |
| | Pin 1=+Vout Pin 2 =Return | Pin 1=+Vout Pin 2 =Return | Pin 1=+Vout Pin 2 =Return |

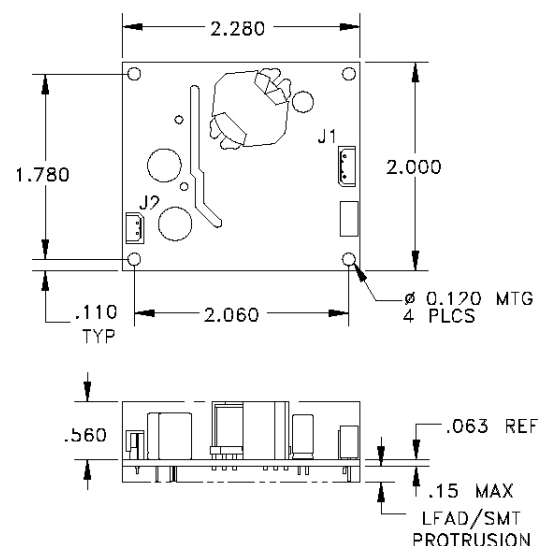

GSM11 Part Numbering Scheme

GSM11-xxYYG

xx=Volts (5, 12, etc)

YY=In-out connectors e.g. AA, TB, BA

G=RoHS Compliant