

3P AC INLET RECEPTACLE

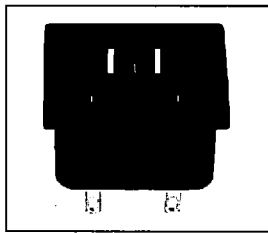

AC-016

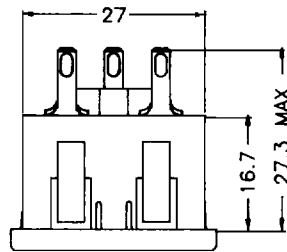

ORDERING CODE:
AC-016-□ - □

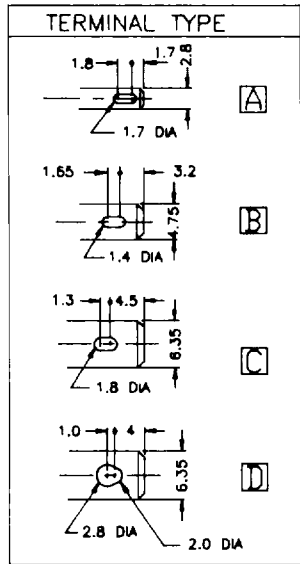
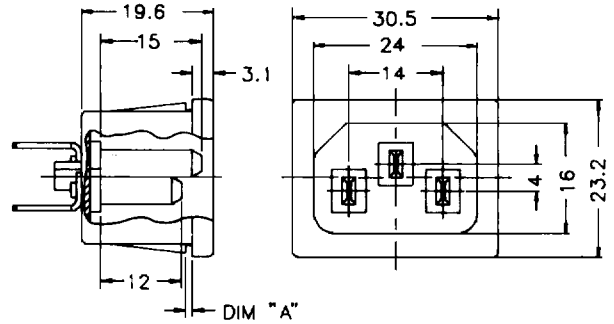

PART NUMBER	PANEL THICKNESS	DIM 'A'
300	3.0	3.33
250	2.5	2.79
230	2.3	2.44
200	2.0	2.23
180	1.8	1.95
150	1.5	1.7
130	1.3	1.4
100	1.0	1.14
080	0.8	0.99

PANEL CUT OUT DIM.
(THICKNESS SEE TABLE)

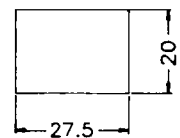

Insulation Resistance: 100MΩ Min.
Dielectric Strength: 2000V Min.
Operating Temperature: 65°C
15A 250V: UL,CSA.
10A 250V: VDE,SEMKO,NEMKO,DEMKO,FIMKO.

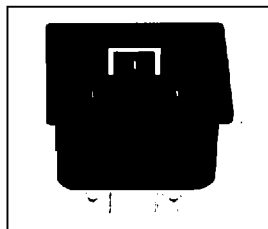

AC-017

(HOT TYPE)

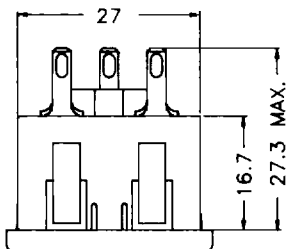

ORDERING CODE:
AC-017-□ - □

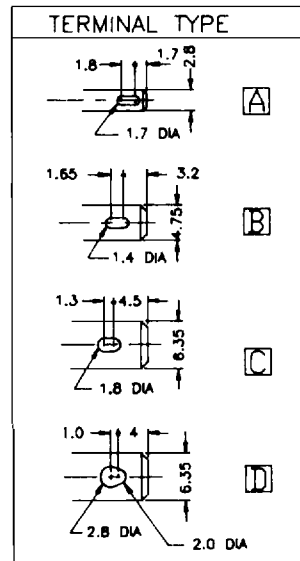
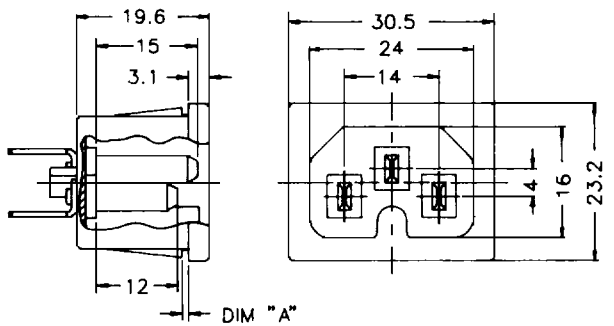

PART NUMBER	PANEL THICKNESS	DIM 'A'
300	3.0	3.33
250	2.5	2.79
230	2.3	2.44
200	2.0	2.23
180	1.8	1.95
150	1.5	1.7
130	1.3	1.4
100	1.0	1.14
080	0.8	0.99

PANEL CUT OUT DIM.
(THICKNESS SEE TABLE)

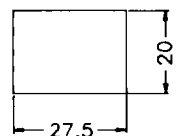

Insulation Resistance: 100MΩ Min.
Dielectric Strength: 2000V Min.
Operating Temperature: 120°C
15A 250V: UL,CSA.
10A 250V: VDE,SEMKO,NEMKO,DEMKO,FIMKO.