

# SMD Inductors(Coils) For Power Line(Wound, Magnetic Shielded)

Conformity to RoHS Directive

## SLF Series SLF10165

### FEATURES

- Miniature size  
Mount area: 10.1×10.1mm  
Height: 7mm max.
- Generic use for portable DC to DC converter line.
- High magnetic shield construction should actualize high resolution for EMC protection.
- Available for automatic mounting in tape and reel package.
- The products do not contain lead and support lead-free soldering.

### SHAPES AND DIMENSIONS

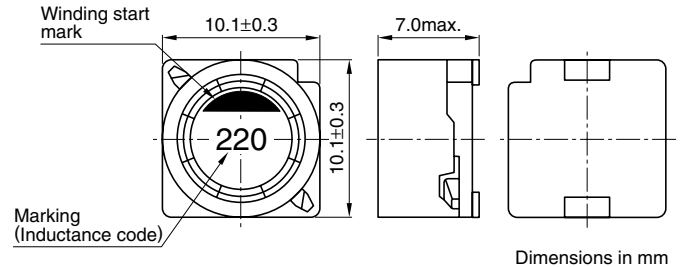

### APPLICATIONS

TVs, PDPs, notebook PCs, portable DVD players, terminal adapters, amusement games, LCD monitors, digital audios, etc.

### RECOMMENDED PC BOARD PATTERN

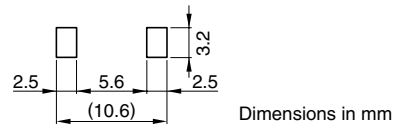

### ELECTRICAL CHARACTERISTICS

Part No.	Inductance (μH)	Inductance tolerance(%)	Test frequency (kHz)	DC resistance (mΩ)	Rated current(A)*	
					Based on inductance change typ.	Based on temperature rise typ.
SLF10165T-1R5N6R83PF	1.5	±30	100	6.7±30%	10.7	6.8
SLF10165T-2R2N6R33PF	2.2	±30	100	8.4±30%	8.9	6.3
SLF10165T-3R3N5R83PF	3.3	±30	100	9.6±30%	7.8	5.8
SLF10165T-4R7N4R73PF	4.7	±30	100	11.7±30%	6.1	4.7
SLF10165T-6R8N4R33PF	6.8	±30	100	14±30%	4.6	4.3
SLF10165T-100M3R83PF	10	±20	100	18.5±20%	4.1	3.8
SLF10165T-150M3R13PF	15	±20	100	27±20%	3.1	3.1
SLF10165T-220M2R43PF	22	±20	100	44.8±20%	2.7	2.4

\* Rated current: Value obtained when current flows and the temperature has risen to 30°C or when DC current flows and the nominal value of inductance has fallen by 10%, whichever is smaller.

- Operating temperature range: -40 to +105°C (Including self-temperature rise)

• Conformity to RoHS Directive: This means that, in conformity with EU Directive 2002/95/EC, lead, cadmium, mercury, hexavalent chromium, and specific bromine-based flame retardants, PBB and PBDE, have not been used, except for exempted applications.

• All specifications are subject to change without notice.