

ADAM TECH

ADAM TECHNOLOGIES INC.

INTRODUCTION:

Adam Tech ADC Series DC Power Jacks are PC board and panel mount power connectors that are generally used in conjunction with AC adapters in the conversion of AC wall voltage to lower DC voltage. Typical applications include office equipment, modems, instrumentation and small electronic devices. Our contact system uses a wide, spring temper, phosphor bronze blade for superior contact pressure and low contact resistance. Its low-profile, compact design is well suited for most applications.

FEATURES:

- Choice of 1.00, 1.30, 2.00 or 2.50mm center pin
- Low profile PC board and panel types
- Universally intermateable
- Compatible with wave, vapor-phase or IR reflow soldering processes

MATING OPTIONS:

Mates with all industry standard compatible DC Plugs

SPECIFICATIONS:

Material:

Insulator: Polyformaldehyde (POM), glass-reinforced thermoplastic, rated UL 94HB

Contacts: Copper Alloy

Plating:

100 μ m Nickel plate to MIL-T-10727, Type 1 with 50 μ m copper underplate to MIL-C-14550

Electrical:

Operation voltage: 250 VAC max

Current rating: 1 Amp max

Contact resistance: 20 m Ω max

Insulation resistance: 5000 M Ω min @ 1000 VDC between adjacent contacts (75°F and 50% R.H.)

Dielectric withstanding voltage: 1000 VAC min rms (sea level)

Capacitance: 1.5 pF max between adjacent contacts

Mechanical:

Insertion force: 7 ozs. max

Withdrawal force: 4 ozs. min

Applicable soldering processes: Hand, wave, vapor-phase or IR Reflow

Environmental:

Operating temperature: -65°C to +85°C

PACKAGING:

Anti-static plastic bags

APPROVALS AND CERTIFICATIONS:

Recognized under the component program of Underwriters Laboratories, Inc. No. E167232
Certified by Canadian Standards Association No. LR75112



DC POWER JACKS

PC BOARD AND PANEL MOUNT

ADC SERIES

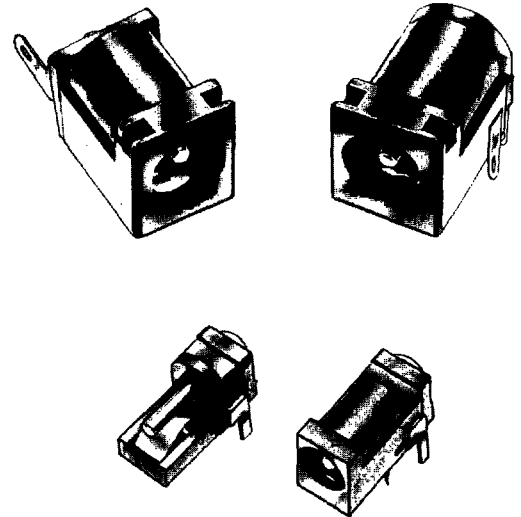

ORDERING INFORMATION

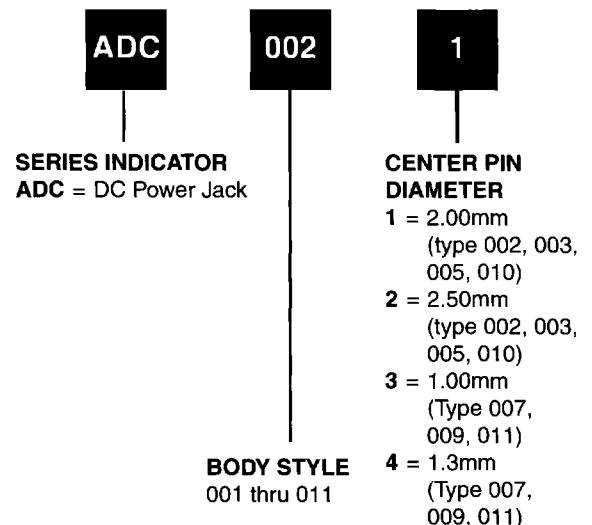

Hi-TEMP
OPTION

OPTIONS:

Add as suffix to basic part number

RT = PC Board Retention Feature (Type 007 & 009 only.)

HT = Hi-Temp insulator for IR reflow or Vapor Phase soldering process

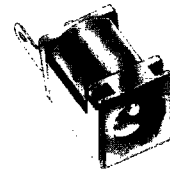
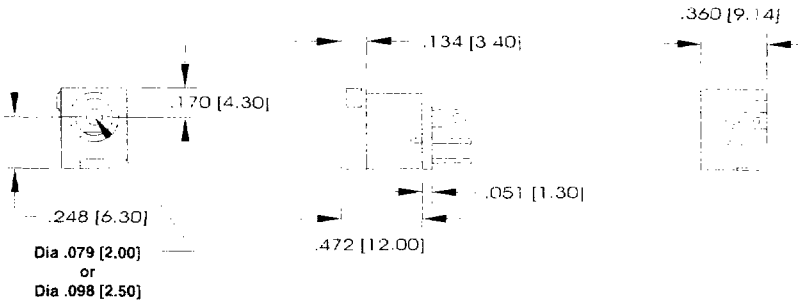

ADC - 010

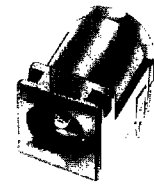
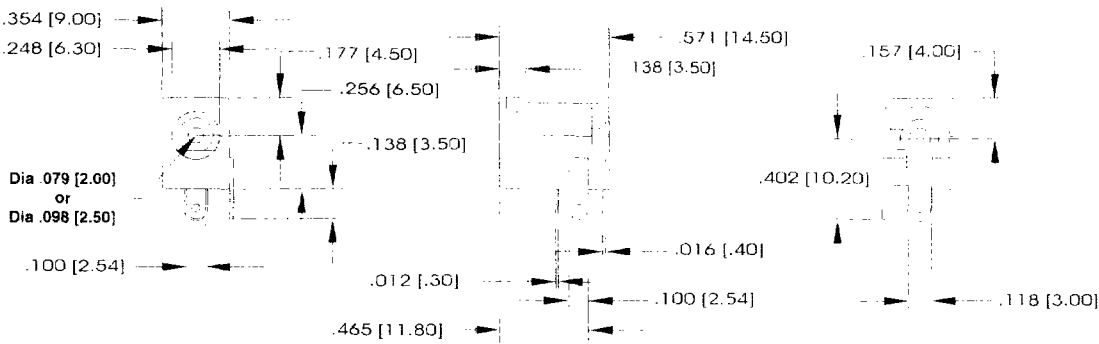

ADC - 002

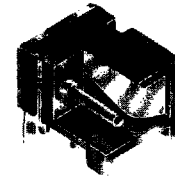
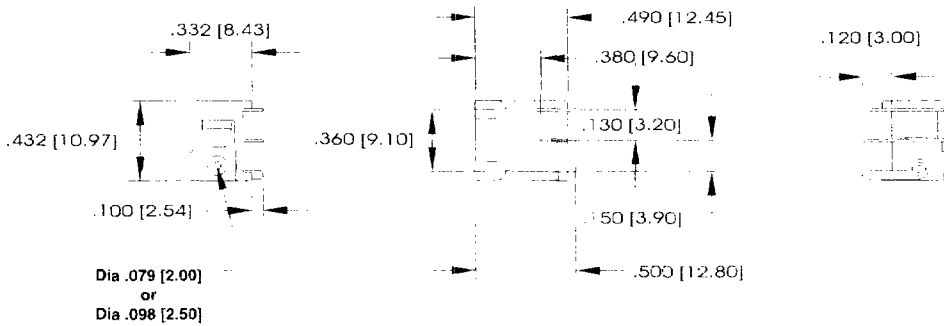

ADC - 003

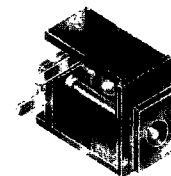
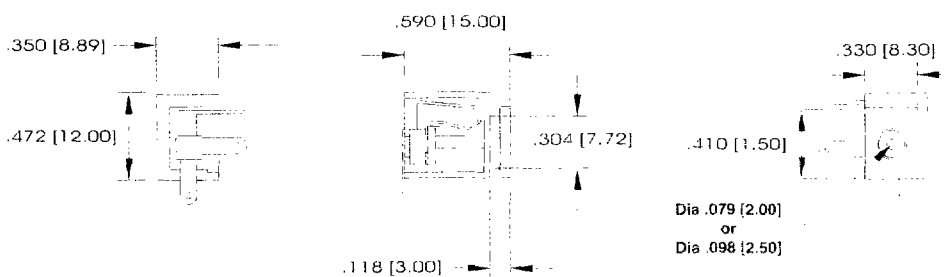

ADC - 005

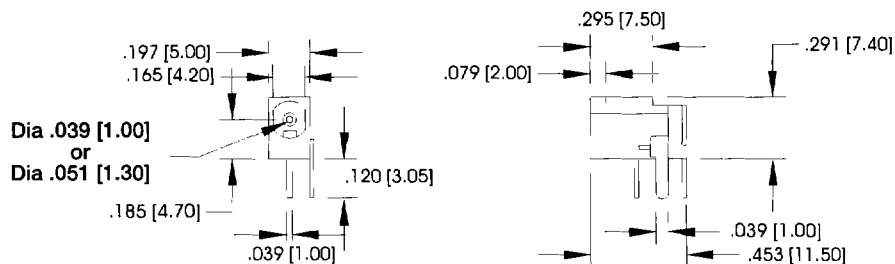

ADC - 007

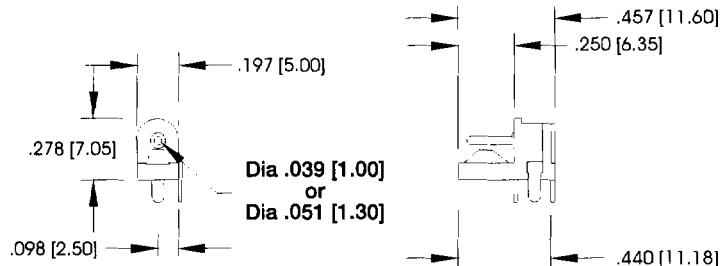

ADC - 009

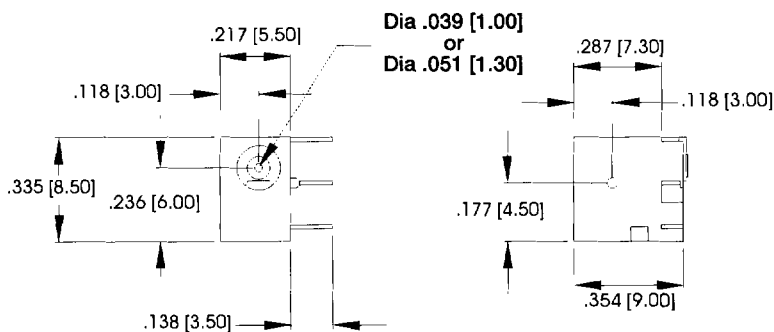

ADC - 011

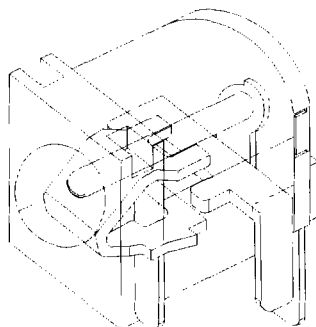

ISOMETRICAL OPERATION VIEW

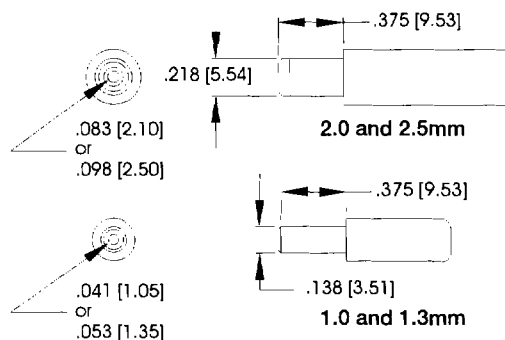

RECOMMENDED MATING PLUG SIZE