

70325-XXX-XX

NUMBER OF POSITIONS

PIN LENGTH

PLATING

BASIC PART NUMBER

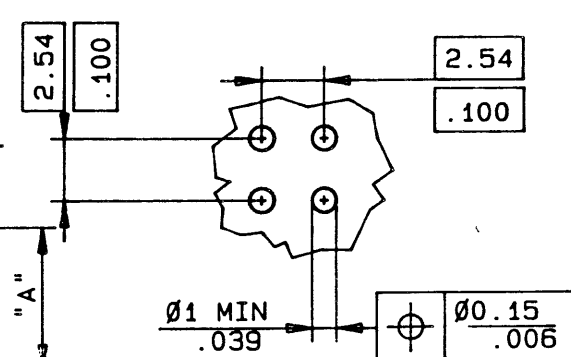
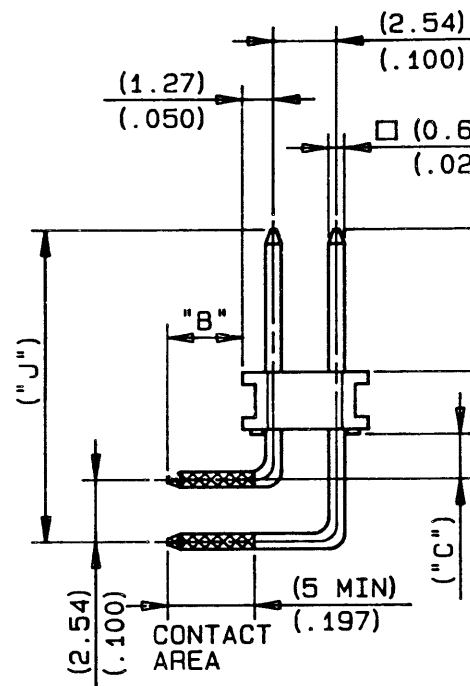

RECOMMENDED HOLE PATTERN

NOTES:

1. MATERIAL PIN :
PHOSPHOR BRONZE A.S.T.M.
B 159 ALLOY C 51000 H0 3
2. MATERIAL BODY :
POLAMID, 30% GLASS FILLED
FLAME RETARDANT PER U.L.
94 V-0 COLOUR BLACK
3. DIM. 1.27 ± 0.03 FOR MOULDED
SIDE(S) ONLY, IF SIDE(S) ARE
BROKEN DIM. 1.02 MIN. TO
1.70 MAX. APPLIES
4. PIN PUSH-OUT FORCE = 15N MIN

CUSTOMER COPY FOR REFERENCE ONLY

stamp part no/rev ltr in area indicated by X		metl code	SEE NOTES 1 & 2
date		finish	SEE SHEET 2
dr 880603 D.GREEN		product no	70325-XXX-XX
chr 880603 C.STONE		title	HEADER, R.A. DOUBLE ROW, REVDUPLEX 2.54mm
appd 880603 H.VAN.DYK		dwg no	70325
release no.		rev	A
A 11122 880603 DGF		sheet	213
revlcr no date dr		1 of 2	



