

67349-0000

56734901S01

| NO. | DRAWING NO. | MATERIAL NO. | NAME | MATERIAL |
|-----|--------------|--------------|---------|------------------------------|
| 1 | SD-67130-003 | 67130-0002 | HEADER | HIGH TEMP. PLASTIC ,TERMINAL |
| 2 | SD-67121-002 | 67121-0001 | EJECTOR | STAINLESS STEEL |

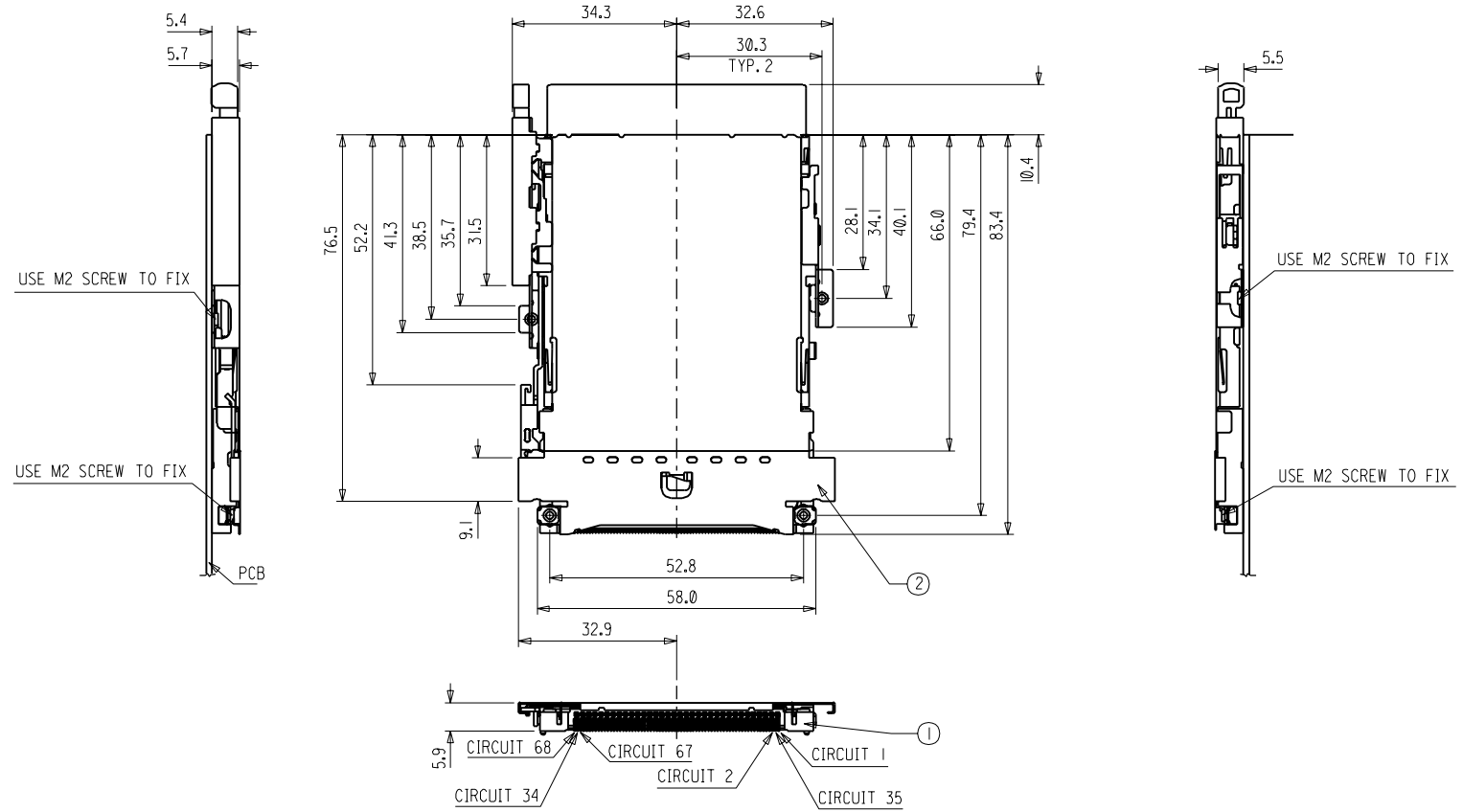

NEW RELEASED
 T2000-0124
 Tom Lu 99/12/23
 Vincent Lin
 Mega Lin

0
 0

1:1

Tom Lu 99/12/23

SINGLE SLOT PCMCIA RIGHT PUSH-PUSH
 FOR 3.3V SMT STANDAR TYPE

| | |
|---|---|
| 2 | A |
| 1 | A |

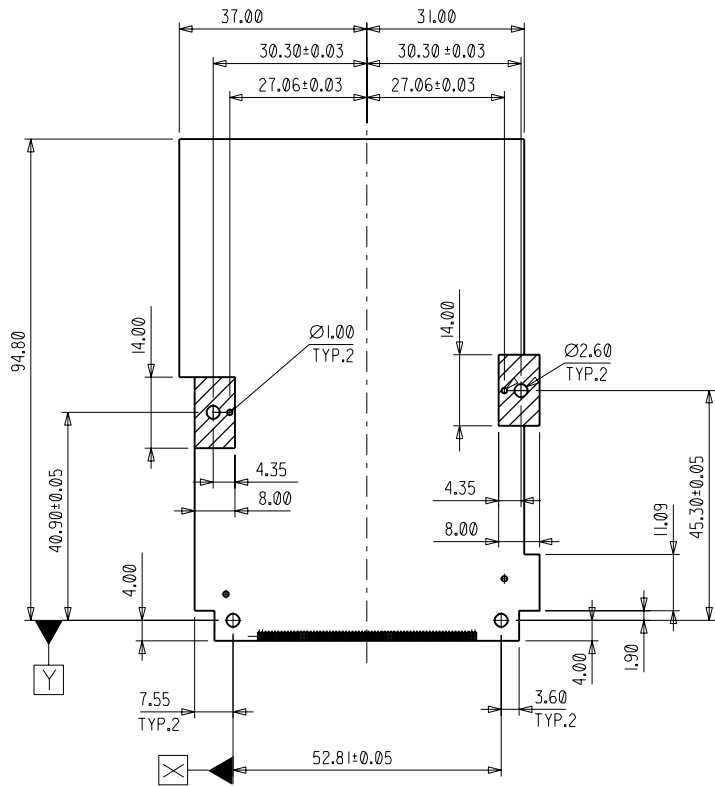

NOTES:

- 1.THE CIRCUITS 1,35,34,68 ARE GROUND FINCTION
- 2.COPLANARITR IS 0.10 mm MAX BETWEEN SOLDER TAILS
- 3.TRUE POSITION IS 0.15 mm MAX BETWEEN SOLDER TAILS
- 4.PRODUCT SPEC. REFER PS-89428

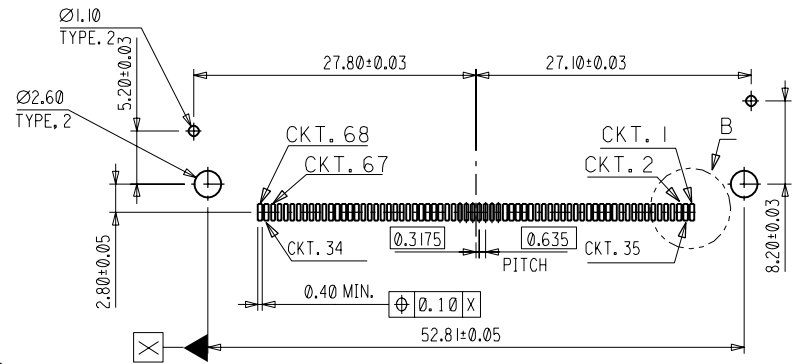

SCALE 2:1

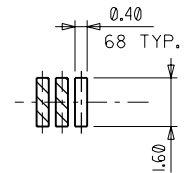

DETAIL B

| | | | | | | | | | | | |
|--|--|--|------------------|---|------------------------|---|------------------------------|------------------------------------|--|--|---------------------|
| NEW RELEASED EC NO. T2000-0124 DRWN: Tom Lu 99/12/23 CHK: Vincent Lin APPR: Mega Lin | QUALITY SYMBOLS MAJOR = 0 CRITICAL = 0 | GENERAL TOLERANCES: (UNLESS SPECIFIED) | | SCALE 1:1 DESIGN UNITS <input checked="" type="checkbox"/> mm <input type="checkbox"/> INCH | THIRD ANGLE PROJECTION | DIMENSIONS: <input type="checkbox"/> mm <input type="checkbox"/> INCH <input type="checkbox"/> mm ONLY | | SHT | RE | | |
| | | 4 PLACES ±0.15 ± | 3 PLACES ±0.15 ± | | | 2 PLACES ±0.25 ±0.10 | 1 PLACE ±0.25 ±0.10 | DRAWN BY & DATE Tom Lu 99/12/23 | TITLE: SINGLE SLOT PCMCIA RIGHT PUSH-PUSH FOR 3.3V SMT STANDAR TYPE | | REVISE C CAD ONL |
| | | ANGULAR: ±3° | | | | CHECKED BY & DATE | MOLEX INCORPORATED | | SHEET 2/2 | | |
| | | DRAFT WHERE APPLICABLE MUST REMAIN WITHIN DIMENSIONS | | | | APPROVED BY & DATE | CAD FILENAME S6734901.S02 | MATERIAL NO. 67349-0001 | DRAWING NO. SD-67349-001 | THIS DRAWING CONTAINS INFORMATION THAT IS PROPRIETARY TO MOLEX INCORPORATED AND SHOULD NOT BE USED WITHOUT WRITTEN PERMISSION. | |

