

PRODUCT NUMBER  
SEE TABLE

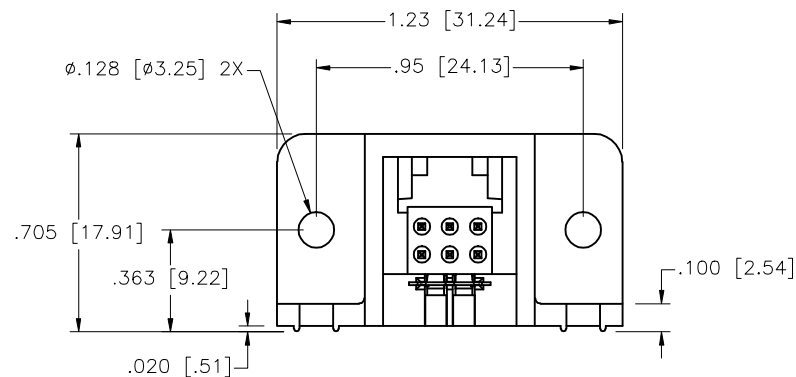
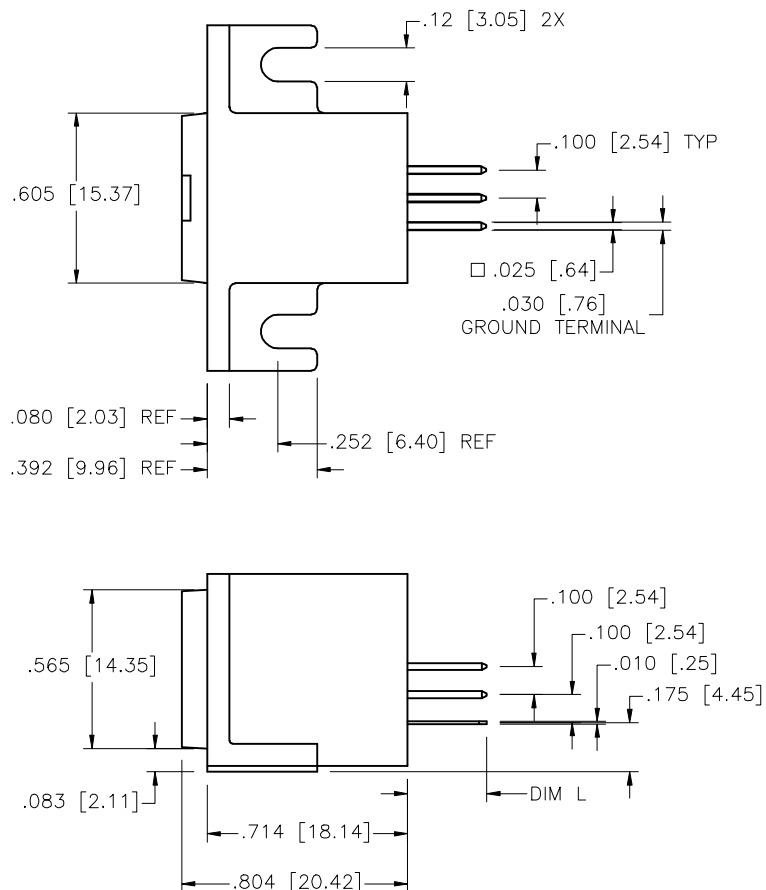

mat'l. code				surface	tolerance	projection	product family
				ISO 1902	ISO 406 ISO 1101		LATCH-N-LOK
ltr	ecn no	dr	date	tolerances unless otherwise specified			title
A	"	MRC	6/21/90	angles	.XX±.01/XX±.03	INCH/MM	2X3 LNL VERTICAL PANEL MOUNT HEADER ASSEMBLY
B	"	RDS	10/18/90	linear	.XXX±.005/XX±.013		
C	VO1053	TFG	6/28/00	0'±2'	.XXX±.0020/XXX±.0051	scale 1:1	sheet 1 of 2 size
D	v10985	TFG	2/21/01	dr	M. CORNMANN	6/21/60	A3
E	M05-0050	ERE	03/15/05	engr	D. HORCHLER	6/21/90	
F	M06-0365	AGS	9/21/06	chr	D. HORCHLER	6/21/90	type
G	M09-0048	MHT	3/12/09	appd	D. HORCHLER	6/21/90	Product Customer Drawing
sheet	revision	G	G				
index	sheet	1	2				

78067-XXXLF

LEAD FREE OPTION ⑥ ⑦

	COLOR ④	
1	70343-LT GRAY	OBS
2	80166 OFF WHITE	
3	70634-DK GRAY	OBS
4	701 BLACK	
5	70511-SLATE GRAY	OBS
7	70455 SILVER GRAY	
8	80189 PEARL WHITE	OBS
9	70419 PEBBLE GRAY	

	PLATING ⑧
0	30u" GXT
3	30u" AU OVER 50u" NI
5	50u" AU OVER 50u" NI

	PIN LENGTH
	DIM L
0	.130/3.30
1	.230/5.84
2	.318/8.08

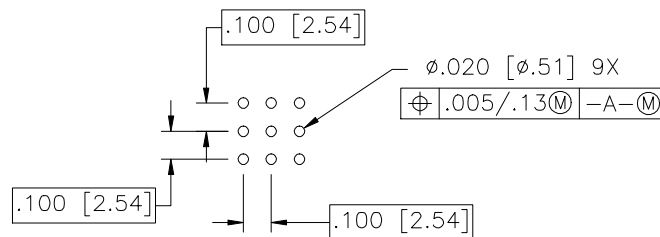

## RECOMMENDED P.C.B. LAYOUT

### NOTES:

- HEADER SHROUD  
MATERIAL: POLYCARBONATE,  
94V-0 RATED.
- GROUND CONTACT  
MATERIAL: COPPER ALLOY  
PLATING: 100-160u"/2.54-4.06u TIN
- SIGNAL CONTACT  
MATERIAL: COPPER ALLOY  
PLATING: SEE TABLE
- NUMBERS SHOWN ARE FOR G.E. LEXAN AND  
ARE FOR REFERENCE ONLY.
- THIS ASSEMBLY UL APPROVED PER FILE E66906 VOL. 1,  
SEC. 84 AND CSA APPROVED PER MASTER FILE LR46923.
- ADD LF SUFFIX AT THE END OF PART NUMBER FOR LEAD FREE OPTION.
- THIS PRODUCT MEETS EUROPEAN UNION DIRECTIVES AND OTHER  
COUNTRY REGULATION AS DESCRIBED IN GS-22-008.
- PLATING OPTIONS:  
MAY BE EITHER GOLD OR GXT PLATED AT MANUFACTURER'S OPTION.

mat'l. code		surface ISO 1902	tolerance ISO 406 ISO 1101	projection INCH/MM	product family LATCH-N-LOK
ltr	ec'n no	dr	date	title 2X3 LNL VERTICAL PANEL MOUNT HEADER ASSEMBLY	
G				dwg no 78067	
				sheet 2 of 2 size A3	
				type Product Customer Drawing	
sheet index	revision sheet				