



ELECTRIC CORPORATION

MACHINE TOOL TRANSFORMERS  
SINGLE PHASE OPEN CONSTRUCTION

11/94

**FEATURES**

- UL LISTED (FILE No. E105527)
- 100% COPPER WINDINGS
- HIGH QUALITY SILICON STEEL CORE MATERIAL
- SLOTTED MOUNTING FOR EASY INSTALLATION
- EASY ACCESS TERMINALS TO PROTECT FROM ACCIDENTAL ELECTRICAL CONTACT

**TA SERIES**

- 55 DEGREE CENTIGRADE TEMPERATURE RISE RATING
- COOLER OPERATING TEMPERATURE
- LOWER INRUSH CURRENT
- SUPERIOR SECONDARY VOLTAGE REGULATION

**TF SERIES**

- 115 DEGREE CENTIGRADE TEMPERATURE RISE RATING
- LOW INRUSH CURRENT
- OUTSTANDING SECONDARY VOLTAGE REGULATION
- COMPACT SIZE

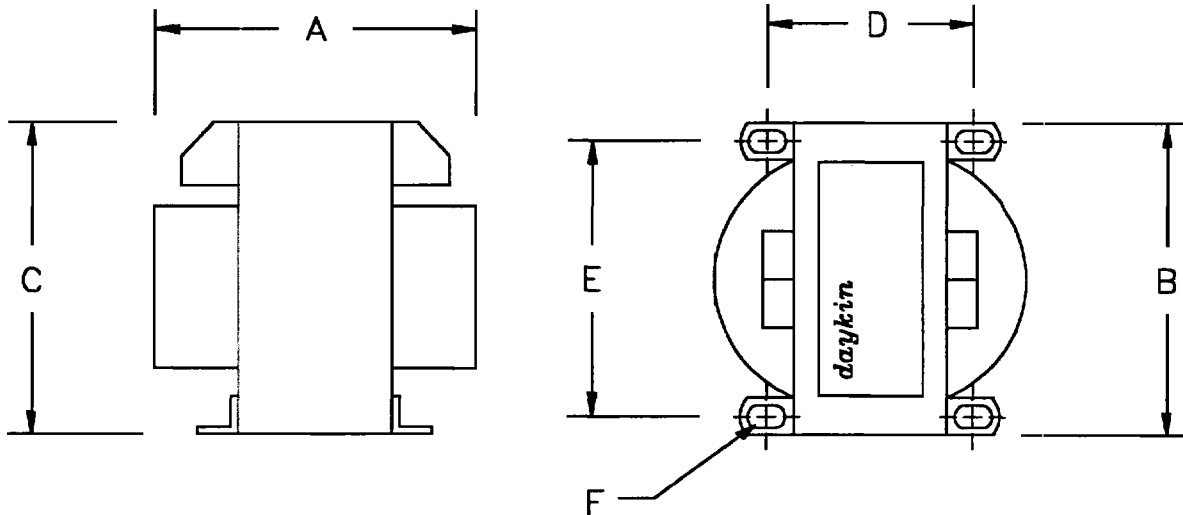



ELECTRIC CORPORATION

LOW TEMPERATURE RISE  
MACHINE TOOL TRANSFORMERS  
SINGLE PHASE OPEN CONSTRUCTION  
TA SERIES 55°C RISE

1/95

TA SERIES

		240/480V		120V 50/60 HZ			
		PRIMARY 230/460V		SECONDARY 115V 50/60 HZ 55°C RISE			
		220/440V		110V 50/60 HZ			
PART NO.	VA RATING	A	B	C	D	E	F
TA250	250	4 3/4	4 1/2	3 3/4	3 5/8	3 3/4	3/16 x 5/16
TA500	500	5	5 1/4	4 3/8	3 3/4	4 3/8	9/32 x 13/32
TA750	750	5	6 3/8	5 5/16	3 3/8	5 5/16	9/32 x 9/16
TA1000	1000	6 1/4	6 3/8	5 5/16	4 5/8	5 5/16	9/32 x 9/16
TA1500	1500	8	6 3/8	5 5/16	6 1/8	5 5/16	9/32 x 9/16
TA2000	2000	7 1/2	7 1/2	6 1/4	6 1/4	5 1/2	13/32 x 1
TA3000	3000	7 1/2	7 1/2	6 1/4	6 1/4	5 1/2	13/32 x 1
TA5000	5000	8 1/2	9	7 1/2	7 1/4	6 1/2	13/32 x 1

TA-K SERIES

		PRIMARY 480/575V		SECONDARY 115V 50/60 HZ 55°C RISE			
PART NO.	VA RATING	A	B	C	D	E	F
TA250K	250	4 1/4	4 1/2	3 3/4	3 3/8	3 3/4	3/16 x 5/16
TA500K	500	5	5 1/4	4 3/8	3 3/4	4 3/8	9/32 x 13/32
TA750K	750	5	6 3/8	5 5/16	3 3/8	5 5/16	9/32 x 9/16
TA1000K	1000	6	6 3/8	5 5/16	4 1/4	5 5/16	9/32 x 9/16
TA1500K	1500	8	6 3/8	5 5/16	6	5 5/16	9/32 x 9/16
TA2000K	2000	7 1/2	7 1/2	6 1/4	6 1/4	5 1/2	13/32 x 1
TA3000K	3000	8	7 1/2	6 1/4	6 3/4	5 1/2	13/32 x 1
TA5000K	5000	8 3/4	9	7 1/2	7 3/16	6 1/2	13/32 x 1

TA-U SERIES

		208/220/230/240V		85/91/95/99V			
		PRI 380/400/416/440/460/480V		SEC 100/110/115/120V 50/60 HZ 55°C RISE			
		500/550/575/600V		125/130V			
PART NO.	VA RATING	A	B	C	D	E	F
TA250U	250	4 1/2	4 1/2	3 3/4	3 5/8	3 3/4	3/16 x 5/16
TA500U	500	5	5 1/4	4 3/8	3 3/4	4 3/8	9/32 x 13/32
TA750U	750	5 3/8	6 3/8	5 5/16	3 5/8	5 5/16	9/32 x 9/16
TA1000U	1000	6 1/8	6 3/8	5 5/16	4 5/8	5 5/16	9/32 x 9/16
TA1500U	1500	7 5/8	6 3/8	5 5/16	6 1/8	5 5/16	9/32 x 9/16
TA2000U	2000	7 5/8	7 1/2	6 1/4	6 7/16	5 1/2	13/32 x 1
TA3000U	3000	8 7/8	7 1/2	6 1/4	7 7/16	5 1/2	13/32 x 1
TA5000U	5000	10	12	10 9/16	6 9/16	8 1/2	13/32 x 1



ELECTRIC CORPORATION

SINGLE PHASE  
INDUSTRIAL CONTROL TRANSFORMERS  
OPEN CONSTRUCTION  
TF SERIES 115°C RISE

1/95

TF SERIES

		240/480V		120V 60 HZ			
		PRIMARY 230/460V		SECONDARY 115V 50/60 HZ 115°C RISE			
		220/440V		110V 50/60 HZ			
PART NO.	VA RATING	A	B	C	D	E	F
TF250	250	4	4 1/2	3 3/4	3	3 3/4	3/16 x 5/16
TF500	500	4 3/4	5 1/4	4 3/8	3 9/16	4 3/8	9/32 x 13/32
TF750	750	5 1/2	5 1/4	4 3/8	4 1/4	4 3/8	9/32 x 13/32
TF1000	1000	5	6 3/8	5 5/16	3 1/2	5 5/16	9/32 x 9/16
TF1500	1500	6 3/8	6 3/8	5 5/16	4 7/8	5 5/16	9/32 x 9/16
TF2000	2000	7	6 3/8	5 5/16	5 1/2	5 5/16	9/32 x 9/16
TF3000	3000	7 1/2	7 1/2	6 1/4	6 3/16	5 1/2	13/32 x 1
TF5000	5000	7 7/8	9	7 1/2	6 3/16	6 1/2	13/32 x 1

TF-K SERIES

		PRIMARY 480/575V		SECONDARY 115V 60 HZ 115°C RISE			
PART NO.	VA RATING	A	B	C	D	E	F
TF250K	250	3 5/8	4 1/2	3 3/4	2 5/8	3 3/4	3/16 x 5/16
TF500K	500	4 1/2	5 1/4	4 3/8	3 1/2	4 3/8	9/32 x 13/32
TF750K	750	5 1/2	5 1/4	4 3/8	4 1/4	4 3/8	9/32 x 13/32
TF1000K	1000	4 3/4	6 3/8	5 5/16	3 1/2	5 5/16	9/32 x 9/16
TF1500K	1500	6 1/2	6 3/8	5 5/16	4 1/2	5 5/16	9/32 x 9/16
TF2000K	2000	7	6 3/8	5 5/16	5 5/8	5 5/16	9/32 x 9/16
TF3000K	3000	7 1/2	7 1/2	6 1/4	6 1/16	5 1/2	13/32 x 1
TF5000K	5000	7 7/8	9	7 1/2	6 1/16	6 1/2	13/32 x 1

TF-U SERIES

		208/220/230/240V		85/91/95/99V			
		PRI 345/380/400/416/440/460V		SEC 100/110/115/120V 50/60 HZ 115°C RISE			
		480/500/550/575/600V		125/130V			
PART NO.	VA RATING	A	B	C	D	E	F
TF250U	250	4	4 1/2	3 3/4	3 1/4	3 3/4	3/16 x 5/16
TF500U	500	4 3/4	5 1/4	4 3/8	3 5/8	4 3/4	9/32 x 13/32
TF750U	750	3 5/8	6 3/8	5 5/16	3 1/8	5 5/16	9/32 x 9/16
TF1000U	1000	5 1/4	6 3/8	5 5/16	3 5/8	5 5/16	9/32 x 9/16
TF1500U	1500	6 1/2	6 3/8	5 5/16	5	5 5/16	9/32 x 9/16
TF2000U	2000	7	7 1/2	6 1/4	5 1/4	5 1/2	13/32 x 1
TF3000U	3000	7 1/2	7 1/2	6 1/4	6 3/16	5 1/2	13/32 x 1
TF5000U	5000	8	9	7 1/2	6 1/4	6 1/2	13/32 x 1



ELECTRIC CORPORATION

**SINGLE PHASE  
INDUSTRIAL CONTROL TRANSFORMERS  
OPEN CONSTRUCTION  
TF SERIES 115°C RISE**

1/95

**TF-J SERIES**

PRIMARY 230/460/575V		SECONDARY 115V 60 HZ 115°C RISE					
PART NO.	VA RATING	A	B	C	D	E	F
TF500J	500	4 1/2	5 1/4	4 3/8	3 1/2	4 3/8	9/32 x 13/32
TF1000J	1000	5 1/2	6 3/8	5 5/16	4	5 5/16	9/32 x 9/16
TF1500J	1500	6 1/2	6 3/8	5 5/16	5	5 5/16	9/32 x 9/16
TF2000J	2000	8	6 3/8	5 5/16	5 3/8	5 5/16	9/32 x 9/16
TF3000J	3000	8 1/8	7 1/2	6 1/4	6 7/8	5 1/2	13/32 x 1
TF5000J	5000	8	9	7 1/2	5 7/8	6 1/2	13/32 x 1

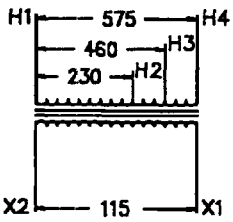

**TF-L SERIES**

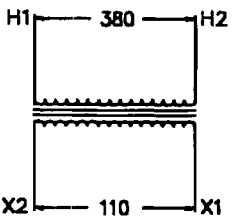
PRIMARY 380V		SECONDARY 110V 50/60 HZ 115°C					
PART NO.	VA RATING	A	B	C	D	E	F
TF500L	500	4 1/2	5 1/4	4 3/8	3 1/2	4 3/8	9/32 x 13/32
TF1000L	1000	5	6 3/8	5 5/16	3 1/2	5 5/16	9/32 x 9/16
TF1500L	1500	6 1/4	6 3/8	5 5/16	4 5/8	5 5/16	9/32 x 9/16
TF2000L	2000	7 1/8	6 3/8	5 5/16	5 1/2	5 5/16	9/32 x 9/16
TF3000L	3000	7 3/8	7 1/2	6 1/4	6	5 1/2	13/32 x 1
TF5000L	5000	8 1/2	9	7 1/2	6 1/4	6 1/2	13/32 x 1

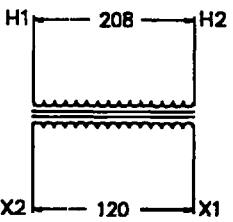

**TF-M SERIES**

PRIMARY 208V		SECONDARY 120V 60 HZ 115°C RISE					
PART NO.	VA RATING	A	B	C	D	E	F
TF500M	500	4 1/2	5 1/4	4 3/8	3 3/8	4 3/8	9/32 x 13/32
TF1000M	1000	4 3/4	6 3/8	5 5/16	3 1/2	5 5/16	9/32 x 9/16
TF1500M	1500	6 1/8	6 3/8	5 5/16	4 1/2	5 5/16	9/32 x 9/16
TF2000M	2000	7 1/8	6 3/8	5 5/16	5 1/2	5 5/16	9/32 x 9/16
TF3000M	3000	7 3/8	7 1/2	6 1/4	6	5 1/2	13/32 x 1
TF5000M	5000	8 1/2	9	7 1/2	6 1/4	6 1/2	13/32 x 1



**TF-Q SERIES**

PRIMARY 460V		SECONDARY 230VCT 60 HZ 115°C RISE					
PART NO.	VA RATING	A	B	C	D	E	F
TF500Q	500	4 1/2	5 1/4	4 3/8	3 1/2	4 3/8	9/32 x 13/32
TF1000Q	1000	5	6 3/8	5 5/16	3 1/2	5 5/16	9/32 x 9/16
TF1500Q	1500	6 1/2	6 3/8	5 5/16	5	5 5/16	9/32 x 9/16
TF2000Q	2000	6 3/4	6 3/8	5 5/16	5 7/8	5 5/16	9/32 x 9/16
TF3000Q	3000	7 1/4	7 1/2	6 1/4	6 11/16	5 1/2	13/32 x 1
TF5000Q	5000	8 1/2	9	7 1/2	6 1/4	6 1/2	13/32 x 1

