

## PUSH-ON COAX 120 SERIES

These BNC/TNC push-on jacks and plugs are designed for (U)PL123 blind mate rack and panel applications. The male plugs mate (U)PL122 with any BNC/TNC jack and are ideally suited for test/cable applications.

PL121 Shown

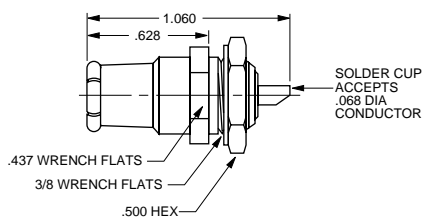

<b>PANEL PLUG</b>	50Ω	<b>PL121</b>
<b>FRONT MOUNT, SOLDER POT</b>	75Ω	<b>UPL121</b>
<b>W/ SOLDER LUG</b>	50Ω	<b>PL121SL</b>
	75Ω	<b>UPL121SL</b>

Mounting Hole: C2.093

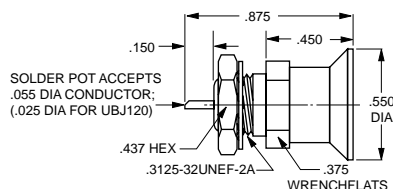

<b>BULKHEAD JACK</b>	50Ω	<b>BJ120</b>
<b>FRONT MOUNT, SOLDER LUG</b>	75Ω	<b>UBJ120</b>
<b>W/ SOLDER LUG</b>	50Ω	<b>BJ120SL</b>
	75Ω	<b>UBJ120SL</b>

Mounting Hole: C1.120

PL122 Shown

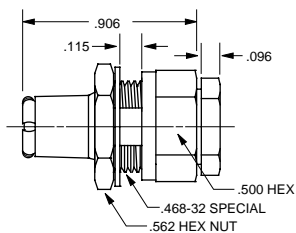

<b>PANEL PLUG</b>	50Ω	<b>PL122-</b>
<b>REAR MOUNT, CABLE ENTRY</b>	75Ω	<b>UPL122-</b>

Mounting Hole: DD5.187

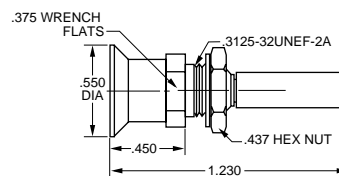

<b>BULKHEAD CABLE JACK</b>	50Ω	<b>BJ120C-</b>
<b>FRONT MOUNT, TOOL CRIMP</b>	75Ω	<b>UBJ120C-</b>

Limited Cable Groups  
Mounting Hole: C1.120

PL223-001 Shown

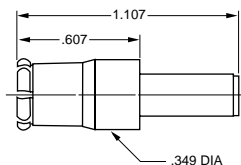

<b>CABLE PLUG</b>	50Ω	<b>PL223-</b>
<b>TOOL CRIMP</b>	75Ω	<b>UPL223-</b>

PL123-2 Shown

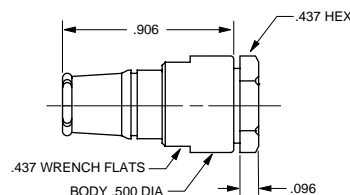

<b>CABLE PLUG</b>	50Ω	<b>PL123-</b>
<b>WRENCH CRIMP</b>	75Ω	<b>UPL123-</b>

- Refers to Cable Group Table, see pages 91-133. "D" mounting holes are on page 54