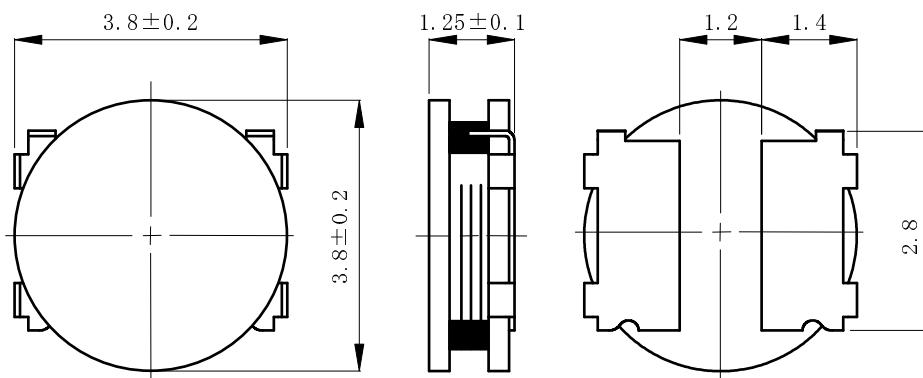
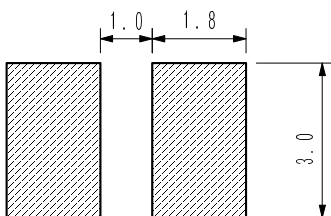
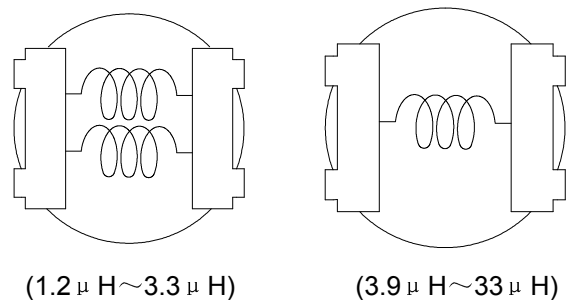

Type: CDH38D12/S
◆ Product Description

- 4.0 × 4.0mm Max.(L × W), 1.35mm Max. Height.
- Inductance range: 1.2 ~ 33 μ H.
- Rated current range: 0.43 ~ 3.15A.
- In addition to the standard versions of inductors shown here, custom inductors are available to meet your exact requirements.

◆ Feature

- Magnetically unshielded construction.
- Storage temperature range: -40°C ~ +105°C.
- Operating temperature range: -40°C ~ +105°C (Including coil's self temperature rise).
- Ideally used PDA, MP3, DSC/DVC etc as DC-DC converter inductors.
- Dropping impact reinforced types.
- Product weight: 0.064g (Ref.).
- RoHS compliance and Halogen free.

◆ Dimensions (mm)

◆ Land Pattern (mm)

◆ Schematics (Bottom)

Type: CDH38D12/S
◆ Specification

| Part Name ※ | Stamp | Inductance (μ H) 100kHz/1V | D.C.R. (m Ω) (at 20°C) | Saturation Current (A) ※1 | Temperature Rise Current (A) ※2 |
|-------------------|-------|---------------------------------------|--------------------------------------|---------------------------------|---------------------------------------|
| CDH38D12SNP-1R2M□ | 1R2 | 1.2±20% | 42±20% | 3.25 | 3.15 |
| CDH38D12SNP-1R5M□ | 1R5 | 1.5±20% | 55±20% | 2.80 | 2.65 |
| CDH38D12SNP-2R2M□ | 2R2 | 2.2±20% | 69±20% | 2.40 | 2.10 |
| CDH38D12SNP-2R7M□ | 2R7 | 2.7±20% | 88±20% | 2.15 | 1.95 |
| CDH38D12SNP-3R3M□ | 3R3 | 3.3±20% | 100±20% | 1.95 | 1.82 |
| CDH38D12SNP-3R9M□ | 3R9 | 3.9±20% | 125±20% | 1.75 | 1.35 |
| CDH38D12SNP-4R7M□ | 4R7 | 4.7±20% | 135±20% | 1.60 | 1.20 |
| CDH38D12SNP-5R9M□ | 5R9 | 5.9±20% | 190±20% | 1.45 | 1.10 |
| CDH38D12SNP-6R8M□ | 6R8 | 6.8±20% | 200±20% | 1.30 | 1.02 |
| CDH38D12SNP-8R0M□ | 8R0 | 8.0±20% | 245±20% | 1.20 | 0.88 |
| CDH38D12SNP-8R6M□ | 8R6 | 8.6±20% | 260±20% | 1.15 | 0.87 |
| CDH38D12SNP-100M□ | 100 | 10±20% | 280±20% | 1.10 | 0.86 |
| CDH38D12SNP-120M□ | 120 | 12±20% | 360±20% | 0.98 | 0.71 |
| CDH38D12SNP-150M□ | 150 | 15±20% | 420±20% | 0.88 | 0.63 |
| CDH38D12SNP-180M□ | 180 | 18±20% | 560±20% | 0.8 | 0.59 |
| CDH38D12SNP-220M□ | 220 | 22±20% | 630±20% | 0.75 | 0.58 |
| CDH38D12SNP-270M□ | 270 | 27±20% | 830±20% | 0.65 | 0.48 |
| CDH38D12SNP-330M□ | 330 | 33±20% | 970±20% | 0.60 | 0.43 |

※ Description of part name

CDH38D12SNP-1R2M□

- B Box
- C Carrier Tape

※1.Saturation current: The DC current at which the inductance decreases to 70% of its nominal value.

※2.Temperature rise current: The DC current at which the temperature rise is $\Delta t=40^{\circ}\text{C}$ ($T_a=20^{\circ}\text{C}$).