

All rights strictly reserved. Reproduction or issue to third parties without written authority from the proprietor is not permitted without written permission of FCI Electronics Inc. Property of FCI Electronics Inc. Reproduction or communication a des tiers interdite sans autorisation écrite du propriétaire. Droits de reproduction FCI Electronics Inc.

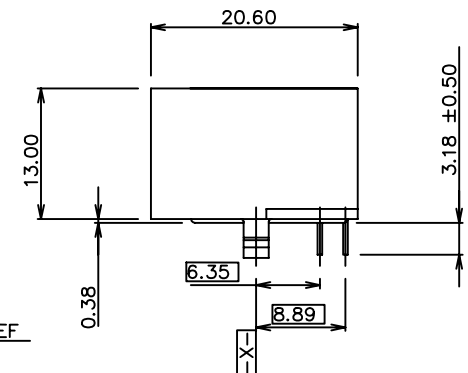
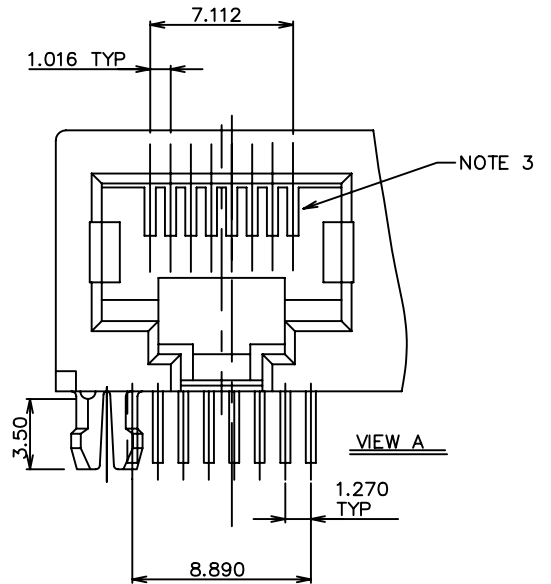
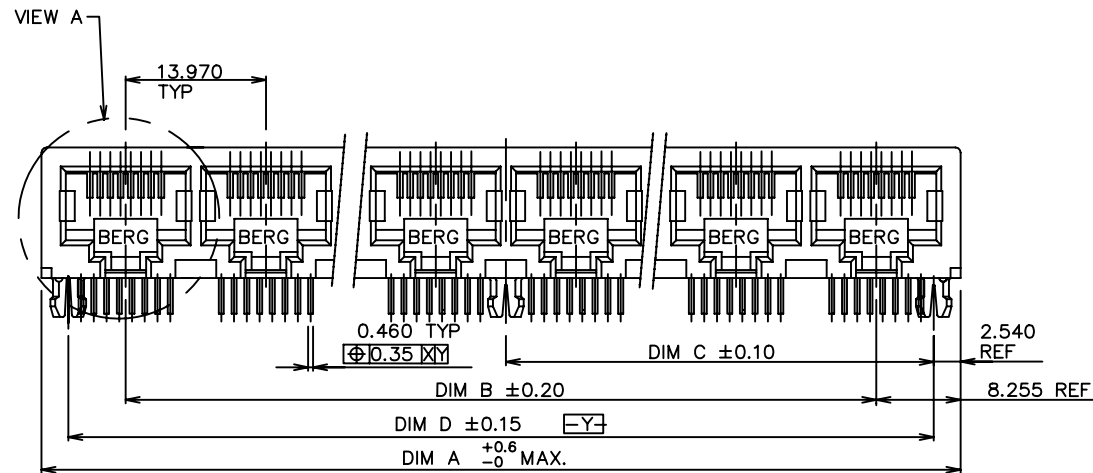
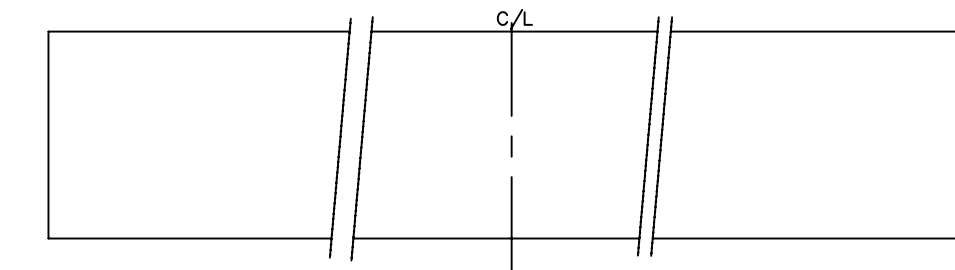

mat'l. code				tolerances unless otherwise specified				CUSTOMER COPY		FCI	
ltr	ecn no	dr	date	linear	.XX ± 0.01 / .XX ± 0.13	projection				www.fciconnect.com	
C	V70846	LP	5/4/97	linear	.XXX ± 0.005 / .XX ± 0.13	projection					
D	V12594	LP	3/20/02	linear	.XXX ± 0.0020 / .XX ± 0.051	projection					
E	M0-0174	MTH	8/17/04	angle	0 ± 2	projection					
F	M04-0187	MTH	10/06/04	dr	L.POTTEIGER 8/30/95	projection					
G	M05-0067	MTH	4/8/05	engr	Y.BELOPOLSKY 8/30/95	projection					
H	N06-0036	DT	2/9/06	chr	Y.BELOPOLSKY 8/30/95	projection					
				appd	Y.BELOPOLSKY 8/30/95	projection					
sheet index	revision sheet	H	H								
		1	1								

All rights strictly reserved. Reproduction or issue to third parties without written authority from the proprietor is not permitted without written authority from the proprietor. Property of c FCI ELECTRONICS INC. Reproduction or communication a des tiers interdite sans autorisation écrite du propriétaire. Droits de reproduction FCI ELECTRONICS INC.

PRODUCT No.	PORTS No	DIM A ± 0.60 -0.00	DIM B ± 0.20	DIM C ± 0.10	DIM D ± 0.15
95679-X01/X01LF	1	15.24	-----	5.715	11.43
95679-X02/X02LF	2	30.48	13.97	12.700	25.40
95679-X03/X03LF	3	44.45	27.94	19.685	39.37
95679-X04/X04LF	4	58.42	41.91	26.670	53.34
95679-X05/X05LF	5	72.39	55.88	33.655	67.31
95679-X06/X06LF	6	86.36	69.85	40.640	81.28
95679-X06P/X06PLF					
95679-X07/X07LF	7	100.33	83.82	47.625	95.25
95679-X08/X08LF	8	114.30	97.79	54.610	109.22
95679-X09/X09LF	9	128.27	111.76	61.595	123.19
95679-X10/X10LF	10	142.24	125.73	68.580	137.16
95679-X11/X11LF	11	156.21	139.70	75.565	151.13
95679-X12/X12LF	12	170.18	153.67	82.550	165.10

NOTE 4

NOTES:

1. APPLICABLE PC BOARD THICKNESS: 1.6 mm.
2. CONTACTS: PHOSPHOR BRONZE ALLOY UNS-C51000, $\emptyset 0.460$ ROUND WIRE, PLATING SEE TABLE.
3. CENTER PEG FOR 8 PORT AND ABOVE.
- ④ OPTIONAL CENTER PEG IN PORT 6 (95679-X06PLF) WITH CENTER PEG (95679-X06LF) WITHOUT CENTER PEG
- ⑤ PART NUMBERS WITH LF IN THE END ARE LEAD FREE.
4. THIS PRODUCT MEETS EUROPEAN UNION DIRECTIVES AN OTHER COUNTRY REGULATION AS DESCRIBED IN GS-22-008.
5. THE HOUSING TEMPERATURE WITHSTAND EXPOSURE TO 260°C PEAK TEMPERATURE FOR 15 SECONDS IN A WAVE SOLDER APPLICATION WITH A 1.5 MM MINIMUM THICK CIRCUIT BOARD. SEE APPLICATION NOTES/PROCEDURES IF THEY ARE AVAILABLE.
- ⑥ PLATING OPTION:
MAY BE EITHER GOLD OR GXT PLATED AT MANUFACTURER'S OPTION.

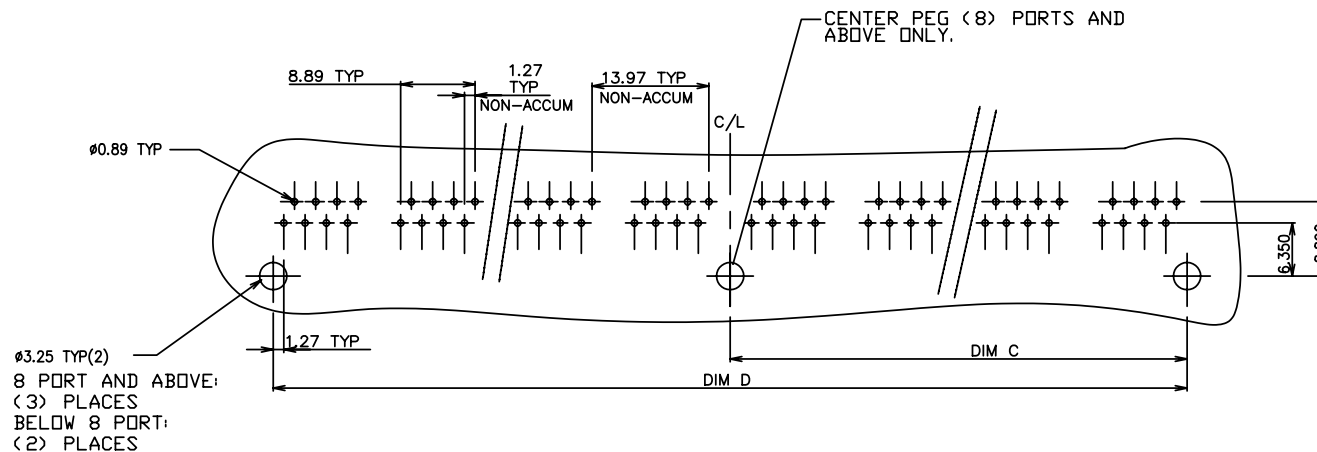

RECOMMENDED PC BOARD LAYOUT

PLATING CODE X	PLATING ⑥
0	30u" G.X.T.
1	15u" GOLD.
2	15u" G.X.T.
3	30u" GOLD.
5	50u" GOLD.

mat'l. code		tolerances unless otherwise specified		CUSTOMER COPY		FCI www.fciconnect.com	
ltn	ecn no	dr	date	linear	projection	title	
H				.XX ± 0.1 / .XX ± 3		R/A CAT 5 GANG JACK ASSY	
				.XXX ± 0.05 / .XX ± 13		8 POS UNSHIELDED SNAP PEG	
				.XXX ± 0.020 / .XXX ± 0.051		product family	
				angles 0 ± 2		sizing no	
				dr LPOTTEIGER 8/30/95		code	
				engr Y.BELOPOLSKY 8/30/95		NT	
				chr Y.BELOPOLSKY 8/30/95		sheet	
				appd Y.BELOPOLSKY 8/30/95		2 of 2	
sheet index	revision sheet	H	H		scale 1:1	A3	
		1	1				