

Type: CDRH4D19/LD

UNDER DEVELOPMENT

Product Description

- 5.1 × 5.1mm Max.(L × W), 2.0mm Max. Height.
- Inductance range: 0.8 ~ 100 μ H
- Rated current range: 0.28 ~ 3.1A
- In addition to the standards versions shown here, custom inductors are also available to meet your exact requirements.



Feature

- Magnetically shielded construction.
- Ideally used in portable devices such as DSC & DVC,PDA(Saturation Current higher than CDRH4D19F in which flat wire is used).
- RoHS Compliance

Dimensions (mm)

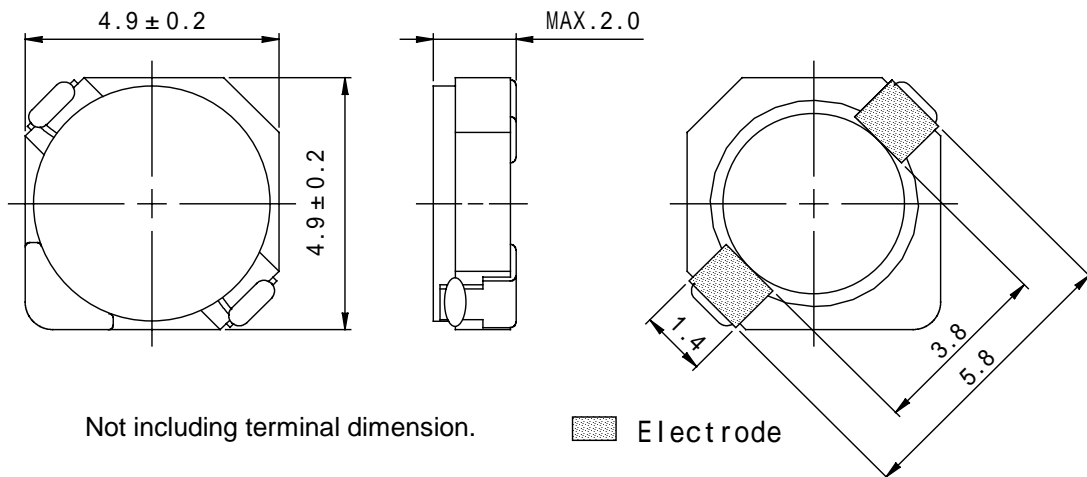

Land Pattern (mm)

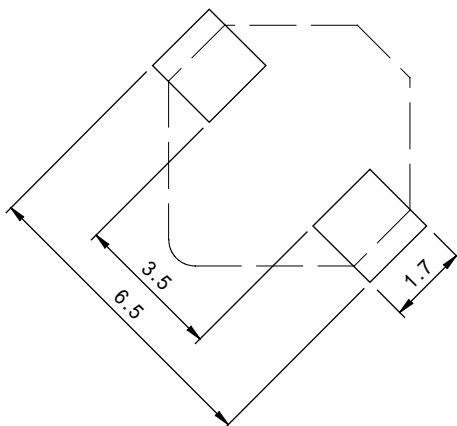

Type: CDRH4D19/LD

UNDER DEVELOPMENT

Specification

Part Name	Stamp	Inductance (μ H) [Within] 100kHz/1V	D.C.R.(m Ω) Max.(Typ.) (at 20 $^{\circ}$ C)	Saturation Current (A) 1		Temperature rise current (A) 2
				(at 20 $^{\circ}$ C)	(at 100 $^{\circ}$ C)	
CDRH4D19LDNP-0R8N	0R8	0.8 μ H \pm 25%	14.3(11.4)	3.10	2.60	5.00
CDRH4D19LDNP-1R2N	1R2	1.2 μ H \pm 25%	17.3(13.8)	2.55	2.15	4.40
CDRH4D19LDNP-2R2N	2R2	2.2 μ H \pm 25%	28.9(23.1)	1.90	1.60	3.20
CDRH4D19LDNP-3R3N	3R3	3.3 μ H \pm 25%	42.3(33.8)	1.55	1.30	2.60
CDRH4D19LDNP-4R7N	4R7	4.7 μ H \pm 25%	57.1(45.7)	1.35	1.10	2.10
CDRH4D19LDNP-5R6N	5R6	5.6 μ H \pm 25%	70.5(56.4)	1.20	1.00	2.00
CDRH4D19LDNP-6R8N	6R8	6.8 μ H \pm 25%	79.1(63.3)	1.05	0.90	1.80
CDRH4D19LDNP-8R2N	8R2	8.2 μ H \pm 25%	93.0(74.4)	1.00	0.82	1.60
CDRH4D19LDNP-100M	100	10.0 μ H \pm 20%	104(83.1)	0.92	0.78	1.50
CDRH4D19LDNP-150M	150	15.0 μ H \pm 20%	165(132)	0.75	0.60	1.15
CDRH4D19LDNP-220M	220	22.0 μ H \pm 20%	248(198)	0.60	0.50	0.90
CDRH4D19LDNP-330M	330	33.0 μ H \pm 20%	363(290)	0.48	0.40	0.75
CDRH4D19LDNP-470M	470	47.0 μ H \pm 20%	490(392)	0.40	0.35	0.60
CDRH4D19LDNP-680M	680	68.0 μ H \pm 20%	740(592)	0.35	0.30	0.50
CDRH4D19LDNP-101M	101	100 μ H \pm 20%	1079(863)	0.28	0.24	0.42

Description Of Part Name

CDRH4D19LDNP-0R8N

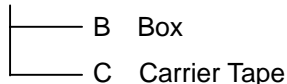

- 1.Saturation Current: The DC current at which the inductance decreases to 65% of it's nominal value.
- 2.Temperature rise current:The DC current at which the temperature rise is $t = 40^{\circ}$ C. ($T_a = 20^{\circ}$ C)