

PERFORMANCE CHARACTERISTICS

CURRENT RATING: 1.5 A AT 20°C (FULLY LOADED)
1 A AT 70°C (FULLY LOADED)

RATED VOLTAGE: 500 V AC (CONT /CONT)

OPERATING TEMPERATURE : -55°C TO 125°C

CONTACT RESISTANCE : 20 mΩ MAX

INSERTION FORCE: 0.75N MAX/CONT

EXTRACTION FORCE : 0.15N MIN /CONT

INSULATION RESISTANCE: 10⁴ MΩ MIN

NOTES

1. LEAD FREE INDICATOR :LF=LEAD FREE
PERFORMANCE LEVEL INDICATOR
(REF. DWG NO.BS.C.201844.003)

2. THIS PRODUCT IS CSA APPROVED.
THIS PRODUCT IS UL RECOGNIZED.

3.FOR RECOMMENDED PTH DIMENSIONS REFER DRAWING :BS.A.201572.001

4.THIS PRODUCT (LF) MEETS EUROPEAN UNION DIRECTIVES AND OTHER COUNTRY
REGULATIONS AS DESCRIBED IN GS-22-008

LAY-OUT
P.C.B.- HOLE

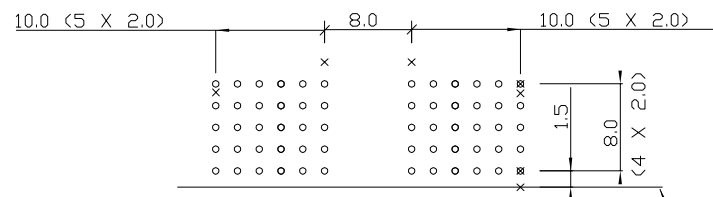

EDGE OF P.C.BOARD

rev	ecn no	dr	date
A	KN	14-09-01	
B	KN	10-10-05	

Material	Spec ref	tolerance	projection	MM
Mat code		1 DEC ±0.2 1 DEC 2 DEC ±0.1 2 DEC ANGLES ±1° MAX	MM	
Heat treat				
Plating/Finish				
Dr	23-10-02	M.Fret	size	Scale
Eng			A1	5.000
Chr			ECN	
Appr			REL Level	
Product family	MILLIPACS			
Model Name				
Model Revision				
MPACS 5R RA RCP CONN TYPE A 6+6 POS				
BS,C ,201418,045				

PDM-Rev-B STATUS-Released Printed: Dec 10, 2005

REV.	DATE	DESCRIPTION	BY	C'K'D'
B	06-05-04	104-0029	ALEX B	BKP
C	14-01-05	105-0006	ALEX B	BKP
D	01-06-05	105-0083	ALEX B	BKP

MILLIPACS : CONTACT PLATING CODE OVERVIEW

HM2---P------(L-)(LF)

FOR LEAD FREE PLATING
OPTIONAL (NOTE 1)
PLATING CODE (DIGIT 13 AND 14)

PLATING CODE	CONTACT AREA		
L9	1.25 μ Au min over 1.3 μ Ni min.	MALE CONN.: SHORT / WIRE WRAP CONT. FEMALE CONNECTOR	
E9	1.00 μ Au min over 1.3 μ Ni min.	MALE CONN.: SHORT / WIRE WRAP CONT. FEMALE CONNECTOR	PERFORMANCE LEVEL 1 (500 mating cycles)
N9	0.80 μ Au min over 1.3 μ Ni min.	MALE CONN.: SHORT / WIRE WRAP CONT. FEMALE CONNECTOR	PERFORMANCE LEVEL 2 (250 mating cycles)
Z1	0.40 μ Au min over 1.3 μ Ni min.	MALE CONN.: SHORT / WIRE WRAP CONT. FEMALE CONNECTOR	PERFORMANCE LEVEL 3 (50 mating cycles)
NN	0.15 μ Au Average over 1.02 μ NiP Average.	MALE CONN.: SHORT / WIRE WRAP CONT. FEMALE CONNECTOR	
NEN	0.38 μ Au Average over 1.02 μ NiP Average.	MALE CONN.: SHORT / WIRE WRAP CONT. FEMALE CONNECTOR	
GE	1.25 μ Au min over 1.3 μ Ni min.	MALE CONN.: REAR PLUG-UP CONTACTS	
GL	1.00 μ Au min over 1.3 μ Ni min.	MALE CONN.: REAR PLUG-UP CONTACTS	PERFORMANCE LEVEL 1 (500 mating cycles)
GF	0.80 μ Au min over 1.3 μ Ni min.	MALE CONN.: REAR PLUG-UP CONTACTS	PERFORMANCE LEVEL 2 (250 mating cycles)
GC	0.40 μ Au min over 1.3 μ Ni min.	MALE CONN.: REAR PLUG-UP CONTACTS	PERFORMANCE LEVEL 3 (50 mating cycles)
GN	0.15 μ Au Average over 1.02 μ NiP Average. (Both Front & Rear Sides)	MALE CONN.: REAR PLUG-UP CONTACTS	
GEN	0.38 μ Au Average over 1.02 μ NiP Average. (Both Front & Rear Sides)	MALE CONN.: REAR PLUG-UP CONTACTS	

NOTE :

- 1) IN CASE OF STR HDR CONNECTORS :
EXTENSIONS CAN BE ADDED TO THE PLATING CODE
IF LUBRICATED CONTACTS ARE REQUIRED
L : LUBRICATED
L1: LUBRICATED TO MEET TELCORDIA GR-1217 CORE REQUIREMENTS
- 2) PLATING AT EON AREA
LF : Sn MATT FINISH PLATING(0.05 μ Min)
ALL OTHER PART NOS : SnPb PLATING(0.05 μ Min)

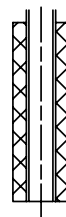

REF NOTE 2 FOR
EON PLATING

1DEC ± 0.2 1DEC 2DEC ± 0.1 2DEC ANGLES $\pm 1^\circ$ HOEKEN	APPR. DRAFT CHECKED	DATE 210303	SIGN. M.Fret	MPACS CONTACT PLATING OVERVIEW	
WE RESERVE THE RIGHT TO CHANGE DIMENSIONS OR REQUIREMENTS WITHOUT PRIOR NOTICE.	PROD. MGR. PR. ENG. MGR. PR. MGT. MGR.			CAT. No. HM2---P------(L-)	
ALL DIMENSIONS IN MM	REFERENCES / REFERENTIES			SCALE	
ALLE AFMETINGEN IN MM				FCI MECHLEN N.V. A. SPINOYSTRAT 8, 2800 MECHLEN	
				BS,C ,201844,003 D	