

DO NOT  
SCALE FROM  
THIS PRINT

NOTES:

1.  $\textcircled{C}$  REPRESENTS A CRITICAL DIMENSION.
2. MINIMUM PUSHOUT FORCE: 1 LB[4.45N].
3. MAXIMUM ALLOWABLE BOW: .002[.05] INCH/INCH AFTER ASSEMBLY.
4. POST HEIGHT VARIATION BETWEEN ANY TWO PINS: .005[.13].
5. FOR ALL PINS: NO BAND MARKS ALLOWED IN POST AREA.
6. FOR LOCKING CLIPS: .75LB[3.336N] MIN RETENTION.
7. MEASURE AT BEND.
8. MAX PIN ROTATION IN BODY TO BE 2°.

SHF-1XX-01-X-D-XX-XX

No OF POSITIONS  
-02 THRU -25

LEAD STYLE  
-01:

PLATING SPECIFICATION  
-L: LIGHT SELECTIVE  
(USE T-1S71-XX-L)  
-F: FLASH GOLD SELECTIVE  
(USE T-1S71-XX-F)  
-S: SELECTIVE GOLD  
(USE T-1S71-XX-S)

OPTION

- LC: LOCKING CLIP  
(NOT AVAILABLE WITH -RA)
- K: POLYIMIDE FILM  
(-SM ONLY)  
(AVAILABLE IN TAPE & REEL ONLY)
- TR: TAPE & REEL

BODY HEIGHT

- TH: THROUGH HOLE (SEE FIG. 1, SHT. 1)
- RA: RIGHT ANGLE (SEE FIG. 2, SHT. 2)
- SM: SURFACE MOUNT (SEE FIG. 3, SHT. 3)

ROW SPECIFICATION  
-D: DOUBLE

FIG. 1  
(SHF-110-01-X-D-TH-LC SHOWN)

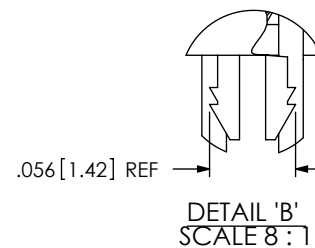
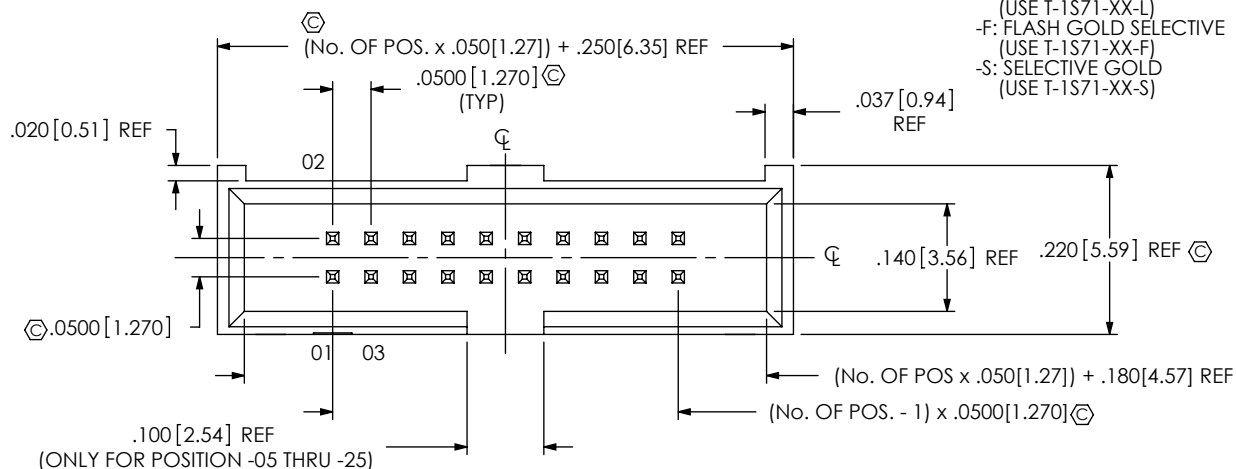

FIRST POSITION  
INDICATOR

2° MAX SWAY  
(TYP)

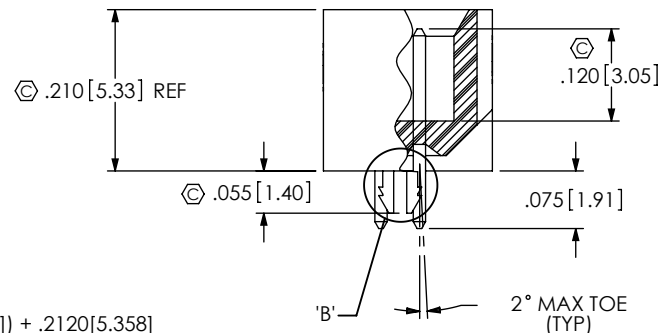
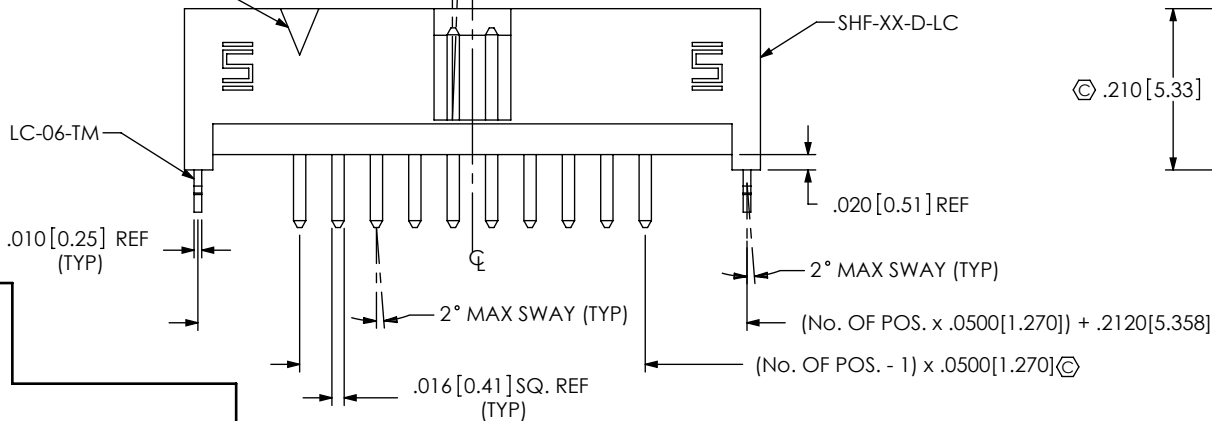

IN-PROCESS 1  
(FOR -TH ONLY)

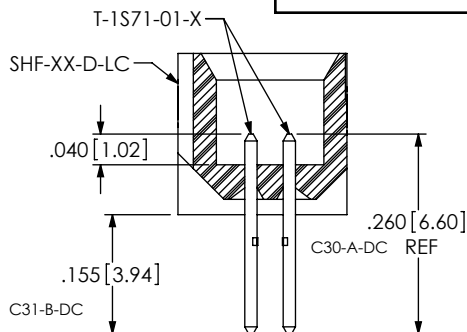

UNLESS OTHERWISE SPECIFIED,  
DIMENSIONS ARE IN INCHES.  
TOLERANCES ARE:  
DECIMALS ANGLES  
.XX:  $\pm .01$  [0.3]  
.XXX:  $\pm .005$  [0.13]  
.XXXX:  $\pm .0020$  [0.051]

PROPRIETARY NOTE

THIS DOCUMENT CONTAINS INFORMATION  
CONFIDENTIAL AND PROPRIETARY TO  
SAMTEC, INC. AND SHALL NOT BE REPRODUCED  
OR TRANSFERRED TO OTHER DOCUMENTS OR  
DISCLOSED TO OTHERS OR USED FOR ANY  
PURPOSE OTHER THAN THAT WHICH IT WAS  
OBTAINED WITHOUT THE EXPRESSED WRITTEN  
CONSENT OF SAMTEC, INC.

**samtec**

520 PARK EAST BLVD, NEW ALBANY, IN 47150  
PHONE: 812-944-6733 FAX: 812-948-5047  
e-Mail: info@SAMTEC.com code 55322

MATERIAL: DO NOT SCALE DRAWING  
INSULATOR: HTN, COLOR: BLACK  
TERMINAL: PHOS BRONZE

SHEET SCALE: 4:1

DESCRIPTION:  
.050 x .050 SHROUDED TERMINAL STRIP

DWG. NO.

SHF-1XX-01-X-D-XX-XX

BY: T NEWTON 1/10/2008

SHEET 1 OF 4

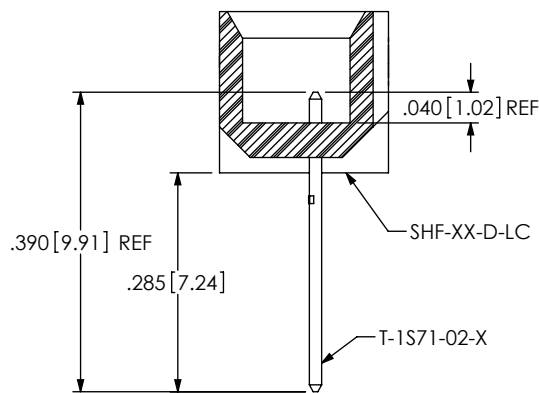

IN-PROCESS 1  
(FOR -RA ONLY)

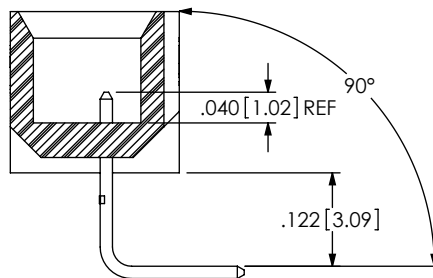

IN-PROCESS 2  
(FOR -RA ONLY)

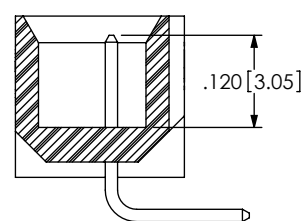

IN-PROCESS 3  
(FOR -RA ONLY)

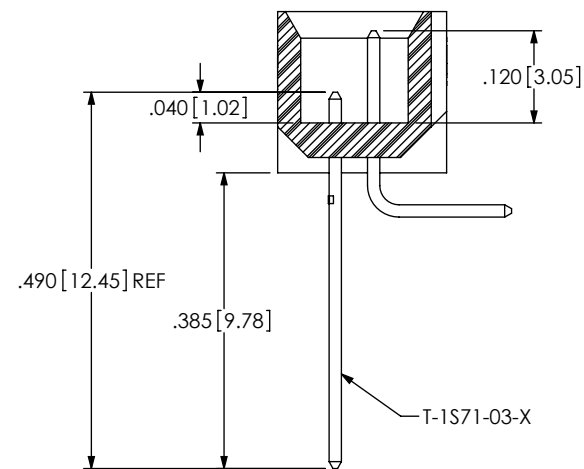

IN-PROCESS 4  
(FOR -RA ONLY)

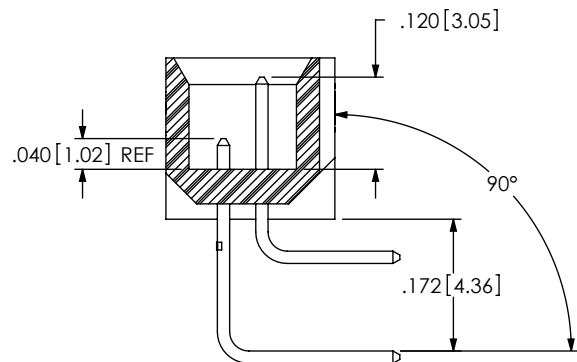

IN-PROCESS 5  
(FOR -RA ONLY)

FIG. 2  
(SHF-110-01-X-D-RA SHOWN)  
(SAME AS FIG. 1, DIFFERENT AS SHOWN)

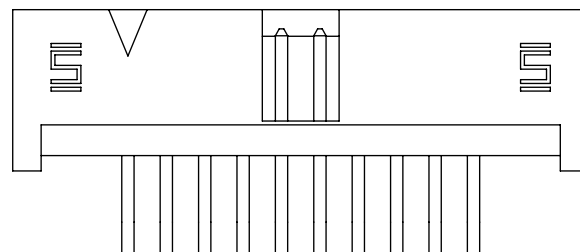
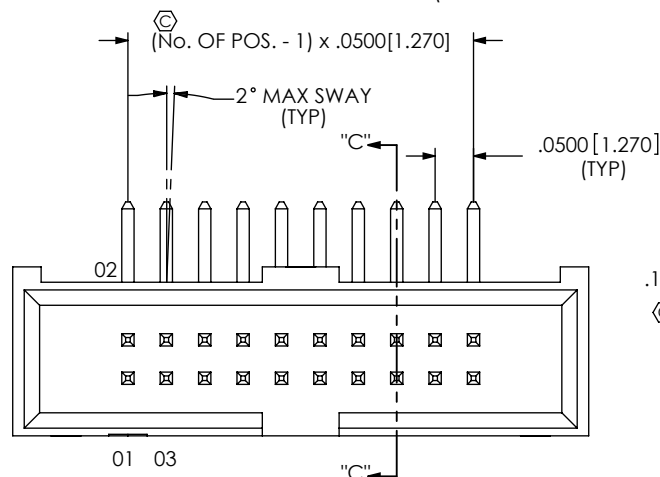

F:\DWG\MISC\MKTG\SHF-1XX-01-X-D-XX-XX-MKT.SLDDRW

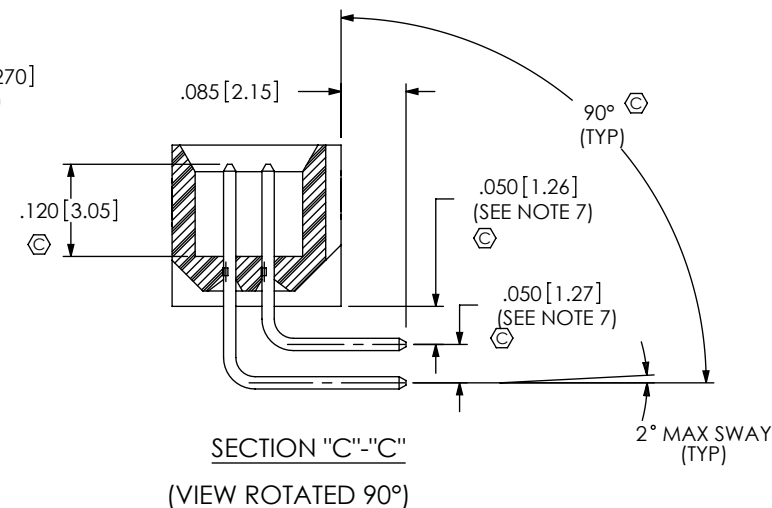

PROPRIETARY NOTE  
THIS DOCUMENT CONTAINS INFORMATION  
CONFIDENTIAL AND PROPRIETARY TO  
SAMTEC, INC. AND SHALL NOT BE REPRODUCED  
OR TRANSFERRED TO OTHER DOCUMENTS OR  
DISCLOSED TO OTHERS OR USED FOR ANY  
PURPOSE OTHER THAN THAT WHICH IT WAS  
OBTAINED WITHOUT THE EXPRESSED WRITTEN  
CONSENT OF SAMTEC, INC.

DO NOT SCALE DRAWING

SHEET SCALE: 4:1

**samtec**

520 PARK EAST BLVD, NEW ALBANY, IN 47150  
PHONE: 812-944-6733 FAX: 812-948-5047  
e-Mail: info@SAMTEC.com code 55322

DESCRIPTION:  
.050 x .050 SHROUDED TERMINAL STRIP

DWG. NO. SHF-1XX-01-X-D-XX-XX

BY: T NEWTON 1/10/2008 SHEET 2 OF 4

# REVISION F

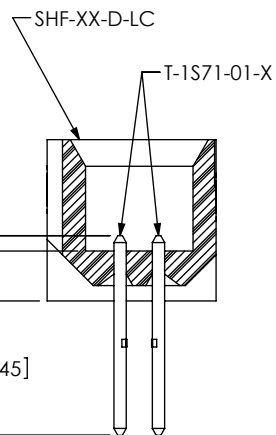

IN-PROCESS 1  
(FOR -SM ONLY)

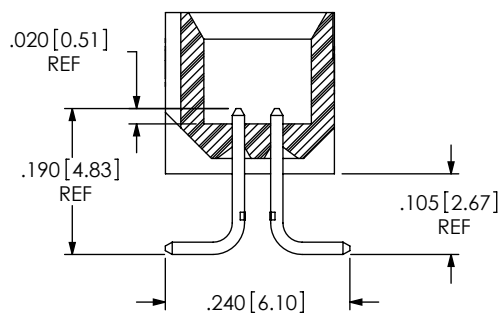

IN-PROCESS 2  
(FOR -SM ONLY)

FIG. 3  
(SHF-110-01-X-D-SM-LC SHOWN)  
(SAME AS FIG. 1, DIFFERENT AS SHOWN)

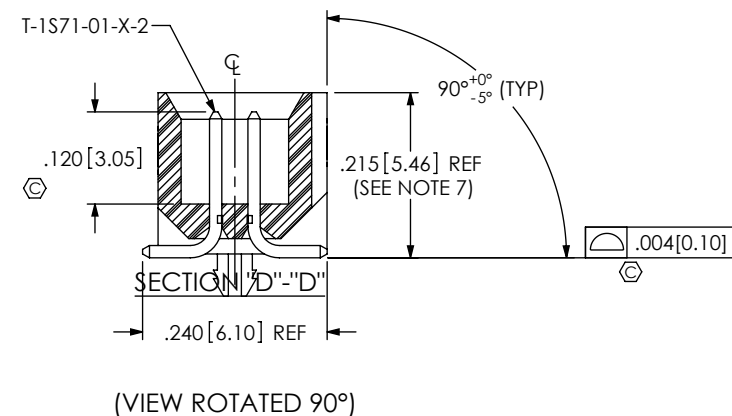
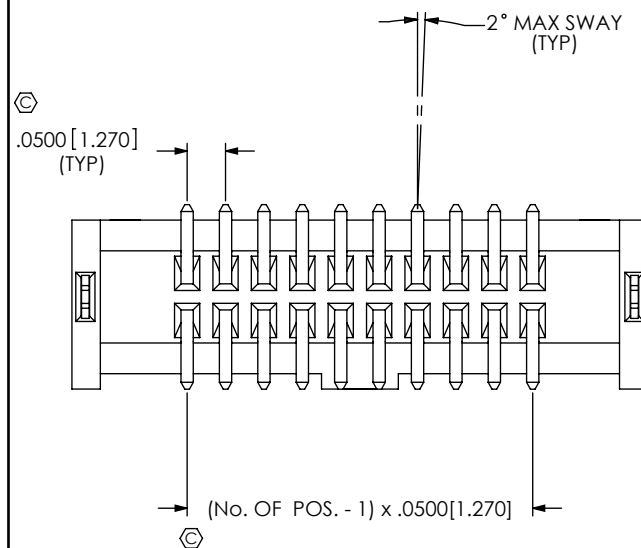
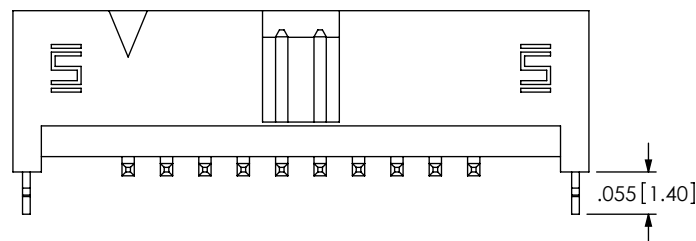
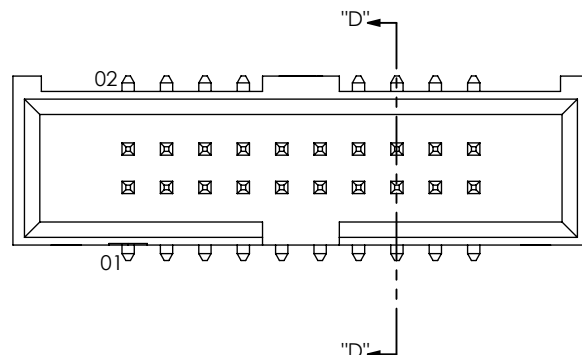

PROPRIETARY NOTE  
THIS DOCUMENT CONTAINS INFORMATION  
CONFIDENTIAL AND PROPRIETARY TO  
SAMTEC, INC. AND SHALL NOT BE REPRODUCED  
OR TRANSFERRED TO OTHER DOCUMENTS OR  
DISCLOSED TO OTHERS OR USED FOR ANY  
PURPOSE OTHER THAN THAT WHICH IT WAS  
OBTAINED WITHOUT THE EXPRESSED WRITTEN  
CONSENT OF SAMTEC, INC.

DO NOT SCALE DRAWING

SHEET SCALE: 4:1

**samtec**

520 PARK EAST BLVD, NEW ALBANY, IN 47150  
PHONE: 812-944-6733 FAX: 812-948-5047  
e-Mail: info@SAMTEC.com code 55322

DESCRIPTION:  
.050 x .050 SHROUDED TERMINAL STRIP

DWG. NO.  
SHF-1XX-01-X-D-XX-XX

BY: T NEWTON 1/10/2008 SHEET 3 OF 4

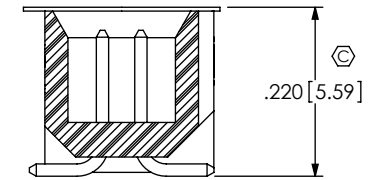
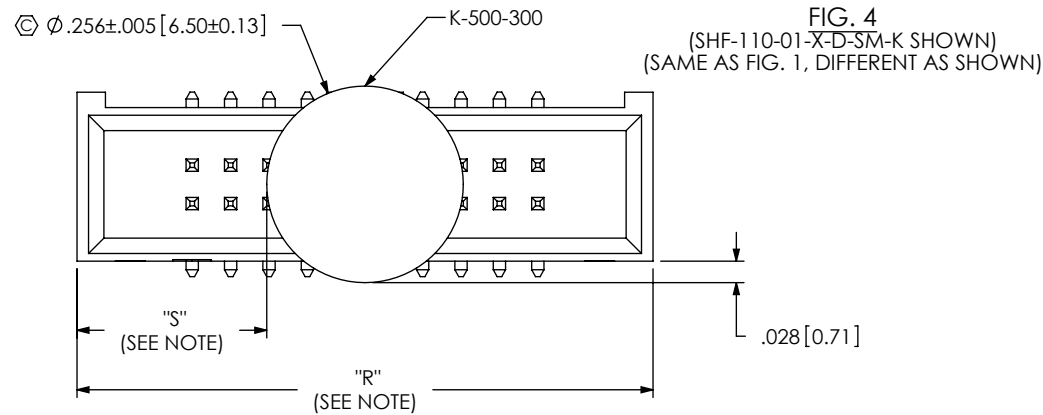

NOTE: "R" = USED MEASURED DIMENSION (REF)  
"S" =  $\{("R" - .256[6.50])/2\} \pm 0.020[0.51]$

**PACKAGING**  
ALL PARTS ARE LOADED WITH POSITION 1  
TOWARD THE ARROW

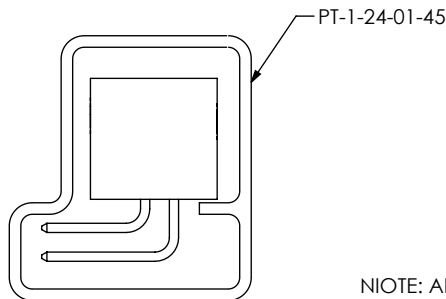
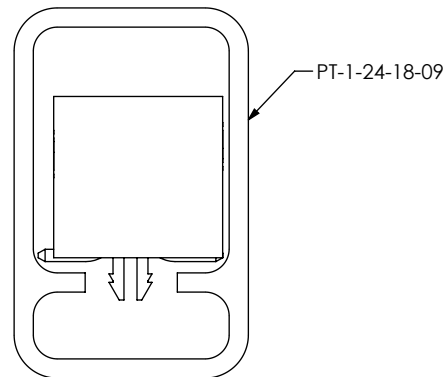
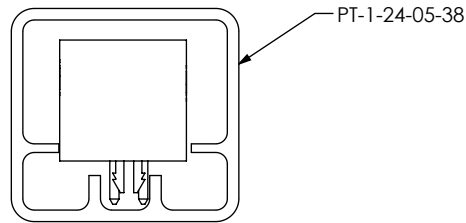

NOTE: ALL POSITIONS ARE TO BE TUBED

TABLE 1		
OPTIONS	PACKAGING TUBE	PLUG
-TH, -TH-LC	PT-1-24-05-38	TP-03
-SM-LC	PT-1-24-18-09	TP-03
-RA	PT-1-24-01-45	TP-07
-SM	PT-1-24-18-09	TP-03

**PROPRIETARY NOTE**  
THIS DOCUMENT CONTAINS INFORMATION  
CONFIDENTIAL AND PROPRIETARY TO  
SAMTEC, INC. AND SHALL NOT BE REPRODUCED  
OR TRANSFERRED TO OTHER DOCUMENTS OR  
DISCLOSED TO OTHERS OR USED FOR ANY  
PURPOSE OTHER THAN THAT WHICH IT WAS  
OBTAINED WITHOUT THE EXPRESSED WRITTEN  
CONSENT OF SAMTEC, INC.

DO NOT SCALE DRAWING

SHEET SCALE: 4:1

**samtec**

520 PARK EAST BLVD, NEW ALBANY, IN 47150  
PHONE: 812-944-6733 FAX: 812-948-5047  
e-Mail info@SAMTEC.com code 55322

DESCRIPTION:  
.050 x .050 SHROUDED TERMINAL STRIP  
DWG. NO. SHF-1XX-01-X-D-XX-XX

BY: T NEWTON 1/10/2008 SHEET 4 OF 4