

SMT Power Inductor

SILM8040 Type

Features

- RoHS compliant.
- Low profile (4.0mm max. Height), SMD type.
- Self-leads, suitable for high density mounting.
- High energy storage and low DCR.
- Provided with embossed carrier tape packing.
- Ideal for power source circuits, DC-DC converter, DC-AC inverters inductor applications.
- In addition to the standard versions shown here, customized inductors are available to meet your exact requirements.

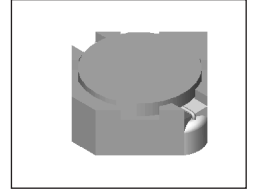

Mechanical Dimension:

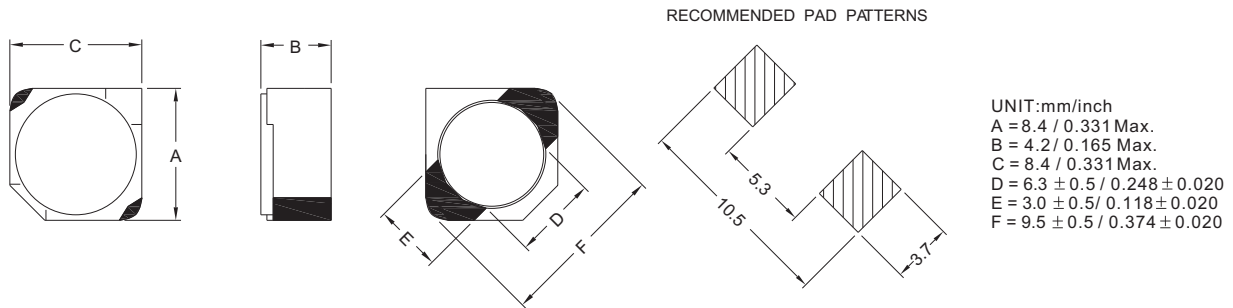

Electrical Characteristics: 25°C: 100KHz, 0.1V

PART NO.	L ¹ (μ H)	DCR (m Ω) MAX	Isat ² (Adc)	Irated ³ (Adc)
SILM8040 - 1R5	1.5	13.8	7.00	9.00
SILM8040 - 2R2	2.2	18.3	6.50	7.50
SILM8040 - 3R3	3.3	20.6	5.00	6.00
SILM8040 - 4R4	4.4	25.7	4.60	6.00
SILM8040 - 5R2	5.2	30.0	4.20	4.50
SILM8040 - 100	10.0	47.0	3.00	4.00
SILM8040 - 150	15.0	71.3	2.75	3.50
SILM8040 - 220	22.0	102.0	2.30	3.00
SILM8040 - 330	33.0	143.0	1.75	2.50
SILM8040 - 470	47.0	189.0	1.52	2.00
SILM8040 - 680	68.0	260.0	1.30	2.00
SILM8040 - 101	100.0	361.0	1.05	1.30

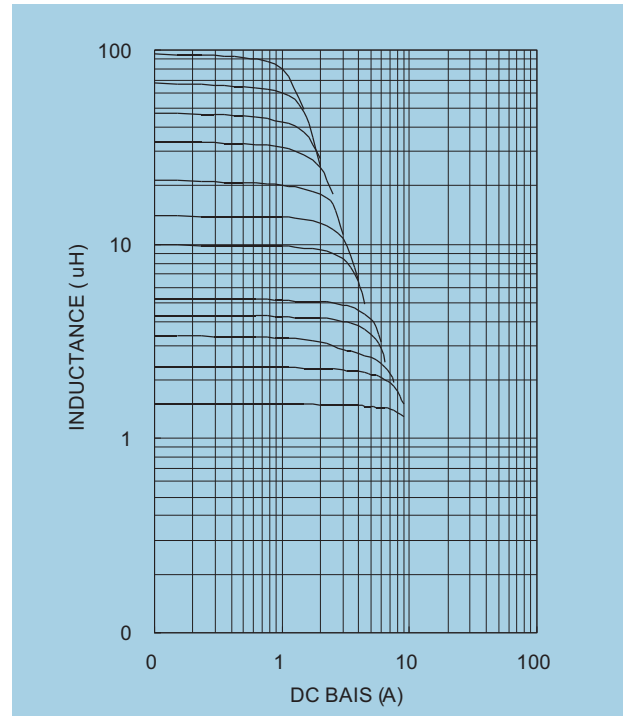

1. Tolerance of inductance : 1.5~100uH± 30%.
2. Irated is the DC current which cause the inductance drop 35% of its nominal inductance without current and the surface temperature of the part increase less than 45°C.
3. Operating temperature: -20°C to 105°C (including self-temperature rise).



DELTA ELECTRONICS, INC.

(TAOYUAN PLANT CPBG) 252, SAN YING ROAD, KUEISAN INDUSTRIAL ZONE, TAOYUAN SHIEN, 333, TAIWAN, R.O.C.

TEL: 886-3-3591968; FAX: 886-3-3591991

<http://www.deltaww.com>